

Han® M12 panel feed-through, D-coded



RJ45 acc. to IEC 60 603 – Technical characteristics see page 03.26

Circular Connectors

Han® M12 panel feed-through
Male, D-coded,
50 cm conductors, AWG 22, 4-poles



21 03 371 1403

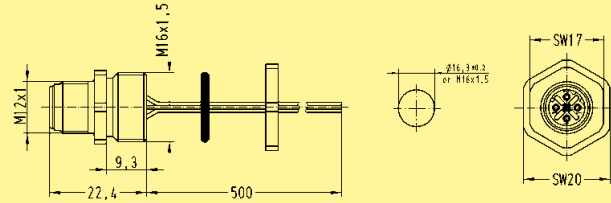

Han® M12 panel feed-through
Female, D-coded,
50 cm conductors, AWG 22, 4-poles

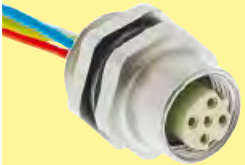

21 03 371 2403

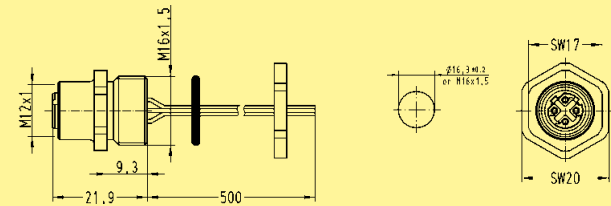

Han® M12 female-RJ45
panel feed-through

4-poles,
D-coded,
angled



21 03 381 4400

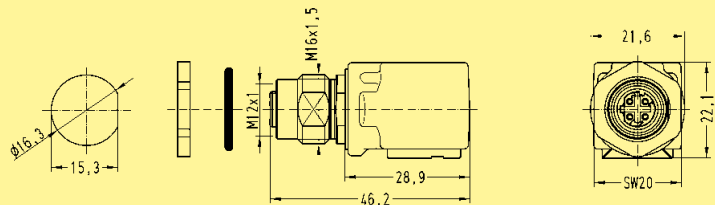

Han® M12 female-RJ45
panel feed-through

4-poles,
D-coded,
straight



21 03 381 2400

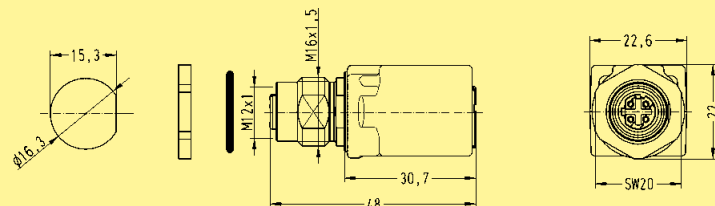

Han® M12 male-RJ45
adapter

4-poles,
D-coded,
straight



21 03 371 1420

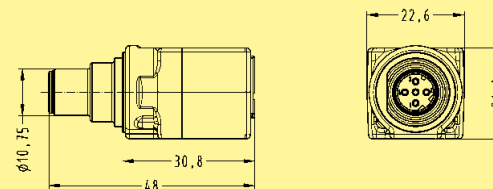

Han® M12
Gender Changer

4-poles, D-coded



21 03 381 6405

