

Features

Unregulated Converters

- UL/CSA and EN-60950-1 Safety certified
- EN-60601 for Medical Applications
- 6kVDC Isolation
- Optional Continuous Short Circuit Protection
- Efficiency up to 82%
- Space Saving „Skinny DIP“ Package
- Very Low Isolation Capacitance
- Suitable for IGBT Applications

Selection Guide

Part Number	Input Voltage (VDC)	Output Voltage (VDC)	Output Current (mA)	Efficiency Std (%)	Max Capacitive Load ⁽¹⁾
RV-xx3.3S*	3.3, 5, 12, 15, 24	3.3	600	70	3300µF
RV-xx05S*	3.3, 5, 12, 15, 24	5	400	70-75	1200µF
RV-xx09S*	3.3, 5, 12, 15, 24	9	222	70-75	1200µF
RV-xx12S*	3.3, 5, 12, 15, 24	12	167	70-75	680µF
RV-xx15S*	3.3, 5, 12, 15, 24	15	132	75-80	680µF
RV-xx24S*	3.3, 5, 12, 15, 24	24	83	75-80	220µF
RV-xx3.3D*	3.3, 5, 12, 15, 24	±3.3	±300	70	±1500µF
RV-xx05D*	3.3, 5, 12, 15, 24	±5	±200	70-75	±470µF
RV-xx09D*	3.3, 5, 12, 15, 24	±9	±111	70-75	±470µF
RV-xx12D*	3.3, 5, 12, 15, 24	±12	±85	70-75	±220µF
RV-xx15D*	3.3, 5, 12, 15, 24	±15	±66	75-80	±220µF
RV-xx24D*	3.3, 5, 12, 15, 24	±24	±42	75-80	±100µF
RV-xx1509D	5, 12, 24	+15/-9	+67/-111	70-82	±330µF

xx = Input Voltage. Other input and output voltage combinations available on request.

* add Suffix "P" for Continuous Short Circuit Protection, e.g. RV-0505S/P, RV-0505D/P

Specifications (measured at $T_A = 25^\circ\text{C}$, nominal input voltage, full load and after warm-up)

Input Voltage Range	±10%	
Output Voltage Accuracy	±5%	
Line Voltage Regulation	1.2%/1% of V_{in} typ.	
Load Voltage Regulation (10% to 100% full load)	3.3V output types	20% max.
	5V output type	15% max.
	9V, 12V, 15V, 24V output types, RV-xx1509D	10% max.
Output Ripple and Noise (20MHz limited)	200mVp-p max.	
Operating Frequency	20kHz min. / 50kHz typ. / 85kHz max.	
	RV-xx1509D	20kHz min. / 47kHz typ.
Efficiency at Full Load	70% min. / 75% typ.	
Minimum Load = 0%	Specifications valid for 10% minimum load only.	
Isolation Voltage	(tested for 1 second)	6000VDC
	(rated for 1 minute)	3000VAC / 60Hz
Isolation Capacitance	2pF min. / 12pF max.	
Isolation Resistance	15 GΩ min.	
Short Circuit Protection	1 Second	
P-Suffix	Continuous	
Operating Temperature Range (free air convection, without derating)	-40°C to +90°C (see Graph)	
Storage Temperature Range	-55°C to +125°C	
Relative Humidity	95% RH	
Package Weight	9g	
Packing Quantity	15 pcs per Tube	
	cont.	

ECONOLINE

DC/DC-Converter

with 3 year Warranty

RECOM

2 Watt DIP24

Miniature Single & Dual Output

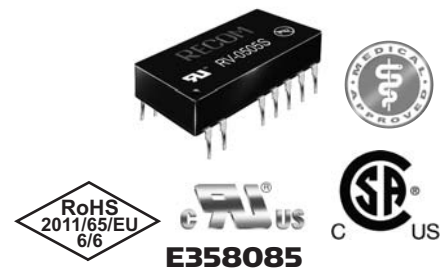

EN-60950-1 Certified
IEC/EN-60601-1 Certified*
UL/CSA 60950-1 Certified*
*** +15/-9 Version excluded**

RV

Description

Very high isolation in a small size are the main features of this miniature DIP24 converter, ideal for highly sophisticated industrial, test and measurement and medical designs where board space is at a premium.

Derating-Graph (Ambient Temperature)

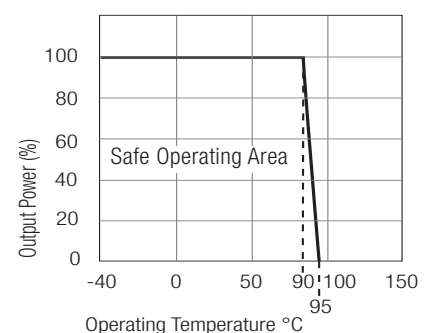

Refer to Application Notes

Tolerance Envelope

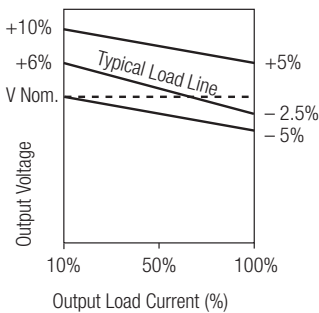

Specifications (continued)

MTBF (+25°C)	Detailed Information see Application Notes chapter "MTBF"	using MIL-HDBK 217F	1154 x 10 ³ hours
(+85°C)		using MIL-HDBK 217F	168 x 10 ³ hours
Certifications	UL/cUL General Safety	Report: E358085	UL 60950-1 2nd Ed.
	EN General Safety	Report: SPCLVD1109103	EN60950-1:2006 + A12: 2011
	EN Medical Safety	Report: SPCMDD1205098-4	IEC/EN60601-1:2006, 3rd Edition

Notes

Note 1 Maximum capacitive load is defined as the capacitive load that will allow start up in under 1 second without damage to the converter.

Typical Characteristics

RV-xx05S

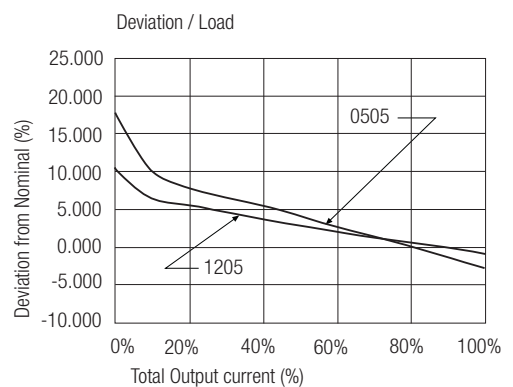
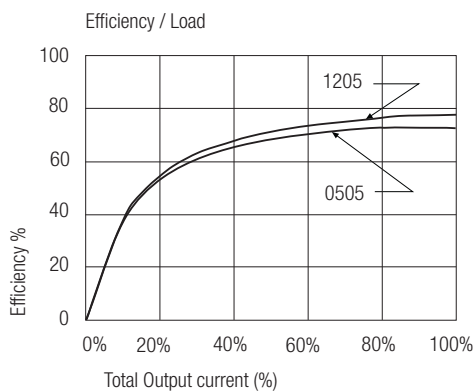

RV-xx12S

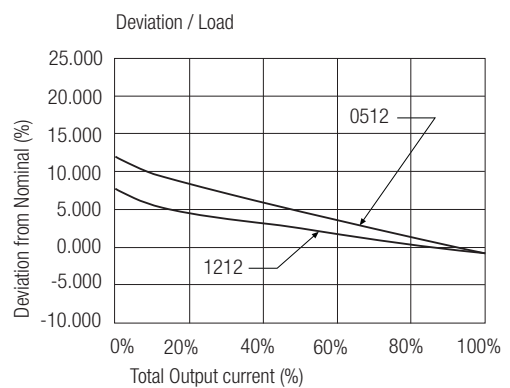
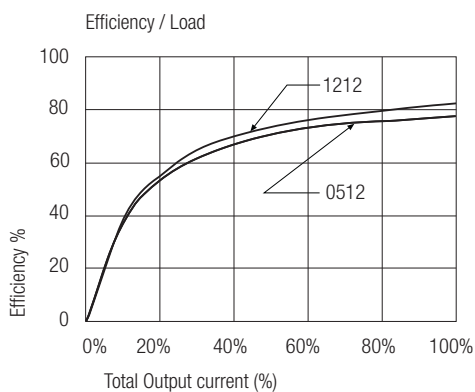

Typical Characteristics

RV-xx05D

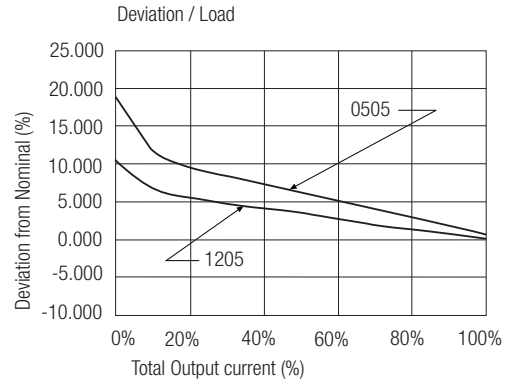
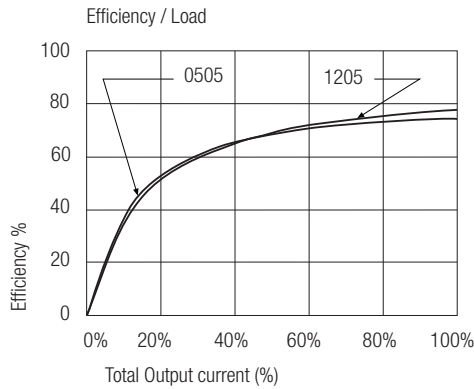

RV-xx12D

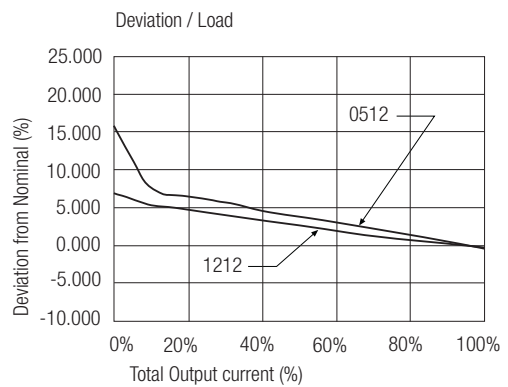
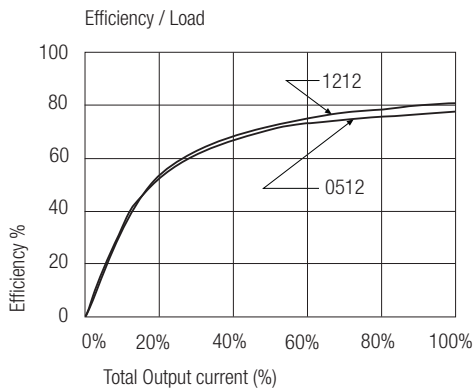

Applications

IGBT Application Circuit

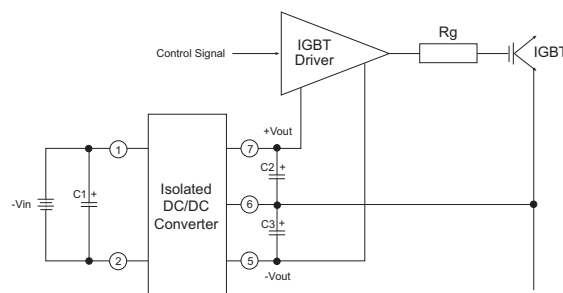

Package Style and Pinning (mm)



24 PIN DIP Miniature Package Style

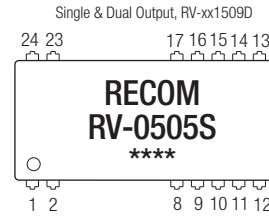
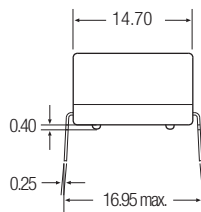
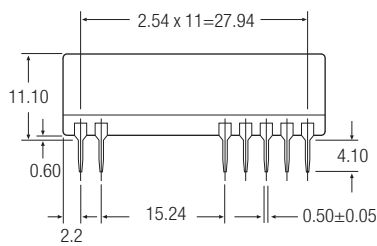

Recommended Footprint Details

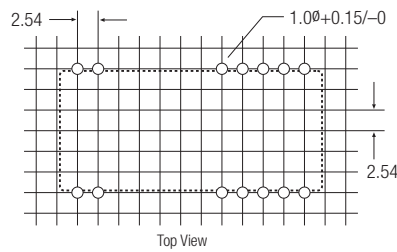
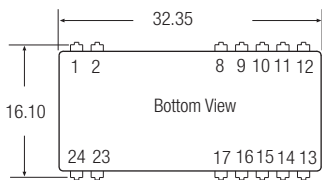

Pin Connections

Pin #	Single
1	+Vin
2	-Vin
8, 9, 11, 14	NC
10, 15	-Vout
12 & 13	+Vout
16, 17, 23, 24	NC

NC = No Connection

Pin Connections

Pin #	Dual
1	+Vin
2	-Vin
8, 17	-Vout
9, 11, 14, 16, 23, 24	NC
10 & 15	Com
12, 13	+Vout

NC = No Connection

XX.X ± 0.5 mm
XX.XX ± 0.25 mm