

RASPBERRY PI STYLE ENCLOSURES

Fitting of the PCB, Light Pipe and Pi-Face Digital Assembly

Light Pipe Assembly

1. Place your Pi-Face Digital top and base onto a steady surface.
2. Peel off the protective film on the light pipes.
3. Apply two drops of glue onto the recess. (We recommend using Everbuild stick 2 All Purpose Superglue)
4. Ensuring that the light pipe is in the correct orientation as shown, place into the recess and hold for five seconds ensuring that the light pipes are perpendicular to the enclosure top.

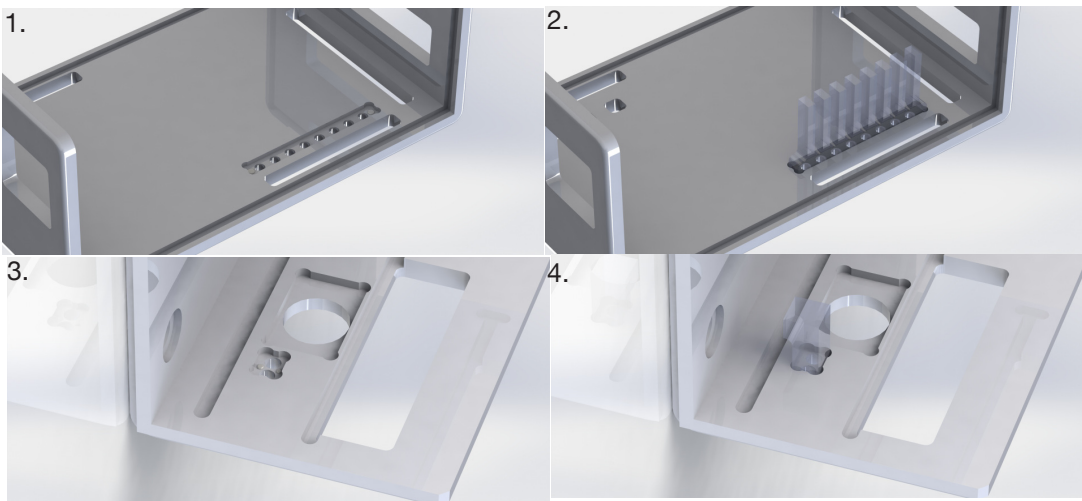

PCB Assembly

5. Place your Pi-Face Digital enclosure base onto a steady surface.
6. Tilting your Pi-Face Digital at 45° angle align the audio and RCA video ports with the machined holes in the base and push until the PCB clips into the PCB groove.
7. Push the opposite side of the PCB down so that it clips into the second PCB groove in the base.

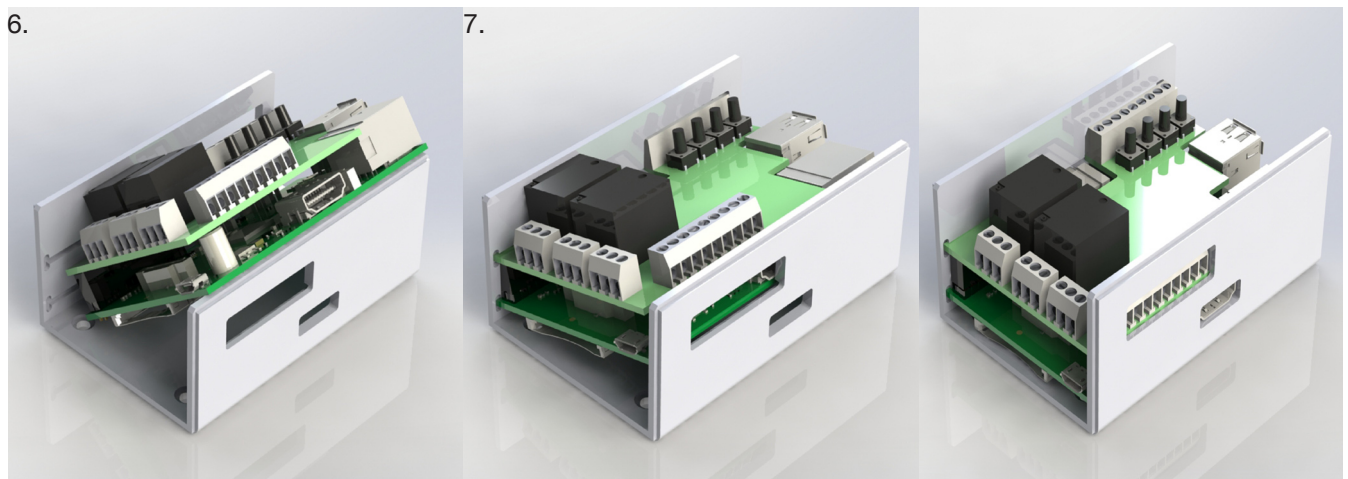

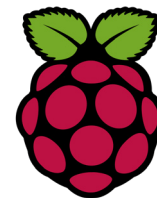

Pi-Face Digital Enclosure Assembly

8. Place your Raspberry Pi-Face Digital Enclosure on a steady surface.

9. Place your four supplied actuators into the locations shown below. (Ensure correct orientation)

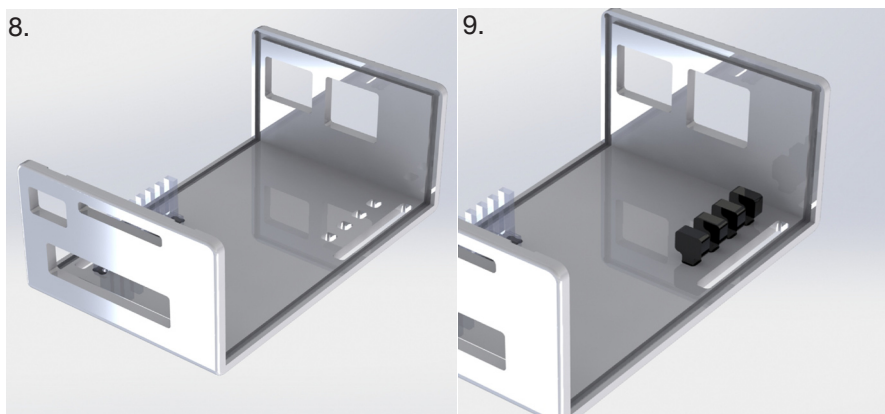

10. Hold the base upside down, in one hand (thumb on the audio connector, fingers over the HDMI connector) Align the USB connector with USB cut-out and clip over the USB and LAN connectors. Then clip the opposite end of the top onto the base.



11. Peel off the protective film on both the top and base of your enclosure. Push the supplied feet into place if required.



UNIVERSAL
ENCLOSURES

HAND
HELD
CASES

HEAVY
DUTY
ENCLOSURES

DIN
RAIL
BOXES

INTERFACE
SUPPORTS

CONTROL
STATIONS

DIECAST
& METAL
BOXES

DESKTOP &
INSTRUMENT
CASES

POTTING
BOXES

19"
ENCLOSURES

19"
SUBRACKS

CUSTOM
SIZED
ENCLOSURES

CUSTOM
SERVICES