

Filter Inductors, High Current, Radial Leaded



ELECTRICAL SPECIFICATIONS

Inductance: Measured at 1.0 V with zero DC current

Dielectric: 2500 V_{RMS} between winding and 0.250" [6.35 mm] of insulating covering edge (with optional insulating covering)

Current Rating: Maximum continuous operating current based on a + 50 °C temperature rise

Operating Temperature: - 55 °C to + 130 °C (no load),
- 55 °C to + 80 °C (at full rated current)

FEATURES

- Printed circuit mounting
- Wide range of inductance and current ratings
- Pre-tinned leads
- Optional polyolefin tubing and printing available at additional cost
- Compliant to RoHS Directive 2002/95/EC
- Halogen-free according to IEC 61249-2-21 definition



RoHS
COMPLIANT
HALOGEN
FREE

MECHANICAL SPECIFICATIONS

Terminals: Extensions of the winding wire, solder coated to within 0.063" [1.60 mm] of body

Mounting: Center hole for mechanical mounting, insulated bushings recommended for center hole mounting

DIMENSIONS in inches [millimeters]

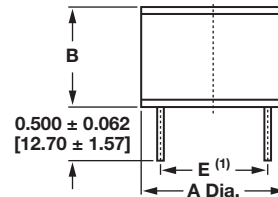
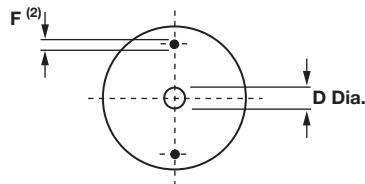

MODEL	A (MAX.)	B (MAX.)	D (MIN.)
IHB-1	0.660 [16.76]	0.840 [21.34]	0.115 [2.92]
IHB-2	0.825 [20.96]	0.840 [21.34]	0.115 [2.92]
IHB-3	1.100 [27.94]	0.840 [21.34]	0.115 [2.92]
IHB-4	1.600 [40.64]	1.030 [26.16]	0.175 [4.45]
IHB-5	1.600 [40.64]	1.450 [36.83]	0.175 [4.45]
IHB-6	2.000 [50.80]	1.500 [38.10]	0.240 [6.10]

Notes

(1) E varies between components, see individual model specifications for details, tolerance of ± 0.035

(2) F varies between components, see individual model specifications for details

STANDARD ELECTRICAL SPECIFICATIONS

MODEL	IND. AT 1 kHz (μH)	TOL. (%)	DCR MAX. (Ω)	RATED DC CURRENT (mA)	APPROX. LEAD "E" SPACING	MAXIMUM LEAD "F" DIAMETER
IHB-1	1.0	± 20	0.003	9000	0.450 [11.43]	0.045 [1.15]
IHB-1	1.2	± 20	0.003	9000	0.450 [11.43]	0.045 [1.15]
IHB-1	1.5	± 20	0.004	9000	0.450 [11.43]	0.045 [1.15]
IHB-1	1.8	± 20	0.004	9000	0.450 [11.43]	0.045 [1.15]
IHB-1	2.2	± 20	0.005	9000	0.450 [11.43]	0.045 [1.15]
IHB-1	2.7	± 20	0.005	9000	0.450 [11.43]	0.045 [1.15]
IHB-1	3.3	± 20	0.005	9000	0.450 [11.43]	0.045 [1.15]
IHB-1	3.9	± 20	0.006	9000	0.450 [11.43]	0.045 [1.15]
IHB-1	4.7	± 20	0.007	9000	0.450 [11.43]	0.045 [1.15]
IHB-1	5.6	± 20	0.007	9000	0.450 [11.43]	0.045 [1.15]
IHB-1	6.8	± 20	0.008	9000	0.450 [11.43]	0.045 [1.15]
IHB-1	8.2	± 20	0.009	9000	0.450 [11.43]	0.045 [1.15]
IHB-1	10	± 10	0.010	9000	0.450 [11.43]	0.045 [1.15]
IHB-1	12	± 10	0.011	9000	0.450 [11.43]	0.045 [1.15]
IHB-1	15	± 10	0.015	7200	0.450 [11.43]	0.040 [1.02]
IHB-1	18	± 10	0.016	7200	0.450 [11.43]	0.040 [1.02]
IHB-1	22	± 10	0.020	5500	0.450 [11.43]	0.040 [1.02]
IHB-1	27	± 10	0.030	4500	0.450 [11.43]	0.032 [0.812]
IHB-1	33	± 10	0.040	4000	0.475 [12.07]	0.028 [0.723]
IHB-1	39	± 10	0.046	4000	0.475 [12.07]	0.028 [0.723]



STANDARD ELECTRICAL SPECIFICATIONS						
MODEL	IND. AT 1 kHz (μH)	TOL. (%)	DCR MAX. (Ω)	RATED DC CURRENT (mA)	APPROX. LEAD "E" SPACING	MAXIMUM LEAD "F" DIAMETER
IHB-1	47	± 10	0.062	2800	0.470 [11.94]	0.025 [0.644]
IHB-1	56	± 10	0.069	2800	0.470 [11.94]	0.025 [0.644]
IHB-1	68	± 10	0.077	2800	0.500 [12.70]	0.025 [0.644]
IHB-1	82	± 10	0.083	2800	0.500 [12.70]	0.025 [0.644]
IHB-1	100	± 10	0.095	2800	0.500 [12.70]	0.025 [0.644]
IHB-1	120	± 10	0.127	2000	0.500 [12.70]	0.023 [0.573]
IHB-1	150	± 10	0.181	1600	0.500 [12.70]	0.020 [0.510]
IHB-1	180	± 10	0.217	1600	0.500 [12.70]	0.020 [0.510]
IHB-1	220	± 10	0.240	1600	0.500 [12.70]	0.020 [0.510]
IHB-1	270	± 10	0.300	1600	0.480 [12.19]	0.018 [0.455]
IHB-1	330	± 10	0.336	1300	0.480 [12.19]	0.018 [0.455]
IHB-1	390	± 10	0.460	1000	0.480 [12.19]	0.016 [0.405]
IHB-1	470	± 10	0.636	800	0.475 [12.07]	0.014 [0.361]
IHB-1	560	± 10	0.696	800	0.475 [12.07]	0.014 [0.361]
IHB-2	1.0	± 20	0.003	11 400	0.620 [15.75]	0.051 [1.29]
IHB-2	1.2	± 20	0.003	11 400	0.620 [15.75]	0.051 [1.29]
IHB-2	1.5	± 20	0.003	11 400	0.620 [15.75]	0.051 [1.29]
IHB-2	1.8	± 20	0.003	11 400	0.620 [15.75]	0.051 [1.29]
IHB-2	2.2	± 20	0.004	11 400	0.620 [15.75]	0.051 [1.29]
IHB-2	2.7	± 20	0.005	11 400	0.620 [15.75]	0.051 [1.29]
IHB-2	3.3	± 20	0.005	11 400	0.620 [15.75]	0.051 [1.29]
IHB-2	3.9	± 20	0.005	11 400	0.620 [15.75]	0.051 [1.29]
IHB-2	4.7	± 20	0.005	11 400	0.620 [15.75]	0.051 [1.29]
IHB-2	5.6	± 20	0.006	11 400	0.620 [15.75]	0.051 [1.29]
IHB-2	6.8	± 20	0.007	11 400	0.620 [15.75]	0.051 [1.29]
IHB-2	8.2	± 20	0.007	11 400	0.620 [15.75]	0.051 [1.29]
IHB-2	10	± 10	0.009	11 400	0.620 [15.75]	0.051 [1.29]
IHB-2	12	± 10	0.009	11 400	0.620 [15.75]	0.051 [1.29]
IHB-2	15	± 10	0.013	9000	0.620 [15.75]	0.045 [1.15]
IHB-2	18	± 10	0.018	7200	0.615 [15.62]	0.040 [1.02]
IHB-2	22	± 10	0.019	7200	0.615 [15.62]	0.040 [1.02]
IHB-2	27	± 10	0.026	5500	0.575 [14.61]	0.036 [0.912]
IHB-2	33	± 10	0.029	5500	0.575 [14.61]	0.036 [0.912]
IHB-2	39	± 10	0.030	5500	0.600 [15.24]	0.036 [0.912]
IHB-2	47	± 10	0.035	5500	0.600 [15.24]	0.036 [0.912]
IHB-2	56	± 10	0.039	5500	0.600 [15.24]	0.036 [0.912]
IHB-2	68	± 10	0.053	4800	0.600 [15.24]	0.032 [0.812]
IHB-2	82	± 10	0.060	4800	0.600 [15.24]	0.032 [0.812]
IHB-2	100	± 10	0.080	4000	0.600 [15.24]	0.028 [0.723]
IHB-2	120	± 10	0.090	4000	0.600 [15.24]	0.028 [0.723]
IHB-2	150	± 10	0.098	4000	0.600 [15.24]	0.028 [0.723]
IHB-2	180	± 10	0.110	4000	0.600 [15.24]	0.028 [0.723]
IHB-2	220	± 10	0.150	2800	0.600 [15.24]	0.025 [0.644]
IHB-2	270	± 10	0.213	2000	0.600 [15.24]	0.023 [0.573]
IHB-2	330	± 10	0.305	1600	0.600 [15.24]	0.020 [0.510]
IHB-2	390	± 10	0.320	1600	0.600 [15.24]	0.020 [0.510]
IHB-2	470	± 10	0.355	1600	0.590 [14.99]	0.020 [0.510]
IHB-2	560	± 10	0.388	1600	0.590 [14.99]	0.020 [0.510]
IHB-2	680	± 10	0.430	1600	0.590 [14.99]	0.020 [0.510]
IHB-2	820	± 10	0.590	1300	0.590 [14.99]	0.018 [0.455]
IHB-2	1000	± 10	0.818	1000	0.590 [14.99]	0.016 [0.405]
IHB-2	1200	± 10	1.140	800	0.590 [14.99]	0.014 [0.361]
IHB-2	1500	± 10	1.260	800	0.590 [14.99]	0.014 [0.361]
IHB-2	1800	± 10	1.390	800	0.590 [14.99]	0.014 [0.361]
IHB-2	2200	± 10	1.540	800	0.590 [14.99]	0.014 [0.361]
IHB-3	1.0	± 20	0.003	21 000	0.790 [20.07]	0.072 [1.83]
IHB-3	1.2	± 20	0.003	21 000	0.790 [20.07]	0.072 [1.83]
IHB-3	1.5	± 20	0.003	21 000	0.790 [20.07]	0.072 [1.83]
IHB-3	1.8	± 20	0.003	21 000	0.790 [20.07]	0.072 [1.83]
IHB-3	2.2	± 20	0.003	21 000	0.790 [20.07]	0.072 [1.83]
IHB-3	2.7	± 20	0.003	21 000	0.790 [20.07]	0.072 [1.83]
IHB-3	3.3	± 20	0.003	21 000	0.790 [20.07]	0.072 [1.83]
IHB-3	3.9	± 20	0.003	21 000	0.790 [20.07]	0.072 [1.83]
IHB-3	4.7	± 20	0.003	21 000	0.790 [20.07]	0.072 [1.83]
IHB-3	5.6	± 20	0.003	21 000	0.790 [20.07]	0.072 [1.83]
IHB-3	6.8	± 20	0.004	21 000	0.790 [20.07]	0.072 [1.83]
IHB-3	8.2	± 20	0.004	21 000	0.790 [20.07]	0.072 [1.83]
IHB-3	10	± 10	0.006	17 000	0.770 [19.56]	0.064 [1.63]
IHB-3	12	± 10	0.008	13 500	0.750 [19.05]	0.057 [1.45]
IHB-3	15	± 10	0.009	13 500	0.750 [19.05]	0.057 [1.45]



STANDARD ELECTRICAL SPECIFICATIONS						
MODEL	IND. AT 1 kHz (μH)	TOL. (%)	DCR MAX. (Ω)	RATED DC CURRENT (mA)	APPROX. LEAD "E" SPACING	MAXIMUM LEAD "F" DIAMETER
IHB-3	18	± 10	0.010	13 500	0.750 [19.05]	0.057 [1.45]
IHB-3	22	± 10	0.011	13 500	0.750 [19.05]	0.057 [1.45]
IHB-3	27	± 10	0.012	13 500	0.800 [20.32]	0.057 [1.45]
IHB-3	33	± 10	0.017	13 500	0.780 [19.81]	0.051 [1.29]
IHB-3	39	± 10	0.022	11 400	0.780 [19.81]	0.051 [1.29]
IHB-3	47	± 10	0.024	9000	0.760 [19.30]	0.045 [1.15]
IHB-3	56	± 10	0.026	9000	0.760 [19.30]	0.045 [1.15]
IHB-3	68	± 10	0.029	9000	0.760 [19.30]	0.045 [1.15]
IHB-3	82	± 10	0.032	9000	0.760 [19.30]	0.045 [1.150]
IHB-3	100	± 10	0.034	9000	0.760 [19.30]	0.045 [1.150]
IHB-3	120	± 10	0.046	7200	0.740 [18.80]	0.040 [1.020]
IHB-3	150	± 10	0.064	5500	0.720 [18.29]	0.036 [0.912]
IHB-3	180	± 10	0.072	5500	0.720 [18.29]	0.036 [0.912]
IHB-3	220	± 10	0.080	5500	0.790 [20.07]	0.036 [0.912]
IHB-3	270	± 10	0.110	4500	0.770 [19.56]	0.032 [0.812]
IHB-3	330	± 10	0.122	4500	0.770 [19.56]	0.032 [0.812]
IHB-3	390	± 10	0.169	4000	0.740 [18.80]	0.028 [0.723]
IHB-3	470	± 10	0.187	4000	0.740 [18.80]	0.028 [0.723]
IHB-3	560	± 10	0.205	4000	0.740 [18.80]	0.028 [0.723]
IHB-3	680	± 10	0.256	2800	0.725 [18.42]	0.025 [0.644]
IHB-3	820	± 10	0.288	2800	0.725 [18.42]	0.025 [0.644]
IHB-3	1000	± 10	0.426	2000	0.715 [18.16]	0.023 [0.573]
IHB-3	1200	± 10	0.462	2000	0.760 [19.30]	0.023 [0.573]
IHB-3	1500	± 10	0.518	2000	0.760 [19.30]	0.023 [0.573]
IHB-3	1800	± 10	0.705	1600	0.740 [18.80]	0.020 [0.510]
IHB-3	2200	± 10	1.020	1300	0.720 [18.29]	0.018 [0.455]
IHB-3	2700	± 10	1.140	1300	0.720 [18.29]	0.018 [0.455]
IHB-3	3300	± 10	1.270	1300	0.720 [18.29]	0.018 [0.455]
IHB-3	3900	± 10	1.670	1000	0.700 [17.78]	0.016 [0.405]
IHB-3	4700	± 10	1.860	1000	0.730 [18.54]	0.016 [0.405]
IHB-4	1.8	± 20	0.002	27 000	1.10 [27.94]	0.072 [1.83]
IHB-4	2.2	± 20	0.002	27 000	1.10 [27.94]	0.072 [1.83]
IHB-4	2.7	± 20	0.003	27 000	1.10 [27.94]	0.072 [1.83]
IHB-4	3.3	± 20	0.003	27 000	1.10 [27.94]	0.072 [1.83]
IHB-4	3.9	± 20	0.003	27 000	1.10 [27.94]	0.072 [1.83]
IHB-4	4.7	± 20	0.003	27 000	1.10 [27.94]	0.072 [1.83]
IHB-4	5.6	± 20	0.004	27 000	1.10 [27.94]	0.072 [1.83]
IHB-4	6.8	± 20	0.004	27 000	1.10 [27.94]	0.072 [1.83]
IHB-4	8.2	± 20	0.004	27 000	1.10 [27.94]	0.072 [1.83]
IHB-4	10	± 10	0.005	27 000	1.10 [27.94]	0.072 [1.83]
IHB-4	12	± 10	0.005	27 000	1.10 [27.94]	0.072 [1.83]
IHB-4	15	± 10	0.006	27 000	1.10 [27.94]	0.072 [1.83]
IHB-4	18	± 10	0.008	27 000	1.10 [27.94]	0.064 [1.63]
IHB-4	22	± 10	0.009	21 000	1.10 [27.94]	0.064 [1.63]
IHB-4	27	± 10	0.010	21 000	1.10 [27.94]	0.064 [1.63]
IHB-4	33	± 10	0.011	21 000	1.10 [27.94]	0.064 [1.63]
IHB-4	39	± 10	0.012	21 000	1.10 [27.94]	0.064 [1.63]
IHB-4	47	± 10	0.018	14 400	1.10 [27.94]	0.057 [1.45]
IHB-4	56	± 10	0.019	14 400	1.11 [28.19]	0.057 [1.45]
IHB-4	68	± 10	0.021	14 400	1.11 [28.19]	0.057 [1.45]
IHB-4	82	± 10	0.023	14 400	1.11 [28.19]	0.057 [1.45]
IHB-4	100	± 10	0.025	14 400	1.11 [28.19]	0.057 [1.45]
IHB-4	120	± 10	0.028	14 400	1.11 [28.19]	0.057 [1.45]
IHB-4	150	± 10	0.040	11 400	1.10 [27.94]	0.051 [1.29]
IHB-4	180	± 10	0.045	11 400	1.10 [27.94]	0.051 [1.29]
IHB-4	220	± 10	0.050	11 400	1.10 [27.94]	0.051 [1.29]
IHB-4	270	± 10	0.056	11 400	1.10 [27.94]	0.051 [1.29]
IHB-4	330	± 10	0.074	11 400	1.16 [29.46]	0.045 [1.15]
IHB-4	390	± 10	0.082	9000	1.13 [28.70]	0.045 [1.15]
IHB-4	470	± 10	0.114	7200	1.13 [28.70]	0.040 [1.02]
IHB-4	560	± 10	0.125	7200	1.13 [28.70]	0.040 [1.02]
IHB-4	680	± 10	0.139	7200	1.13 [28.70]	0.040 [1.02]
IHB-4	820	± 10	0.154	7200	1.13 [28.70]	0.040 [1.02]
IHB-4	1000	± 10	0.216	5500	1.10 [27.94]	0.036 [0.912]
IHB-4	1200	± 10	0.232	5500	1.10 [27.94]	0.036 [0.912]
IHB-4	1500	± 10	0.324	4500	1.14 [28.96]	0.032 [0.812]
IHB-4	1800	± 10	0.360	4500	1.14 [28.96]	0.032 [0.812]
IHB-4	2200	± 10	0.494	4000	1.11 [28.19]	0.028 [0.723]
IHB-4	2700	± 10	0.555	4000	1.11 [28.19]	0.028 [0.723]
IHB-4	3300	± 10	0.773	2800	1.09 [27.69]	0.025 [0.644]



STANDARD ELECTRICAL SPECIFICATIONS						
MODEL	IND. AT 1 kHz (μH)	TOL. (%)	DCR MAX. (Ω)	RATED DC CURRENT (mA)	APPROX. LEAD "E" SPACING	MAXIMUM LEAD "F" DIAMETER
IHB-4	3900	± 10	0.845	2800	1.09 [27.69]	0.025 [0.644]
IHB-4	4700	± 10	1.140	2000	1.07 [27.18]	0.023 [0.573]
IHB-4	5600	± 10	1.600	2000	1.05 [26.67]	0.020 [0.510]
IHB-4	6800	± 10	1.760	1600	1.05 [26.67]	0.020 [0.510]
IHB-4	8200	± 10	1.950	1600	1.09 [27.69]	0.020 [0.510]
IHB-4	10 000	± 10	2.760	1300	1.07 [27.18]	0.018 [0.455]
IHB-4	12 000	± 10	3.040	1300	1.07 [27.18]	0.018 [0.455]
IHB-4	15 000	± 10	3.390	1300	1.07 [27.18]	0.018 [0.455]
IHB-5	1.8	± 20	0.002	35 000	1.13 [28.70]	0.081 [2.05]
IHB-5	2.2	± 20	0.002	35 000	1.13 [28.70]	0.081 [2.05]
IHB-5	2.7	± 20	0.002	35 000	1.13 [28.70]	0.081 [2.05]
IHB-5	3.3	± 20	0.002	35 000	1.13 [28.70]	0.081 [2.05]
IHB-5	3.9	± 20	0.003	35 000	1.13 [28.70]	0.081 [2.05]
IHB-5	4.7	± 20	0.003	35 000	1.13 [28.70]	0.081 [2.05]
IHB-5	5.6	± 20	0.003	35 000	1.13 [28.70]	0.081 [2.05]
IHB-5	6.8	± 20	0.003	35 000	1.13 [28.70]	0.081 [2.05]
IHB-5	8.2	± 20	0.003	35 000	1.13 [28.70]	0.081 [2.05]
IHB-5	10	± 10	0.004	35 000	1.13 [28.70]	0.081 [2.05]
IHB-5	12	± 10	0.004	35 000	1.13 [28.70]	0.081 [2.05]
IHB-5	15	± 10	0.005	35 000	1.13 [28.70]	0.081 [2.05]
IHB-5	18	± 10	0.007	27 000	1.10 [27.94]	0.072 [1.83]
IHB-5	22	± 10	0.007	27 000	1.10 [27.94]	0.072 [1.83]
IHB-5	27	± 10	0.008	27 000	1.10 [27.94]	0.072 [1.83]
IHB-5	33	± 10	0.009	27 000	1.10 [27.94]	0.072 [1.83]
IHB-5	39	± 10	0.010	27 000	1.10 [27.94]	0.072 [1.83]
IHB-5	47	± 10	0.011	27 000	1.10 [27.94]	0.072 [1.83]
IHB-5	56	± 10	0.013	21 000	1.10 [27.94]	0.072 [1.83]
IHB-5	68	± 10	0.015	21 000	1.10 [27.94]	0.072 [1.83]
IHB-5	82	± 10	0.017	21 000	1.10 [27.94]	0.072 [1.83]
IHB-5	100	± 10	0.018	21 000	1.10 [27.94]	0.072 [1.83]
IHB-5	120	± 10	0.022	17 000	1.08 [27.43]	0.064 [1.63]
IHB-5	150	± 10	0.025	17 000	1.08 [27.43]	0.064 [1.63]
IHB-5	180	± 10	0.035	13 500	1.12 [28.45]	0.057 [1.45]
IHB-5	220	± 10	0.040	13 500	1.12 [28.45]	0.057 [1.45]
IHB-5	270	± 10	0.044	13 500	1.12 [28.45]	0.057 [1.45]
IHB-5	330	± 10	0.049	13 500	1.12 [28.45]	0.057 [1.45]
IHB-5	390	± 10	0.070	11 400	1.09 [27.69]	0.051 [1.29]
IHB-5	470	± 10	0.078	11 400	1.09 [27.69]	0.051 [1.29]
IHB-5	560	± 10	0.105	9000	1.07 [27.18]	0.045 [1.15]
IHB-5	680	± 10	0.115	9000	1.07 [27.18]	0.045 [1.15]
IHB-5	820	± 10	0.127	9000	1.07 [27.18]	0.045 [1.15]
IHB-5	1000	± 10	0.176	7200	1.05 [26.67]	0.040 [1.02]
IHB-5	1200	± 10	0.195	7200	1.05 [26.67]	0.040 [1.02]
IHB-5	1500	± 10	0.274	5500	1.03 [26.16]	0.036 [0.912]
IHB-5	1800	± 10	0.302	5500	1.10 [27.94]	0.036 [0.912]
IHB-5	2200	± 10	0.338	5500	1.10 [27.94]	0.036 [0.912]
IHB-5	2700	± 10	0.459	4500	1.08 [27.43]	0.032 [0.812]
IHB-5	3300	± 10	0.642	4000	1.06 [26.92]	0.028 [0.723]
IHB-5	3900	± 10	0.699	4000	1.06 [26.92]	0.028 [0.723]
IHB-5	4700	± 10	0.775	4000	1.06 [26.92]	0.028 [0.723]
IHB-5	5600	± 10	0.843	4000	1.06 [26.92]	0.028 [0.723]
IHB-5	6800	± 10	1.150	2800	1.04 [26.42]	0.025 [0.644]
IHB-5	8200	± 10	1.260	2800	1.09 [27.69]	0.025 [0.644]
IHB-5	10 000	± 10	1.740	2000	1.07 [27.18]	0.023 [0.573]
IHB-5	12 000	± 10	1.920	2000	1.07 [27.18]	0.023 [0.573]
IHB-5	15 000	± 10	2.170	2000	1.07 [27.18]	0.023 [0.573]
IHB-6	4.7	± 20	0.002	35 000	1.43 [36.32]	0.102 [2.59]
IHB-6	5.6	± 20	0.002	35 000	1.43 [36.32]	0.102 [2.59]
IHB-6	6.8	± 20	0.003	35 000	1.43 [36.32]	0.102 [2.59]
IHB-6	8.2	± 20	0.003	35 000	1.43 [36.32]	0.102 [2.59]
IHB-6	10	± 10	0.003	35 000	1.43 [36.32]	0.102 [2.59]
IHB-6	12	± 10	0.004	35 000	1.43 [36.32]	0.102 [2.59]
IHB-6	15	± 10	0.004	35 000	1.43 [36.32]	0.102 [2.59]
IHB-6	18	± 10	0.005	35 000	1.43 [36.32]	0.102 [2.59]
IHB-6	22	± 10	0.005	35 000	1.43 [36.32]	0.102 [2.59]
IHB-6	27	± 10	0.006	35 000	1.43 [36.32]	0.102 [2.59]
IHB-6	33	± 10	0.006	35 000	1.43 [36.32]	0.102 [2.59]
IHB-6	39	± 10	0.006	35 000	1.43 [36.32]	0.102 [2.59]
IHB-6	47	± 10	0.008	35 000	1.53 [38.86]	0.102 [2.59]
IHB-6	56	± 10	0.009	35 000	1.53 [38.86]	0.102 [2.59]



STANDARD ELECTRICAL SPECIFICATIONS						
MODEL	IND. AT 1 kHz (μH)	TOL. (%)	DCR MAX. (Ω)	RATED DC CURRENT (mA)	APPROX. LEAD "E" SPACING	MAXIMUM LEAD "F" DIAMETER
IHB-6	68	± 10	0.009	35 000	1.53 [38.86]	0.102 [2.59]
IHB-6	82	± 10	0.010	35 000	1.53 [38.86]	0.102 [2.59]
IHB-6	100	± 10	0.014	27 000	1.45 [36.83]	0.081 [2.05]
IHB-6	120	± 10	0.015	27 000	1.45 [36.83]	0.081 [2.05]
IHB-6	150	± 10	0.023	21 000	1.41 [35.81]	0.072 [1.83]
IHB-6	180	± 10	0.025	21 000	1.41 [35.81]	0.072 [1.83]
IHB-6	220	± 10	0.028	21 000	1.41 [35.81]	0.072 [1.83]
IHB-6	270	± 10	0.030	21 000	1.41 [35.81]	0.072 [1.83]
IHB-6	330	± 10	0.040	17 000	1.38 [35.05]	0.064 [1.63]
IHB-6	390	± 10	0.055	13 500	1.35 [34.29]	0.057 [1.45]
IHB-6	470	± 10	0.061	13 500	1.35 [34.29]	0.057 [1.45]
IHB-6	560	± 10	0.068	13 500	1.35 [34.29]	0.057 [1.45]
IHB-6	680	± 10	0.094	11 400	1.33 [33.78]	0.051 [1.29]
IHB-6	820	± 10	0.104	11 400	1.33 [33.78]	0.051 [1.29]
IHB-6	1000	± 10	0.143	9000	1.31 [33.27]	0.045 [1.15]
IHB-6	1200	± 10	0.156	9000	1.40 [35.56]	0.045 [1.15]
IHB-6	1500	± 10	0.219	7200	1.37 [34.80]	0.040 [1.02]
IHB-6	1800	± 10	0.241	7200	1.37 [34.80]	0.040 [1.02]
IHB-6	2200	± 10	0.270	7200	1.37 [34.80]	0.040 [1.02]
IHB-6	2700	± 10	0.364	5500	1.34 [34.04]	0.036 [0.912]
IHB-6	3300	± 10	0.498	4500	1.32 [33.53]	0.032 [0.812]
IHB-6	3900	± 10	0.548	4500	1.32 [33.53]	0.032 [0.812]
IHB-6	4700	± 10	0.608	4500	1.32 [33.53]	0.032 [0.812]
IHB-6	5600	± 10	0.671	4500	1.38 [35.05]	0.032 [0.812]
IHB-6	6800	± 10	0.750	4500	1.38 [35.05]	0.032 [0.812]
IHB-6	8200	± 10	1.030	4000	1.35 [34.29]	0.028 [0.723]
IHB-6	10 000	± 10	1.160	4000	1.35 [34.29]	0.028 [0.723]
IHB-6	12 000	± 10	1.540	2800	1.33 [33.78]	0.025 [0.644]
IHB-6	15 000	± 10	1.750	2800	1.33 [33.78]	0.025 [0.644]
IHB-6	18 000	± 10	1.940	2800	1.38 [35.05]	0.025 [0.644]
IHB-6	22 000	± 10	2.740	2000	1.36 [34.54]	0.023 [0.573]
IHB-6	27 000	± 10	3.710	1700	1.33 [33.78]	0.020 [0.510]
IHB-6	33 000	± 10	4.160	1700	1.33 [33.78]	0.020 [0.510]
IHB-6	39 000	± 10	5.550	1400	1.31 [33.27]	0.018 [0.455]
IHB-6	47 000	± 10	6.190	1400	1.34 [34.04]	0.018 [0.455]

MARKING
- Model
- Value
- Date code

ORDERING INFORMATION				
MODEL	INDUCTANCE VALUE	INDUCTANCE TOLERANCE	PACKAGE CODE	JEDEC LEAD (Pb)-FREE STANDARD
IHB-1	10 μH	± 10 %	EB	e2

GLOBAL PART NUMBER			
<div style="display: flex; justify-content: space-around;"> <div style="border: 1px solid black; padding: 2px;">I</div> <div style="border: 1px solid black; padding: 2px;">H</div> <div style="border: 1px solid black; padding: 2px;">B</div> <div style="border: 1px solid black; padding: 2px;">1</div> </div> <p>MODEL</p>	<div style="display: flex; justify-content: space-around;"> <div style="border: 1px solid black; padding: 2px;">E</div> <div style="border: 1px solid black; padding: 2px;">B</div> </div> <p>PACKAGE CODE</p>	<div style="display: flex; justify-content: space-around;"> <div style="border: 1px solid black; padding: 2px;">1</div> <div style="border: 1px solid black; padding: 2px;">0</div> <div style="border: 1px solid black; padding: 2px;">0</div> </div> <p>INDUCTANCE VALUE</p>	<div style="border: 1px solid black; padding: 2px;">K</div> <p>INDUCTANCE TOLERANCE</p>



Disclaimer

ALL PRODUCT, PRODUCT SPECIFICATIONS AND DATA ARE SUBJECT TO CHANGE WITHOUT NOTICE TO IMPROVE RELIABILITY, FUNCTION OR DESIGN OR OTHERWISE.

Vishay Intertechnology, Inc., its affiliates, agents, and employees, and all persons acting on its or their behalf (collectively, "Vishay"), disclaim any and all liability for any errors, inaccuracies or incompleteness contained in any datasheet or in any other disclosure relating to any product.

Vishay makes no warranty, representation or guarantee regarding the suitability of the products for any particular purpose or the continuing production of any product. To the maximum extent permitted by applicable law, Vishay disclaims (i) any and all liability arising out of the application or use of any product, (ii) any and all liability, including without limitation special, consequential or incidental damages, and (iii) any and all implied warranties, including warranties of fitness for particular purpose, non-infringement and merchantability.

Statements regarding the suitability of products for certain types of applications are based on Vishay's knowledge of typical requirements that are often placed on Vishay products in generic applications. Such statements are not binding statements about the suitability of products for a particular application. It is the customer's responsibility to validate that a particular product with the properties described in the product specification is suitable for use in a particular application. Parameters provided in datasheets and/or specifications may vary in different applications and performance may vary over time. All operating parameters, including typical parameters, must be validated for each customer application by the customer's technical experts. Product specifications do not expand or otherwise modify Vishay's terms and conditions of purchase, including but not limited to the warranty expressed therein.

Except as expressly indicated in writing, Vishay products are not designed for use in medical, life-saving, or life-sustaining applications or for any other application in which the failure of the Vishay product could result in personal injury or death. Customers using or selling Vishay products not expressly indicated for use in such applications do so at their own risk. Please contact authorized Vishay personnel to obtain written terms and conditions regarding products designed for such applications.

No license, express or implied, by estoppel or otherwise, to any intellectual property rights is granted by this document or by any conduct of Vishay. Product names and markings noted herein may be trademarks of their respective owners.

Material Category Policy

Vishay Intertechnology, Inc. hereby certifies that all its products that are identified as RoHS-Compliant fulfill the definitions and restrictions defined under Directive 2011/65/EU of The European Parliament and of the Council of June 8, 2011 on the restriction of the use of certain hazardous substances in electrical and electronic equipment (EEE) - recast, unless otherwise specified as non-compliant.

Please note that some Vishay documentation may still make reference to RoHS Directive 2002/95/EC. We confirm that all the products identified as being compliant to Directive 2002/95/EC conform to Directive 2011/65/EU.

Vishay Intertechnology, Inc. hereby certifies that all its products that are identified as Halogen-Free follow Halogen-Free requirements as per JEDEC JS709A standards. Please note that some Vishay documentation may still make reference to the IEC 61249-2-21 definition. We confirm that all the products identified as being compliant to IEC 61249-2-21 conform to JEDEC JS709A standards.