

# PCB TERMINAL BLOCKS

## 7.5mm Pitch Standard Profile Rising Clamp Terminal

- 2 & 3 pole double interlocking mechanism for increased strength
- 4-12 pole solid block
- Moulded in green UL94-V0 flame retardant PA
- Professional rising clamp terminals
- 0.2-4.0mm<sup>2</sup> (30-12AWG) solid cable
- 0.2-2.5mm<sup>2</sup> (30-12AWG) stranded cable
- Guided pin alignment
-  approved



TYPE NO.	POLES	LENGTH
CTB0110/2	2	15mm
CTB0110/3	3	22.5mm
CTB0110/4	4	30mm
CTB0110/5	5	37.5mm
CTB0110/6	6	45mm
CTB0110/7	7	52.5mm
CTB0110/8	8	60mm
CTB0110/9	9	67.5mm
CTB0110/10	10	75mm
CTB0110/11	11	82.5mm
CTB0110/12	12	90mm

### SPECIFICATION

Rating	24A/500V
	UL=14A/300V, VDE&IMQ=24A/750V
Dielectric strength	≥3kV
Impulse withstand voltage	6kV
Working temperature	110°C
Moulding	UL94-V0 flame retardant PA
Pin/terminal	Tinned, nickel plated brass
Wire clamp	Nickel plated brass
Screw/torque	M3 steel zinc plated, 0.5Nm
Recommended PCB hole size	ø1.3mm

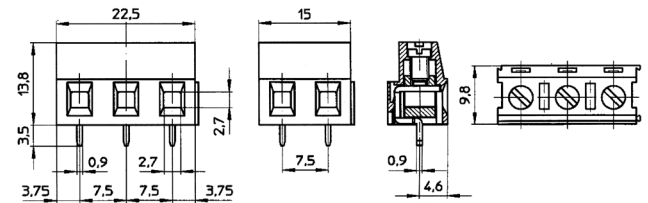

## 7.5mm Pitch Standard Profile 90° Rising Clamp Terminal

- 2 & 3 pole double interlocking mechanism for increased strength
- 4-12 pole pre-assembled
- Moulded in green UL94-V0 flame retardant PA
- Professional rising clamp terminals
- 0.2-4.0mm<sup>2</sup> (30-12AWG) solid cable
- 0.2-2.5mm<sup>2</sup> (30-12AWG) stranded cable
- Guided pin alignment
-  approved



TYPE NO.	POLES	LENGTH
CTB0115/2	2	15mm
CTB0115/3	3	22.5mm
CTB0115/4	4	30mm
CTB0115/5	5	37.5mm
CTB0115/6	6	45mm
CTB0115/7	7	52.5mm
CTB0115/8	8	60mm
CTB0115/9	9	67.5mm
CTB0115/10	10	75mm
CTB0115/11	11	82.5mm
CTB0115/12	12	90mm

### SPECIFICATION

Rating	24A/750V
	UL=14A/300V, VDE&IMQ=24A/750V
Dielectric strength	≥3kV
Insulation resistance	≥5MΩ
Working temperature	125°C
Moulding	UL94-V0 flame retardant PA
Pin/terminal	Tinned, nickel plated brass
Wire clamp	Nickel plated brass
Screw/torque	M3 steel zinc plated, 0.5Nm
Recommended PCB hole size	ø1.3mm

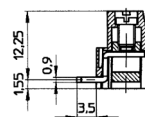

For other dimensions see CTB0110