



M83723/59-2, M83723/60-2, MS27293 and MS29295 Protective Plug and Receptacle Covers Bayonet Coupling

CONNECTOR INTERFACE
MIL-DTL-83723 Bayonet

Superseded Part Number

| | |
|---|-------------|
| Basic Part Number MS27293 = Plug Cover MS27295 = Receptacle Cover | Dash Number |
| MS27293 | - 1 |

See Note 3

| | | |
|---|--------------------------------|--|
| Basic Part Number M83723/59-2 = Plug Cover M83723/60-2 = Receptacle Cover | Shell Size 10 | Attachment Style C = 5.0" (127.0) Chain P = 8.0" (203.2) Chain R = 5.0" (127.0) Rope T = 8.0" (203.2) Rope N = No Attachment |
| M83723/59-2 | 10 | A C |
| Finish A = Black Anodize R = Electroless Nickel W = Cadmium over Electroless Nickel | | |

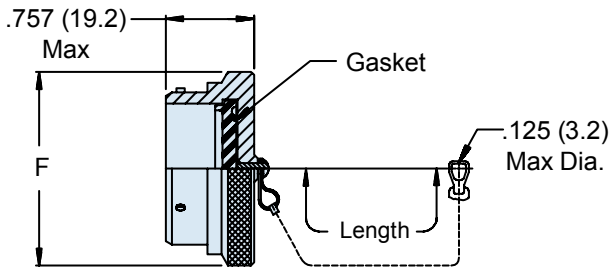

M83723/59-2 PLUG COVER
M27293 PLUG COVER (SEE NOTE 3)

TABLE I: Shell Size, Dash Number and Dimensions

| Shell Size | M27292 M27294 Dash No. | F Dia Max |
|------------|------------------------|--------------|
| 8 | 7 | .776 (19.7) |
| 10 | 1 | .906 (23.0) |
| 12 | 2 | 1.078 (27.4) |
| 14 | 3 | 1.141 (29.0) |
| 16 | 4 | 1.266 (32.2) |
| 18 | 5 | 1.375 (34.9) |
| 20 | 8 | 1.510 (38.4) |
| 22 | 6 | 1.625 (41.3) |
| 24 | 9 | 1.760 (44.7) |

M83723/59-2, M83723/60-2, MS27293 and MS29295
Protective Plug and Receptacle Covers
Bayonet Coupling

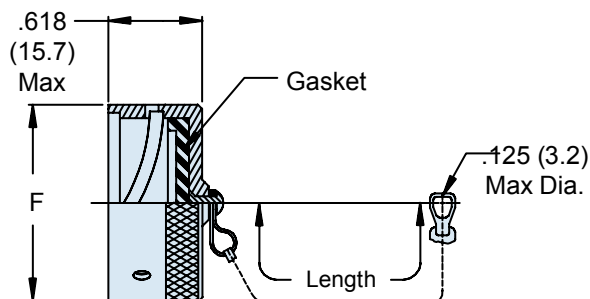

M83723/60-2 RECEPTACLE COVER
M27295 RECEPTACLE COVER (SEE NOTE 3)

APPLICATION NOTES

1. Assembly identified with manufacturer's name and part number, space permitting.
2. For complete dimensions, see the applicable Military Specification.
3. MS27293 and MS27295 have a black anodize finish. Dash numbers 1, 2 and 7 have a 3.0-inch (76.2) wire rope attachment. Other dash numbers have a 5-inch (127.0) wire rope attachment.
4. Metric dimensions (mm) are in parentheses.