

HAND HELD CASES

2955-40 Series Ergo Keyfobs

Ergonomically shaped ABS keyfobs with 1-5 rubber buttons and clear silicone LED window.

- Moulded in ABS
- Snap-fit assembly of lid and base
- 1 to 5 ergonomically shaped rubber buttons with contact pads
- Base incorporates a separate enclosed battery compartment for coin cells
- Eyelet for key-ring
- Clear silicone LED window



SPECIFICATION

Materials	Lid, base & adaptor ABS Push buttons silicone
Standard colours	Lid, base and adaptor black similar to RAL 9004 Push buttons light grey similar to RAL 7037
Standard unit includes	Lid & base Push-button insert Button adaptor

BLACK	DESCRIPTION
2955-40R-1	1 Button
2955-40R-2	2 Button
2955-40R-3	3 Button
2955-40R-4	4 Button
2955-40R-5	5 Button

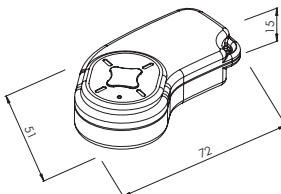

2955 Series Battery Holder

- Spring steel nickel-plated battery holder
- Fits 20mm coin cell lithium type battery (not included)

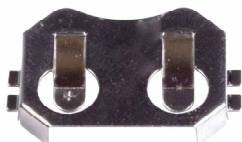

TYPE NO. DESCRIPTION

2955-BATT-HDR	20mm coin cell battery holder
---------------	-------------------------------

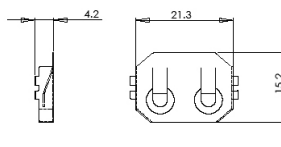

2956 Series Eco Keyfob Case

Economic ABS key fob with label recess in lid.

- Moulded in ABS
- Blank keyfob case (without buttons)
- Assembly of lid and base
- Small eyelet for key-ring
- Label recess in lid



SPECIFICATION

Materials	Lid & base ABS
Standard colours	Black similar to RAL 9004
Standard unit includes	Lid & base 2x screws

BLACK	LEGNTH	WIDTH	HEIGHT
2956	53mm	33mm	15mm

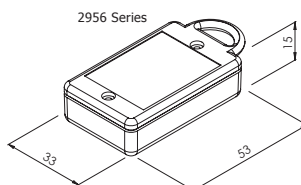

UNIVERSAL
ENCLOSURES

HAND
HELD
CASES

HEAVY
DUTY
ENCLOSURES

DIN
RAIL
BOXES

INTERFACE
SUPPORTS

CONTROL
STATIONS

DIECAST
& METAL
BOXES

DESKTOP &
INSTRUMENT
CASES

POTTING
BOXES

19"
ENCLOSURES

19"
SUBRACKS

CUSTOM
SIZED
ENCLOSURES

CUSTOM
SERVICES