

Eaton 9130 Tower UPS



Product snapshot

- Product rating:** 700–3000 VA
- Voltage:** 120 Vac, 208–240V
- Frequency:** 50/60 Hz (auto-sensing)
- Configuration:** Tower

Advanced power protection for:

- IT and networking environments
- Servers, networking gear
- Telecommunications, VoIP, security systems
- Medical systems
- Diagnostics and medical screening
- Patient record archives
- Manufacturing systems
- Chip fabrication
- Pharmaceutical production
- Chemical processing

Features

- Protects against downtime, data loss and process interruption by providing continuous, clean power
- Offers premium performance with a 0.9 power factor and >95 percent efficiency in high efficiency mode
- Increases battery service life and system uptime with ABM® battery charging technology
- Enables prolonged runtime of essential equipment during power outages by allowing for orderly, remote shutdown of non-critical systems or processes
- Conserves valuable space with a slim tower design
- Ensures data and system integrity with Intelligent Power® Manager supervisory software, which provides easy, versatile, remote monitoring and management of multiple devices
- Provides a two-year limited warranty, an extended warranty, on-site Flex and on-site PowerTrust service contracts, and a \$250,000 load protection guarantee (U.S. and Canada)

Maximum availability

- ABM technology increases battery life and system uptime
- Load segments allow for selective load shedding during outages
- Optional hot-swappable extended battery modules (EBMs) extend backup runtime for hours
- Internal hot-swappable batteries can be replaced without powering down the UPS
- UPS startup on battery power
- Optional HotSwap Maintenance Bypass (MBP) enables the entire UPS to be serviced or replaced without interrupting power to loads

Low total cost of ownership

- More real output power for dollar spent with 0.9 power factor
- Cuts energy usage and costs with >95% efficiency rating in high efficiency mode



Powering Business Worldwide





Bright LCD user interface



Add up to four EBMs for hours of runtime



Optional FlexPDU and HotSwap MBP for greater flexibility and uptime

UPS status and operation

- Bright, front panel LCD for easy monitoring and management
- LEDs to show system status
- Optional FlexPDU adds more plug-and-play flexibility, streamlining power distribution
- Multiple options for industry-standard communications
- Intelligent Power Manager supervisory software included free of charge
- Free NetWatch 5.0 software enables automatic shutdown of UPS-protected devices, including virtualized servers
- Direct monitoring via existing management systems and LANs

Communications

- A standard communication slot accepts interfaces for Web, SNMP, Modbus or serial connectivity
- Connect directly to the Ethernet network and the Internet to monitor and manage the UPS with a standard Web browser
- Monitor power conditions in real time through existing facilities or building management system
- Monitor and gracefully shut down multiple servers running various operating systems
- Receive alarm notifications from the UPS, environmental monitoring devices or security systems

For more information on the 9130, please visit www.eaton.com/9130 or call 800.356.5794.



Eaton NetWatch Client 5.0 has tested compatible with Cisco Unified Communications Manager 4.3. Go to www.eaton.com/PQ/cisco for disclaimer.

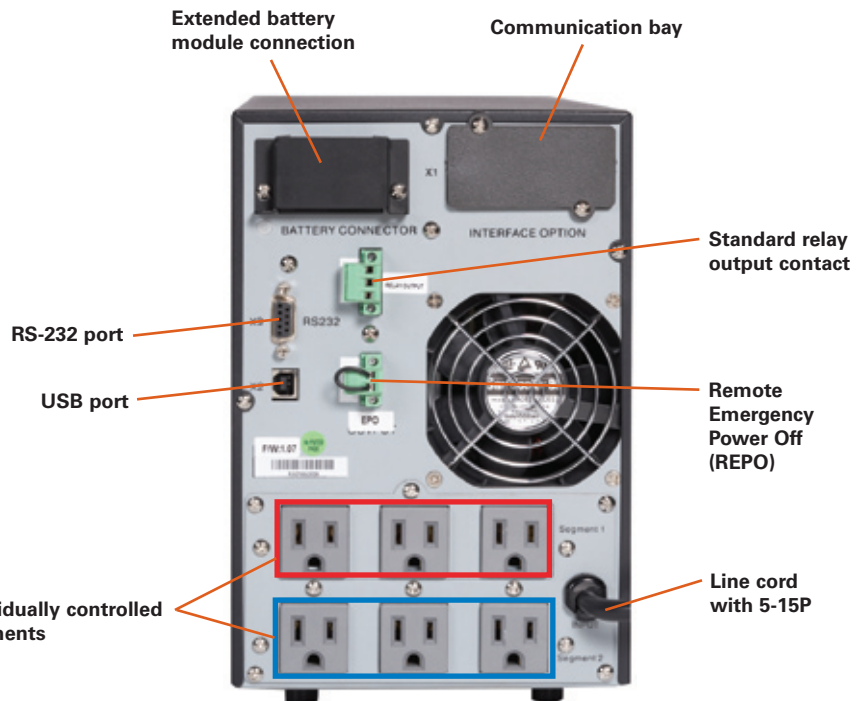

UPS rear panel (PW9130L1500T-XL)

Battery runtimes (in minutes)

Load (VA/Watts)	Internal batteries	w/1 EBM	w/2 EBMs	w/3 EBMs	w/4 EBMs	Load (VA/Watts)	Internal batteries	w/1 EBM	w/2 EBMs	w/3 EBMs	w/4 EBMs
PW9130L700T						PW9130i1500T-XL					
700/490	8	N/A	N/A	N/A	N/A	1500/1050	7	32	61	98	128
525/368	12	N/A	N/A	N/A	N/A	1125/788	11	47	83	126	195
350/245	21	N/A	N/A	N/A	N/A	750/525	18	81	143	208	262
175/123	37	N/A	N/A	N/A	N/A	375/263	38	171	298	416	564
PW9130i700T						PW9130L2000T-XL					
700/490	8	N/A	N/A	N/A	N/A	2000/1400	15	61	111	156	194
525/368	12	N/A	N/A	N/A	N/A	1500/1050	21	81	145	184	269
350/245	19	N/A	N/A	N/A	N/A	1000/700	34	129	198	293	410
175/123	35	N/A	N/A	N/A	N/A	500/350	72	225	449	590	766
PW9130L1000T-XL						PW9130G2000T-XL / XLEU / PW9130i2000T-XL					
1000/700	10	40	73	108	149	2000/1400	15	61	111	156	186
750/525	13	58	101	152	219	1500/1050	21	81	145	184	248
500/350	24	85	172	249	304	1000/700	34	129	198	293	431
250/175	48	190	310	451	569	500/350	72	225	449	590	840
PW9130G1000T-XL / XLEU / PW9130i1000T-XL						PW9130L3000T-XL					
1000/700	10	40	78	110	150	3000/2100	9	35	66	95	132
750/525	13	55	103	151	223	2250/1575	13	53	100	139	183
500/350	22	82	186	250	312	1500/1050	22	86	153	221	267
250/175	47	190	328	431	584	750/525	69	168	298	395	545
PW9130L1500T-XL						PW9130G3000T-XL / XLEU / PW9130i3000T-XL					
1500/1050	7	34	63	88	135	3000/2100	9	36	68	101	137
1125/788	11	44	84	129	210	2250/1575	12	49	90	134	165
750/525	18	79	148	207	267	1500/1050	20	79	143	180	240
375/263	38	167	278	475	540	750/525	46	161	267	434	547

Notes:

Backup times are approximate and may vary with equipment, configuration, battery age, temperature, etc.
Runtimes are shown at a 0.7 power factor.

9130 models

Catalog number	Style number	Rating (VA/Watts)	Input connection ¹	Output receptacles	Dimensions H x W x D, in (mm)	Weight, lb (kg)
North American models: 120V, 50/60 Hz						
PW9130L700T	103006426-6591	700/630	5-15P	(6) 5-15R	9.1 x 6.3 x 13.8 (230 x 160 x 350)	26.9 (12.2)
PW9130L1000T-XL	103006427-6591	1000/900	5-15P	(6) 5-15R	9.1 x 6.3 x 15.0 (230 x 160 x 380)	32.0 (14.5)
PW9130L1500T-XL	103006428-6591	1500/1350	5-15P	(6) 5-15R	9.1 x 6.3 x 16.9 (230 x 160 x 430)	41.9 (19.0)
PW9130L2000T-XL	103006429-6591	2000/1800	5-20P	(1) L5-20R, (4) 5-20R	12.8 x 8.4 x 16.1 (325 x 214 x 410)	76.1 (34.5)
PW9130L3000T-XL	103006430-6591	3000/2700	L5-30P	(4) 5-20R, (1) L5-30R	12.8 x 8.4 x 16.1 (325 x 214 x 410)	76.1 (34.5)
Global models: 208V, 50/60 Hz						
PW9130G1000T-XL	103006431-6591	1000/900	L6-20P ²	(1) L6-20R, (2) 6-20R	9.1 x 6.3 x 15.0 (230 x 160 x 380)	32.0 (14.5)
PW9130G2000T-XL	103006432-6591	2000/1800	L6-20P ²	(1) L6-20R, (4) 6-20R	12.8 x 8.4 x 16.1 (325 x 214 x 410)	76.1 (34.5)
PW9130G3000T-XL	103006446-6591	3000/2700	L6-20P ³	(1) L6-30R, (1) L6-20R, (2) 6-20R	12.8 x 8.4 x 16.1 (325 x 214 x 410)	76.1 (34.5)
PW9130G1000T-XLEU	103006477-6591	1000/900	L6-20P ²	(6) C13	9.1 x 6.3 x 15.0 (230 x 160 x 380)	32.0 (14.5)
PW9130G2000T-XLEU	103006478-6591	2000/1800	L6-20P ²	(8) C13, (1) C19	12.8 x 8.4 x 16.1 (325 x 214 x 410)	76.1 (34.5)
PW9130G3000T-XLEU	103006479-6591	3000/2700	L6-20P ³	(8) C13, (1) C19	12.8 x 8.4 x 16.1 (325 x 214 x 410)	76.1 (34.5)
International models: 230V, 50/60 Hz						
PW9130i700T	103006433-6591	700/630	C14	(6) C13	9.1 x 6.3 x 13.8 (230 x 160 x 350)	26.9 (12.2)
PW9130i1000T-XL	103006434-6591	1000/900	C14	(6) C13	9.1 x 6.3 x 15.0 (230 x 160 x 380)	32.0 (14.5)
PW9130i1500T-XL	103006435-6591	1500/1350	C14	(6) C13	9.1 x 6.3 x 16.9 (230 x 160 x 430)	41.9 (19.0)
PW9130i2000T-XL	103006436-6591	2000/1800	C14	(8) C13, (1) C19	12.8 x 8.4 x 16.1 (325 x 214 x 410)	76.1 (34.5)
PW9130i3000T-XL	103006437-6591	3000/2700	C20	(8) C13, (1) C19	12.8 x 8.4 x 16.1 (325 x 214 x 410)	76.1 (34.5)
Extended battery modules						
PW9130N1000T-EBM ⁴	103006438-6591	NA	NA	NA	9.1 x 6.3 x 15.0 (230 x 160 x 380)	40.8 (18.5)
PW9130N1500T-EBM ⁵	103006439-6591	NA	NA	NA	9.1 x 6.3 x 16.9 (230 x 160 x 430)	53.6 (24.3)
PW9130N3000T-EBM ⁶	103006440-6591	NA	NA	NA	12.8 x 8.4 x 16.1 (325 x 214 x 410)	110.3 (50.0)

¹ Input cord length is 6 ft

² C14, w/detachable L6-20P

³ C20, w/detachable L6-20P

⁴ This EBM works with 1000 VA model, where available

⁵ This EBM works with 1500 VA model

⁶ This EBM works with 2000/2500/3000 VA models, where available

Additional notes:

When high voltage 9130 is used at 208V, derate power by 10% and 20% at 200V
When low voltage 9130 is used at 110V, derate power by 10% and 20% at 100V

Comprehensive Eaton services available for 9130 Tower products

- Warranty+ extended warranties—3 or 5 years total
- On-site service plans for startups and preventive and corrective maintenance

Visit www.eaton.com/9130 for details.

Technical specifications¹

General		Communications																			
User interface	Graphical LCD with blue backlight and text in English, French, German, Russian and Spanish	Serial port	RS-232 standard, for interface to power management software																		
LEDs	Four status-indicating LEDs	USB port	HID standard, for communicating with Windows 98, XP, ME and Vista computers																		
Topology	True online, double-conversion	Relay output	Common alarm standard																		
Diagnostics	Full system self-test	Communications slot	Optional communication slots (BD Slot, Mini-Slot)																		
UPS bypass	Automatic bypass	Optional communication cards	SNMP/Web card for direct control and monitoring in SNMP-based networks, monitoring of UPS status and meters through Web browser interface Relay card for integration to industrial environment and building management systems, remote shutdown for IBM AS/400 systems																		
Dimensions	See models table																				
Remote Emergency Power-off (REPO)	Emergency shutdown control through the REPO port																				
Electrical input		Environmental																			
Nominal voltage	120V, 208V, 220–240V	Safety markings	120/208V: UL, CUL, VCCI 230V: CE, GS																		
Voltage range	120V: 90–138 Vac 208/230V: 160–276 Vac	EMC markings	120V: FCC Class B, EN55022 Class B (1.5 kVA and below); FCC Class A, EN55022 Class A (2.0 kVA and above) 230V: CE (per IEC/EN62040-2: Emissions, Category C1; Immunity, Category C2)																		
Power draw of UPS	700: 5.8A @120V, 3.4A @208V, 3.0A @230V 1000: 8.3A @120V, 4.8A @208V, 4.3A @230V 1500: 12.5A @120V, 7.2A @208V, 6.5A @230V 2000: 16.6A @120V, 9.6A @208V, 8.7A @230V 3000: 14.4A @208V, 13.0A @230V	Audible noise	<50 dB																		
Dedicated circuit breaker rating	120V: 700–1500 VA: 15A 2000 VA: 20A 3000 VA: 30A 208/230V: 700–2000 VA: 10A 3000 VA: 16A	Ambient operating temperature	0°C (32°F) to +40°C (104°F)																		
Frequency	50/60 Hz	Storage temperature	-20°C (-4°F) to +40°C (104°F) with batteries and -25°C (-13°F) to +55°C (131 °F) without batteries																		
Frequency range	45–65 Hz	Relative humidity	5–90% non-condensing																		
Electrical output		Heat dissipation for all voltages: 208–240V and 120V																			
Power factor	0.9	<table border="1"> <thead> <tr> <th>9130 model</th> <th>Normal mode, BTUs/hr</th> <th>On battery, BTUs/hr</th> </tr> </thead> <tbody> <tr> <td>700 VA</td> <td>350</td> <td>554</td> </tr> <tr> <td>1000 VA</td> <td>500</td> <td>674</td> </tr> <tr> <td>1500 VA</td> <td>750</td> <td>1,011</td> </tr> <tr> <td>2000 VA</td> <td>838</td> <td>1,348</td> </tr> <tr> <td>3000 VA</td> <td>1,257</td> <td>1,755</td> </tr> </tbody> </table>		9130 model	Normal mode, BTUs/hr	On battery, BTUs/hr	700 VA	350	554	1000 VA	500	674	1500 VA	750	1,011	2000 VA	838	1,348	3000 VA	1,257	1,755
9130 model	Normal mode, BTUs/hr			On battery, BTUs/hr																	
700 VA	350			554																	
1000 VA	500			674																	
1500 VA	750			1,011																	
2000 VA	838			1,348																	
3000 VA	1,257	1,755																			
On utility voltage regulation	±3% of nominal																				
On battery voltage regulation	±3% of nominal																				
Efficiency	>95% in high-efficiency mode; >86% in online mode																				
Frequency regulation	±3% Hz online																				
Load crest factor	3 to 1																				
Voltage waveform	Sine wave																				
Load segments	Two configurable, individually controlled receptacles																				
Battery																					
Battery type	VRLA 12V/9 Ah (both internal and external)																				
Battery runtime	>3 minutes with internal batteries @100% load																				
Battery replacement	Hot-swappable internal and external batteries																				
Start-on-battery	Allows start of UPS without utility input																				

¹ Due to continuing product improvement programs, specifications are subject to change without notice.

The 9130 is part of the UPSgrade program

UPSgrade™

www.eaton.com/UPSgrade



PowerChain Management®

UNITED STATES
8609 Six Forks Road
Raleigh, NC 27615 U.S.A.
Toll Free: 1.800.356.5794

www.eaton.com/powerquality

CANADA
Ontario: 416.798.0112
Toll free: 1.800.461.9166

LATIN AMERICA
Argentina: 54.11.4124.4000
Brazil: 55.11.3616.8500
Caribbean: 1.949.452.9610
Mexico & Central America:
52.55.9000.5252
South Cone: 54.11.4343.6323

EUROPE/MIDDLE EAST/AFRICA
Denmark: 45.3686.7910
Finland: 358.94.52.661
France: 33.1.6012.7400
Germany: 49.0.7841.604.0
Italy: 39.02.66.04.05.40
Norway: 47.23.03.65.50
Portugal: 55.11.3616.8500
Sweden: 46.8.598.940.00
United Kingdom: 44.1753.608.700

ASIA PACIFIC
Australia: 61.2.9693.9366
New Zealand: 64.0.3.343.3314
China: 86.21.6361.5599
HK/Korea/Taiwan: 852.2745.6682
India: 91.11.4223.2300
Singapore/SEA: 65.6825.1668

Eaton, Powerware, ABM, Intelligent Power, UPSgrade and PowerChain Management are trade names, trademarks and/or service marks of Eaton Corporation or its subsidiaries and affiliates. All other trademarks are property of their respective owners.

© 2009 Eaton Corporation
All Rights Reserved
Printed in USA
9130TFXA
July 2009



Powering Business Worldwide