

**Ordering number C12771_RER-7-S**

Family	Tampa	FWHM	19 degrees
Type	Lens array	Efficiency	89 %
LED	LUXEON Rebel ES	cd/lm	4.429
Color	Clear	Gerber File	Available
Diameter	38 mm		
Height	10.6 mm		
Style	Round		
Optic Material	PMMA		
Holder Material	-		
Fastening	Pin, glue		
Status	On production		

**Ordering number C11232_RER-7-MD**

Family	Tampa	FWHM	36 degrees
Type	Lens array	Efficiency	85 %
LED	LUXEON Rebel ES	cd/lm	-
Color	Clear	Gerber File	Available
Diameter	38 mm		
Height	10.6 mm		
Style	Round		
Optic Material	PMMA		
Holder Material	-		
Fastening	Pin, glue		
Status	On production		

**Ordering number C11230_RER-7-W**

Family	Tampa	FWHM	42 degrees
Type	Lens array	Efficiency	82 %
LED	LUXEON Rebel ES	cd/lm	-
Color	Clear	Gerber File	Available
Diameter	38 mm		
Height	10.6 mm		
Style	Round		
Optic Material	PMMA		
Holder Material	-		
Fastening	Pin, glue		
Status	On production		

**Ordering number C11231_RER-7-WW**

Family	Tampa	FWHM	52 degrees
Type	Lens array	Efficiency	90 %
LED	LUXEON Rebel ES	cd/lm	-
Color	Clear	Gerber File	Available
Diameter	38 mm		
Height	10.6 mm		
Style	Round		
Optic Material	PMMA		
Holder Material	-		
Fastening	Pin, glue		
Status	On production		



PRODUCT DATASHEET
Tampa series
last update 30/7/2012

PHILIPS
LUMILEDS

NOTE: The typical divergence will be changed by different color, chip size and chip position tolerance. The typical total divergence is the full angle measured where the luminous intensity is half of the peak value.



PRODUCT DATASHEET

Tampa series

last update 30/7/2012

PHILIPS
LUMILEDS

GENERAL INFORMATION

- Product series especially designed & optimized for LUXEON Rebel ES series of LEDs.
- Special care taken to make light distribution as uniform as possible.
- Lens material optical grade PMMA with high UV and temperature resistance. Allows use of high current and temperature conditions.

Please find more information about used material from below:

http://ledil.fi/sites/default/files/Documents/Technical/Material/PMMA%20N%20UL94_Yellow%20Card.pdf

<http://ledil.fi/sites/default/files/Documents/Technical/Material/PMMA%20N%20PLEXIGLAS-Datasheet.pdf>

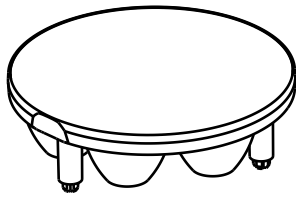

Isometric view
Scale: 1:1

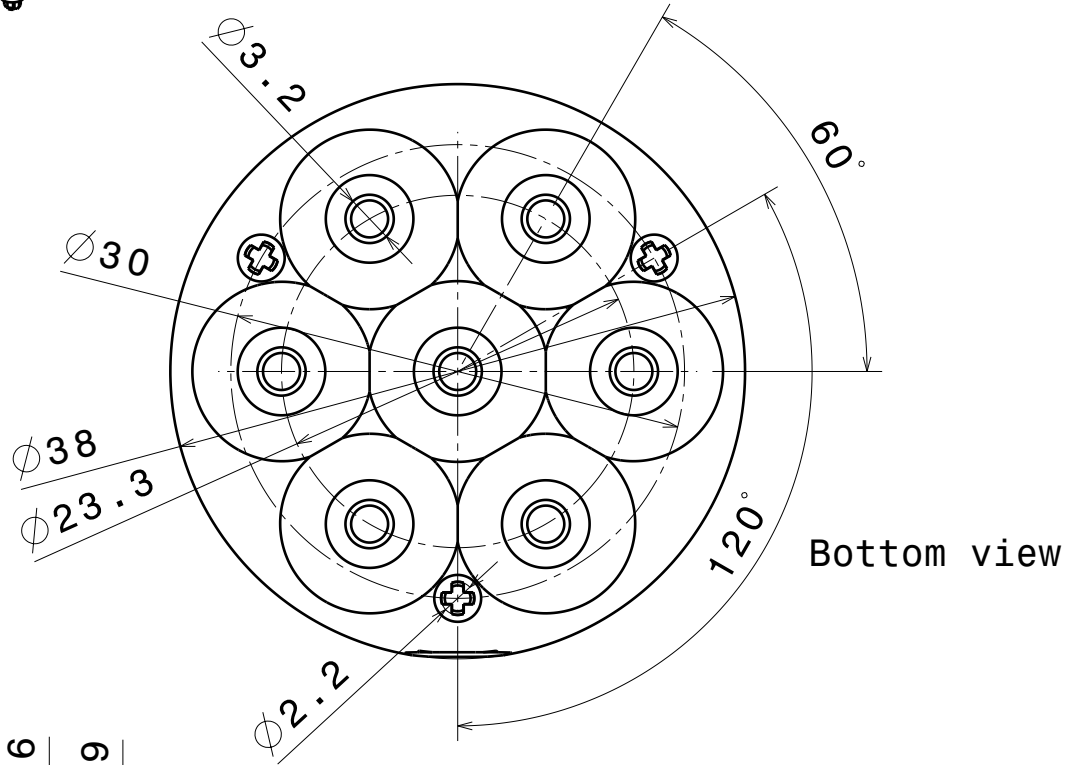

Bottom view

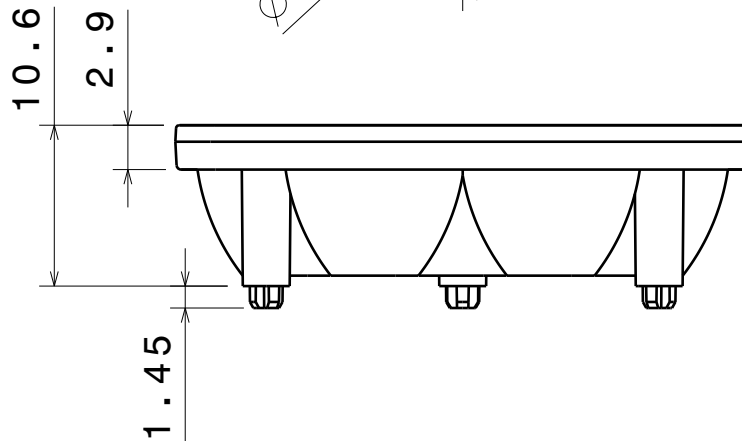

Front view

Material: PC, Lexan 915AU

Tolerances:

Dimensions less < 20mm ± 0.1 mm

Dimensions between (21-45)mm ± 0.2 mm

This drawing is our property.
It can't be reproduced
or communicated without
our written agreement.

LEDiL

Ledil Oy
Salorankatu 10
FIN 24240 SALO
Finland

DRAWING TITLE

Mechanical drawing

DRAWN BY

pv

DATE

02.11.2010

CHECKED BY

sn

DATE

-

SIZE

A4

PART NUMBER

-

REV

001

DESIGNED BY

hh

DATE

13.11.2009

SCALE

1:1

WEIGHT

-

SHEET

1/1

D

A