

THIS DOCUMENT CONTAINS PROPRIETARY DATA OF POLARIS INDUSTRIAL ENTERPRISES, INC. NO DISCLOSURE, REPRODUCTION, OR USE OF ANY PART THERE OF MAY BE MADE EXCEPT BY WRITTEN PERMISSION.

| | | | | | |
|------|----|------|---------|-----|-------|
| REV. | BY | DATE | APPRVL. | P/N | HSM22 |
|------|----|------|---------|-----|-------|

GENERAL SPECIFICATION:

CURRENT CONSUMPTION SINGLE OUTPUT ----- BELOW 16mA
 CURRENT CONSUMPTION DUAL OUTPUT----- BELOW 32mA
 INDEPENDENT LINEARITY TOL. ----- $\pm 0.5\%FS$ (FS=360°)
 MECHANICAL ROTATING ANGLE ----- 360°(ENDLESS)
 EFFECTIVE ELECTRICAL ANGLE ----- 360°(ENDLESS)
 APPLIED VOLTAGE ----- 5V $\pm 10\%$ D.C
 LOAD RESISTANCE ----- 10KOHMS MIN
 EFFECTIVE OUTPUT ----- 10% $\pm 3\%$ ~ 90% $\pm 3\%$ VIN
 OUTPUT TEMPERATURE CHARACT. ----- WITHIN $\pm 0.3\%$ OUT/FS
 OPERATING TEMPERATURE RANGE ----- -40°C ~ +120°C
 STORAGE TEMPERATURE RANGE ----- -40°C ~ +120°C
 MASS ----- APPROX 20g

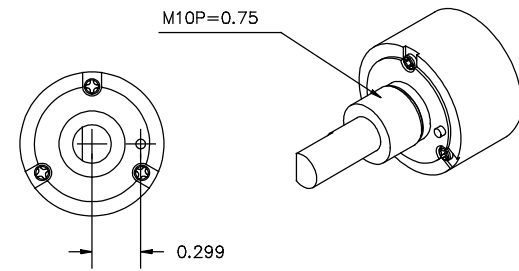
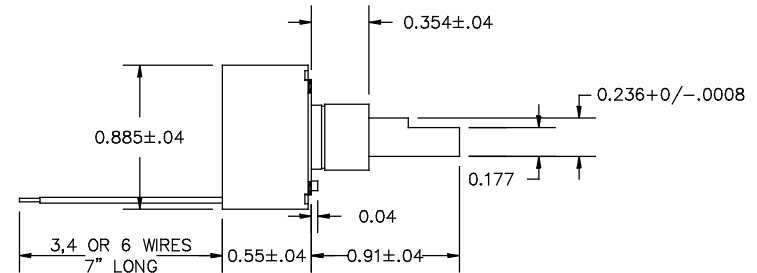

ENVIRONMENTAL SPECIFICATION:

ROTATING TORQUE ----- BELOW 5mN.m
 THERMAL SHOCK ----- 5 CYCLES -40°C ~ +105°C
 EXPOSURE TO LOW TEMPERATURE ----- 24 HOURS AT -40°C
 EXPOSURE AT HIGH TEMPERATURES ----- 1,000 HOURS AT +105°C
 VIBRATION ----- 10 ~ 2,000Hz 196m/s.s 12 HOURS
 SHOCK ----- 980m/s.s 6ms (18 TIMES)
 ROTATIONAL LIFE EXPECTANCY ----- APPROX. 50,000,000 REVOLUTIONS
 EMS TOLERANCE ----- 100V/m (80MHz ~ 1GHz 1KHz SIN WAVE 80% AMPLITUDE MODULATION)
 ESD TOLERANCE ----- $\pm 8KV$ CONTACT / $\pm 15KV$ AERIAL DISCHARGE

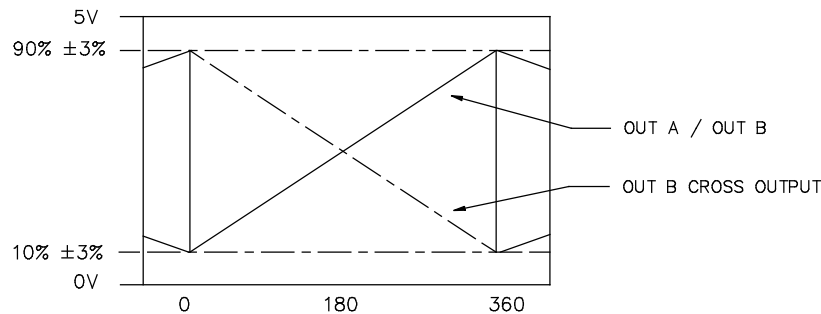

SINGLE OUTPUT DUAL OUTPUT DUAL INDEP. OUTPUT

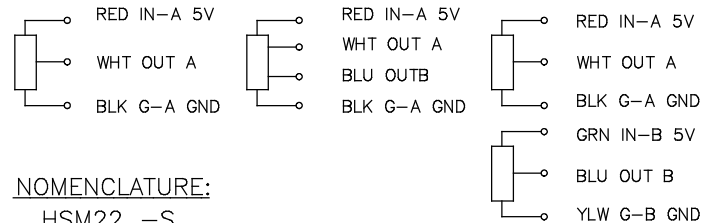

NOMENCLATURE:

HSM22 -S
 OUTPUT TYPE (S, X, P, IX OR IP)
 SERIES

TOLERANCES
 XX = +/- .010" FRACT. = +/- 1/64"
 XXX = +/- .005" ANGLES = +/- 1/2"
 ALL SPECIFICATIONS SUBJECT TO CHANGE WITHOUT NOTICE.

| | |
|-------------|--------------|
| SCALE | DATE: 5-3-13 |
| NONE | BY AT |
| | APPRV'D |
| CODE IDENT: | 19477 |



TITLE
 CONTACTLESS
 POTENTIOMETER

PART NO.
 HSM22