

**APPLICATION:**

Ammeters and wattmeters.

**FREQUENCY:**

50-400 Hz.

**INSULATION LEVEL:**

600 Volts, 10 kV BIL full wave.

Terminal are brass studs No. 8-32 with one flatwasher, lockwasher and regular nut.

Flexible leads are UL 1015, 105°C, CSA approved, #16 AWG, 24" long. Non-standard, lead length can be specified.

Order mounting bracket kit 0221B00180 separately for Model 5ASHT.

Model 5ASHT and model 5ASFT also available as 5ASHL and 5ASFL with leads.

Approximate weight 1 lb.

CATALOG NUMBER	CURRENT RATIO	V.A. ± 1% CLASS	ANSI METERING CLASS AT 60HZ					SECONDARY WINDING RESISTANCE (OHMS @ 75°C)	CONTINUOUS THERMAL RATING FACTOR	
			B0.1	B0.2	B0.5	B0.9	B1.8		@ 30°C	@ 55°C
5A**—500	50:5	1.0	4.8	—	—	—	—	0.009	2.0	2.0
5A**—750	75:5	1.0	2.4	4.8	—	—	—	0.010	2.0	2.0
5A**—101	100:5	1.0	1.2	2.4	—	—	—	0.012	2.0	2.0
5A**—151	150:5	5.0	0.6	1.2	2.4	4.8	—	0.019	2.0	2.0
5A**—201	200:5	5.0	0.6	0.6	1.2	2.4	4.8	0.024	2.0	2.0
5A**—251	250:5	12.5	0.6	0.6	1.2	2.4	2.4	0.033	2.0	1.5
5A**—301	300:5	15.0	0.3	0.3	0.6	1.2	2.4	0.040	2.0	1.5
5A**—401	400:5	20.0	0.3	0.3	0.6	1.2	1.2	0.091	1.5	1.0
5A**—501	500:5	25.0	0.3	0.3	0.6	0.6	1.2	0.105	1.33	0.8
5A**—601	600:5	30.0	0.3	0.3	0.6	0.6	1.2	0.158	1.0	0.8
5A**—751	750:5	30.0	0.3	0.3	0.6	0.6	0.6	0.147	1.0	0.8
5A**—801	800:5	30.0	0.3	0.3	0.6	0.6	0.6	0.156	1.0	0.8
5A**—102	1000:5	35.0	0.3	0.3	0.3	0.6	0.6	0.196	1.0	0.8
5A**—122	1200:5	40.0	0.3	0.3	0.3	0.3	0.6	0.291	1.0	0.6

\*\*Note: When ordering, prefix Cat No. with model designation required i.e. 5ASHT-501, 5ARL-501, etc.

# Model 5A

**Model 5ASFT**

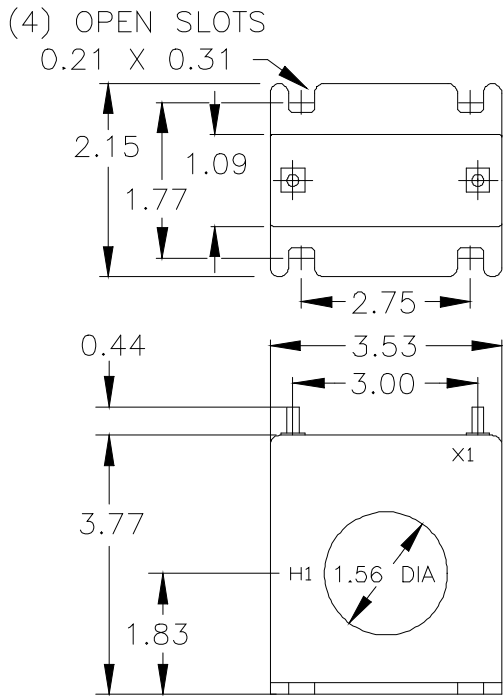

**Model 5ASHT**

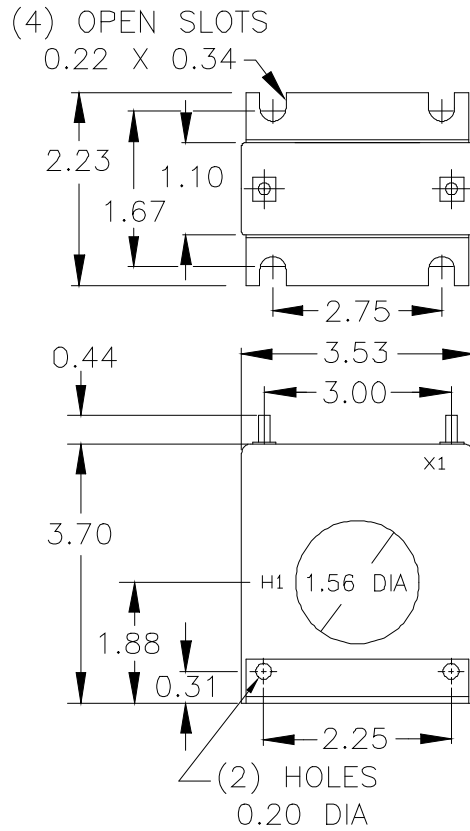

**Model 5ARL**

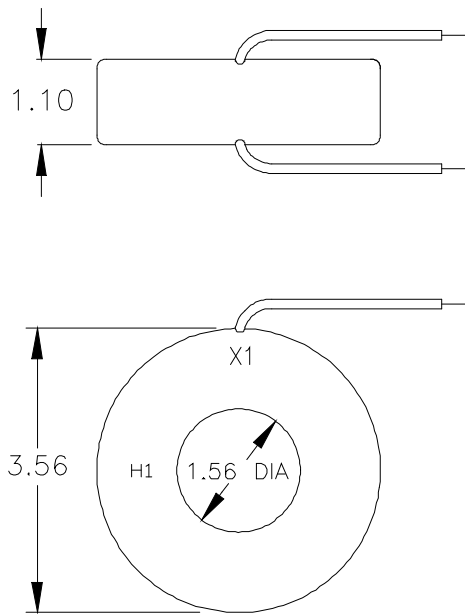

**USA, Canada, Asia, Latin America**

Tel: +1-800-547-8629

Fax: +1-905-201-2455

e-mail: [sales.multilin@ge.com](mailto:sales.multilin@ge.com)

**Europe, Middle East, Africa**

Tel: +34-94-485-88-00

Fax: +34-94-485-88-45

e-mail: [gemultilin.euro@ge.com](mailto:gemultilin.euro@ge.com)