

# Ground-Tite® Grounding Liquidtight Couplings

For Threaded RMC and IMC

## Type 4Q-FML

### Combination Couplings

#### Use:

Secures, grounds and seals liquidtight flexible metal conduit and terminates bonding conductor run externally alongside liquidtight conduit to threaded rigid conduit and IMC.

#### Features:

- Positive grounding type
- Liquidtight flexible metal conduit to threaded rigid conduit and IMC
- Female hub NPT
- Grounding lug is cast as an integral part of malleable iron gland nut. Provides high ground fault withstand capability
- Compact, slim diameter with small turning radius
- Furnished with locknut and KO sealing ring.
- Liquidtight/Raintight/Oiltight/Concretetight
- UL Listed NEMA Type 4 when installed into a NPT threaded entry or UL Listed conduit hub (sizes 1¼" and larger require thread sealant).

• Suitable for use in the following

#### Hazardous Locations:

- Class I, Div. 2 per NEC 501.4(B)
- Class I, Zone 2 per NEC 505.15(C)(2)
- Class II, Div. 1 per NEC 502.4(A)(1)(e)
- Class II, Div. 2 per NEC 502.4(B)(2)
- Class III, Div. 1 per NEC 503.3(A)(2)
- Class III, Div. 2 per NEC 503.3(B)

Intrinsically Safe per NEC 504.20

- Bonding Wedge Locknuts are recommended in Hazardous Locations. See 101 Series on Page DB8.

• Long ferrule prevents pull-out and tight bend conduit "pop-out"

\* Inspection windows in ferrule to ensure full engagement

- See Page GC4 for our patented Ferrule Wrench which makes ferrule installation easy.

#### Material/Finish:

Malleable Iron Body and Nut, Zinc Electroplated. Steel Ferrule, Zinc Electroplated.

#### Optional Finish:

Hot Dip or Mechanical Galvanize, add suffix "G" to catalog number. Contact your local representative for pricing and availability.

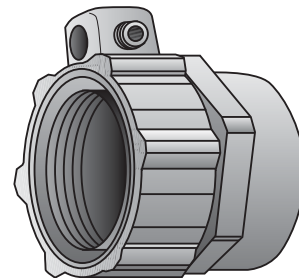
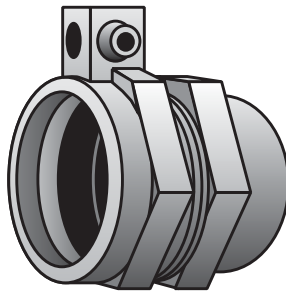

Type 4Q-38FML — Type 4Q-200FML

Type 4Q-250FML — Type 4Q-500FML

Trade Size (inches)	Catalog Number	Dimensions in Inches			Turning Radius Gland Nut	Wire Size	
		A	B	C		Min.	Max.
3/8 (1/2 KO)	4Q-38FML	1 1/16	1 3/16	1 11/16	1 1/8	14	4
1/2	4Q-50FML	1 3/8	1 1/2	1 7/8	1 1/4	14	4
3/4	4Q-75FML	1 7/8	1 7/8	2 1/8	1 3/4	14	4
1	4Q-100FML	1 5/8	1 13/16	2 3/8	1 7/8	14	4
1 1/4	4Q-125FML	2	2 5/16	2 7/8	1 3/4	6	1/0
1 1/2	4Q-150FML	2 1/16	2 3/8	3 1/4	1 7/8	6	1/0
2	4Q-200FML	2 5/16	3 1/16	3 3/4	2 1/16	6	1/0
2 1/2	4Q-250FML	3 3/16	3 3/8	4 5/8	2 3/4	1	4/0
3	4Q-300FML	3 3/8	4 3/8	5 1/16	3 1/16	1	4/0
3 1/2	4Q-350FML	3 7/8	5 1/16	5 7/8	3 3/8	1	4/0
4	4Q-400FML	3 11/16	5 3/4	6 1/2	3 7/8	1	4/0
5	4Q-500FML	3 7/8	6 3/8	7 1/2	4 3/16	1	4/0

\*UL Listing not applicable

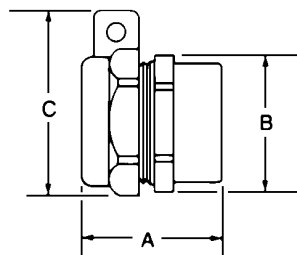

#### Third Party Certification:



UL Listed: E-24264



CSA Certified: 009795

#### Applicable Third Party Standards:

UL Standard: 467  
CSA Standard: C22.2 No. 41  
NEMA: FB-1  
Federal Spec: W-F-406E

PATENTED

(All types this page)