

# HAND HELD CASES

## 2955 Series Keyfob

A range of keyfob enclosures dedicated to RF activated mobile applications such as hand-held transmitters and manual control units. The snap-fit design allows an uncomplicated and secure assembly.



Round Keyfobs  
2955-20

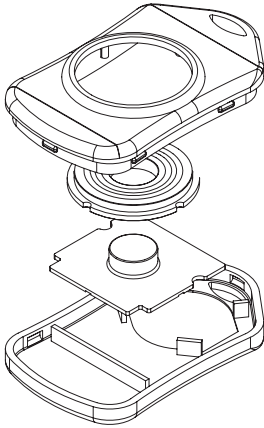

Ergo Keyfobs  
2955-40

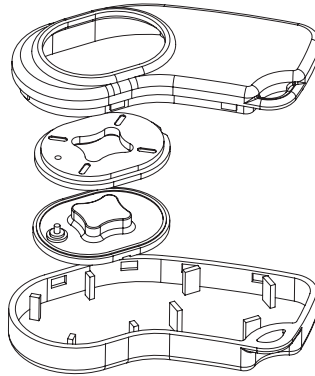

Eco Keyfob  
2956

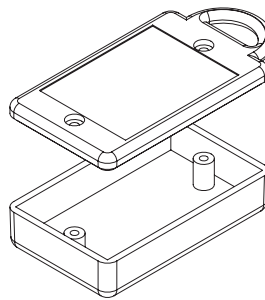

Eco Keyfobs  
2957

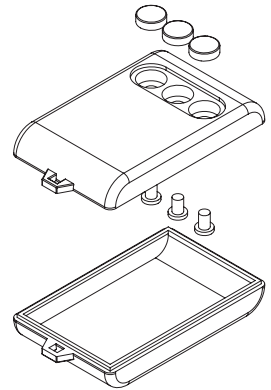

### 2955-20 Series Round Keyfobs

ABS keyfobs with round 1-5 rubber button layout

- Moulded in ABS
- Snap-fit assembly of lid & base
- 1 to 5 rubber buttons with contact pads
- Enclosed battery compartment for coin cells
- Eyelet for key-ring



#### SPECIFICATION

Materials	Lid, base & adaptor ABS Push buttons silicone
Standard colours	Lid, base and adaptor black similar to RAL 9004 Push buttons light grey similar to RAL 7037
Standard unit includes	Lid & base Push-button insert Button adaptor

BLACK	DESCRIPTION
2955-20R-1	1 Button
2955-20R-2	2 Button
2955-20R-3	3 Button
2955-20R-4	4 Button
2955-20R-5	5 Button

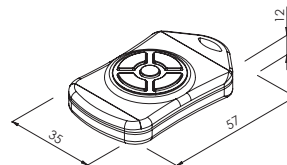

# HAND HELD CASES

## 2955-40 Series Ergo Keyfobs

Ergonomically shaped ABS keyfobs with 1-5 rubber buttons and clear silicone LED window.

- Moulded in ABS
- Snap-fit assembly of lid and base
- 1 to 5 ergonomically shaped rubber buttons with contact pads
- Base incorporates a separate enclosed battery compartment for coin cells
- Eyelet for key-ring
- Clear silicone LED window



### SPECIFICATION

Materials	Lid, base & adaptor ABS Push buttons silicone
Standard colours	Lid, base and adaptor black similar to RAL 9004 Push buttons light grey similar to RAL 7037
Standard unit includes	Lid & base Push-button insert Button adaptor

BLACK	DESCRIPTION
2955-40R-1	1 Button
2955-40R-2	2 Button
2955-40R-3	3 Button
2955-40R-4	4 Button
2955-40R-5	5 Button

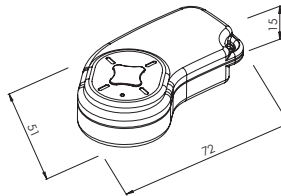

## 2955 Series Battery Holder

- Spring steel nickel-plated battery holder
- Fits 20mm coin cell lithium type battery (not included)

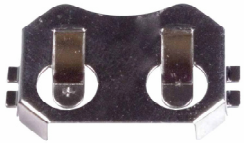

TYPE NO.	DESCRIPTION
2955-BATT-HDR	20mm coin cell battery holder

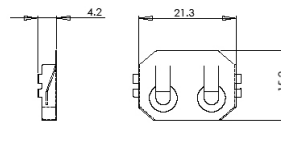

## 2956 Series Eco Keyfob Case

Economic ABS key fob with label recess in lid.

- Moulded in ABS
- Blank keyfob case (without buttons)
- Assembly of lid and base
- Small eyelet for key-ring
- Label recess in lid



### SPECIFICATION

Materials	Lid & base ABS
Standard colours	Black similar to RAL 9004
Standard unit includes	Lid & base 2x screws

BLACK	LEGNTH	WIDTH	HEIGHT
2956	53mm	33mm	15mm

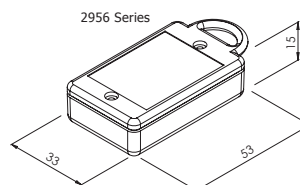

UNIVERSAL ENCLOSURES

HAND HELD CASES

HEAVY DUTY ENCLOSURES

DIN RAIL BOXES

INTERFACE SUPPORTS

CONTROL STATIONS

DIECAST & METAL BOXES

DESKTOP & INSTRUMENT CASES

POTTING BOXES

19" ENCLOSURES

19" SUBRACKS

CUSTOM SIZED ENCLOSURES

CUSTOM SERVICES



+44 (0)1638 716101  
info@camdenboss.com  
www.camdenboss.com

We operate a constant improvement policy, our products are subject to change without notice.

Ver 1.0

**CAMDENBOSS**  
ELECTRONICS & ENCLOSURES