

Electrical/Optical characteristics at T_A = 25°C

| Parameter | Symbol | Min. | Type | Max. | Unit | Test |
|--|-----------|------|------|------|------|-----------|
| Luminous Intensity | IV | 18.5 | 36 | 45 | mcd | IF = 20mA |
| Viewing Angle | 2θ½ | | 120 | | Deg. | IF = 20mA |
| Peak Emission Wavelength | λp | | 571 | | nm | |
| Dominant Wavelength | λD | 567 | 571 | 577 | nm | IF = 20mA |
| Spectral Line Half-Width | Δλ | | 30 | | nm | |
| Forward Voltage | VF | 1.8 | 2.1 | 2.3 | V | IF = 20mA |
| Power Dissipation | Pd | | | 78 | mW | |
| Peak Forward Current (Duty1/10 @ 1kHz) | IF (Peak) | | | 60 | mA | |
| Recommended Operating Current | IF (Rec) | | 30 | | mA | |

Absolute Maximum Ratings : (T_A = 25°C)

| | |
|---|------------------------------|
| Reverse Voltage | : 5 Volt |
| Reverse Current | : 10μA (V _R = 5V) |
| Operating Temperature Range | : -40°C to +85°C |
| Storage Temperature Range | : -40°C to +100°C |
| Lead Soldering Temperature Range {1.6mm (1/16 inch) from body} | : 260°C For 5 Seconds |

Reliability test For LED Lamps

| Item | Test Conditions | Test Time/Cycle | Sample Size | Ac/Re |
|--------------------------------|--|-----------------|-------------|-------|
| DC Operating Life | Temperature : 25°C IF : 20mA | 1,000 Hrs. | 76 Pcs. | 0/1 |
| High Temperature High Humidity | Temperature : 85°C 85%RH | | | |
| High Temperature Storage | Temperature : 100°C | | | |
| Low Temperature Storage | Temperature : -40°C | | | |
| Temperature Cycling | 85°C~ 25°C~-35°C 15min~ 5min~ 15min | 15 Cycles | | |
| Thermal Shock | 85°C~ 25°C~-10°C 5min~ 10sec ~ 5min | | | |
| Solder Heat | Temperature : 260°C ±5°C | 10 Sec. | | |

Typical Electro-Optical Characteristics Curves

Super Green (AlInGaP $\lambda_P=570\text{nm}$)

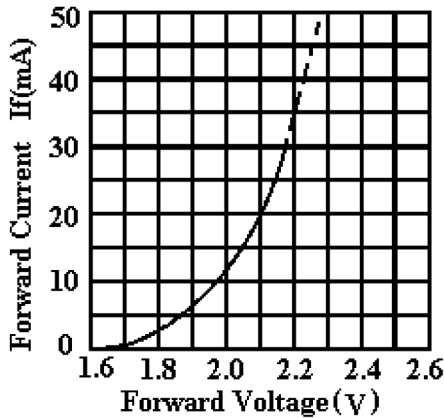

Forward current vs. Forward Voltage

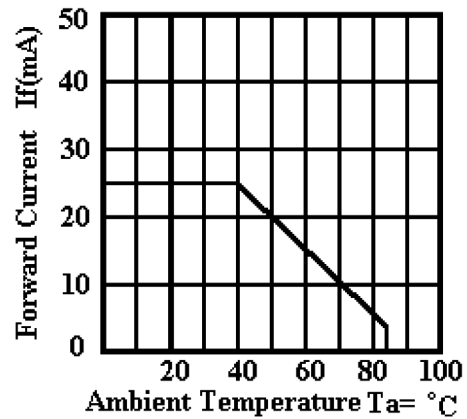

Forward current Derating curve

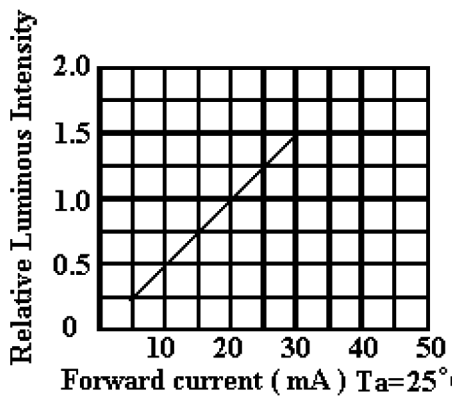

Luminous Intensity vs. Forward current

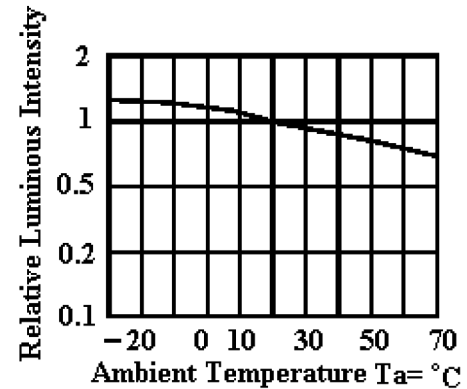

Luminous Intensity vs. Ambient Temperature

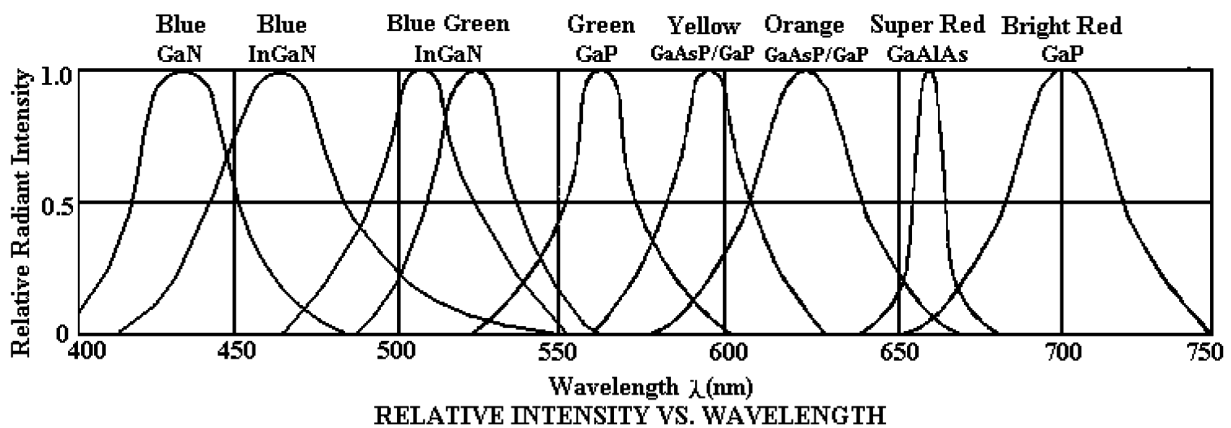

Dimensions:

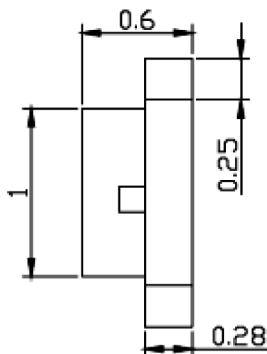
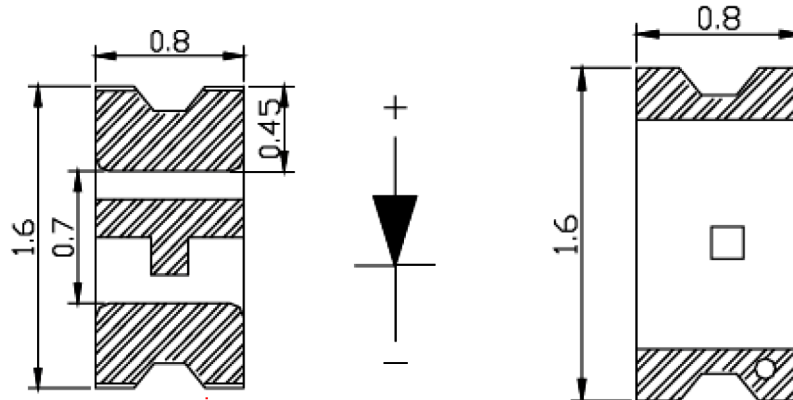

Recommended soldering pad design

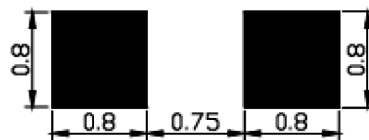

Dimensions : Millimetres
 All tolerance shall be
 $\pm 0.02\text{mm}$

Part Number Table

| Description | Part Number |
|---------------------------------|----------------|
| LED, 0.8mm, Green, 36mcd, 571nm | MCL-S291SGC-ML |

Important Notice : This data sheet and its contents (the "Information") belong to the members of the Premier Farnell group of companies (the "Group") or are licensed to it. No licence is granted for the use of it other than for information purposes in connection with the products to which it relates. No licence of any intellectual property rights is granted. The Information is subject to change without notice and replaces all data sheets previously supplied. The Information supplied is believed to be accurate but the Group assumes no responsibility for its accuracy or completeness, any error in or omission from it or for any use made of it. Users of this data sheet should check for themselves the Information and the suitability of the products for their purpose and not make any assumptions based on information included or omitted. Liability for loss or damage resulting from any reliance on the Information or use of it (including liability resulting from negligence or where the Group was aware of the possibility of such loss or damage arising) is excluded. This will not operate to limit or restrict the Group's liability for death or personal injury resulting from its negligence. Multicomp is the registered trademark of the Group. © Premier Farnell plc 2012.