

C-Series Commercial
Pin & Sleeve Devices

HUBBELL

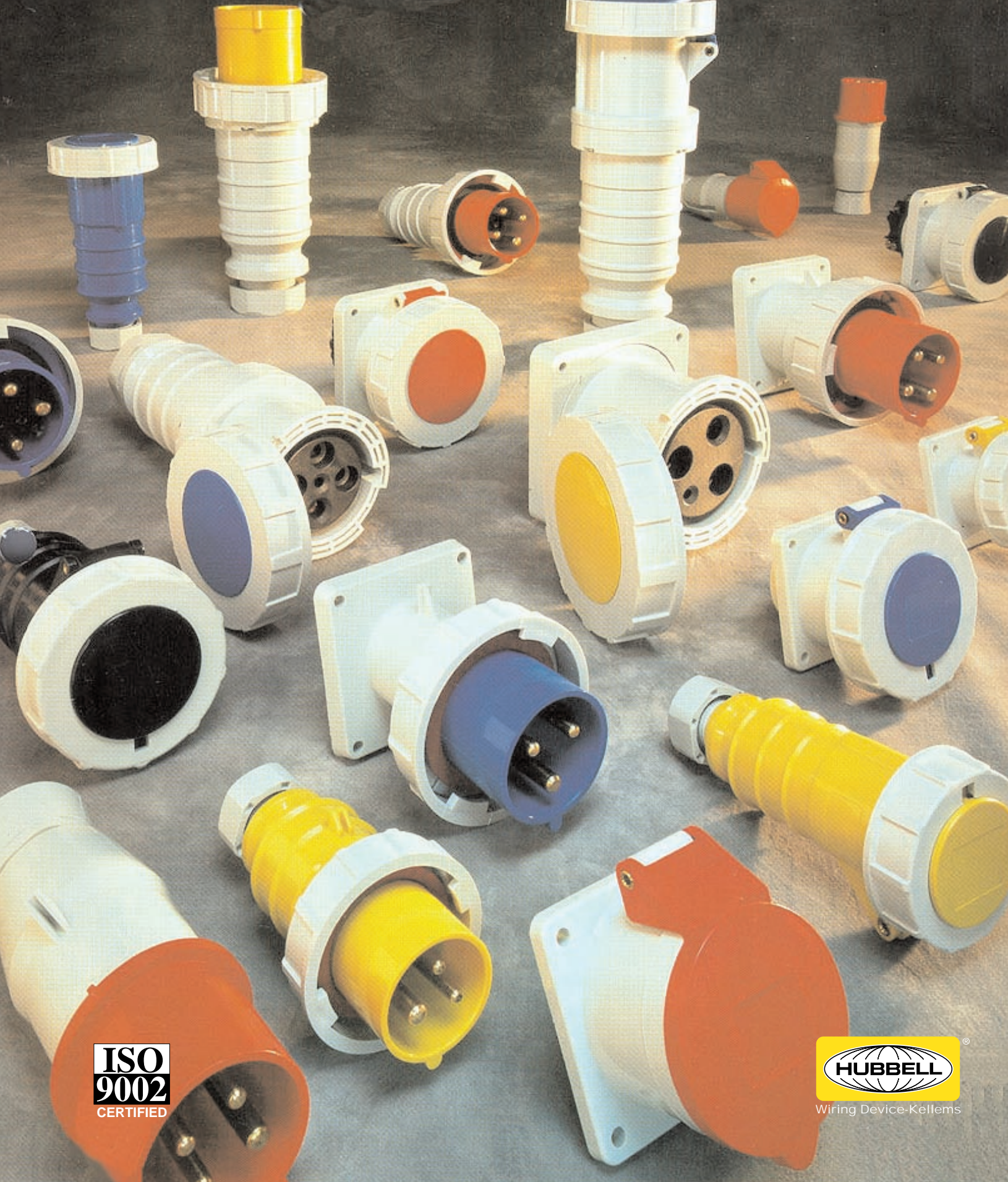

**ISO
9002**
CERTIFIED



Wiring Device-Kellems



C-Series - A New Generation of Pin & Sleeve Devices

Hubbell now offers a complete line of commercial grade pin and sleeve wiring devices. Safety, durability, performance, and positive locking are all essential to you. But so is economy.

Where the application calls for a light-industrial wiring device designed and constructed with safety in mind, Hubbell C-Series pin and sleeve devices are the answer.

The North American devices are available in 20, 30, 60, and 100 Amp watertight configurations while the European devices are available in 16,32,63, and 125 Amp watertight and splashproof configurations.

An airtight case for a watertight pin and sleeve.

Often, pin and sleeve devices are used in applications where water is present and that can make short work of an unprotected device. To minimize that risk, C-Series is designed with features that make them watertight.

For example, the self-closing, gasketed cover on the receptacle and connector body seats to provide a weatherproof seal and makes a watertight seal when locked. The plug and inlet are watertight when connected to a mating device and locked with the locking ring or closure cap.

Furthermore, neoprene glands provide a reliable watertight connection at the cable entry point. The same protective features make the C-Series pin and sleeve device dust tight, as well as watertight to reduce the risk of contamination by metal filings or dust.

A watertight pin and sleeve that holds tight, too.

To protect the internal wire termination, the new C-Series pin and sleeve devices feature an internal cable grip which can handle a wide variety of cable sizes to prevent conductor movement and strain on the terminals.

But we didn't stop there.

A tough pin and sleeve device has to withstand more than just external impact. It also has to withstand possible internal heat build-up. To meet this requirement, the C-Series devices utilize a glass filled nylon contact carrier. The result: interiors that resist arcing and prevent damage in the event of heat build-up due to overloads.

The C-Series also incorporates solid brass pins and sleeves combined with stainless steel components to improve overall corrosion resistance.

Hubbell Safe

The C-Series devices are designed and built to conform to IEC 309-2, the worldwide pin and sleeve standard established by the International Electrotechnical Commission. This is a uniform system that makes the mating of plugs and receptacles of different voltages and current ratings physically impossible as required by the National Electrical Code.

C-Series devices are color coded according to voltage rating and female grounding contact position. Within a particular voltage group, every plug and the weatherproof cap on every receptacle is identical in color. All 250 VAC devices are blue, all 480 VAC devices are red, etc.

As shown, a clock face is used to represent the ground sleeve position for all receptacles. With the keyway at the bottom, the female grounding sleeve will appear at one of the twelve "hour" positions. Using this system, it is easy to identify the system voltage for any plug and receptacle. This standard calls out a singly rated non-interchangeable configuration for every voltage and type of service throughout the world.

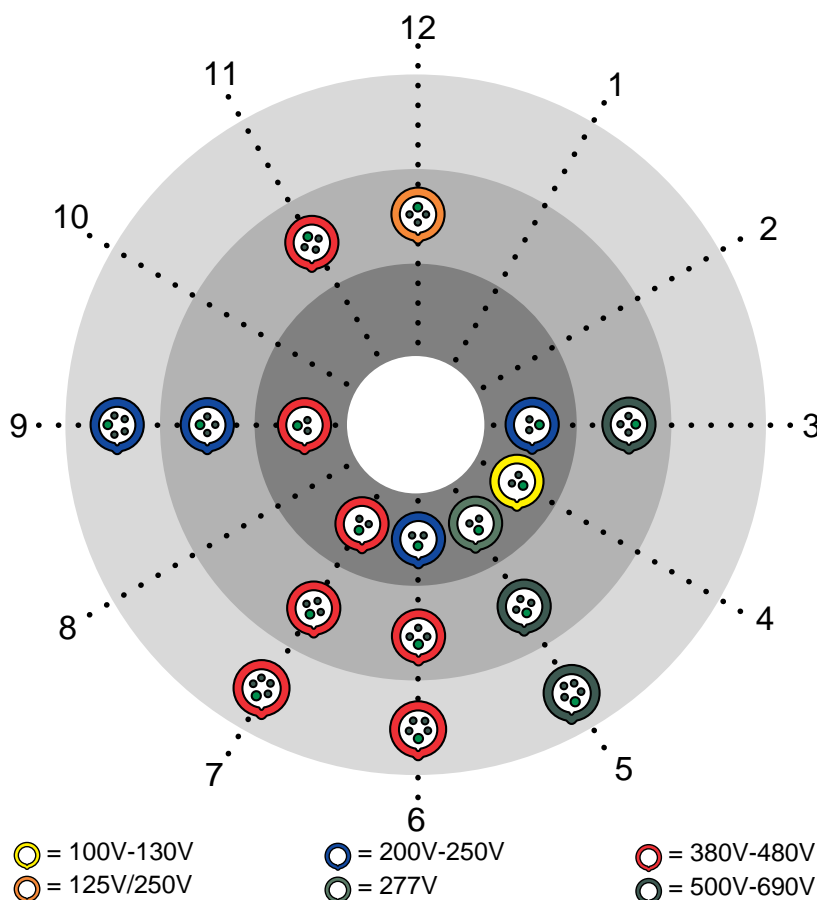



Features and Benefits

Terminal identification - the ground and neutral terminals are clearly identified with large color coded markings for easy recognition.

Watertight multi-diameter sealing glands - for use with varying cable sizes insure a highly reliable seal at the cable entry to the device.

Insulated housing - tough nylon provides increased safety and maximum impact and abuse resistance.

Gasketed cover and locking ring - The self-closing cover sits in a position that provides a weatherproof seal. Simply rotating the cover then locking it makes it watertight

Solid pins - dependable solid pin construction provides for long life and reliable electrical contact.

Cable grip - internal strain relief protects the wiring by preventing conductor movement which can cause strain on terminals. The internal cable grip is designed to swing out of the way for easier wiring.

Staggered contacts - in female devices to assure protection of personnel and equipment. Oversized ground contact is farthest forward, assuring first make and last break of the ground for safety. Neutral contact is next to prevent the possibility of an "open neutral" condition that could result in an over-voltage condition at equipment. Phase contact is farthest back, making it last to make, first to break.

Shrouding - protects pins from impact and abuse.

Color coding - all devices are color coded by voltage for quick visual identification of mating devices.

Product identification - every device is marked with its respective catalog number and rating for ease in identification.

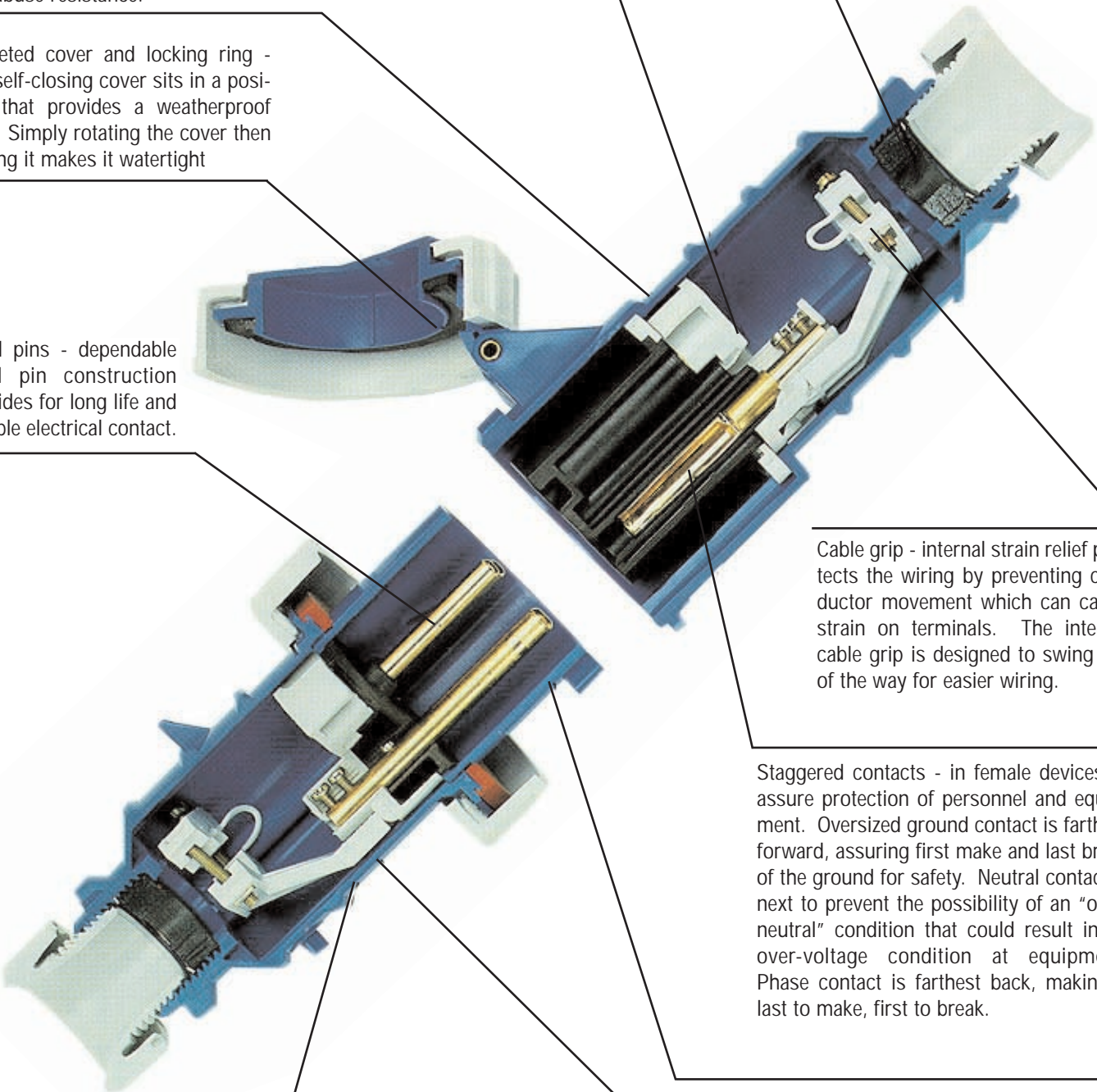



Watertight Devices Ordering Information

Pin and Sleeve C-Series

20 through 100 Ampere – North American Ratings

16 through 125 Ampere – International Ratings

|     IP67 | | | | | Watertight Devices | | | Back Boxes | | | |
|---|-----------------|---|---|------------------------|--|--|---|---|---|--|---|
| Amps | Poles and Wires | Configuration Recep./ Conn. | Plug/ Inlet | Voltage |  Receptacle |  Plug |  Connector |  MIN. MAX. Cord Dia. inches |  Nonmetallic |  Metallic |  Adapter Plate |
| 16 | 2P3W |  |  | 200-250 | C316R6W | C316P6W | C316C6W | .365-.625 | BB2030N* | SP20301 | CAP2030 |
| | 4P5W |  |  | 200/346 240/415 | C516R6W | C516P6W | C516C6W | .365-.625 | BB2030N* | SP20301 | CAP2030 |
| 20 | 2P3W |  |  | 125 | C320R4W | C320P4W | C320C4W | .365-.625 | BB2030N* | SP20301 | CAP2030 |
| | 2P3W |  |  | 250 | C320R6W | C320P6W | C320C6W | .365-.625 | BB2030N* | SP20301 | CAP2030 |
| | 3P4W |  |  | 125/250 | C420R12W | C420P12W | C420C12W | .365-.625 | BB2030N* | SP20301 | CAP2030 |
| | 3P4W |  |  | 3Ø250 | C420R9W | C420P9W | C420C9W | .365-.625 | BB2030N* | SP20301 | CAP2030 |
| | 3P4W |  |  | 3Ø480 | C420R7W | C420P7W | C420C7W | .365-.625 | BB2030N* | SP20301 | CAP2030 |
| | 3P4W |  |  | 3Ø600 | C420R5W | C420P5W | C420C5W | .365-.625 | BB2030N* | SP20301 | CAP2030 |
| 30 | 2P3W |  |  | 250 | C330R6W | C330P6W | C330C6W | .565-.95 | BB2030N* | SP20301 | CAP2030 |
| | 2P3W |  |  | 480 | C330R7W | C330P7W | C330C7W | .565-.95 | BB2030N* | SP20301 | CAP2030 |
| | 3P4W |  |  | 3Ø250 | C430R9W | C430P9W | C430C9W | .565-.95 | BB2030N* | SP20301 | CAP2030 |
| | 3P4W |  |  | 3Ø480 | C430R7W | C430P7W | C430C7W | .565-.95 | BB2030N* | SP20301 | CAP2030 |
| | 3P4W |  |  | 3Ø600 | C430R5W | C430P5W | C430C5W | .565-.95 | BB2030N* | SP20301 | CAP2030 |
| | 4P5W |  |  | 3ØY120/208 | C530R9W | C530P9W | C530C9W | .565-.95 | BB2030N* | SP20301 | CAP2030 |
| | 4P5W |  |  | 3ØY277/480 | C530R7W | C530P7W | C530C7W | .565-.95 | BB2030N* | SP20301 | CAP2030 |
| 32 | 2P3W |  |  | 200-250 | C332R6W | C332P6W | C332C6W | .565-.95 | BB2030N* | SP20301 | CAP2030 |
| | 3P4W |  |  | 380V 50Hz 440V 60Hz | C432R3W | C432P3W | C432C3W | .565-.95 | BB2030N* | SP20301 | CAP2030 |
| | 4P5W |  |  | 200/346 240/415 | C532R6W | C532P6W | C532C6W | .565-.95 | BB2030N* | SP20301 | CAP2030 |
| 60 | 3P4W |  |  | 3Ø250 | C460R9W | C460P9W | C460C9W | .78-1.40 | BB60N* | SP602 | CAP60 |
| | 3P4W |  |  | 3Ø480 | C460R7W | C460P7W | C460C7W | .78-1.40 | BB60N* | SP602 | CAP60 |
| | 3P4W |  |  | 3Ø600 | C460R5W | C460P5W | C460C5W | .78-1.40 | BB60N* | SP602 | CAP60 |
| | 4P5W |  |  | 3ØY120/208 | C560R9W | C560P9W | C560C9W | .78-1.40 | BB60N* | SP602 | CAP60 |
| 63 | 4P5W |  |  | 200/346 240/415 | C563R6W | C563P6W | C563C6W | .78-1.40 | BB60N* | SP602 | CAP60 |
| 100 | 3P4W |  |  | 125/250 | C4100R12W | C4100P12W | C4100C12W | .92-1.72 | BB100N* | BB1001W* | CAP100 |
| | 3P4W |  |  | 3Ø250 | C4100R9W | C4100P9W | C4100C9W | .92-1.72 | BB100N* | BB1001W* | CAP100 |
| | 3P4W |  |  | 3Ø480 | C4100R7W | C4100P7W | C4100C7W | .92-1.72 | BB100N* | BB1001W* | CAP100 |
| | 3P4W |  |  | 3Ø600 | C4100R5W | C4100P5W | C4100C5W | .92-1.72 | BB100N* | BB1001W* | CAP100 |
| | 4P5W |  |  | 3ØY120/208 | C5100R9W | C5100P9W | C5100C9W | .92-1.72 | BB100N* | BB1001W* | CAP100 |
| 125 | 4P5W |  |  | 200/346 240/415 | C5125R6W | C5125P6W | C5125C6W | .92-1.72 | BB100N* | BB1001W* | CAP100 |

* Adapter plate required



Dimensions - Watertight Devices

(inch/mm)

| Plugs | A | B | C | D | E |
|-----------------------------------|---------------|-------------|--------------|---------------|--------------|
| C320P | 2.75 70.5 | 4.37 112 | 5.42 139 | 4.11 105.5 | 0.62 16 |
| C420P | 3.04 78 | 4.37 112 | 5.42 139 | 4.11 105.5 | 0.62 16 |
| C520P | 3.37 86.5 | 4.60 118 | 5.66 145 | 4.35 111.5 | 0.62 16 |
| C330P, C430P | 3.67 94 | 5.62 144 | 6.67 171 | 4.95 127 | 0.88 22.5 |
| C530P | 3.96 101.5 | 5.62 144 | 6.67 171 | 4.95 127 | 0.88 22.5 |
| C360P, C460P, C560P | 4.43 113.5 | 8.81 226 | 9.91 254 | 7.49 192 | 1.43 36.5 |
| C3100P, C4100P, C5100P | 4.88 125 | 9.87 253 | 11.15 286 | 8.39 215 | 1.72 44 |

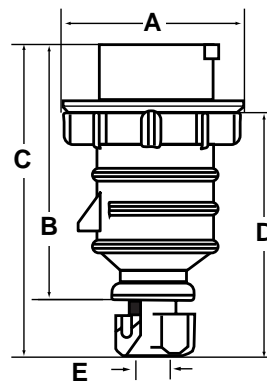

(inch/mm)

| Connectors | A | B | C | D |
|--------------------------------|---------------|--------------|---------------|--------------|
| C320C | 2.75 70.5 | 5.97 153 | 3.00 77 | 0.62 16 |
| C420C | 3.04 78 | 5.97 153 | 3.24 83 | 0.62 16 |
| C520C | 3.37 86.5 | 6.20 159 | 3.63 93 | 0.62 16 |
| C330C, C430C | 3.67 94 | 7.33 188 | 3.86 99 | 0.88 22.5 |
| C530C | 3.96 101.5 | 7.33 188 | 4.17 107 | 0.88 22.5 |
| C360C, C460C, C560C | 4.29 110 | 10.61 272 | 4.43 113.5 | 1.42 36.5 |
| C3100C, C4100C | 4.91 126 | 12.01 308 | 4.99 128 | 1.72 44 |
| C5100C | 4.91 126 | 12.01 308 | 4.99 128 | 1.72 44 |

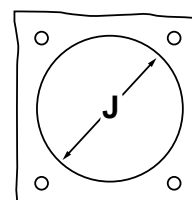
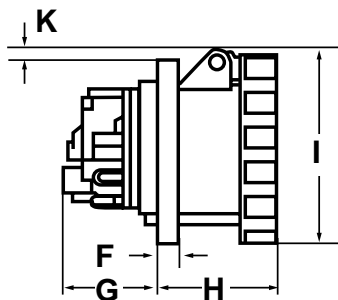
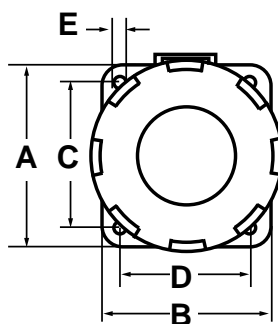
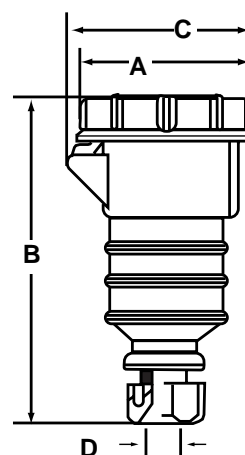

(inch/mm)

| Receptacles | A | B | C | D | E | F | G | H | I | J | K |
|-----------------------------------|-------------|-------------|-------------|-------------|-------------|------------|--------------|-------------|-------------|------------|--------------|
| C320R | 2.93 75 | 2.93 75 | 2.34 60 | 2.34 60 | 0.22 5.5 | 0.27 7 | 0.66 17 | 2.22 57 | 2.96 76 | 1.76 45 | 0.14 3.5 |
| C420R | 2.93 75 | 2.93 75 | 2.34 60 | 2.34 60 | 0.22 5.5 | 0.27 7 | 1.01 26 | 2.26 58 | 3.24 83 | 1.76 45 | 0.27 7 |
| C520R | 2.93 75 | 2.93 75 | 2.34 60 | 2.34 60 | 0.22 5.5 | 0.27 7 | 0.66 17 | 2.22 57 | 3.63 93 | 2.15 55 | 0.45 11.5 |
| C330R, C430R | 2.93 75 | 2.93 75 | 2.34 60 | 2.34 60 | 0.22 5.5 | 0.31 8 | 1.40 36 | 2.54 65 | 3.90 100 | 2.34 60 | 0.47 12 |
| C530R | 2.93 75 | 2.93 75 | 2.34 60 | 2.34 60 | 0.22 5.5 | 0.31 8 | 0.74 19 | 2.54 65 | 3.90 100 | 2.34 60 | 0.66 17 |
| C360R, C460R, C560R | 4.17 107 | 3.9 100 | 3.32 85 | 3.00 77 | 0.25 6.5 | 0.47 12 | 2.20 56.5 | 2.96 76 | 4.41 113 | 3.43 88 | 0.27 7 |
| C3100R, C4100R, C5100R | 4.68 120 | 4.68 120 | 3.90 100 | 3.90 100 | 0.25 6.5 | 0.82 21 | 1.95 50 | 4.56 117 | 5.03 129 | 3.28 84 | 0.23 6 |



Ordering Information / Dimensions - Splashproof Devices

| IP44 | | | | | Splashproof Devices | | | Back Boxes | | | |
|-------------|-----------------|-----------------------------|-------------|--------------------|---------------------|----------|---------------|--------------------------------------|-----------------|--------------|-------------------|
| Amps | Poles and Wires | Configuration Recep./ Conn. | Plug/ Inlet | Voltage | Receptacle | Plug | Connector | Cord Dia. MIN. MAX. inches | Nonmetallic | Metallic | Adapter Plate |
| 16 | 2P3W | | | 100-130 | C316R4S | C316P4S | C316C4S | .365-.625 | BB2030N* | SP20301 | CAP2030 |
| | 2P3W | | | 200-250 | C316R6S | C316P6S | C316C6S | .365-.625 | BB2030N* | SP20301 | CAP2030 |
| | 4P5W | | | 200/346 240/415 | C516R6S | C516P6S | C516C6S | .365-.625 | BB2030N* | SP20301 | CAP2030 |
| 32 | 2P3W | | | 100-130 | C332R4S | C332P4S | C332C4S | .565-.95 | BB2030N* | SP20301 | CAP2030 |
| | 2P3W | | | 200-250 | C332R6S | C332P6S | C332C6S | .565-.95 | BB2030N* | SP20301 | CAP2030 |
| | 4P5W | | | 200/346 240/415 | C532R6S | C532P6S | C532C6S | .565-.95 | BB2030N* | SP20301 | CAP2030 |

* Adapter plate required

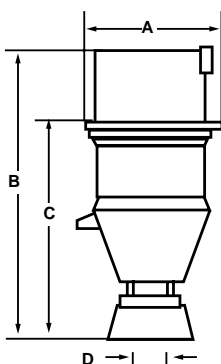

(inch/mm)

| Plugs | A | B | C | D |
|--------------|------|------|------|------|
| C316P | 1.99 | 5.38 | 3.98 | 0.66 |
| | 51 | 138 | 102 | 17 |
| C516P | 2.5 | 5.58 | 4.17 | 0.66 |
| | 64 | 143 | 107 | 17 |
| C332P | 2.57 | 6.83 | 5.07 | 0.96 |
| | 66 | 175 | 130 | 24.5 |
| C532P | 2.85 | 6.86 | 5.11 | .96 |
| | 73 | 176 | 131 | 24.5 |

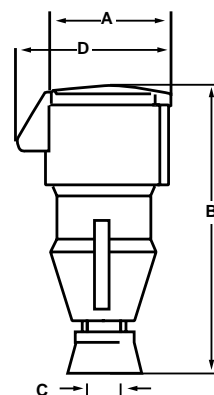

(inch/mm)

| Connectors | A | B | C | D |
|--------------|------|------|-------|------|
| C316C | 1.99 | 5.85 | 0.66 | 2.77 |
| | 51 | 150 | 17 | 71 |
| C516C | 2.50 | 6.05 | 0.66 | 3.32 |
| | 64 | 155 | 17 | 85 |
| C332C | 2.57 | 7.33 | 0.96 | 3.63 |
| | 66 | 188 | 24.50 | 93 |
| C532C | 2.81 | 7.37 | .96 | 3.86 |
| | 72 | 189 | 24.5 | 99 |

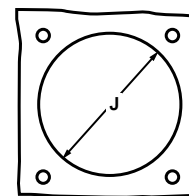
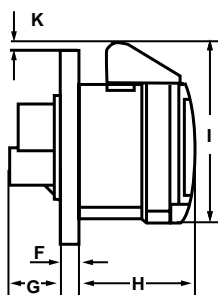
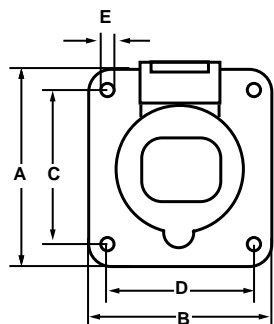

(inch/mm)

| Receptacles | A | B | C | D | E | F | G | H | I | J | K |
|--------------|------|------|------|------|------|------|------|------|------|------|------|
| C316R | 2.93 | 2.93 | 2.34 | 2.34 | 0.22 | 0.27 | 0.66 | 1.99 | 2.73 | 1.76 | 0.40 |
| | 75 | 75 | 60 | 60 | 5.5 | 7 | 17 | 51 | 70 | 45 | 3.5 |
| C516R | 2.93 | 2.93 | 2.34 | 2.34 | 0.21 | 0.27 | 0.66 | 2.07 | 3.32 | 2.15 | .45 |
| | 75 | 75 | 60 | 60 | 5.5 | 7 | 17 | 53 | 85 | 55 | 11.5 |
| C332R | 2.93 | 2.93 | 2.34 | 2.34 | 0.21 | 0.31 | 1.40 | 2.42 | 3.51 | 2.34 | .47 |
| | 75 | 75 | 60 | 60 | 5.5 | 8 | 36 | 62 | 90 | 60 | 12 |
| C532R | 2.93 | 2.93 | 2.34 | 2.34 | .21 | .31 | .74 | 2.42 | 3.82 | 2.34 | .47 |
| | 75 | 75 | 60 | 60 | 5.5 | 8 | 19 | 62 | 98 | 60 | 17 |



Accessories

Nonmetallic Back Box

This Hubbell back box is made of a high grade engineered thermoplastic that meets IP67 requirements. It resists chemicals, abuse and UV rays. What's more, this box has an integral grounding plate and, when installed with a watertight conduit hub, it meets Type 4X requirements (hose-directed water, corrosion resistance).



| Description | Hub Size Inch (mm) | A Inch (mm) | B Inch (mm) | C Inch (mm) | D Inch (mm) | E Inch (mm) | F Inch (mm) | Cubic Inch Capacity | Catalog Number |
|-----------------------------------|--------------------------|-------------------|-------------------|-------------------|-------------------|-------------------|-------------------|---------------------------|-------------------|
| Back box for 20 & 30A devices. | 1* | 5.67 | 4.44 (144.0) | 4.05 (112.8) | 3.91 (102.9) | 2.35 (99.3) | 4.92 (59.7) | 30 (125.0) | BB2030N |
| Back box for 60A devices. | 1 1/4** | 7.76 | 5.16 (197.0) | 5.87 (131.0) | 4.72 (149.0) | 2.99 (120.0) | 6.94 (76.0) | 70 (176.0) | BB60N |
| Back box for 100A devices. | 1 1/2*** | 8.21 | 6.23 (209.0) | 6.31 (158.0) | 5.71 (160.3) | 3.99 (145.0) | 7.41 (101.0) | 120 (188.0) | BB100N |

* Hub is not included; order one of the following Racco part numbers: * 1" = 1704, ** 1 1/4 = 1705, *** 1 1/2 = 1706

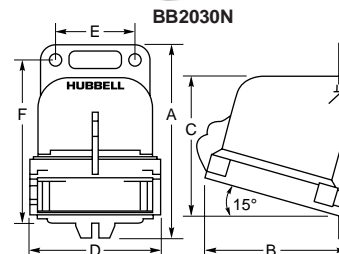

Adapter Plate

Adapter plate allows receptacles and inlets to be mounted to nonmetallic back boxes

| Description | Catalog Number |
|----------------------------------|----------------|
| 20, 30, 16, 32 Amp Adapter Plate | CAP2030 |
| 60, 63 Amp Adapter Plate | CAP60 |
| 100, 125 Amp Adapter Plate | CAP100 |

Adapter Plate thickness .375

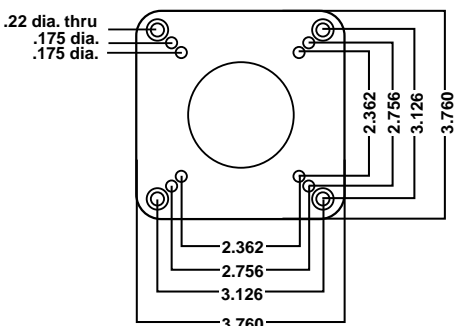

CAP2030

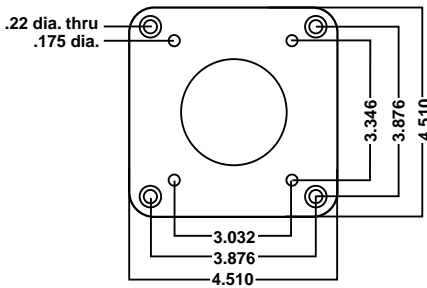

CAP60

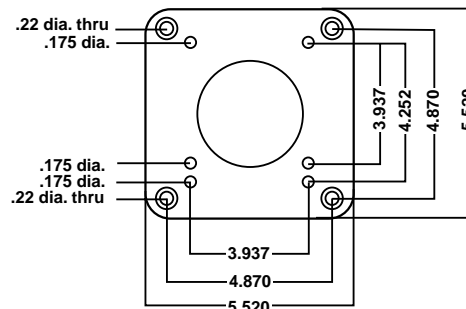

CAP100

Metallic Back Boxes, Back Box Dimensions

| Description | Hub Size | A Inch (mm) | B Inch (mm) | C Inch (mm) | D Inch (mm) | Catalog Number |
|-------------------------|----------|-------------------|-------------------|-------------------|-------------------|-------------------|
| 15° angle for 20A & 30A | 3/4" | 5.07 130 | 3.38 87 | 4.13 106 | 3.62 93 | SP20301 |
| 15° angle for 60A | 1 1/4" | 5.81 149 | 4.28 110 | 4.56 117 | 4.58 117 | SP602 |
| 15° angle for 100A | 1 1/2" | 8.38 215 | 6.75 173 | 6.88 176 | 5.50 141 | BB1001W* |

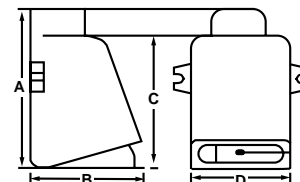

Note: All metal boxes are made of cast aluminum, *Adapter plate required

Closure Caps

Cap assemblies provide watertight sealing to a disconnected male Pin and Sleeve plug or inlet. Manufactured out of the same tough nonmetallic material as the watertight Pin and Sleeve Size devices for corrosion and abuse resistance.

| Description | Catalog Number |
|--|----------------|
| Fits all 20A 3 wire plugs and inlets | PC320 |
| Fits all 20A 4 wire plugs and inlets | PC420 |
| Fits all 20A 5 wire plugs and inlets | PC520 |
| Fits all 30A 3 and 4 wire plugs and inlets | PC3430 |
| Fits all 30A 5 wire plugs and inlets | PC530 |
| Fits all 60A plugs and inlets | PC60 |
| Fits all 100A plugs and inlets | PC100 |

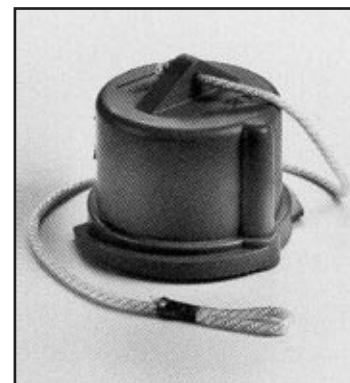



Specifications

Listed to UL Standard 1682 & 1686

Certified to CSA Standard C22.2 Number 182.1 (Industrial-type, Special-use Attachment Plugs, Receptacles and Connectors).

Watertight and Splashproof Materials

| Part | Material |
|----------------------------|--|
| Plug | |
| Housing | Nylon. |
| Locking Ring | Polycarbonate. |
| Gasket & Seals | Neoprene, EPDM, TPE, Silicone. |
| Cord Clamp Assembly | Nylon. |
| Gland Nut | Nylon. |
| Assembly Screws | Stainless Steel (300 Series)(20, 30A, Plated Steel). |
| Contact Carrier | Reinforced Nylon (60A Nylon). |
| Retainer | Reinforced Nylon |
| Ground, Phase Pins | Brass. |
| Terminal | Plated Steel. |
| Receptacle | |
| Housing | Nylon. |
| Mounting Flange | Nylon. |
| Cover Arm | Nylon. |
| Cover | Polycarbonate. |
| Cover Rivet | Brass. |
| Cover Spring | Stainless Steel (300 Series). |
| Gaskets & Seals | Neoprene, EPDM, TPE, Silicone. |
| Mounting Screws | Stainless Steel (300 Series). |
| Terminal Screw | Plated Steel. |
| Phase, Ground Sleeves | Brass. |
| Contact Carrier & Retainer | Reinforced Nylon (60A Nylon) |
| Connector Body | |
| Housing | Nylon. |
| Cord Clamp Assembly | Nylon. |
| Gland Nut | Nylon. |
| Cover Arm | Nylon. |
| Cover | Polycarbonate. |
| Cover Rivet | Brass. |
| Cover Spring | Stainless Steel (300 Series). |
| Gaskets & Seals | Neoprene, EPDM, TPE, Silicone. |
| Contact Carrier | Reinforced Nylon (60A Nylon). |
| Retainer | Reinforced Nylon. |
| Phase, Ground Sleeves | Brass. |
| Terminal | Plated Steel |
| Assembly Screws | Stainless Steel (300 Series) (20, 30A Plated Steel) |



® Wiring Device - Kellems

Hubbell Incorporated (Delaware) • 185 Plains Road • Milford, CT 06460-2420 • (203) 882-4800 • FAX (800) 255-1031
World Wide Web URL: <http://www.hubbell-wiring.com>

Worldwide Locations

Hubbell Canada (905) 839-1138, Fax (905) 839-9108
Hubbell Ltd. England (441) 234-855444, Fax (441) 234-854008
Hubbell-Taian Co., Ltd., (886) 2 567-5995, Fax (886) 2 567-4853
Hubbell Int'l. Inc., Korea Branch (82) 2 607-1362, Fax (82) 2 603-7386

Hubbell de Mexico, S.A. de C.V. (52) 5 575-2022, Fax (52) 5 559-8626
Caribe Sales Agencies, Puerto Rico (809) 720-7185, Fax (809) 789-2796
Hubbell S.E. Asia Pte., Ltd., 65-4544772, Fax 65-4544775
Hubbell Inc. Middle East (971) 4 369-763, Fax (971) 4 360-541