

Installer Connector Cases

222, 773 and 224 Series connectors



Installer Carry Case - Part No. 51006944

Contents:- 690 connectors

222-412 x 100	773-102 x 100	224-101 x 100
222-413 x 50	773-104 x 100	224-112 x 100
222-415 x 40	773-106 x 50	
	773-108 x 50	



Installer Box Professional - Part No. 51228988

Contents:- 240 connectors

222-412 x 40	773-102 x 40	224-101 x 20
222-413 x 40	773-104 x 40	224-112 x 20
222-415 x 20	773-106 x 10	
	773-108 x 10	



Installer Box Basic - Part No. 51228987

Contents:- 75 connectors

222-412 x 10	773-102 x 10	224-101 x 10
222-413 x 10	773-104 x 10	224-112 x 10
222-415 x 5	773-106 x 5	
	773-108 x 5	



WAGO®
INNOVATIVE CONNECTIONS

224 Series lighting connectors

Installation side 1 - 2.5mm² "s"
Lighting side 0.5 - 2.5mm² "s + f-st"
400V/4 kV/2
I_N 24A

AWG 14 - 12
AWG 20 - 16
300V, 20A



224-101
2-conductor



224-112
3-conductor

9 - 11 mm "s" - Solid "f-st" - Flex

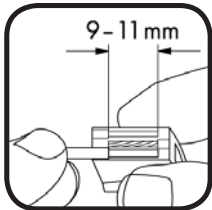

Strip both the conductors 9 - 11 mm

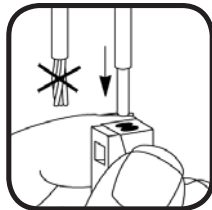

Push the supply cable (solid) into the back of the connector

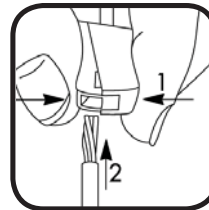

Squeeze the front of the connector to open the CAGE CLAMP® and insert the load cable (flex) then release to close



Use testpoints to safely test connectors

773 Series PUSH WIRE® connectors for junction boxes

0.75 - 2.5mm² "s"
1.5 - 2.5mm² "st"
400V/4 kV/2
I_N 24A

AWG 18 - 12 "s"
AWG 16 - 12 "st"
600V, 20A UL



773-102
2-conductor



773-104
4-conductor



773-106
6-conductor



773-108
8-conductor

12 mm "s" - Solid "st" - Stranded

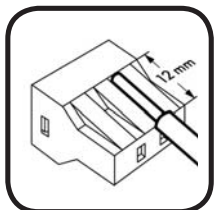

Strip the conductor 12mm

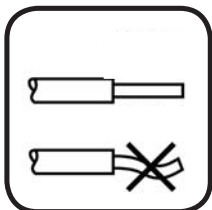

Make sure the conductor is straight

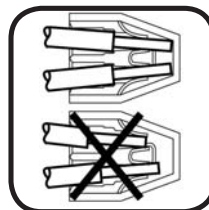

Insert fully into the housing

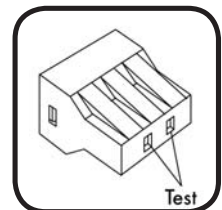

Use testpoints to safely test connectors

222 Series lever connectors

0.08 - 2.5mm² "s + st"
4mm² "f-st"
400V/4 kV/2
I_N 32A

AWG 28 - 14 "s + st"
AWG 28 - 12 "f-st"
600V, 20A UL



222-412
2-conductor



222-413
3-conductor



222-415
5-conductor

9 - 10 mm "s" - Solid "st" - Stranded "f-st" - Flex

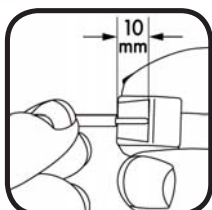

Strip the conductor 10mm

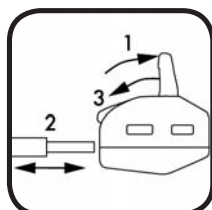

1. Lift orange lever
2. Insert conductor fully
3. Close lever

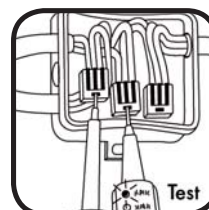

Use testpoints to safely test connectors



Be careful when closing levers