

④ V @ h "

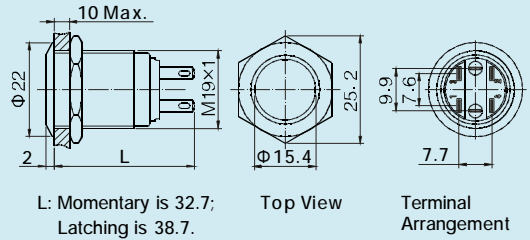

Φ19mm diameter
 Switch Rating: 5A/250VAC
 Contact Configuration: 1NO1NC
 Tag Terminal
 Operation Type: Momentary / Latching
 The Front Shape: Flat Head
 The Surface Material: BS/SS/B/BLK
 IP Degree: IP67 IK09



Φ19mm diameter
 Switch Rating: 5A/250VAC
 Contact Configuration: 1NO1NC
 Screw Terminal
 Operation Type: Momentary / Latching
 The Front Shape: Flat Head
 The Surface Material: BS/SS/B/BLK
 IP Degree: IP67 IK09

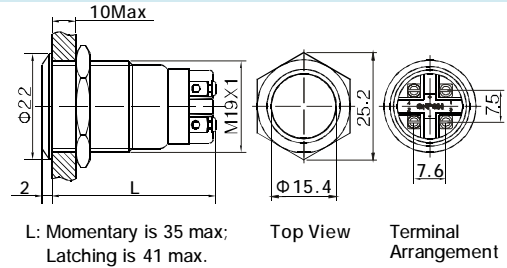

Φ19mm diameter
 Switch Rating: 5A/250VAC
 Contact Configuration: 1NO1NC /
 2NO2NC
 Operation Type: Momentary / Latching
 The Front Shape: Flat Head
 The Surface Material: BS/SS/B/BLK
 IP Degree: IP67 IK09

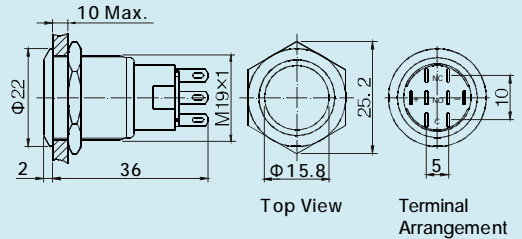

Specification	RJS101-19-F-X-IP67	RJS101S-19-F-X-IP67	RJSX02-19-F-X-IP67
The Front Shape	Flat Head	Flat Head	Flat Head
Terminal Type	Tag Terminals	Screw Terminals	Pin Terminal (2.8 x 0.5mm)
Switching	No.1	No.1	No.1
Max. Switch Rating	5A/250VAC	5A/250VAC	5A/250VAC
Contact Resistance	≤50mΩ	≤50mΩ	≤50mΩ
Insulation Resistance	≥1000MΩ	≥1000MΩ	≥1000MΩ
Dielectric Intensity	2000VAC	2000VAC	2000VAC
Operating Temp	-20°C ~ +55°C	-20°C ~ +55°C	-20°C ~ +55°C
Mechanical Life	1,000,000cycles	1,000,000cycles	1,000,000cycles
Electrical Life	50,000cycles	50,000cycles	50,000cycles
Panel Thickness	1~10mm	1~10mm	1~10mm
Torque	5~14Nm	5~14Nm	5~14Nm
Operation Pressure	About 4N	About 4N	3~5 N
Operation Distance	About 2.5mm	About 2.5mm	About 3.1mm
IP Degree	IP65, IK09	IP65, IK09	IP65, IK09
Material	Contact	Silver Alloy	Silver Alloy
	Button	BS/SS/B/BLK	BS/SS/B/BLK
	Body	BS/SS/B/BLK	BS/SS/B/BLK
	Base	PC	PA
	ROHS	Made to order	Made to order

④ V @ h "



Φ19mm diameter
 Switch Rating: 5A/250VAC
 Contact Configuration: 1NO1NC /
 2NO2NC/3NO3NC
 Operation Type: Momentary / Latching
 The Front Shape: Flat Head
 The Surface Material: BS/SS/B/BLK
 IP Degree: IP67, IK09

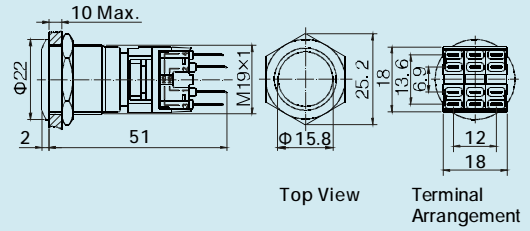

Specification	RJSX04-19-F-BS-IP67	
The Front Shape	Ball Head	
Terminal Type	Pin Terminal (2.8x0.5mm)	
Switching	No.1	
Max. Switch Rating	5A/250VaC	
Contact Resistance	≤50mΩ	
Insulation Resistance	≥1000MΩ	
Dielectric Intensity	2000VAC	
Operating Temp	-20°C ~ +55°C	
Mechanical Life	1,000,000cycles	
Electrical Life	50,000cycles	
Panel Thickness	1~6mm	
Torque	5~14Nm	
Operation Pressure	5.5 ~ 8N	
Operation Distance	About 3.1mm	
IP Degree	IP67, IK09	
Material	Contact	Silver Alloy
	Button	BS/SS/B/BLK
	Body	BS/SS/B/BLK
	Base	PA
	ROHS	Made to order