

**PLEASE CHECK WWW.MOLEX.COM FOR LATEST PART INFORMATION**

**Part Number:** [19069-0054](#)  
**Status:** **Active**  
**Overview:** Ring Tongue - Spade Terminals  
**Description:** Krimptite™ Ring Tongue Terminal for 18-22 AWG Wire

**Documents:**

[Drawing \(PDF\)](#) [Product Specification PS-19902-013 \(PDF\)](#)  
[Product Specification PS-19902-011 \(PDF\)](#) [RoHS Certificate of Compliance \(PDF\)](#)

**Agency Certification**

CSA LR18689  
 UL E32244

**General**

Product Family Ring and Spade Terminals  
 Series [19069](#)  
 Crimp Quality Equipment Yes  
 Mil-Spec N/A  
 Overview [Ring Tongue - Spade Terminals](#)  
 Product Name Krimptite™  
 Type Ring  
 UPC 800753067820

**Physical**

Barrel Type Closed  
 Insulation None  
 Material - Plating Mating Tin  
 Material - Plating Termination Tin  
 Net Weight 0.435/g  
 Packaging Type Bag  
 Plating min - Mating 2.540µm  
 Plating min - Termination 2.540µm  
 Stud Size 5-6 (M3-3.5)  
 Termination Interface: Style Crimp or Compression  
 Wire Size AWG 18, 20, 22  
 Wire Size mm² 0.35 - 0.80

**Material Info**

Old Part Number AA-132-06

**Reference - Drawing Numbers**

Product Specification PS-19902-011, PS-19902-013  
 Sales Drawing SD-19069-004

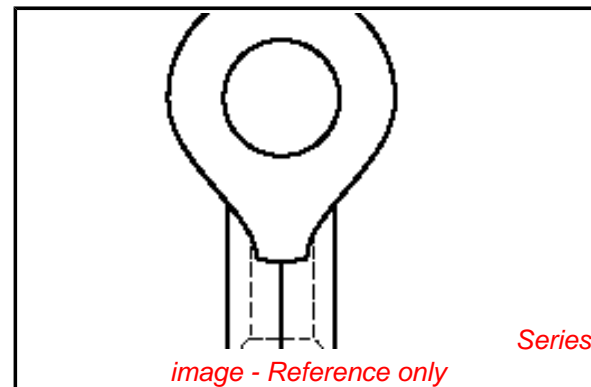

**EU RoHS**

**ELV and RoHS  
 Compliant**  
**REACH SVHC  
 Contains SVHC: No**  
**Low-Halogen Status  
 Low-Halogen**

**China RoHS**



**Need more information on product  
 environmental compliance?**

Email [productcompliance@molex.com](mailto:productcompliance@molex.com)  
 For a multiple part number RoHS Certificate of Compliance, [click here](#)

Please visit the [Contact Us](#) section for any non-product compliance questions.

**Search Parts in this Series**

19069Series

**Application Tooling | FAQ**

*Tooling specifications and manuals are found by selecting the products below. Crimp Height Specifications are then contained in the Application Tooling Specification document.*

**Global**

Description	Product #
PremiumGrade™ Hand Crimp Tool	<a href="#">0640030100</a>
Crimp Head for the AT-200™ Pneumatic Hand Tool	<a href="#">0640070100</a>

**PLEASE CHECK WWW.MOLEX.COM FOR LATEST PART INFORMATION**