

Dimensions in mm

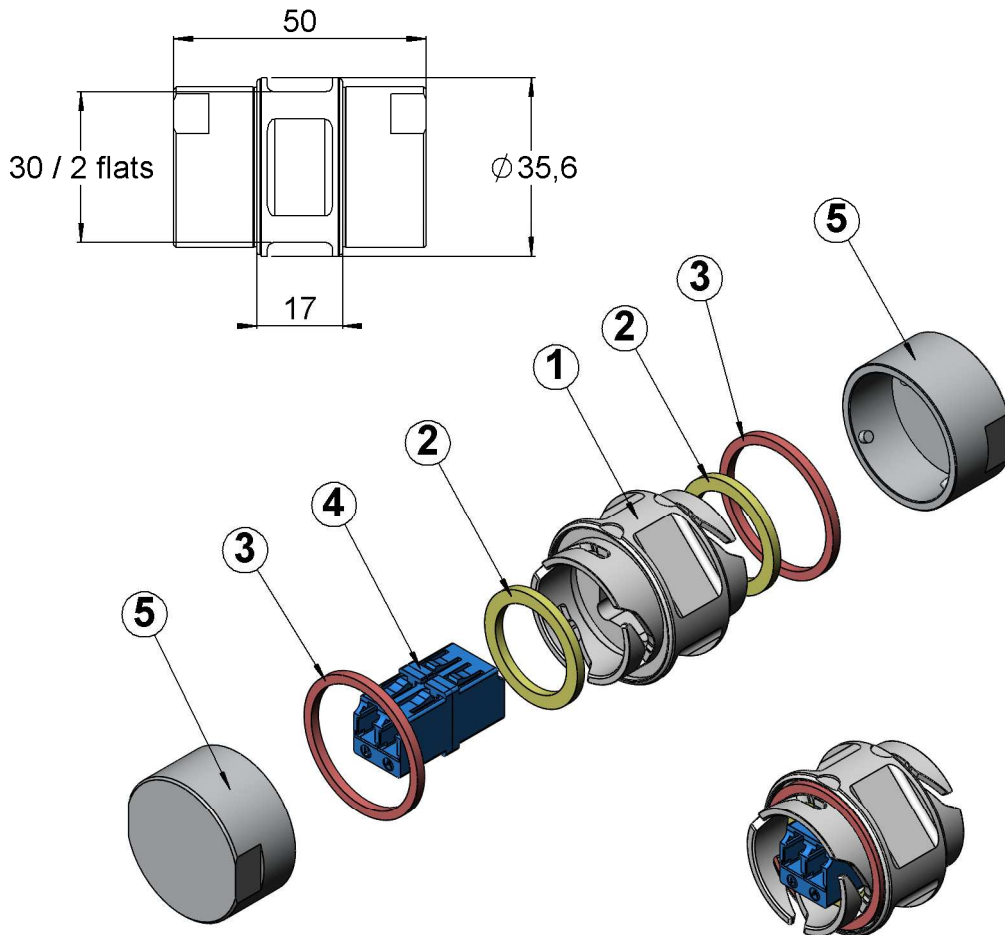

PATENT PENDING

### DESCRIPTION

REP	COMPONENT	MATERIALS	PLATING
1	ADAPTOR BODY	ALUMINIUM	-
2	GASKET PANEL SEALING	SILICONE	-
3	GASKET CONNECTION SEALING	SILICONE	-
4	SM LC DUPLEX ADAPTOR (BLUE)	-	-
5	PROTECTION CAP	ALUMINIUM	-

<b>CREATION</b> N°Project : EPC0812 Name: RD Date: 23/12/2012 Appr.: CB				
	1247 A	Creation	RD	CB
	Issue	Revisions	Name	Appr.

**RADIALL®**  
 101, rue P. Hoffmann  
 93116 ROSNY/BOIS  
 FRANCE  
 Tel : (33) 0149353535  
 Fax : (33) 0148546363

Dimensions in mm

**GENERAL CHARACTERISTICS**

<p><b>Mechanical</b> Endurance Vibrations</p>	<p>100 mating cycles In accordance with IEC 61300-2-1 IEC 60721-3-4 class 4M5 ETSI EN 300 019-2-4</p>
<p><b>Optical</b> Signal Alignment sleeve Other information</p>	<p>Singlemode Zirconia See technical data sheet F727.750.000 (LC DPLX SM ADAPTOR)</p>
<p><b>Environmental</b> Protection Operating temperature</p>	<p>IP67 (plugged with metal protection cap or mated part) -40°C to +85°C</p>
<p><b>Weight</b></p>	<p>61,35g</p>

**PACKAGING :**

TBD

<p><b>CREATION</b> N°Project : EPC0812 Name: RD Date: 23/12/2012 Appr.: CB</p>				
	1247 A	Creation	RD	CB
	Issue	Revisions	Name	Appr.
	<p><b>RADIALL®</b> 101, rue P. Hoffmann 93116 ROSNY/BOIS FRANCE Tel : (33) 0149353535 Fax : (33) 0148546363</p>			