

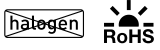

Junction boxes, COMBI 1210

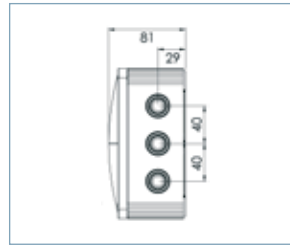

COMBI 1210

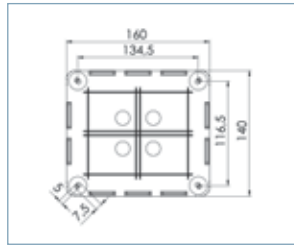

**Protection class:** IP 66 / 67  
**Glow wire test:** 750 °C  
**Temperature range:** -30 °C - 100 °C  
**Installation temperature:** -5 °C - 60 °C  
**Voltage:** 690 V  
**Terminals/poles:** 10 mm<sup>2</sup>  
**Advice:** 10 entries M 20 with soft membrane and threaded and M 25 knockout opening, Colour: RAL 7035 · .../S = RAL 9005 · .../W = RAL 9001  
**Material:** Polypropylene, Gasket: TPE

Type	WISKA-No.	 (mm)		LxBxH external (mm)	
COMBI 1210/empty	10101459	3 · 12		160 x 140 x 81	2
COMBI 1210/empty/S	10101460	3 · 12		160 x 140 x 81	2
COMBI 1210/empty/W	10101461	3 · 12		160 x 140 x 81	2
COMBI 1210/5	10101462	3 · 12		160 x 140 x 81	2
COMBI 1210/5/S	10101463	3 · 12		160 x 140 x 81	2
COMBI 1210/5/W	10101464	3 · 12		160 x 140 x 81	2
DIN RAIL KIT 1210	10101478	-			1

POLYAMIDE  
 POLYAMIDE ACCESSORIES  
 MEMBRANE  
 BRASS  
 BRASS ACCESSORIES  
 MARITIME  
 STAINLESS STEEL  
 EMC  
 EX E / I  
 EX D  
 VENTING  
 BS 6121  
 SEALINGS, TOOLS  
 JUNCTION BOXES  
 TECHNICS  
 INDEX