

REV.	CNN	CNN DESCRIPTION	Date	Check in
AB	-	-	16/10/2013	Shaun Barron
01	-	-	20/03/2014	Shaun Barron

A  
B  
C  
D  
E

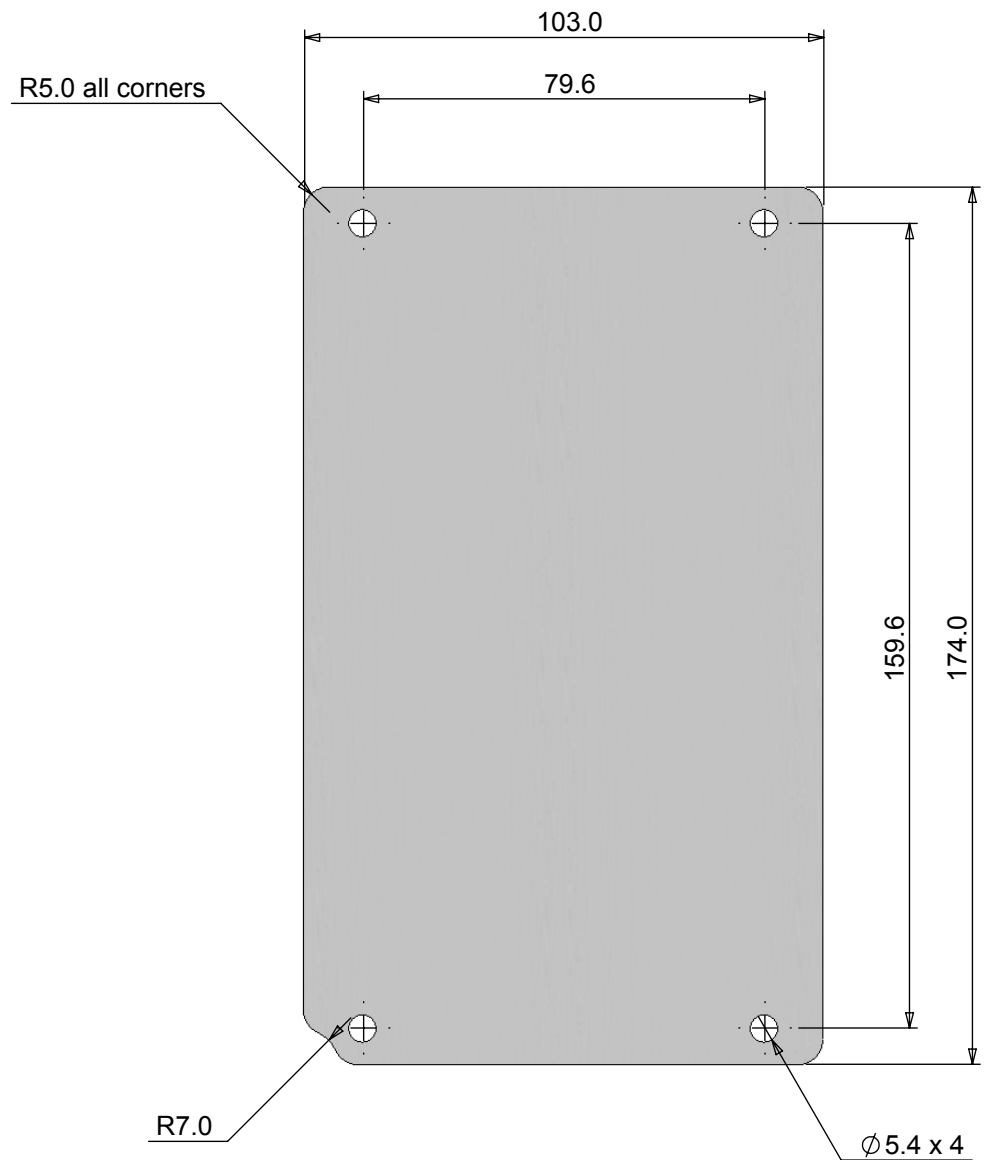
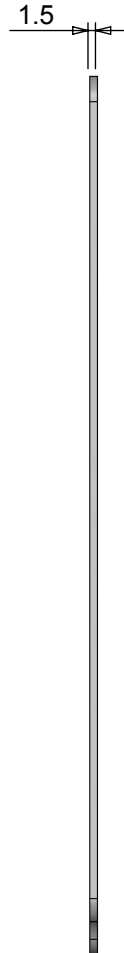

Tel No. +44(0)1724 273200 Website www.dem-uk.com

**Alpha3** manufacturing  
**ROXBURGH EMC**  
**DELTRON Components**  
**DELTRON Enclosures**

**PROPRIETARY AND CONFIDENTIAL**  
THE INFORMATION CONTAINED IN THIS DRAWING IS THE SOLE PROPERTY OF ALPHA 3 MANUFACTURING.  
ANY REPRODUCTION IN PART OR AS A WHOLE WITHOUT THE WRITTEN PERMISSION OF ALPHA 3 MANUFACTURING IS PROHIBITED.

**DEM** DEM Manufacturing, Deltron Emcon House  
Hargreaves Way, Sawcliffe Ind. Park,  
Scunthorpe, North Lincolnshire, DN15 8RF, UK

UNLESS OTHERWISE SPECIFIED:  
DIMENSIONS ARE IN MILLIMETRES.  
TOLERANCE:  
**NO DECIMAL PLACES ±0.2mm**  
**1 DECIMAL PLACE ±0.1mm**  
**2 DECIMAL PLACES ±0.05mm**  
**ANGULAR TOLERANCE: ±1°**

FINISH	Galvanised Steel Passivated	DEBURR AND BREAK SHARP EDGES
MATERIAL	1.5mm Galvanised Steel	

DRAWN BY	SPB
APPROVED BY	WC
THIRD ANGLE PROJECTION	SHEET 1 OF 1
	SCALE 1:1.5
	A4

TITLE	Heavy duty mounting plate for 486-221208 xx & 486-221209 xx
DRAWING NO.	4MP2212
ISSUE	<b>01</b> Release