



Auxiliary contact module, 2N/O+2N/C



Powering Business Worldwide™

Part no. DILM32-XHI22
Article no. 277377
Catalog No. XTCEXFCC22

Delivery programme

Product range
 Accessories
 Description
 Function
 Pole
 Connection technique
 Rated operational current
 AC-3
 Conventional free air thermal current, 3 pole, 50 - 60 Hz
 Open
 at 60 °C
 AC-15
 220 V 230 V 240 V
 380 V 400 V 415 V
 Contacts
 N/O = Normally open
 N/C = Normally closed
 Mounting type
 Contact sequence

$I_{th} = I_e$ A
 I_e A
 I_e A

Accessories
 Auxiliary contact modules with interlocked opposing contacts for standard applications
 4 pole
 Screw terminals

2 N/O
 2 N/C
 Front fixing

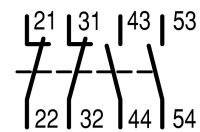

For use with

DILM(C)7-10...
 DILM(C)9-10...
 DILM(C)12-10...
 DILM(C)15-10...
 DILM(C)17-10...
 DILM(C)25-10...
 DILM(C)32-10...
 DILM38-10...
 DILMP20...
 DILMP32-10...
 DILMP45-10...
 DILL...
 Interlocked opposing contacts according to IEC/EN 60947-5-1 appendix L, inside the auxiliary contact modules, also for the integrated auxiliary contacts of the DILM 7 - DILM32
 Auxiliary contacts used as mirror contacts according to IEC/EN 60947-4-1 Appendix F (not N/C late open)

Instructions

Approvals

Product Standards
 UL File No.
 UL Category Control No.
 CSA File No.
 CSA Class No.
 North America Certification
 Specially designed for North America

IEC/EN 60947-4-1; UL 508; CSA-C22.2 No. 14-05; CE marking
 E29184
 NKCR
 012528
 3211-03
 UL listed, CSA certified
 No

Electrical specifications for standard auxiliary contacts

Interlocked opposing contacts within an auxiliary contact module (to IEC 60947-5-1 Annex L)
 N/C contact (not late-break contact) suitable as a mirror contact (to IEC/EN 60947-4-1 Annex F)
 Rated impulse withstand voltage

Overvoltage category/pollution degree

Rated insulation voltage

Rated operational voltage

Safe isolation to EN 61140

between coil and auxiliary contacts

between the auxiliary contacts

Rated operational current

		Yes
		DILM7 - DILM38
U_{imp}	V AC	6000
		III/3
U_i	V AC	690
U_e	V AC	500
	V AC	400
	V AC	400
	A	

Conventional free air thermal current, 3 pole, 50 - 60 Hz

Open
at 60 °C

AC-15
220 V 230 V 240 V
380 V 400 V 415 V
500 V

DC current

DC L/R $\frac{U}{I}$ 15 ms
24 V
60 V
110 V
220 V

DC-13 (6xP)
Contacts in series:
3
3
3
3

Control circuit reliability

Component lifespan
at $U_e = 230$ V, AC-15, 3 A

Short-circuit rating without welding
max. fuse

$I_{th} = I_e$	A	16
I_e	A	4
I_e	A	4
I_e	A	1.5
I_e	A	10
I_e	A	6
I_e	A	3
I_e	A	1
	A	
24 V	A	2.5
60 V	A	1
110 V	A	0.5
220 V	A	0.25
Failure rate	λ	$<10^{-8}$, < one failure at 100 million operations (at $U_e = 24$ V DC, $U_{min} = 17$ V, $I_{min} = 5.4$ mA)
Operations	$x 10^6$	1.3
	A gG/ gL	10

Technical data ETIM 5.0

Low-voltage industrial components (EG000017) / Auxiliary contact block (EC000041)

Electric engineering, automation, process control engineering / Low-voltage switch technology / Component for low-voltage switching technology / Auxiliary switch block
(ecl@ss8-27-37-13-02 [AKN342009])

Number of contacts as change-over contact		0
Number of contacts as normally open contact		2
Number of contacts as normally closed contact		2
Rated operation current I_e at AC-15, 230 V	A	6
Type of electric connection		Screw connection
Mounting method		Front fastening

Dimensions

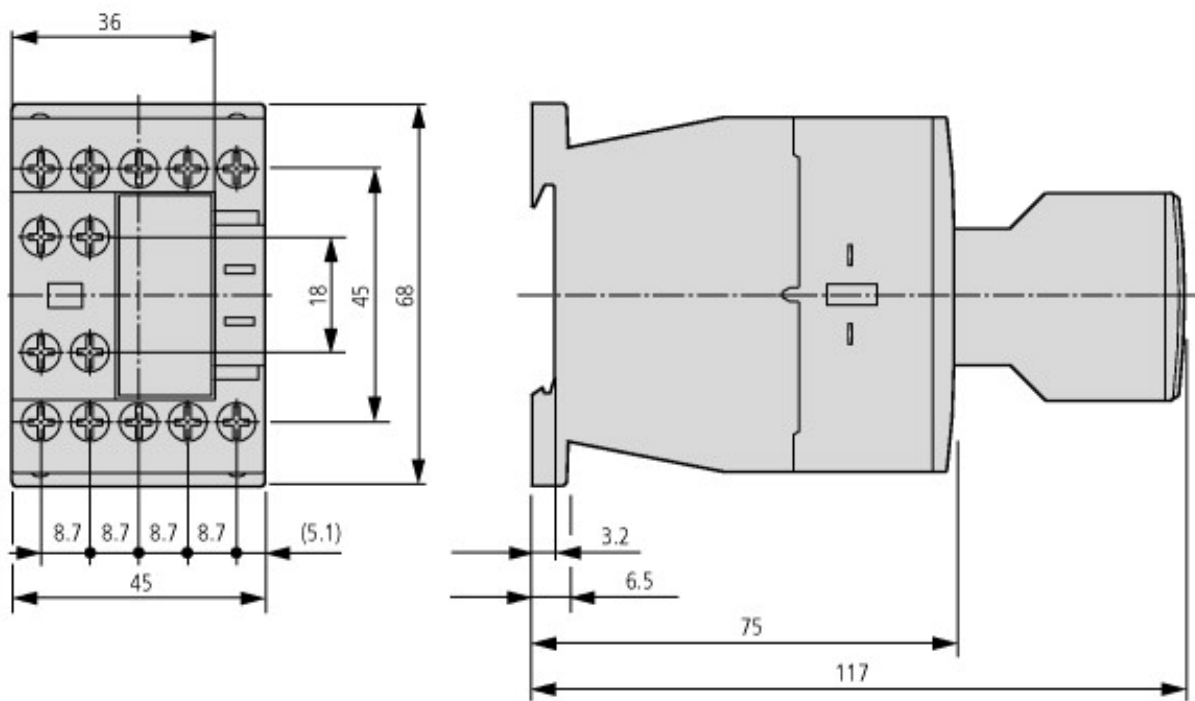

Contacteur avec module de contact auxiliaire

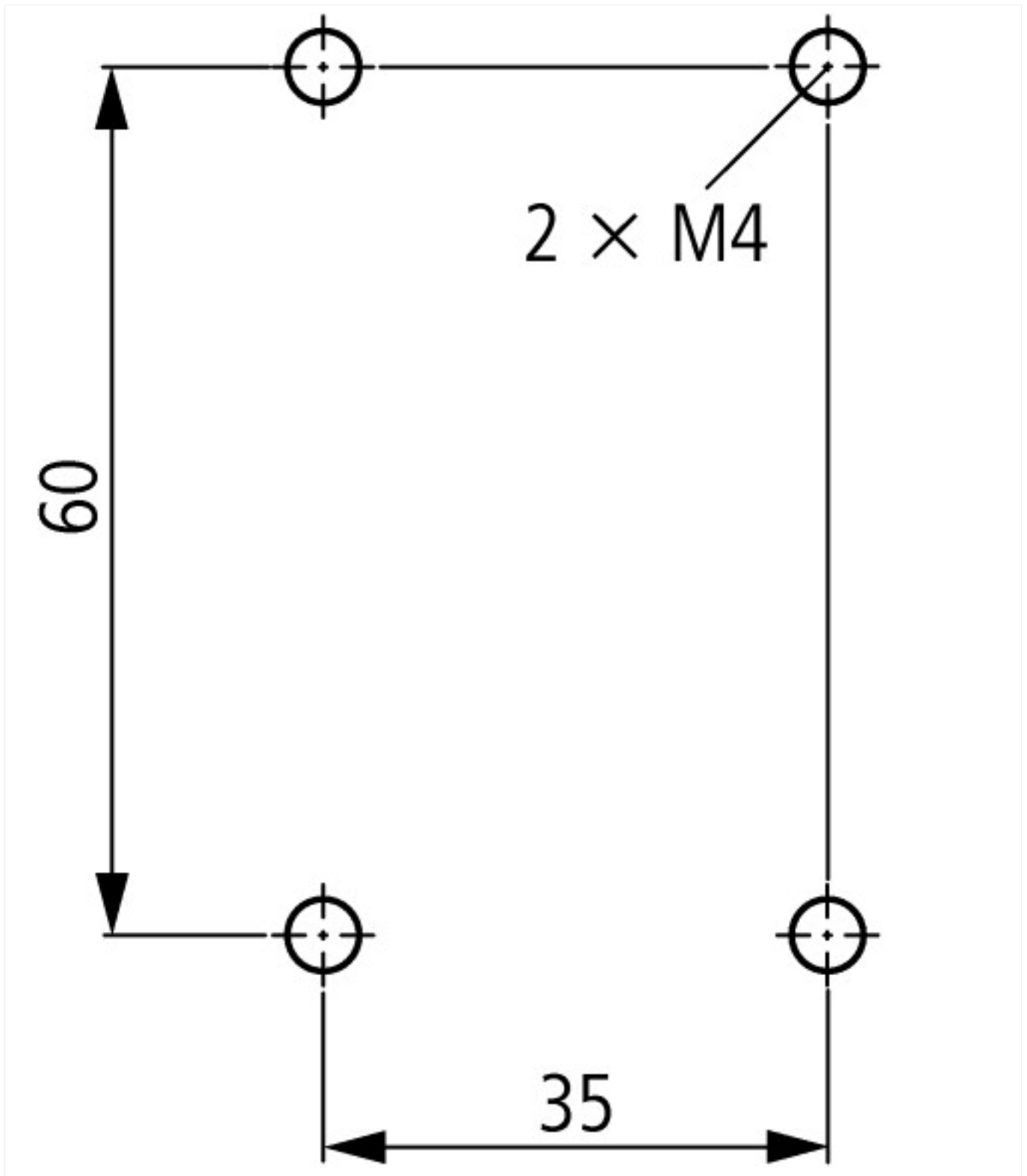

Additional product information (links)

IL03407013Z (AWA2100-2126) Contactors

IL03407013Z (AWA2100-2126)
Contactors

ftp://ftp.moeller.net/DOCUMENTATION/AWA_INSTRUCTIONS/IL03407013Z2012_03.pdf

<http://de.ecat.moeller.net/flip-cat/?edition=HPLTE&startpage=5.84>

Switchgear of Power Factor Correction
Systems

http://www.moeller.net/binary/ver_techpapers/ver934en.pdf

X-Start - Modern Switching
Installations Efficiently Fitted and
Wired Securely

http://www.moeller.net/binary/ver_techpapers/ver938en.pdf

Mirror Contacts for Highly-Reliable
Information Relating to Safety-Related
Control Functions

http://www.moeller.net/binary/ver_techpapers/ver944en.pdf

Effect of the Cabel Capacitance of
Long Control Cables on the Actuation
of Contactors

http://www.moeller.net/binary/ver_techpapers/ver949en.pdf

Motor starters and "Special Purpose Ratings" for the North American market	http://www.moeller.net/binary/ver_techpapers/ver953en.pdf
Switchgear for Luminaires	http://www.moeller.net/binary/ver_techpapers/ver955en.pdf
Standard Compliant and Functionally Safe Engineering Design with Mechanical Auxiliary Contacts	http://www.moeller.net/binary/ver_techpapers/ver956en.pdf
The Interaction of Contactors with PLCs	http://www.moeller.net/binary/ver_techpapers/ver957en.pdf
Busbar Component Adapters for modern Industrial control panels	http://www.moeller.net/binary/ver_techpapers/ver960en.pdf