



Indicator light, flush, white



Powering Business Worldwide™



Part no.  
Article no.  
Catalog No.

M22-L-W  
216771  
M22-L-WQ

## Delivery programme

Product range

Basic function

Single unit/Complete unit

Colour

RMQ-Titan (drilling dimensions 22.5

mm)

Indicator lights

Single unit

Design

Protection type

Front ring

Connection to SmartWire-DT

White

Flush

IP67, IP69K

Front ring: titanium

yes

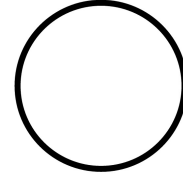

## Approvals

Product Standards

UL File No.

UL Category Control No.

CSA File No.

CSA Class No.

North America Certification

Degree of Protection

IEC/EN 60947-5; UL 508; CSA-C22.2 No. 14-05; CSA-C22.2 No. 94-91; CE marking

E29184

NKCR

012528

3211-03

UL listed, CSA certified

UL/CSA Type 3R, 4X, 12, 13

## General

Standards

Protection type

Climatic proofing

Ambient temperature

Open

Mounting position

Mechanical shock resistance

Terminal capacity

Solid

Stranded

|  |                 |  |
|--|-----------------|--|
|  |                 | IEC/EN 60947<br>VDE 0660   |
|  |                 | IP67, IP69K  |
|  |                 | Damp heat, constant, to IEC 60068-2-78<br>Damp heat, cyclic, to IEC 60068-2-30 |
|  | °C              |  |
|  | °C              | - 25 - + 70  |
|  |                 | As required  |
|  | g               | 30<br>Shock duration 11 ms<br>Sinusoidal<br>according to IEC 60068-2-27        |
|  | mm <sup>2</sup> | 0.5 - 1.5  |
|  | mm <sup>2</sup> | 0.5 - 1.5  |

## Contacts

Rated impulse withstand voltage

Rated insulation voltage

Overvoltage category/pollution degree

|           |         |       |
|-----------|---------|-------|
| $U_{imp}$ | V<br>AC | 4000  |
| $U_i$     | V       | 250   |
|           |         | III/3 |

## Technical data ETIM 5.0

Low-voltage industrial components (EG000017) / Front element for indicator light (EC000223)

Electric engineering, automation, process control engineering / Low-voltage switch technology / Command and alarm device / Front element for warning lights

(ec1@ss8-27-37-12-11 [AKF029010])

Suitable for number of built-in signal lights

Colour lens

Construction type lens

Hole diameter

Width opening

Height meter opening

With front ring

Material front ring

Colour front ring

Type of lens

Degree of protection (IP), front side

1

White

Round

22

22

6

Yes

Plastic

Chrome

Flat

IP67

## Dimensions

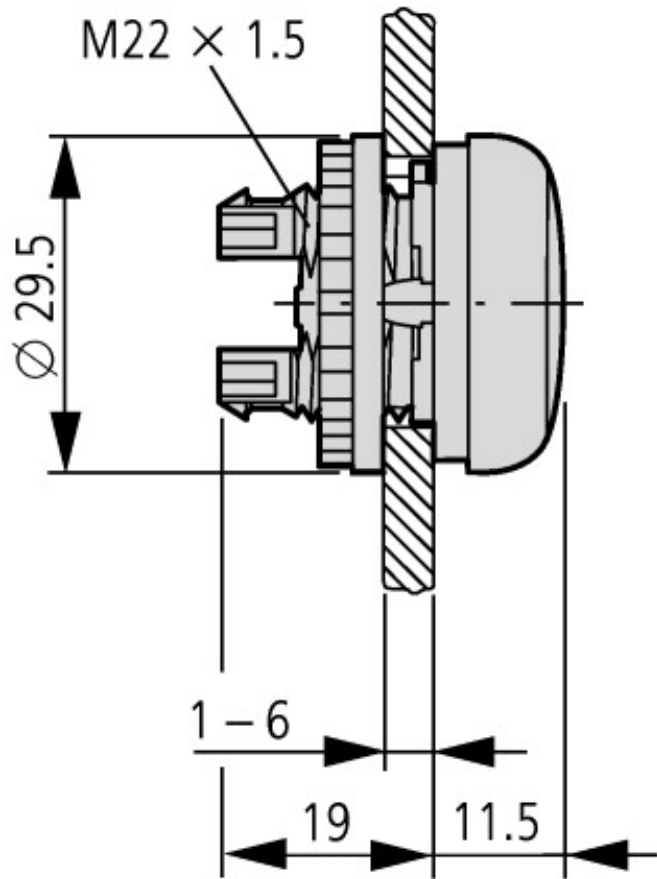
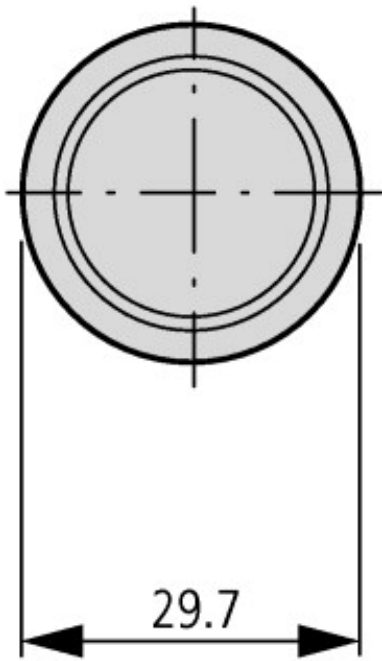

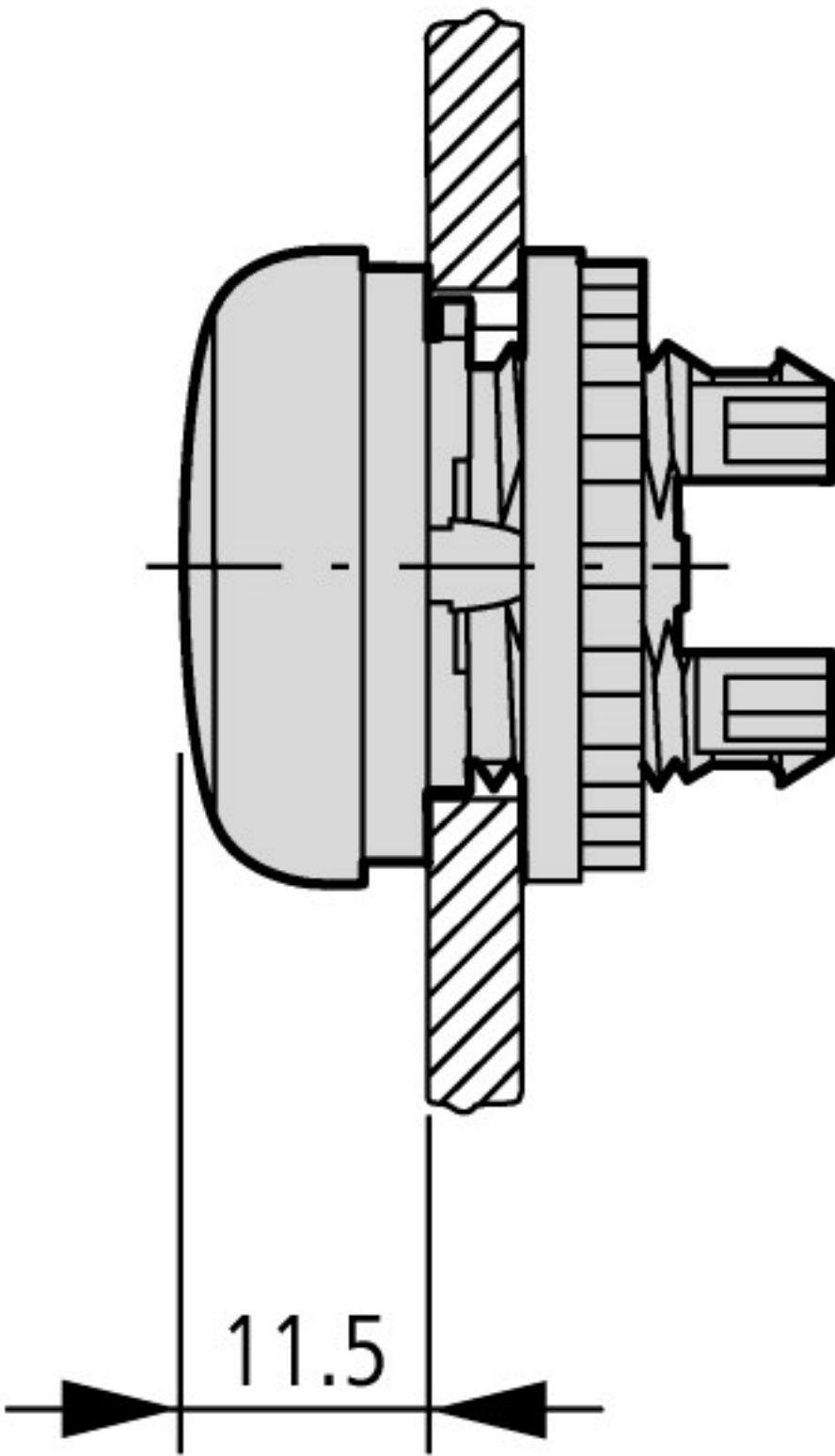

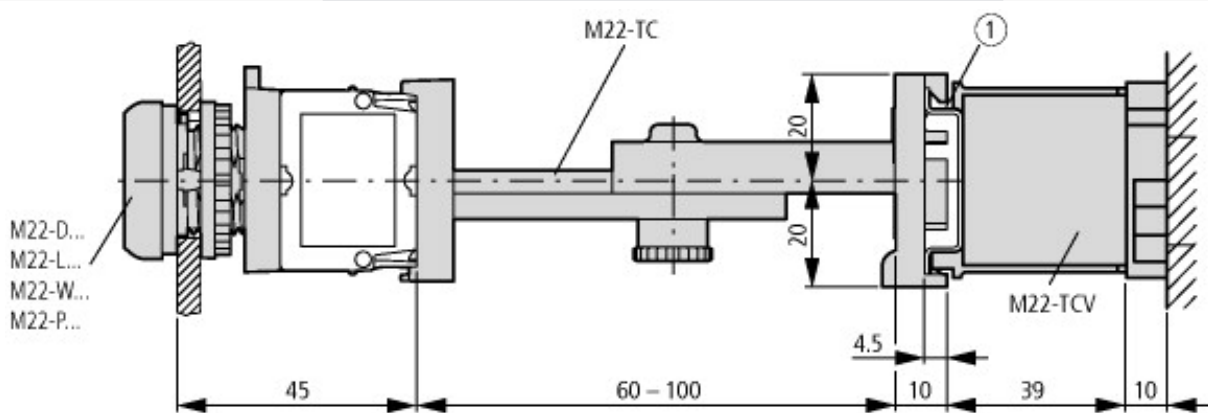
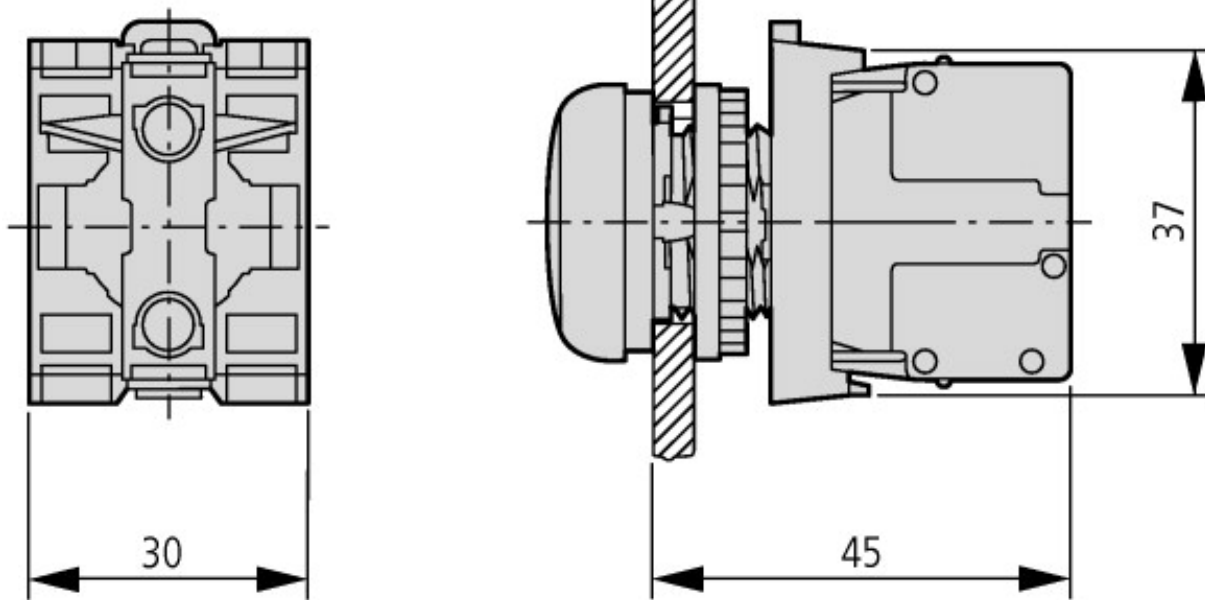

Pushbuttons and indicator lights with M22-TC telescopic clip and M22-TCV extension

① Top-hat rail to IEC/EN 60715

### Additional product information (links)

IL04716002Z (AWA1160-1745) RMQ-Titan System

IL04716002Z (AWA1160-1745) RMQ-Titan System

[ftp://ftp.moeller.net/DOCUMENTATION/AWA\\_INSTRUCTIONS/IL04716002Z2013\\_08.pdf](ftp://ftp.moeller.net/DOCUMENTATION/AWA_INSTRUCTIONS/IL04716002Z2013_08.pdf)



## Mounting clamp

**Part no.** **M22-A**  
**Article no.** **216374**

**Catalog No.** **M22-AQ**



Powering Business Worldwide™



## Delivery programme

Product range

Basic function

Basic function accessories

Subrange

Accessories

Single unit/Complete unit

Function

Fixing

Description

For use with

For use with

Configuration

Protection type

Connection to SmartWire-DT

RMQ-Titan (drilling dimensions 22.5 mm)

Accessories

Fixing adapters

Mounting adapter

Accessories RMQ

Fixing adapters

Single unit

Mounting clamp (front mounting) for 3-contact LED elements

Front fixing

for 1 function element M22-SWD-K...

or LED element M22-SWD-LED...

in addition 1 or 2 contact elements

M22-K.. possible

Sequence numbers on fixing adapter

Contact elements M22-(C)K...

LED elements M22-(C)LED...

M22-SWD-K...

M22-SWD-LED...

|       |       |       |
|-------|-------|-------|
| 1 / 4 | 3 / 6 | 2 / 5 |
|-------|-------|-------|

IP20

yes

## Approvals

Product Standards

UL File No.

UL Category Control No.

CSA File No.

CSA Class No.

North America Certification

IEC/EN 60947-5; UL 508; CSA-C22.2 No. 14-05; CSA-C22.2 No. 94-91; CE marking

E29184

NKCR

012528

3211-03

UL listed, CSA certified

## General

Standards

Lifespan, mechanical

Operating frequency

Operating torque (screw terminals)

Protection type

Climatic proofing

Ambient temperature

Open

Mounting position

Terminal capacities

Solid

Stranded

|              |                      |  |
|--------------|----------------------|--|
|              |                      | IEC/EN 60947<br>VDE 0660   |
| Operations   | x<br>10 <sup>6</sup> | > 5  |
| Operations/h |                      | 3600   |
|              | Nm                   | 0.8  |
|              |                      | IP20   |
|              |                      | Damp heat, constant, to IEC 60068-2-78<br>Damp heat, cyclic, to IEC 60068-2-30 |
|              | °C                   |  |
|              | °C                   | - 25 - + 70  |
|              |                      | As required  |
|              | mm <sup>2</sup>      |  |
|              | mm <sup>2</sup>      | 0.75 - 2.5   |
|              | mm <sup>2</sup>      | 0.5 - 2.5  |

## Contacts

Rated impulse withstand voltage

Rated insulation voltage

Overvoltage category/pollution degree

Control circuit reliability

at 24 V DC/5 mA

at 5 V DC/1 mA

|                  |                   |  |
|------------------|-------------------|--|
| U <sub>imp</sub> | V<br>AC           | 6000   |
| U <sub>i</sub>   | V                 | 500  |
|                  |                   | III/3  |
| H <sub>F</sub>   | Fault probability | < 10 <sup>-7</sup> , < 1 fault in 10 <sup>7</sup> operations           |
| H <sub>F</sub>   | Fault probability | < 5 x 10 <sup>-6</sup> , < 1 failure in 5 x 10 <sup>6</sup> operations |

**Max. short-circuit protective device**

Fuseless

Fuse

|       |      |                   |
|-------|------|-------------------|
|       | Type | PKZM0-10/FAZ-B6/1 |
| gG/gL | A    | 10                |

**Switching capacity**

## Rated operational current

## AC-15

115 V

220 V 230 V 240 V

380 V 400 V 415 V

500 V

## DC-13

24 V

42 V

60 V

110 V

220 V

|            |             |     |
|------------|-------------|-----|
| $I_e$      | A           |     |
| $I_e$      | A           | 6   |
| $I_e$      | A           | 6   |
| $I_e$      | A           | 4   |
| $I_e$      | A           | 2   |
| $I_e$      | A           | 3   |
| $I_e$      | A           | 1.7 |
| $I_e$      | A           | 1.2 |
| $I_e$      | A           | 0.8 |
| $I_e$      | A           | 0.3 |
| Operations | x<br>$10^6$ | 1.6 |
| Operations | x<br>$10^6$ | 1   |
| Operations | x<br>$10^6$ | 0.7 |
| Operations | x<br>$10^6$ | 1.2 |

## Lifespan, electrical

## AC-15

230 V/0.5 A

230 V/1.0 A

230 V/3.0 A

## DV-13

12 V/2.8 A

Indoor and protected outdoor installation

**Technical data ETIM 5.0**

Low-voltage industrial components (EG000017) / Adapter for control circuit devices (EC001020)

Electric engineering, automation, process control engineering / Low-voltage switch technology / Command and alarm device / Adapter for command devices  
(eci@ss8-27-37-12-26 [AKF044010])

Built-in diameter

mm

22

Number of appliances to build in

6

**Dimensions**

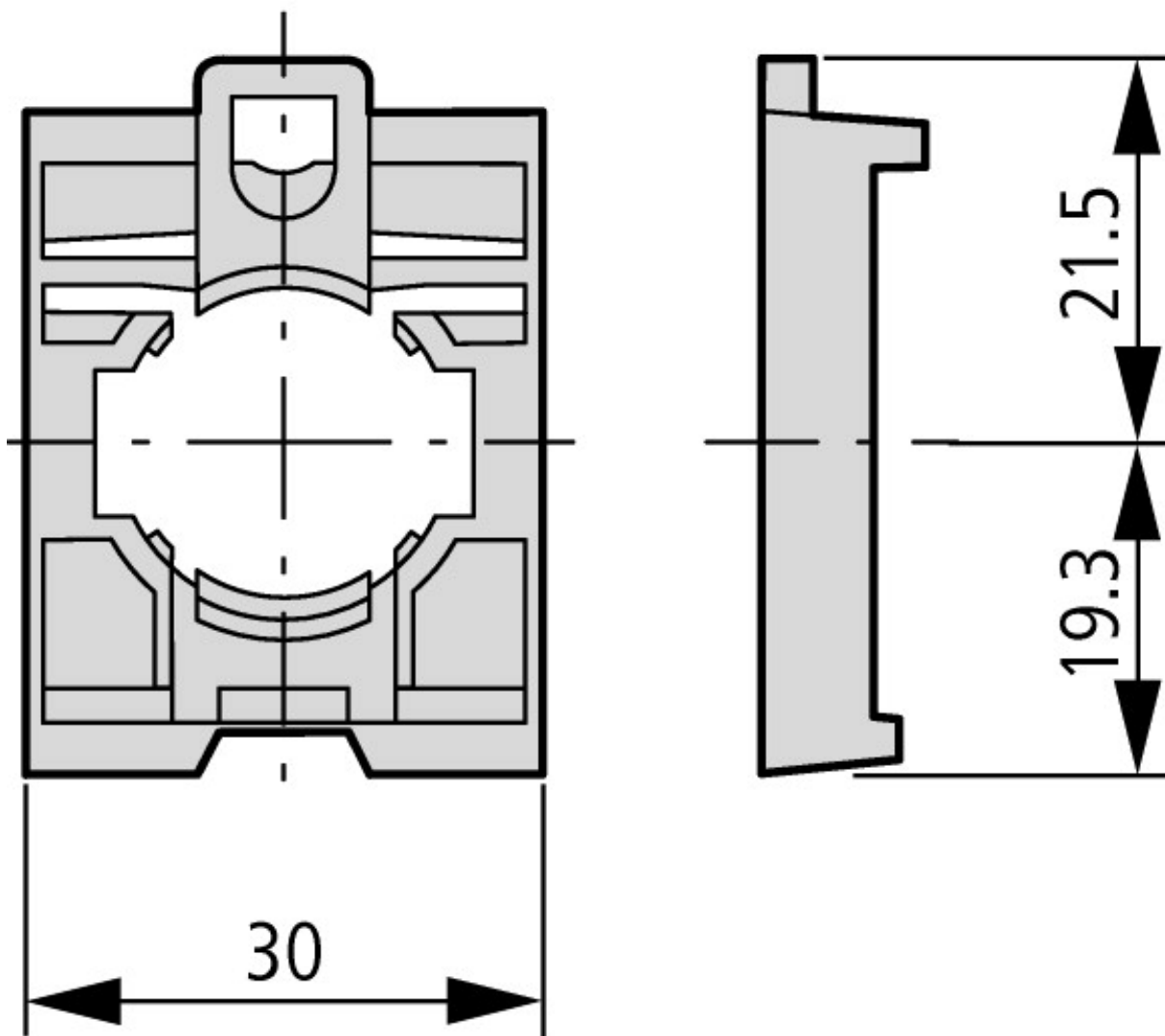

Fixing adapters  
 Fixing adapter (front mount) for 3-contacts-/LED elements

**Additional product information (links)**

**IL04716004Z (AWA1160-2511) SmartWire-DT: RMQ-Titan**

|   |   |
|---|---|
| IL04716004Z (AWA1160-2511)<br>SmartWire-DT: RMQ-Titan | <a href="ftp://ftp.moeller.net/DOCUMENTATION/AWA_INSTRUCTIONS/IL04716004Z2010_10.pdf">ftp://ftp.moeller.net/DOCUMENTATION/AWA_INSTRUCTIONS/IL04716004Z2010_10.pdf</a> |
|---|---|

**MN05006002Z-EN (AWB2723-1617) SmartWire-DT, The System**

|   |   |
|---|---|
| MN05006002Z-DE (AWB2723-1617)<br>SmartWire-DT, Das System - Deutsch | <a href="ftp://ftp.moeller.net/DOCUMENTATION/AWB_MANUALS/MN05006002Z_DE.pdf">ftp://ftp.moeller.net/DOCUMENTATION/AWB_MANUALS/MN05006002Z_DE.pdf</a> |
|---|---|

|   |   |
|---|---|
| MN05006002Z-EN (AWB2723-1617)<br>SmartWire-DT, The System - English | <a href="ftp://ftp.moeller.net/DOCUMENTATION/AWB_MANUALS/MN05006002Z_EN.pdf">ftp://ftp.moeller.net/DOCUMENTATION/AWB_MANUALS/MN05006002Z_EN.pdf</a> |
|---|---|

|  |   |
|--|---|
| MN05006002Z-IT (AWB2723-1617)<br>SmartWire-Darwin, Il sistema - italiano | <a href="ftp://ftp.moeller.net/DOCUMENTATION/AWB_MANUALS/MN05006002Z_IT.pdf">ftp://ftp.moeller.net/DOCUMENTATION/AWB_MANUALS/MN05006002Z_IT.pdf</a> |
|--|---|