

DETAILS

| | |
|------------------------|--------------------|
| Ordering Number | C13226_DOROTHY-4-A |
| Family | Dorothy |
| Type | Lens array |
| Color | clear |
| Diameter | 50.6 mm |
| Height | 4,5 mm |
| Style | round |
| Optic Material | PMMA |
| Holder Material | |
| Fastening | pin |
| Status | ready |
| ROHS Compliant | Yes |
| Date Updated | 25/09/2013 |



OPTICAL PROPERTIES

| LED | Viewing Angle | Light Beam | Efficiency | cd/lm |
|----------|-----------------|------------|------------------|-------------------|
| XP-E | (simulated) 155 | | (simulated) 90 % | (simulated) 0.000 |
| NVSxx19A | (simulated) 145 | | (simulated) 88 % | (simulated) 0.000 |
| NCSxx19A | 143 degrees | | 93 % | 0.277 |
| LUXEON R | 151 degrees | | 93 % | 0.256 |
| XP-G2 | 152 degrees | | 94 % | 0.300 |

Relative intensity of C13226_DOROTHY-4-A-(XPG2)

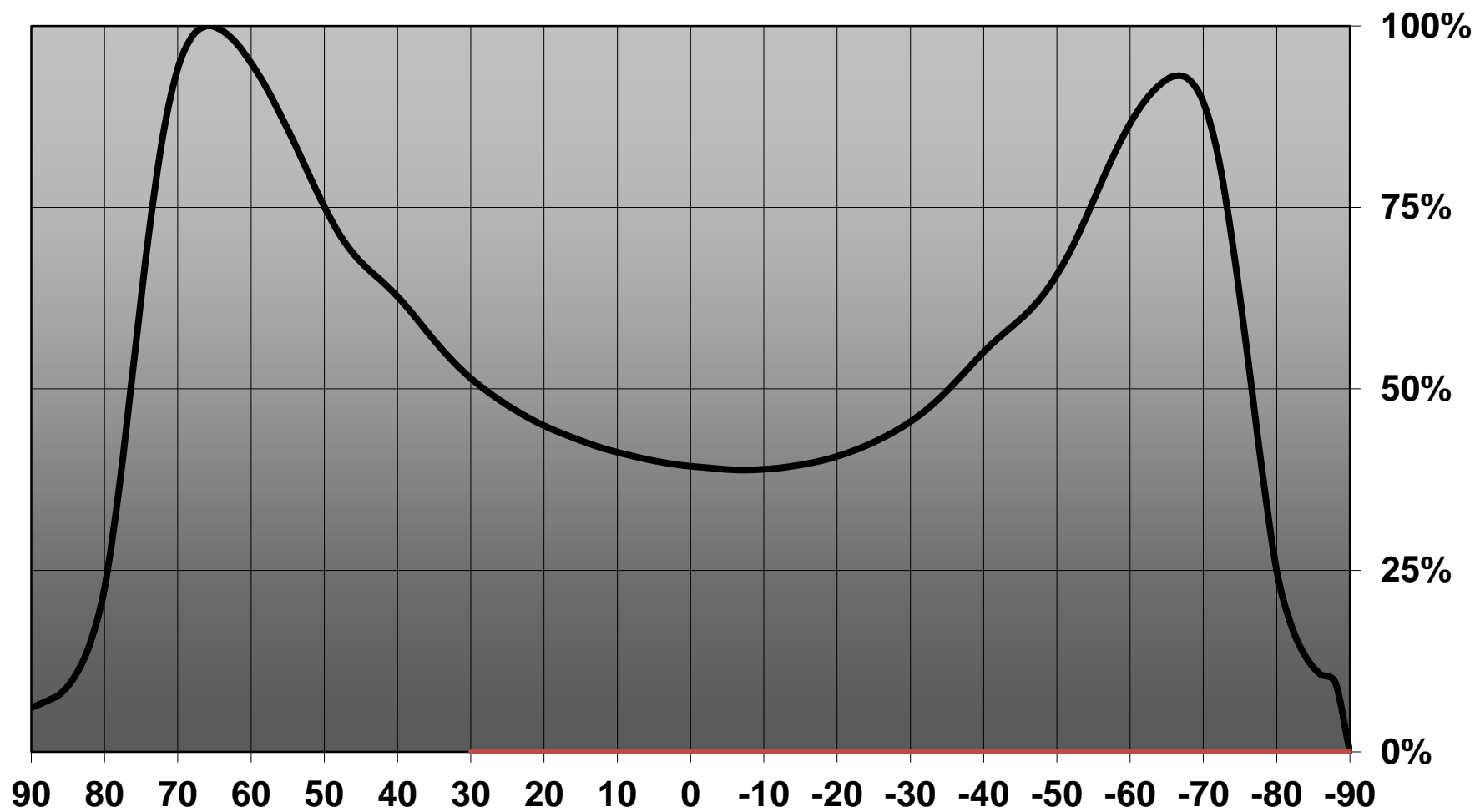

D

C

B

A

4

Bottom view

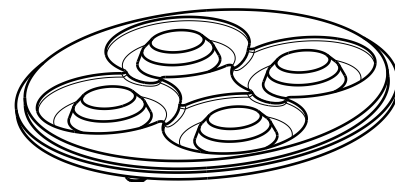
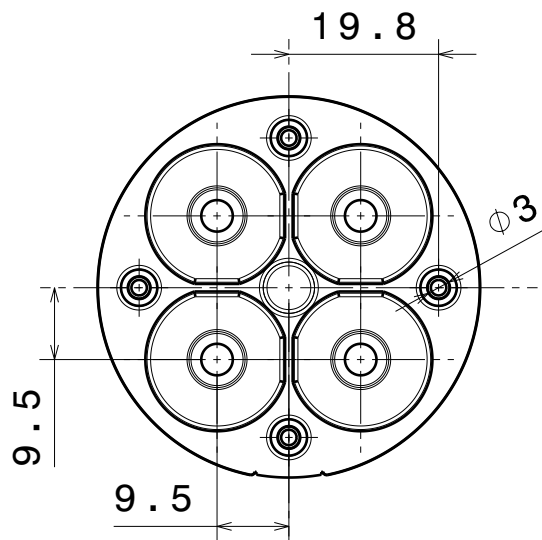

Isometric view

4

3

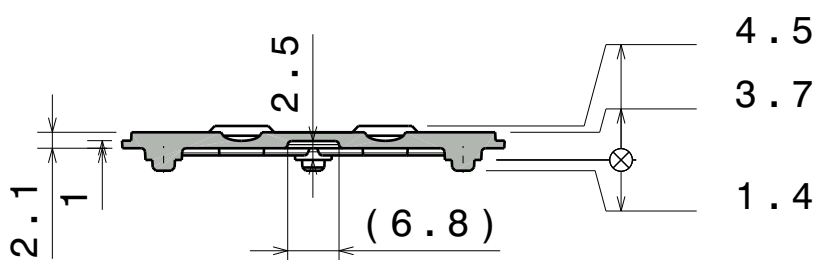
Section view
A-A

3

2

Top view

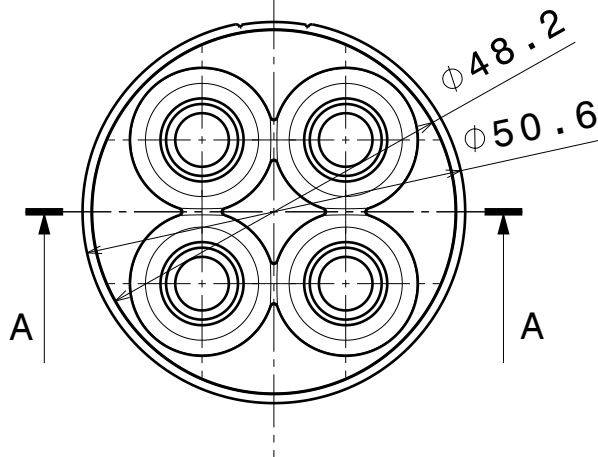

2

| INDEX | PART NO | DESCRIPTION | MATERIAL | COLOUR |
|-------|---------|-------------|----------|--------|
| 1 | C13226 | DOROTHY-4-A | PMMA | |

Tolerances if not otherwise shown
According to DIN ISO 2768-1
Linear measures:
Up to 30mm class F, otherwise class M.
According to DIN ISO 2768-2
Form and position: class K

LEDiL

Ledil Oy
Salorankatu 10
FIN 24240 SALO
Finland

THIRD ANGLE PROJECTION:

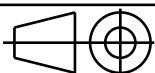

DRAWING TITLE

C13226_DOROTHY-4-A

This drawing is the property
of LEDiL Oy. It may not be
reproduced, copied or
communicated without a written
agreement with LEDiL Oy."

SIZE PART NUMBER

A4

C13226

SCALE 1:1 WEIGHT 4,3 g SHEET 1/1

D

A

1

Luminaire: LEDiL Oy C13226_DOROTHY-4-A_(NCS19) Eff. 92,6%
Lamps: 1 x Nichia NCSxx19 (330@250mA)

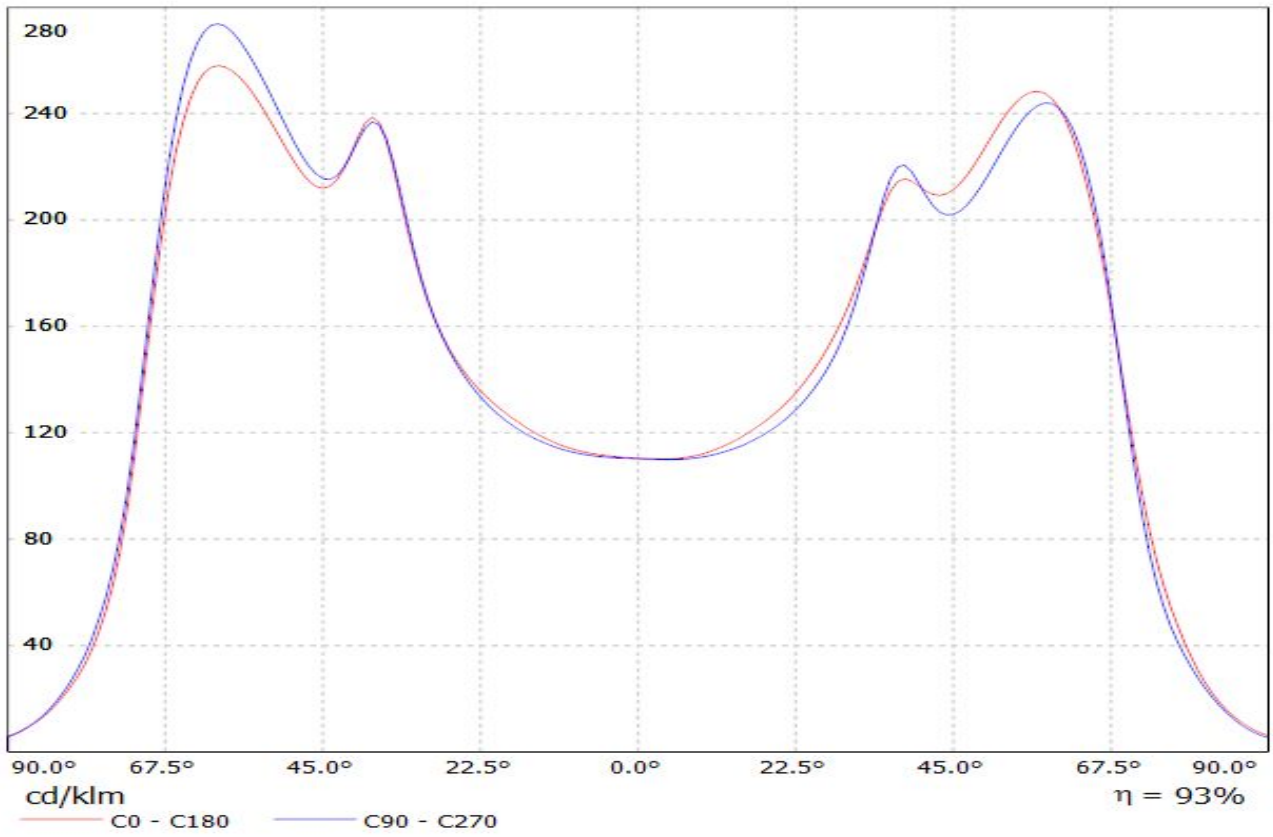

Luminaire: LEDiL Oy C13226_DOROTHY-4-A_(XT-E) Eff. 93,2%
Lamps: 1 x Cree XT-E (296lm@250mA)

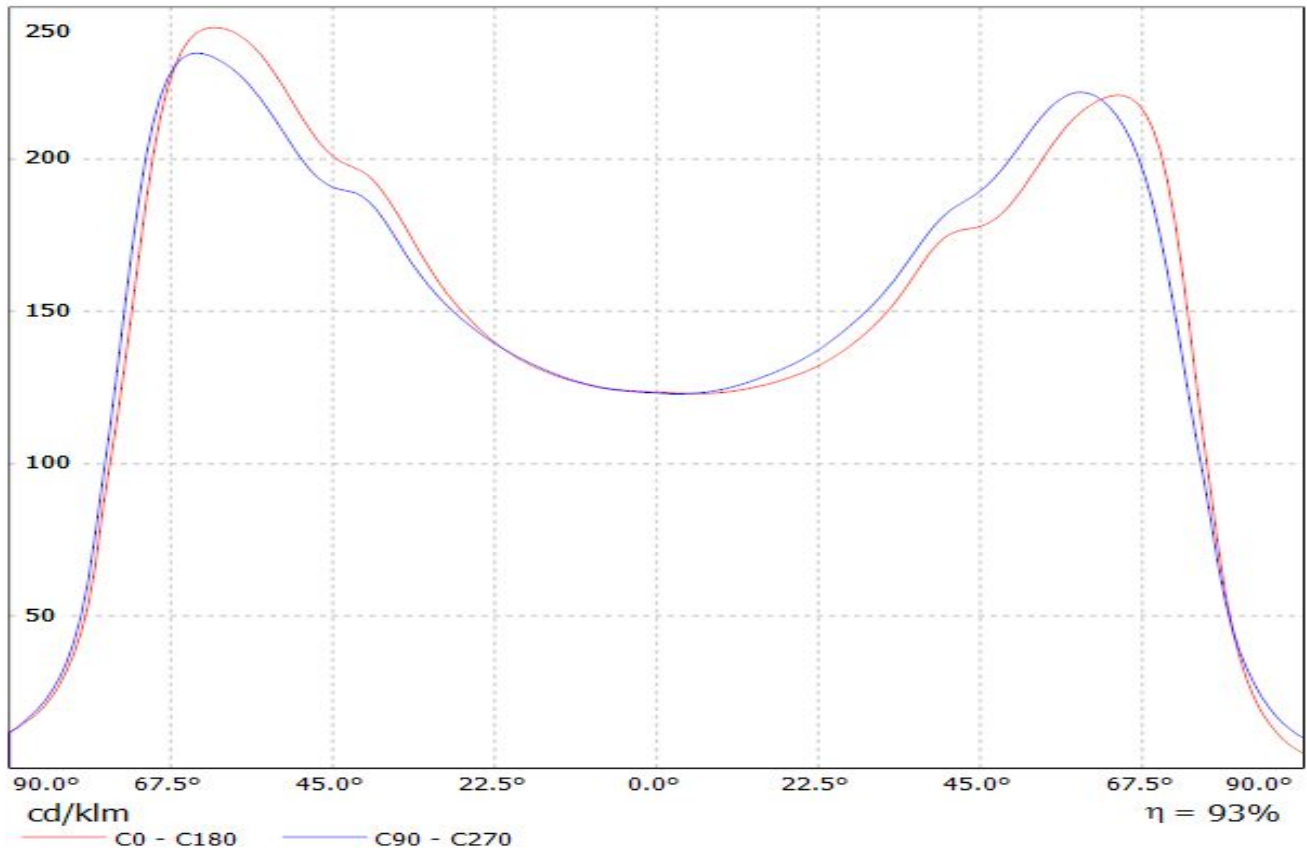

Luminaire: LEDiL Oy C13226_DOROTHY-4-A_(NVS19B) Eff. 93%
Lamps: 1 x Nichia NVSxx19B (301@250mA)

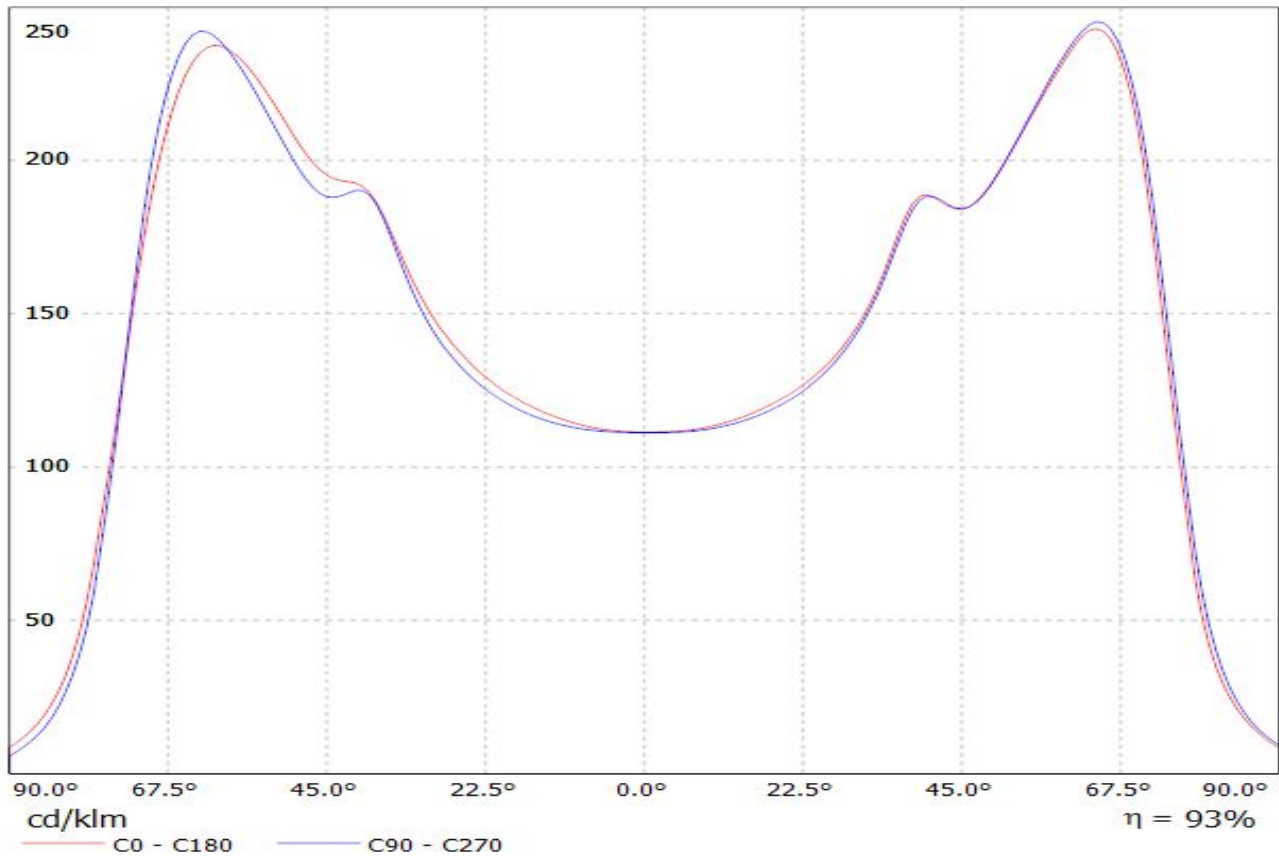

Luminaire: LEDiL Oy C13226_DOROTHY-4-A_(REBEL) Eff.91.5%
Lamps: 1 x Luxeon REBEL (250lm@250mA)

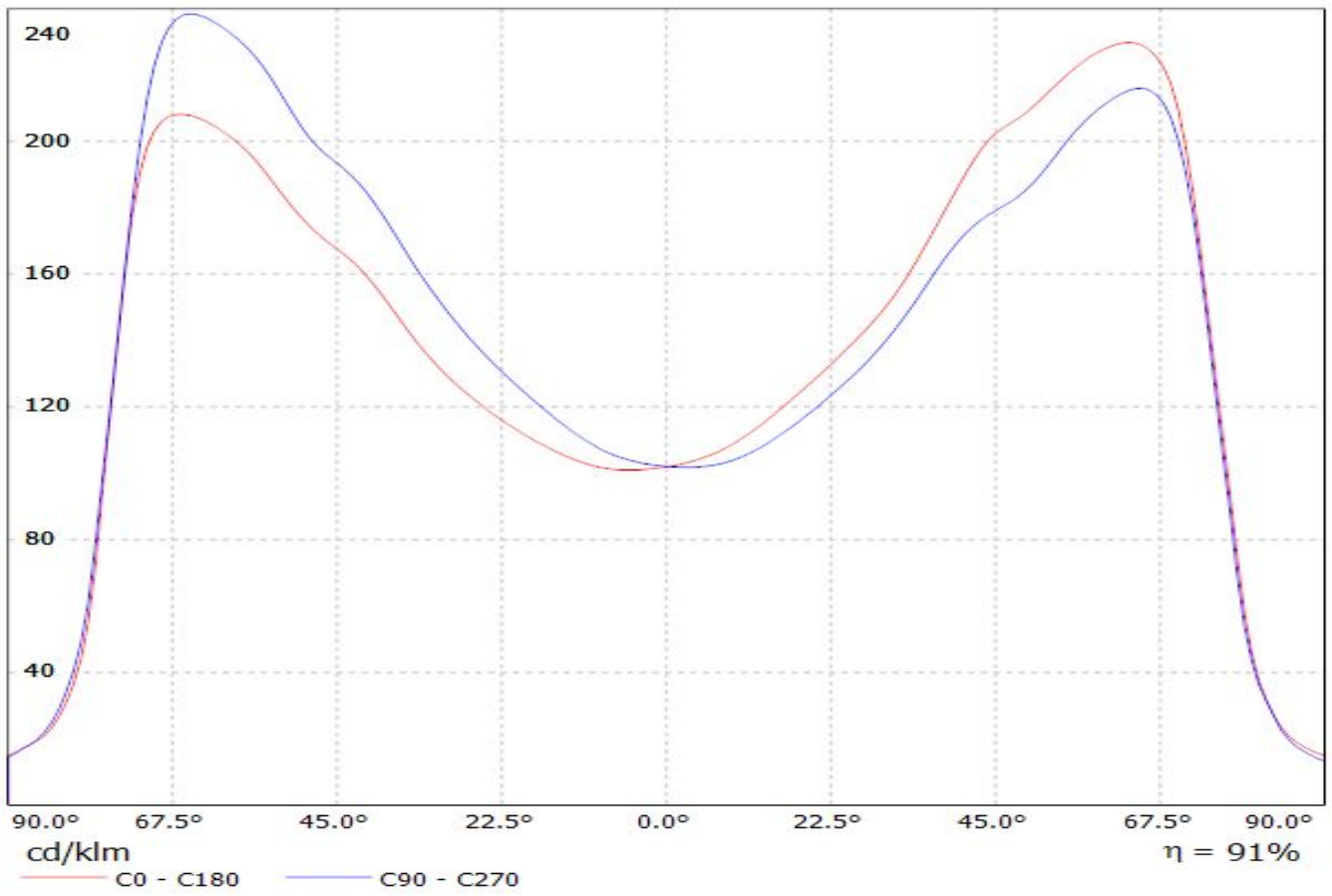

Luminaire: LEDiL Oy C13226_DOROTHY-4-A_(XP-G) Eff. 93,3%
Lamps: 1 x Cree XP-G (254@250mA)

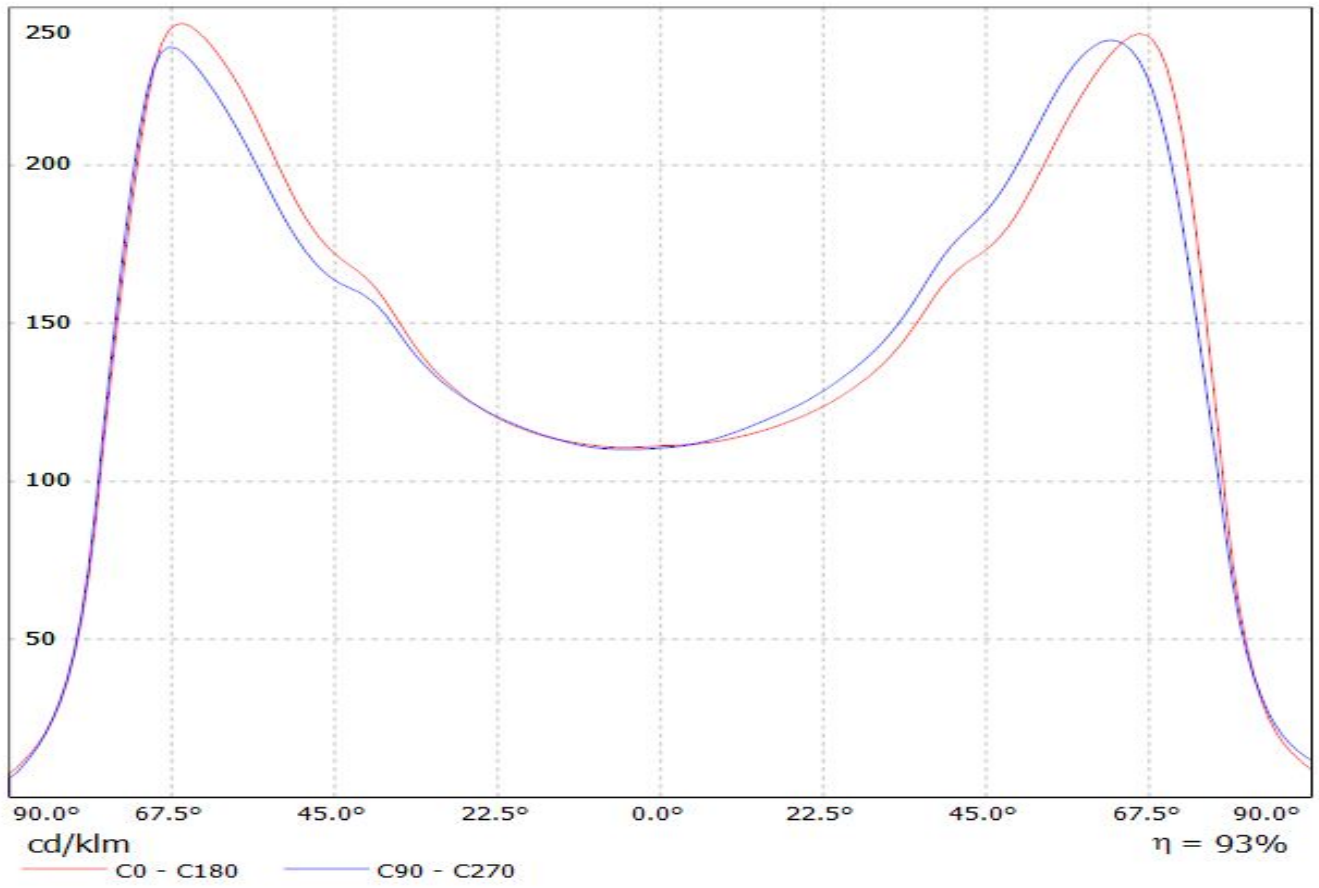

Luminaire: LEDiL Oy C13226_DOROTHY-4-A_(XT-E) Eff. 93,2%
Lamps: 1 x Cree XT-E (296lm@250mA)

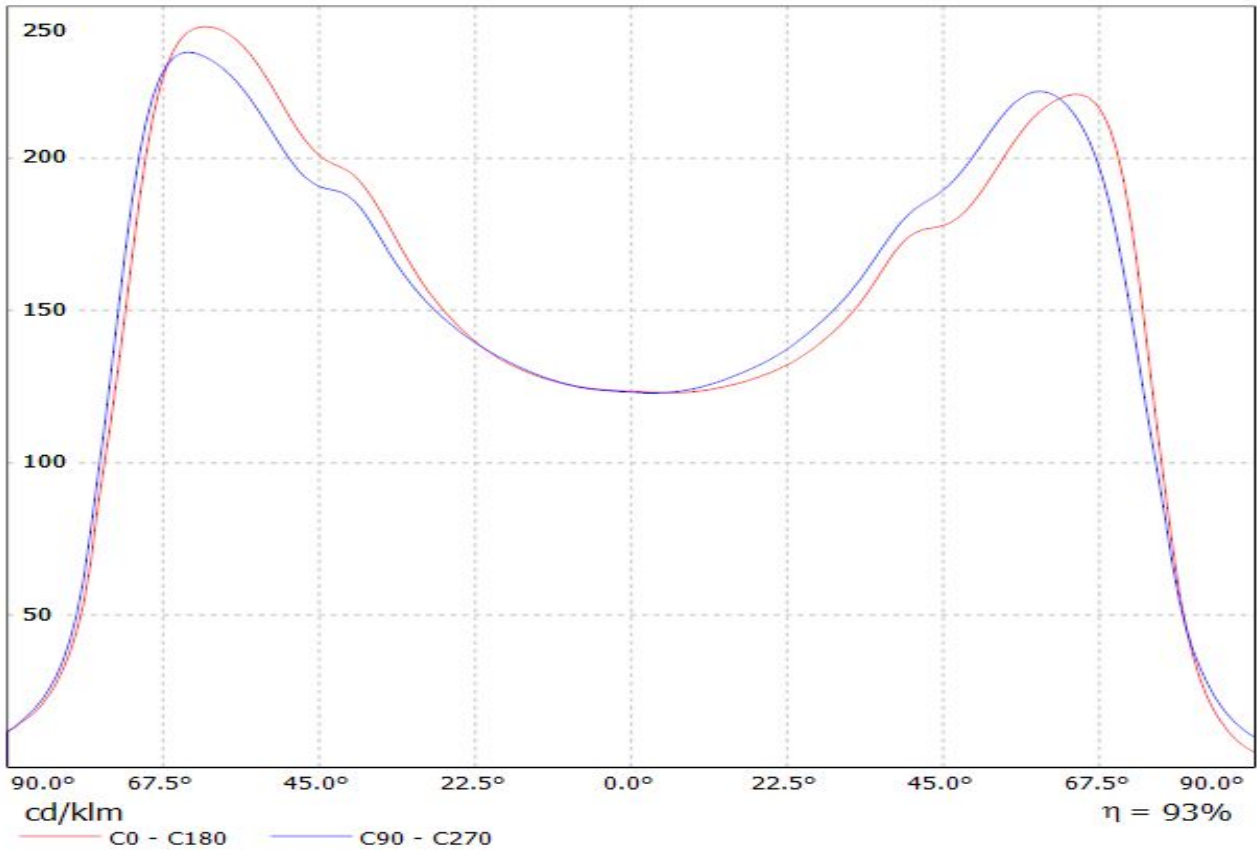

Luminaire: LEDiL Oy C13226_DOROTHY-4-A_(Luxeon_A) Eff. 92,5%
Lamps: 1 x Luxeon A (265@250mA)

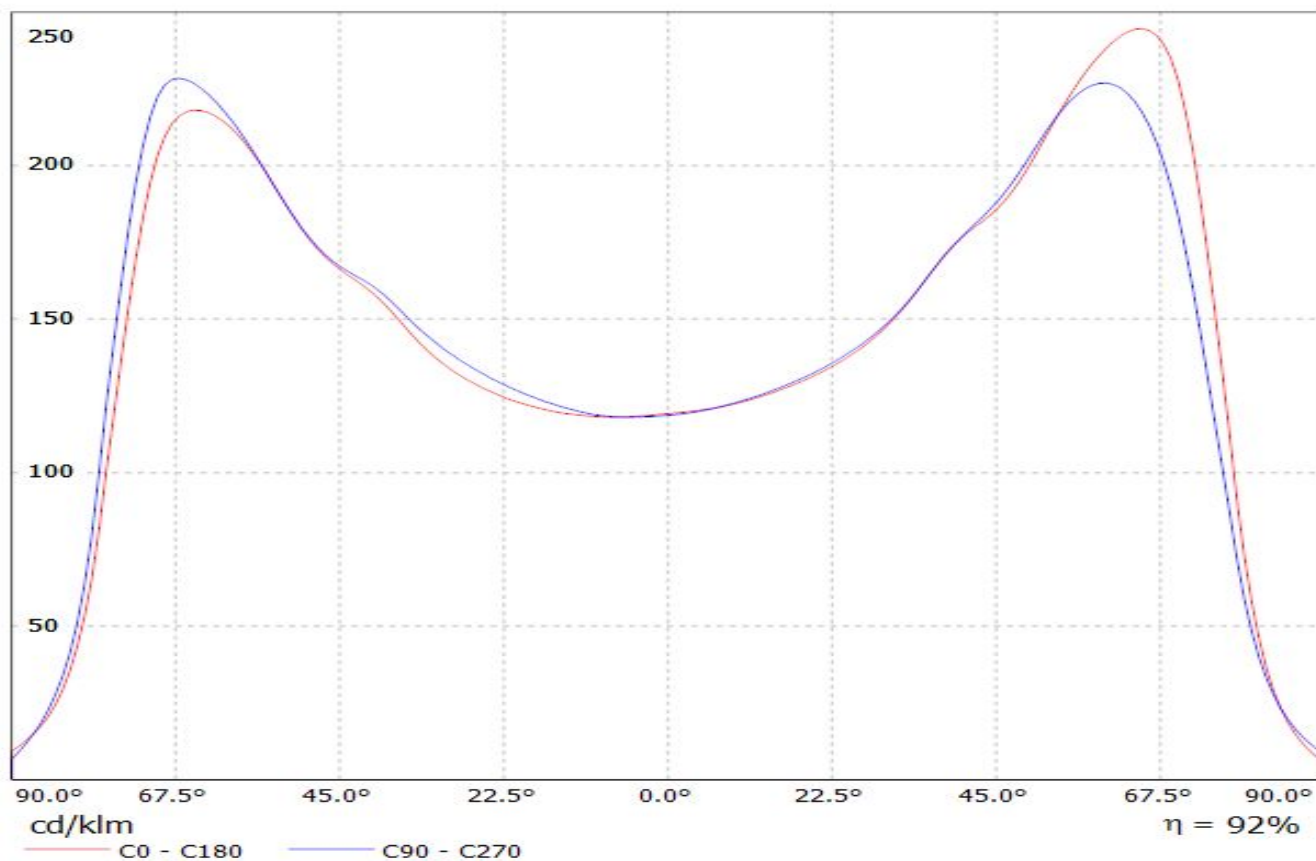

Luminaire: Led8-0y-0183M (DOROTHY-4-A, 800x400mm) Efficiency:82%

Lamps: 1 x Nichia NSCBA150 (4000, 1100lm) Recommended CCT: 3000 P=30W 4000lm

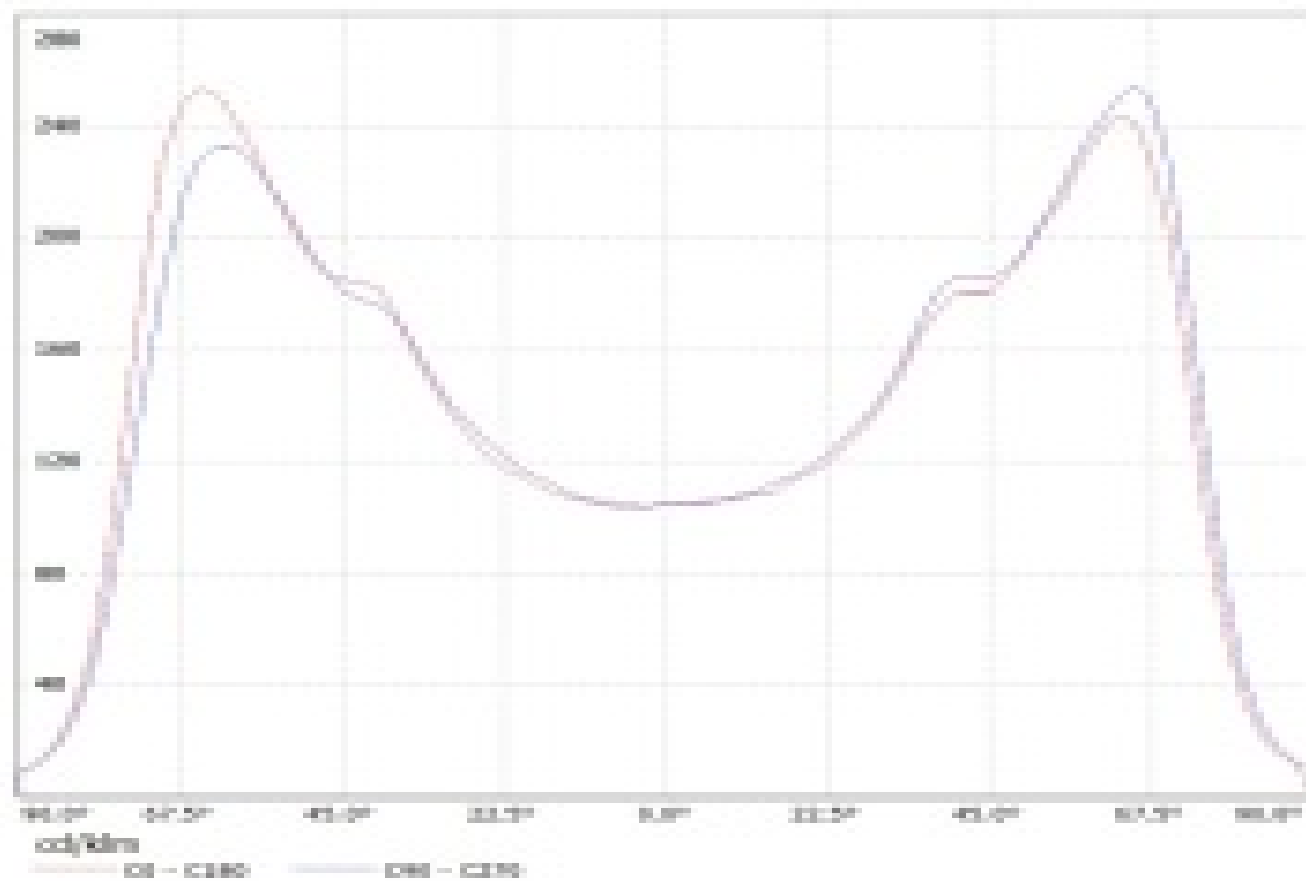

Luminaire: LEDil Oy C13226_DOROTHY-4-A_(XP-E2) Efficiency=94%
Lamps: 1 x XP-E2 (XPEBWT-L17B4-Q4-0-01) 336lm @ 250mA CCT=3200K P=2.9W I=250mA

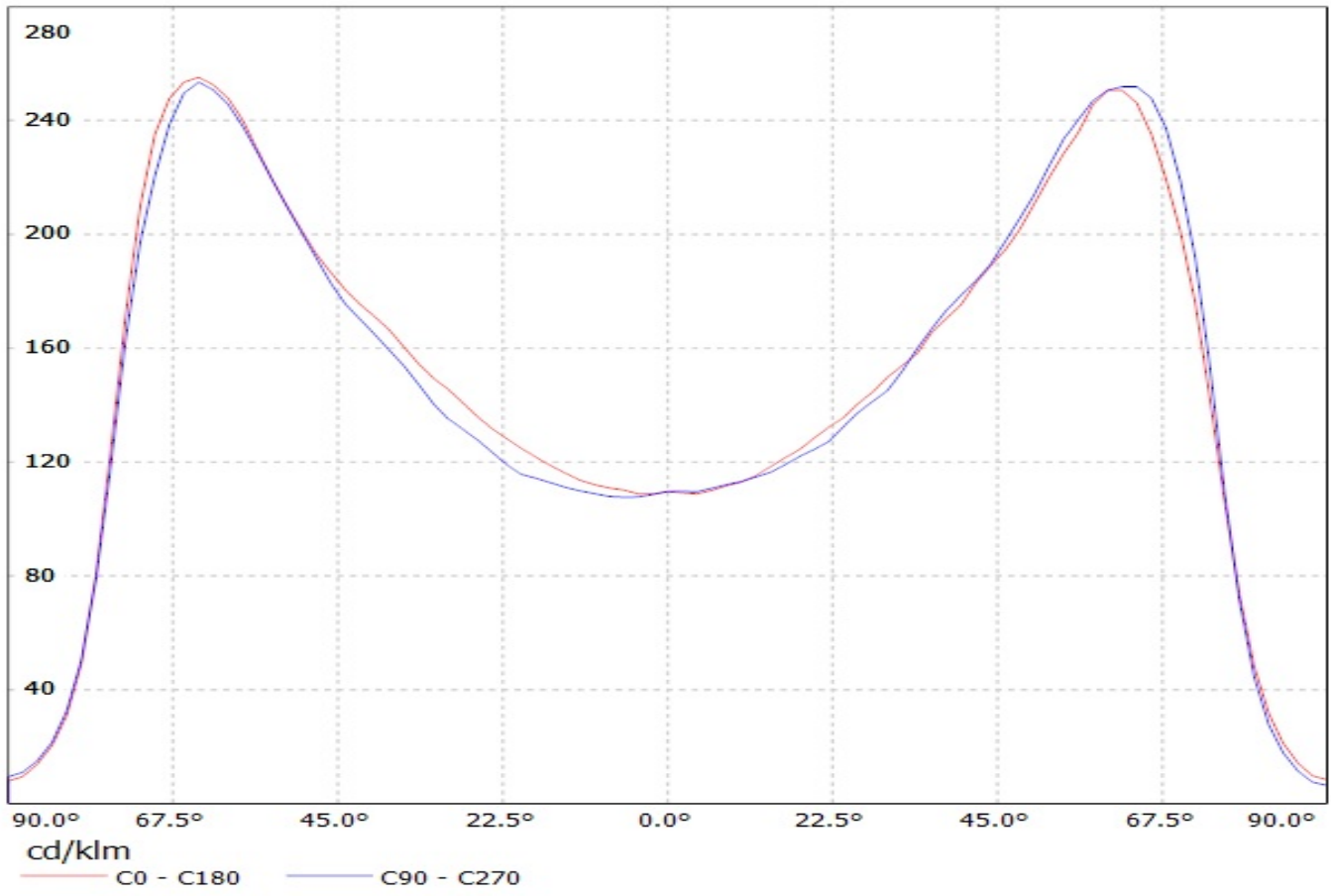

Luminaire: LEDiL Oy C13226_DOROTHY-4-A_(NCS19) Eff. 92,6%
Lamps: 1 x Nichia NCSxx19 (330@250mA)

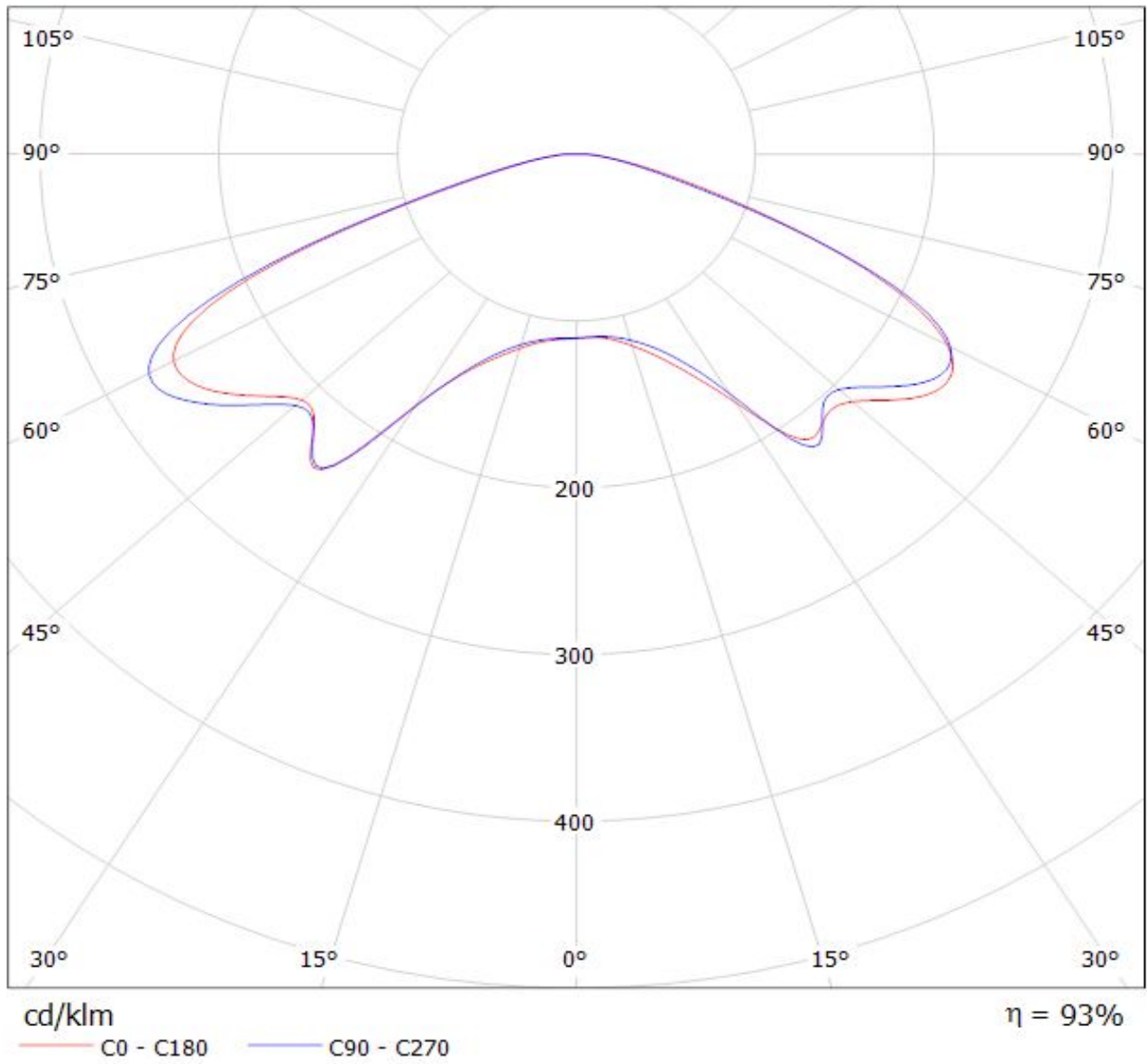

Luminaire: LEDiL Oy C13226_DOROTHY-4-A_(Luxeon_R) Eff. 92,9%
Lamps: 1 x Luxeon R (296@250mA)

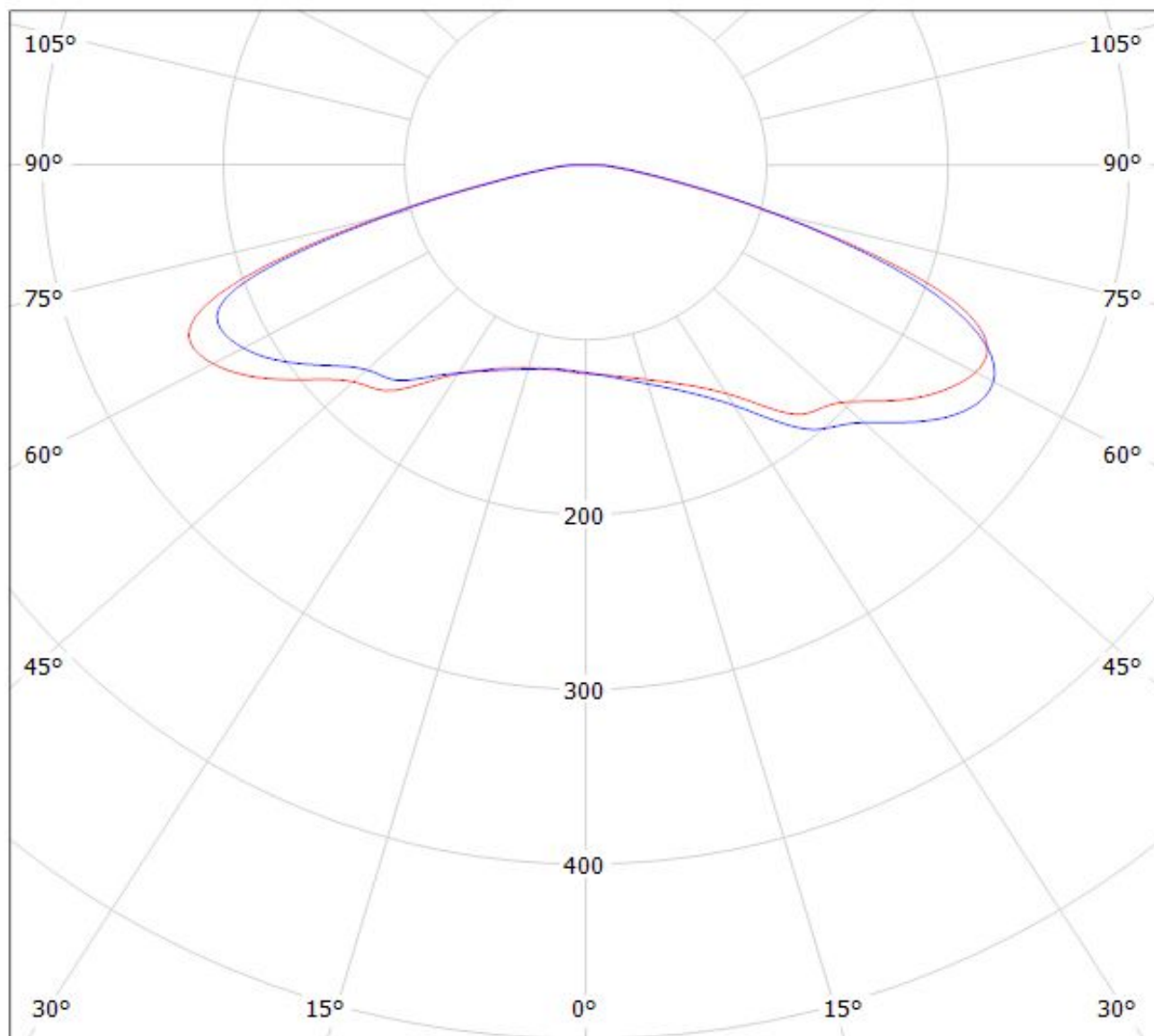

cd/klm

— C0 - C180

— C90 - C270

$\eta = 93\%$

Luminaire: LEDiL Oy C13226_DOROTHY-4-A_(NVS19B) Eff. 93%
Lamps: 1 x Nichia NVSxx19B (301@250mA)

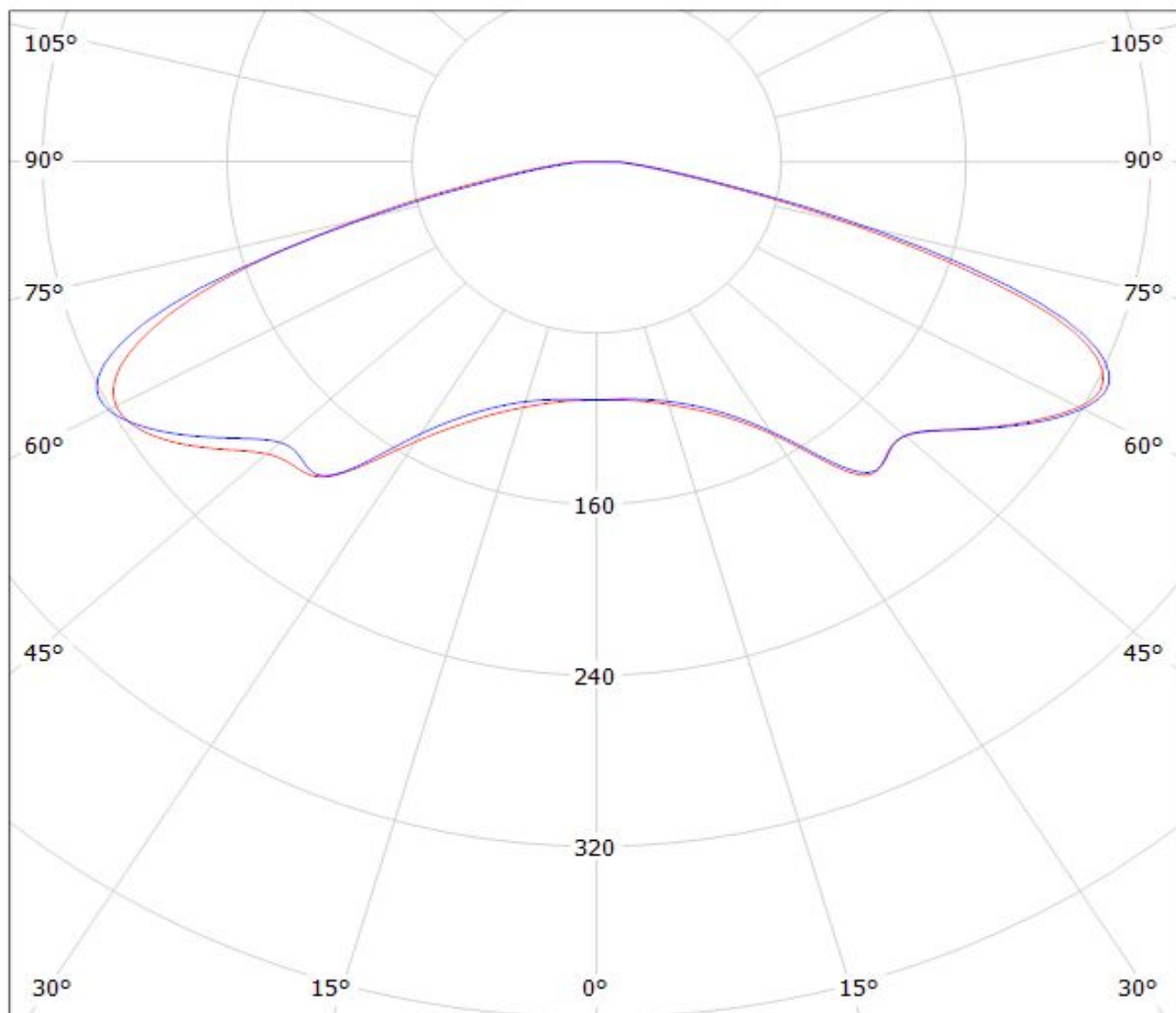

cd/klm

— C0 - C180

— C90 - C270

$\eta = 93\%$

Luminaire: LEDiL Oy C13226_DOROTHY-4-A_(REBEL) Eff.91.5%
Lamps: 1 x Luxeon REBEL (250lm@250mA)

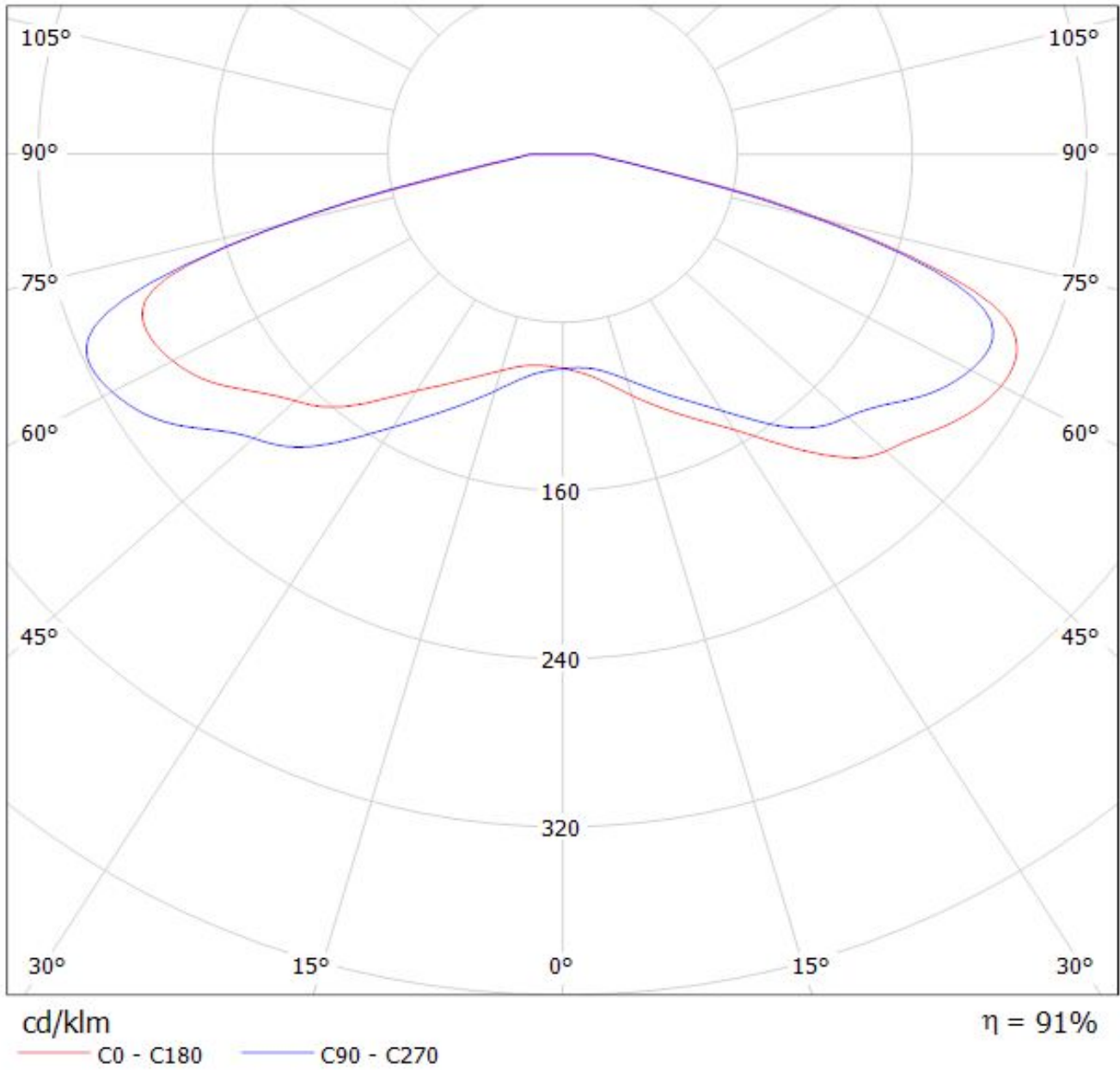

Luminaire: LEDiL Oy C13226_DOROTHY-4-A_(XP-G) Eff. 93,3%
Lamps: 1 x Cree XP-G (254@250mA)

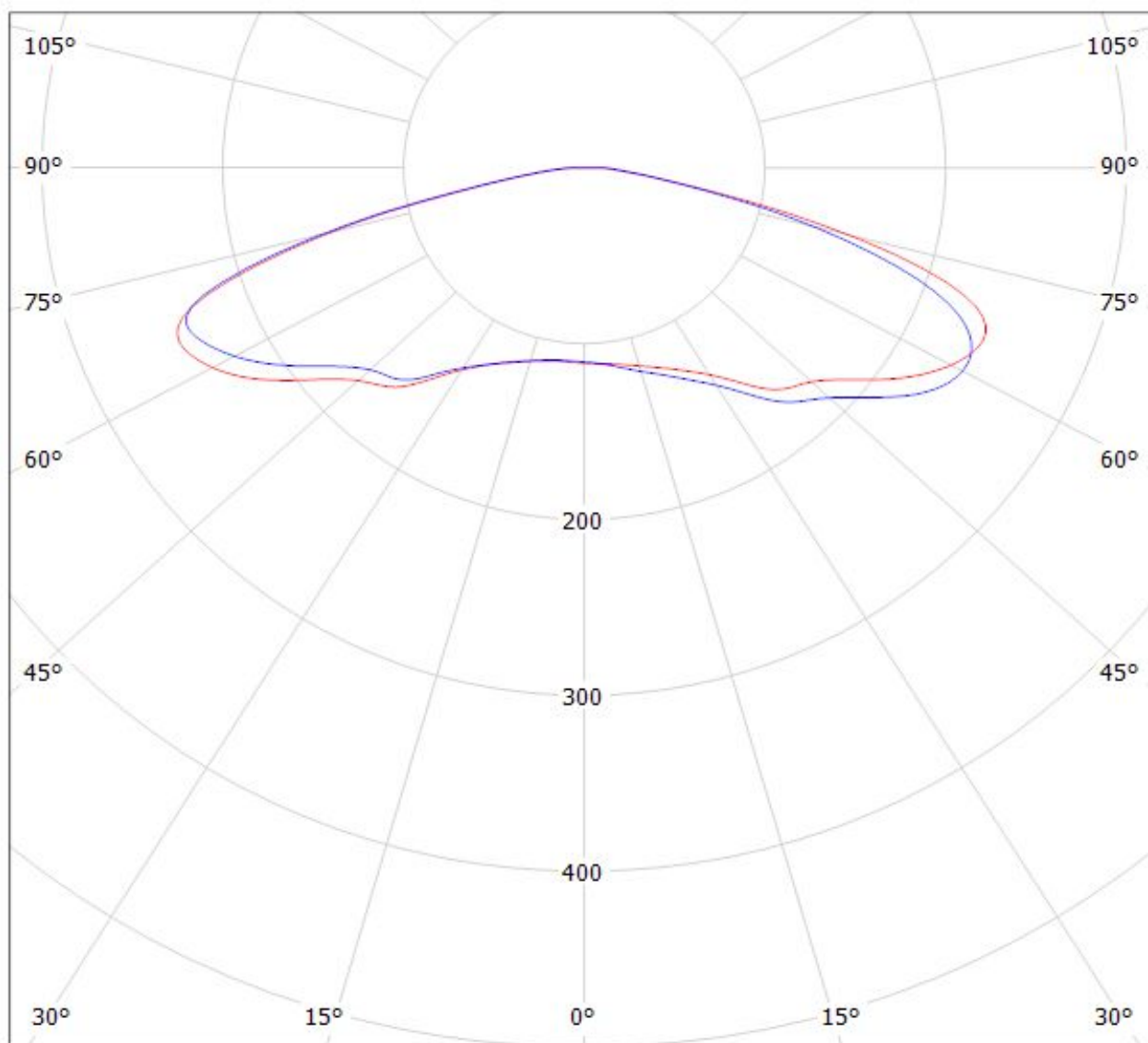

cd/klm

— C0 - C180 — C90 - C270

$\eta = 93\%$

Luminaire: LEDiL Oy C13226_DOROTHY-4-A_(XT-E) Eff. 93,2%
Lamps: 1 x Cree XT-E (296lm@250mA)

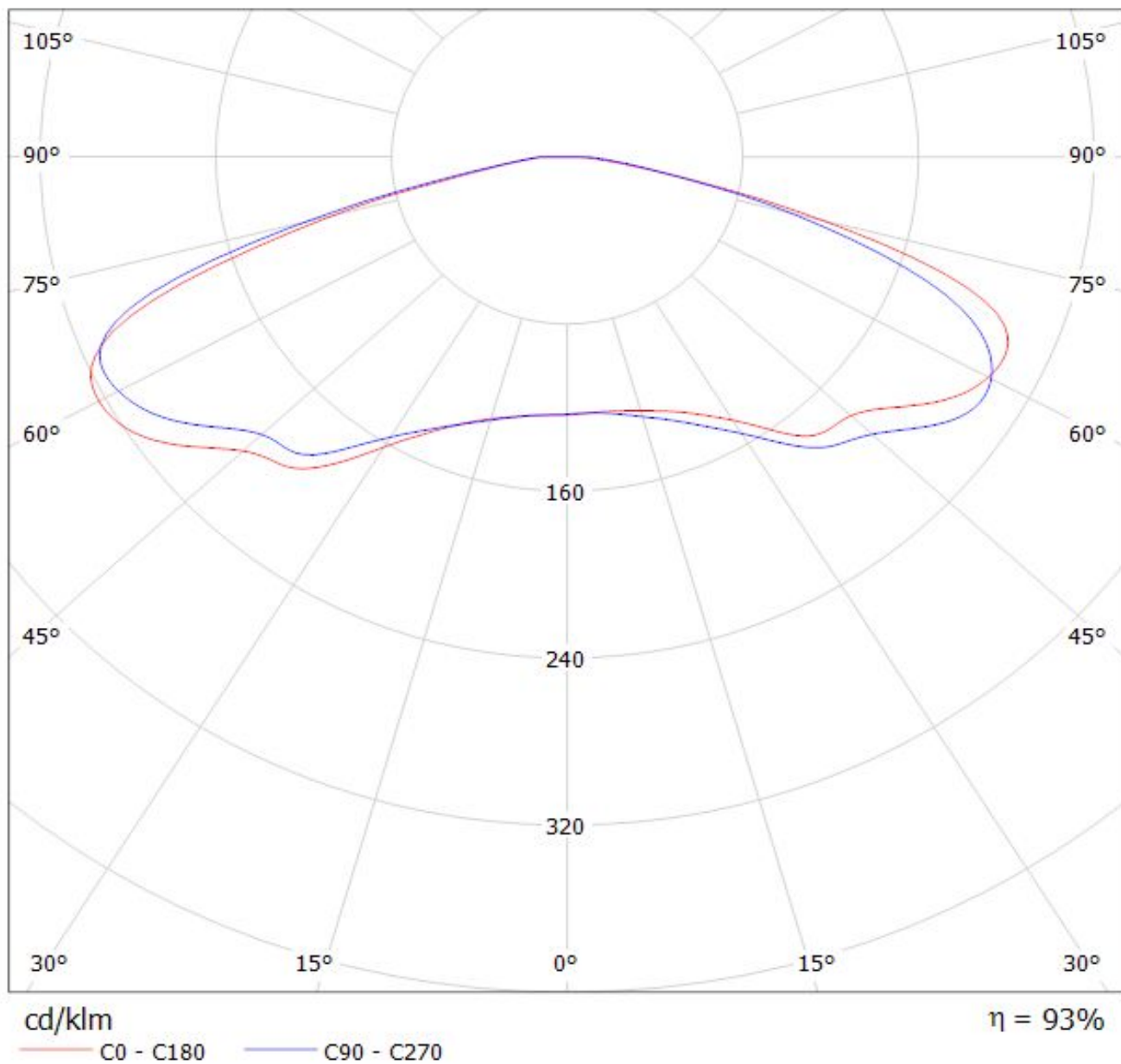

Luminaire: LEDiL Oy C13226_DOROTHY-4-A_(Luxeon_A) Eff. 92,5%
Lamps: 1 x Luxeon A (265@250mA)

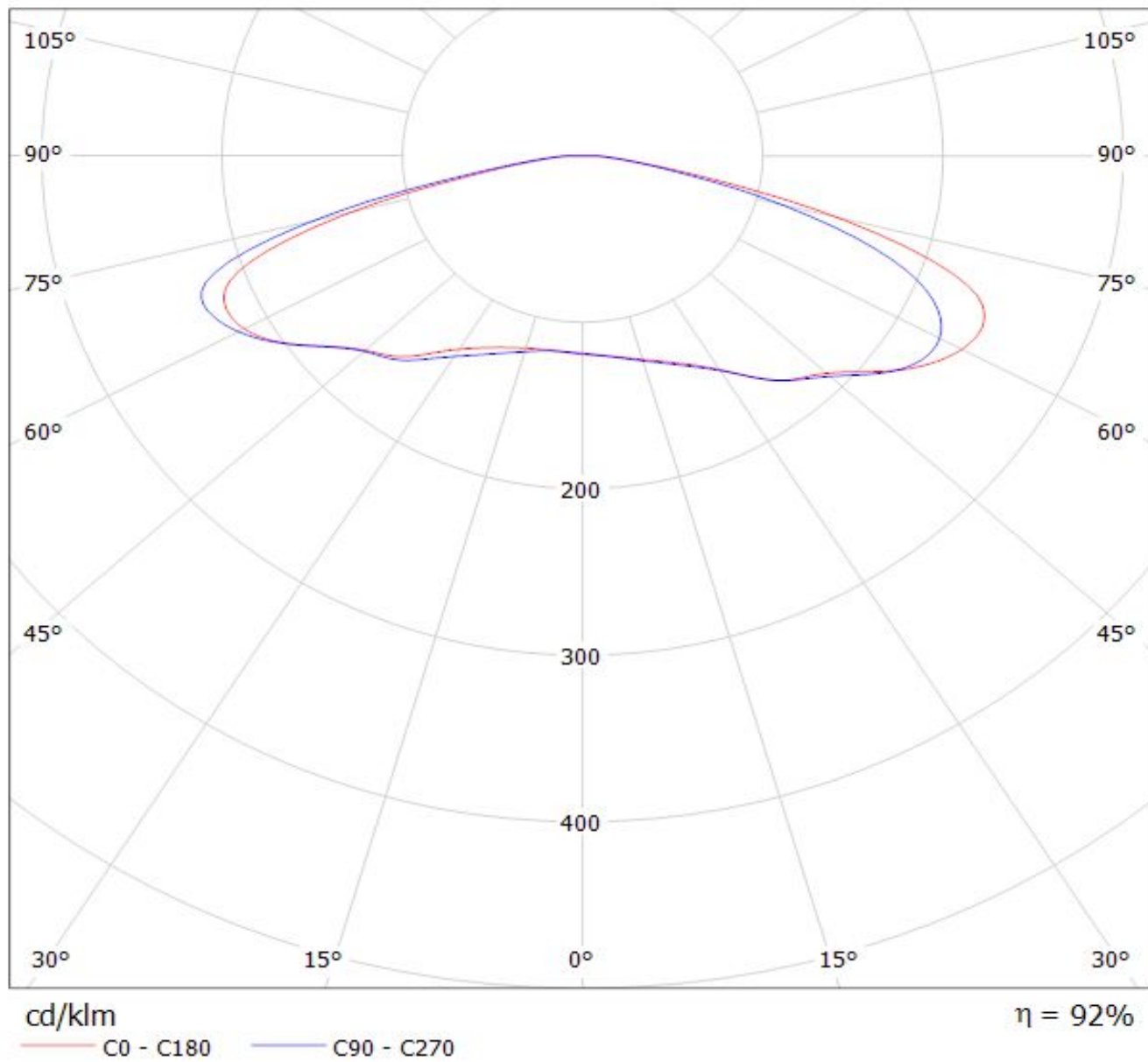

Remitente: Lash Co C/DOON, DOROTHY J. & (N/Car/NE/ElMansay/CPN)

Lugar: T. a. Nueva FICSA/TBA (FICSA/TBA) 28-04-2008. DCTM: 2000. P. 04/11/2008.

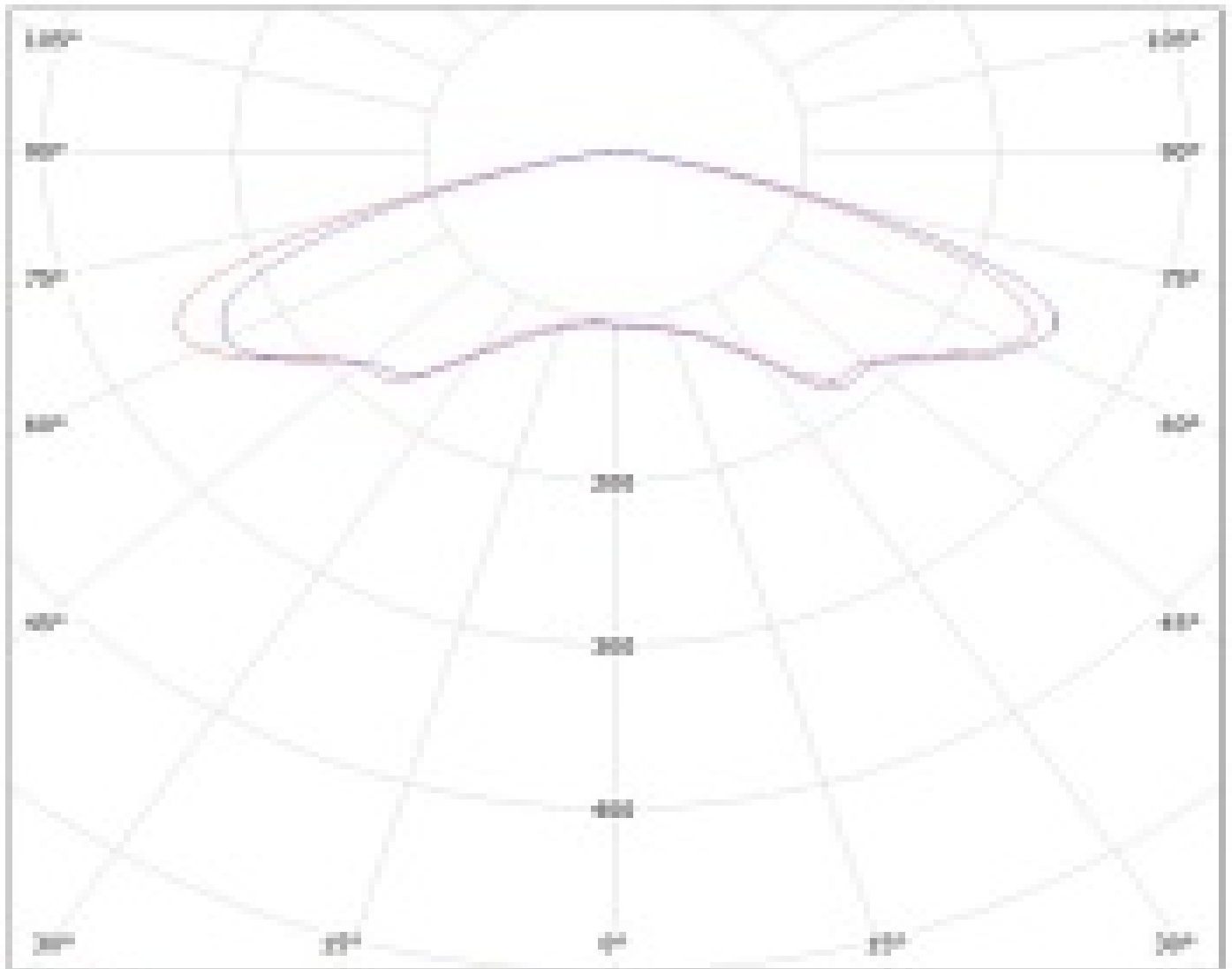

ccj/cdm

DB - CSM DB - CTR

Luminaire: LEDil Oy C13226_DOROTHY-4-A_(XP-E2) Efficiency=94%
Lamps: 1 x XP-E2 (XPEBWT-L17B4-Q4-0-01) 336lm @ 250mA CCT=3200K P=2.9W I=250mA

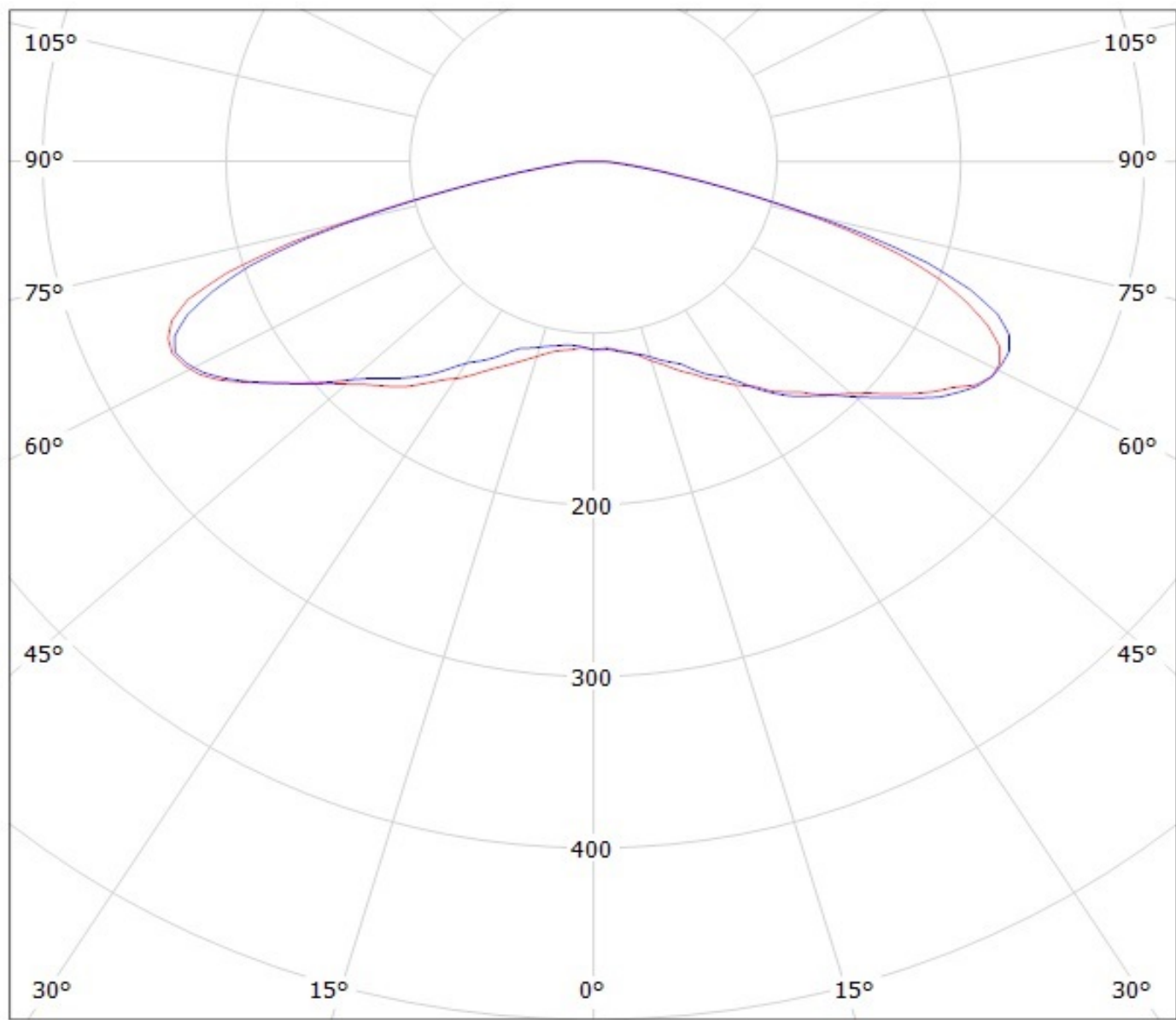

cd/klm

— C0 - C180

— C90 - C270

NOTE: The typical divergence will be changed by different color, chip size and chip position tolerance. The typical total divergence is the full angle measured where the luminous intensity is half of the peak value.