

IEC Appliance Inlet C8, Screw-on Mounting, rear side, PCB terminals



0720-FP



**Description**

- Panel Mount:  
Screw-on mounting from rear-side
- 1 Function
- Appliance Inlet, Pin temperature 70 °C, Protection class II
- PCB

**Approvals**

- UL File Number: E96454
- CSA File Number: 73165
- CCC File Number: 2011010204483973

**Characteristics**

- Contact pins rolled

**Weblinks**

[pdf-datasheet](#), [html-datasheet](#), [General Product Information](#), [Approvals](#), [CE declaration of conformity](#), [RoHS](#), [CHINA-RoHS](#), [Mating Connectors](#), [e-Shop](#), [SCHURTER-Stock-Check](#), [Distributor-Stock-Check](#), [CAD-Drawings](#), [Accessories](#), [Detailed request for product](#)

**Technical Data**

|                           |  |
|---------------------------|--|
| Ratings IEC               | 2.5 A / 250 VAC; 50 Hz   |
| Ratings UL/CSA            | 2.5 A / 250 VAC; 60 Hz   |
| Dielectric Strength       | > 2 kVAC between L-N<br>(1 min/50 Hz)                              |
| Allowable Operation Temp. | -25 °C to 70 °C  |
| Degree of Protection      | from rear-side IP 40 acc. to IEC 60529                             |
| Protection Class          | Suitable for appliances with protection class II acc. to IEC 61140 |
| Terminal                  | PCB terminals  |
| Panel Thickness s         | Screw: max 4 mm<br>Mounting screw torque max 0.5 Nm                |
| Material: Housing         | Thermoplastic, black, UL 94V-0                                     |

|                 |  |
|-----------------|--|
| Appliance Inlet | C8 acc. to IEC 60320,<br>UL 498, CSA C22.2 no. 42 (for cold conditions) pin-temperature 70 °C,<br>2.5 A, Protection Class II |
|-----------------|--|

**Dimensions**

0720-FP

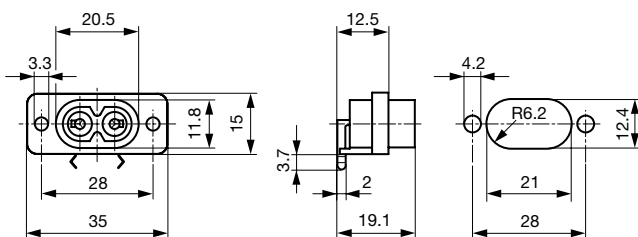

Solder terminals for PCB

**Drilling diagrams**

PCB Layout

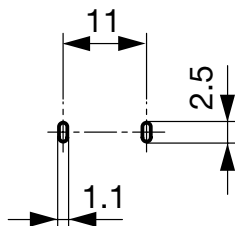

**All Variants**

| Type    | Panel mounting | Panel Thickness s [mm] | Terminal      | Order Number |
|---------|----------------|------------------------|---------------|--------------|
| 0720-FP | Screw          | -                      | PCB terminals | 4300.0097    |

Most Popular.

Availability for all products can be searched real-time: <http://www.schurter.com/en/Stock-Check/Stock-Check-SCHURTER>

**Packaging unit** 100 Pcs

**Mating Outlets/Connectors**

Category / Description

[Power Supply or Interconnection Cord Overview complete](#)



|   |               |
|---|---------------|
| Diverse Power Supply and Interconnection Cords 2.5 A                          | CS01.0121.150 |
| Diverse Power Supply and Interconnection Cords 2.5 A                          | CS01.0221.150 |
| Diverse Power Supply and Interconnection Cords 2.5 A                          | CS01.0321.150 |
| Diverse Power Supply and Interconnection Cords 2.5 A                          | CS01.0421.150 |
| Diverse Power Supply and Interconnection Cords 2.5 A                          | CS03.0421.150 |
| <a href="#">Power Supply or Interconnection Cord further types to 0720-FP</a> | ...           |