

919DLN SERIES NOISE ATTENUATED 35mm SPUR GEARED MOTOR



(RE 540LN MOTOR)

IMPORTANT NOTICE
Due to the wide range of applications for this product it is the users responsibility to establish the products suitability for their individual purpose(s).

RATIOS NOW AVAILABLE AS EX-STOCK ITEMS.

919D2.51LN	(4.5v - 15v)	WITH RE 540LN MOTOR.	RATIO 2.5:1
919D61LN	(4.5v - 15v)	WITH RE 540LN MOTOR.	RATIO 6:1
919D111LN	(4.5v - 15v)	WITH RE 540LN MOTOR.	RATIO 11:1
919D501LN	(4.5v - 15v)	WITH RE 540LN MOTOR.	RATIO 50:1
919D1001LN	(4.5v - 15v)	WITH RE 540LN MOTOR.	RATIO 100:1
919D1481LN	(4.5v - 15v)	WITH RE 540LN MOTOR.	RATIO 148:1
919D5001LN	(4.5v - 15v)	WITH RE 540LN MOTOR.	RATIO 500:1
919D8101LN	(4.5v - 15v)	WITH RE 540LN MOTOR.	RATIO 810:1
919D30001LN	(4.5v - 15v)	WITH RE 540LN MOTOR.	RATIO 3000:1

Designed for heavier-duty industrial and model applications. These units boast a high quality, five pole low rpm motor providing approx 33% more motor torque than the standard RE540/1 motor, **with a considerable reduction in motor noise level.** The metal gearbox incorporates sleeve bearings, enabling the high torque transfer from the motor to be transmitted through the gearbox.

MOTOR DATA. (RE-540/1)

MODEL	VOLTAGE		NO LOAD		AT MAXIMUM EFFICIENCY						STALL TORQUE	
	OPERATING RANGE	NOMINAL	SPEED	CURRENT	SPEED	CURRENT	TORQUE		OUTPUT	EFF	oz - in	g - cm
			R.P.M.	A	R.P.M.	A	oz - in	g - cm	W	%		
RE540LN	4.5 - 15.0	12.0v CONSTANT	6000	0.25	5216	1.26		206	11	73		1756

REDUCTION TABLE. R.P.M. (NO LOAD)

SUPPLY VOLTAGE	4.5v	6.0v	9.0v	12.0v	15.0v
919D2.51LN	843	1150	1785	2379	3018
919D61LN	350	478	735	992	1262
919D111LN	212	292	448	595	749
919D501LN	42	58	90	120	152
919D1001LN	21	28	45	59	76
919D1481LN	14	19	29	40	51
919D5001LN	4.5	5.5	8.6	12	15
919D8101LN	2.5	3.5	5.5	7	9.5
919D30001LN	0.6	0.9	1.5	2	2.5

WEIGHT	
919D2.51LN	329g
919D61LN	329g
919D111LN	329g
919D501LN	343g
919D1001LN	343g
919D1481LN	349g
919D5001LN	355g
919D8101LN	355g
919D30001LN	355g

GEARED MOTOR TORQUE RATINGS AT MAX. EFFICIENCY

	At 12V (g.cm)
2.5:1	412
6:1	989
11:1	1000
50:1	3000
100:1	6000
148:1	6000
500:1	6000
810:1	6000
3000:1	6000

IMPORTANT NOTICE
At very low ratios the torque produced by this geared motor combination may exceed the maximum permissible torque of the gearbox. In this situation the unit must not be allowed to stall as this may damage the gears.

NOTE: To establish Torque Rating in Nm, divide g.cm by 10,197.0
Motor RPM may vary by + or - 10%

919DLN SERIES NOISE ATTENUATED 35mm SPUR GEARED MOTOR

(RE 540LN MOTOR)

GEARBOX DIMENSIONS

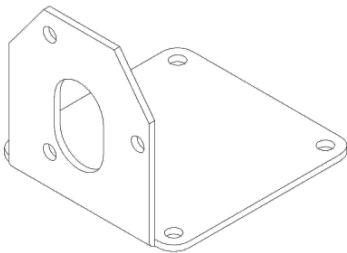
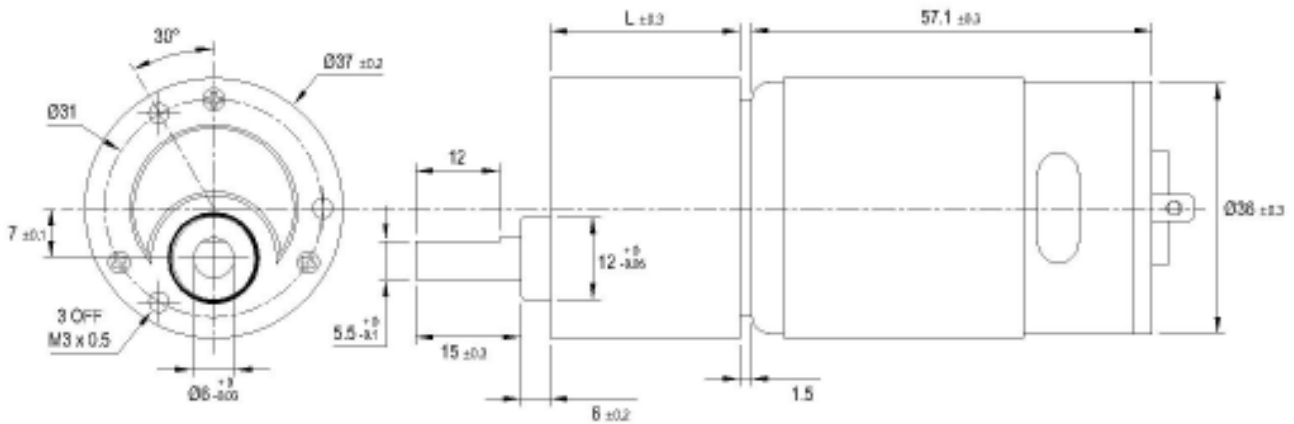

**Pt. No. 727
Geared motor bracket (90 degree)**

GEARBOX REF.	L
919D2.51LN	19.5
919D61LN (6:1)	19.5
919D111LN (11:1)	19.5
919D501LN (50:1)	24.5
919D1001LN(100:1)	24.5
919D1481LN(148:1)	27.0
919D5001LN(500:1)	29.5
919D8101LN(810:1)	29.5
919D30001LN	32.0

Subject to minimum order quantities of 250 units, the following ratios are also available with a six week lead-time. The physical dimensions of these other gearboxes may vary from the data as illustrated above. Details of individual gearboxes are available upon request.

GEARBOX 10:1 WITH 540/1 MOTOR
 GEARBOX 60:1 WITH 540/1 MOTOR
 GEARBOX 90:1 WITH 540/1 MOTOR
 GEARBOX 180:1 WITH 540/1 MOTOR
 GEARBOX 300:1 WITH 540/1 MOTOR
 GEARBOX 450:1 WITH 540/1 MOTOR
 GEARBOX 700:1 WITH 540/1 MOTOR
 GEARBOX 1000:1 WITH 540/1 MOTOR

GEARBOX 18:1 WITH 540/1 MOTOR.
 GEARBOX 70:1 WITH 540/1 MOTOR.
 GEARBOX 100:1 WITH 540/1 MOTOR
 GEARBOX 200:1 WITH 540/1 MOTOR
 GEARBOX 350:1 WITH 540/1 MOTOR
 GEARBOX 500:1 WITH 540/1 MOTOR
 GEARBOX 750:1 WITH 540/1 MOTOR
 GEARBOX 1500:1 WITH 540/1 MOTOR

GEARBOX 30:1 WITH 540/1 MOTOR.
 GEARBOX 75:1 WITH 540/1 MOTOR.
 GEARBOX 120:1 WITH 540/1 MOTOR
 GEARBOX 250:1 WITH 540/1 MOTOR
 GEARBOX 400:1 WITH 540/1 MOTOR
 GEARBOX 600:1 WITH 540/1 MOTOR
 GEARBOX 900:1 WITH 540/1 MOTOR