

## MRX700 DigiLink SCART-to-RF Converter

Adds DigiLink signal distribution capability to Sky™, Freeview™ or Freesat™ receivers

- Converts the signal from the SCART output to an RF output with return path
- Simple Plug-and-Play installation
- Fully compatible with DigiLink amps and DigiLink eyes to allow channel changing from other rooms
- Provides loop-through for Freeview™ on every TV including the main set
- Supplied with 2 IR transmitters to control up to 2 devices
- Supplied with mains power supply



	MRX700
RF modulator output channels	21CH - 69CH
RF forward frequency range	470 - 860MHz
Output level	72+/-4dBuV
RF in to RF out	0-5dB gain
RF connector	F-Type
AV connector	SCART
DC output (RF OUT)	9VDC 100mA (max)
Power supply	9VDC
Dimensions (L x W x H)	116 x 78 x 35mm
Weight	115g

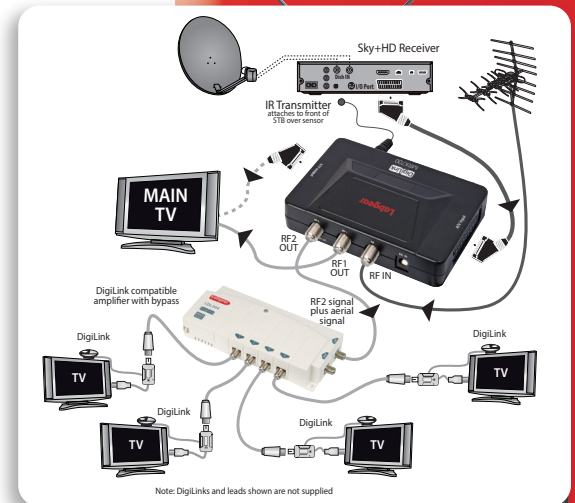

## MRX600 DigiLink I/O-to-RF Converter

Restores RF2 functions to Sky™ receivers via I/O port

- Converts the signal from the Sky™ I/O port to an RF output with return path
- Simple Plug-and-Play installation
- Fully compatible with DigiLink amps and DigiLink eyes to allow channel changing from other rooms
- Provides loop-through from Freeview™ on every TV including the main set
- Fully screened compact design with built-in I/O connector, flylead and DC IN (to power line powered amplifiers)



	MRX600
RF modulator output channels	21CH - 69CH
RF forward frequency range	47-862MHz
Return path frequency range	5 to 12 MHz (RF OUT to I/O port)
RF IN connector x 1	IEC female
RF OUT connector x 2	IEC male
I/O connector	10 pin mini DIN plug on 250mm flylead
DC output (RF OUT)	Regulated 9VDC 100mA (short circuit protected)
Power consumption	0.6W in 5VDC (not included 9VDC/100mA max output)
Power supply	5VDC
Dimensions (L x W x H)	60mm x 55mm x 25mm
Weight	35g

