

FY^{*1)}XX^{*2)}P7-K120

e.g. FL25P7-K120

*1) Y for series FL or FU
 *2) xx No. of contacts 09, 15, 25 or 37

xx	A (mm)	B (mm)	C (mm)
09	30,8	16,9	25
15	39,1	25,2	33,3
25	53	38,9	47,04
37	69,3	55,3	63,5

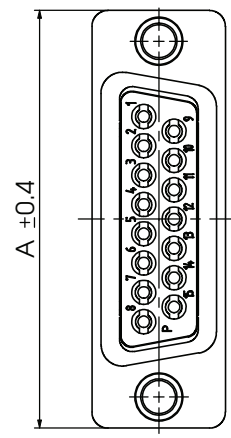
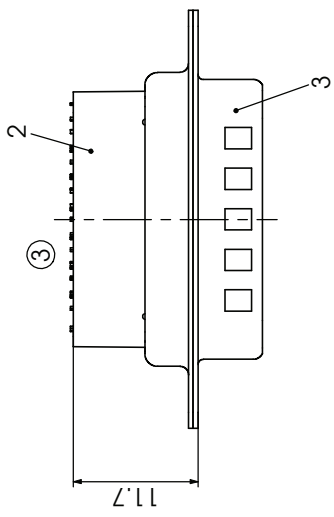

Technical data for modification (FU)
 Crimp contacts FK20P (AWG 20-24/1,3µm Au) included in delivery.

3	1	Shell	Steel	tin plated
2	1	Insulator rear part	PEI (-55°C - +130°C)	green
1	1	Insulator front part	PBT	green
No.	St.	Part	Type Description/Material	Surface plating/Colour/Class

② Technical data for modification (FL)
 Crimp contacts not supplied with connector. Contacts must be ordered separately.

3	1	Shell	Steel	tin plated
2	1	Insulator rear part	PA66 (-55°C - +115°C)	black
1	1	Insulator front part	PBT	black
No.	St.	Part	Type Description/Material	Surface plating/Colour/Class

Measurement without tolerance acc. to ISO 2768-m		SCALE	TITLE
DRAWN	21-11-2003	2:1	D-Sub Crimp Connector
CHECKED	13-12-2011	Denzinger	
DATE	24-11-2011	sschref	DWG. NO.
CH-NO.	23123		
REV.	17-02-2006		REPLACEMENT FOR:
	1		FyxxP7-K120 a

