

## Device connector, front mounting - SH-8EPC58AWA00S - 1621569

Please be informed that the data shown in this PDF Document is generated from our Online Catalog. Please find the complete data in the user's documentation. Our General Terms of Use for Downloads are valid (<http://phoenixcontact.com/download>)



Device connector for front wall, straight, shielded: Yes, SPEEDCON locking, M23, Number of positions: 4+4+4+PE, Type of contact: Male connector, Crimp connection, Axial O-ring, 4xØ3,2, Flange dimensions: 26 mm x 26 mm



### Key commercial data

Packing unit	1
GTIN	 4 046356 937177
Custom tariff number	85366990

### Technical data

#### General

Mounting type	4xØ3,2
---------------	--------

### Classifications

#### eCl@ss

eCl@ss 4.0	272607xx
eCl@ss 4.1	27260701
eCl@ss 5.0	27143424
eCl@ss 5.1	27143424
eCl@ss 6.0	27143424
eCl@ss 7.0	27440209
eCl@ss 8.0	27440209

#### ETIM

ETIM 4.0	EC002635
ETIM 5.0	EC002635

### Drawings

## Device connector, front mounting - SH-8EPC58AWA00S - 1621569

Schematic diagram

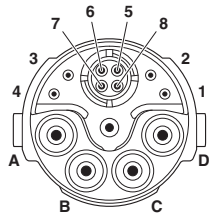

Dimensioned drawing

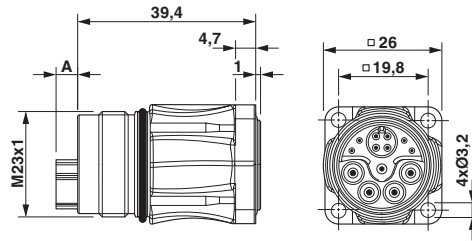

Pin assignment of pin, CAT5

Pin version: dimension A = 4.75 mm, socket version: dimension A = 0 mm