



DS Series Interlock Pushbutton Switches

NEW!

Pushbutton
A

Features/Benefits

- Snap-in mounting
- Reliable snap action mechanism
- Latch or momentary
- RoHS compliant
- Halogen free material

Typical Applications

- Interlock switch
- Detection switch
- Circuit interrupt



ENEC UL 61058-1



UL file # E247379

Specifications

FUNCTION: Single pole double throw / Double pole double throw
MOUNTING TYPE: Snap in style

Electrical

ELECTRICAL LIFE: see ratings chart below
DIELECTRIC STRENGTH: 1500 V (50-60 Hz @ sea level)
INSULATION RESISTANCE: 100 M Ω min.
INITIAL CONTACT RESISTANCE: 30 milli-ohms

Materials

HOUSING, COVER, ACTUATOR, KNOB: PA 66/6 halogen free, color white
NO & NC FIXED TERMINALS: Copper alloy
COMMON TERMINALS: Copper alloy, silver plate
CONTACTS: Silver alloy / F5 rating gold plated over silver alloy
RETURN SPRINGS: Stainless steel

Operating Environment

OPERATING TEMPERATURE: -40°C to +85°C

NOTE: Specifications and materials listed above are for switches with standard options. For information on specific and custom switches, please contact Customer Service.

Build-A-Switch

To order, simply select desired option from each category and place in the appropriate box.



Designation

DS DS Series

Number of Poles

- 1** SPDT
- 2** DPDT

Rating

- F5** 0.1 (0.05)A @ 125/250 V AC 50/60 Hz 50E3
0.1A G.P. @ 125/250 V AC 50/60 Hz 10E3
- D6** 10 (4)A @ 125/250 V AC 50/60 Hz 50E3
10A G.P. @ 125 / 250 V AC 1/3HP @ 125/250 V AC
50/60 Hz 10E3

International Rating Symbols

10E3	Cycles 10,000
50E3	Cycles 50,000
10(4)	Current rating: First number represents resistive rating. Second number represents inductive (motor) rating
GP	General purpose rating UL1054

Extended Electrical Life

U 100,000 cycles
contact Customer Service
available in F5 rating only

Terminals

- Q1** 4.8 x 0.5
- Q2** 4.8 x 0.8
- Q3** 6.3 x 0.8

Actuator Style

- A** Momentary, Short button
- B** Momentary, Long button
- C** Momentary/Pulled out button



Dimensions are shown: mm
Specifications and dimensions subject to change

NEW!

DS Series Interlock Pushbutton Switches



A

Pushbutton

NUMBER OF POLES

1 SPDT

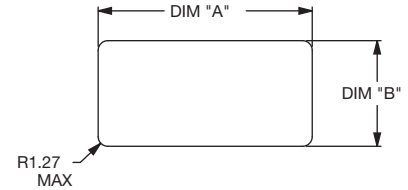
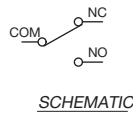
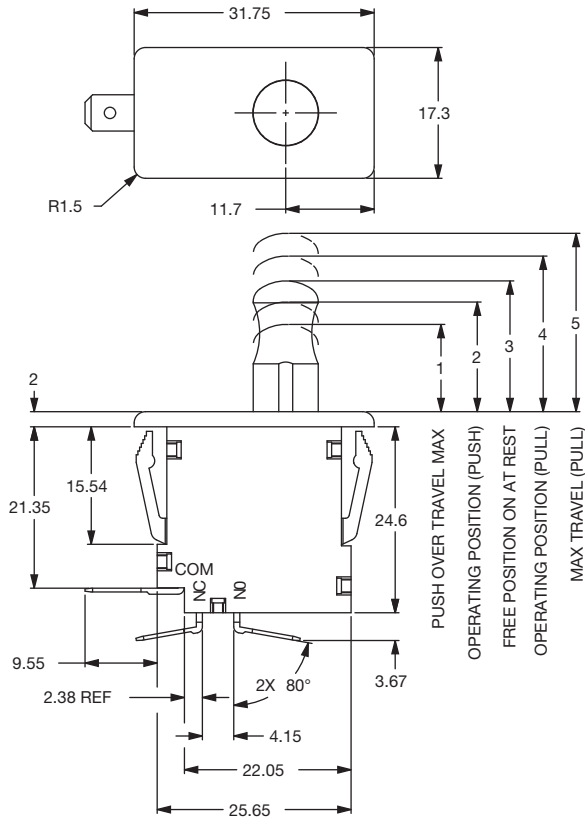

PANEL MOUNTING		
PANEL THICKNESS	DIM "A" mm	DIM "B" mm
1.14	28.32	13.97
2.54	28.58	13.97

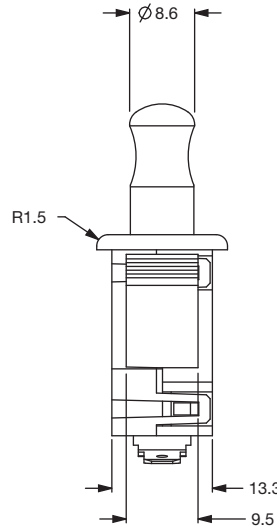

2 DPDT

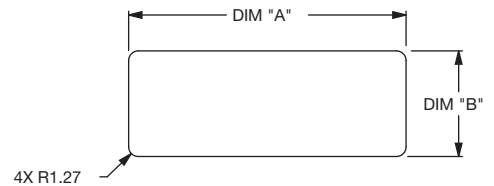
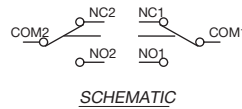
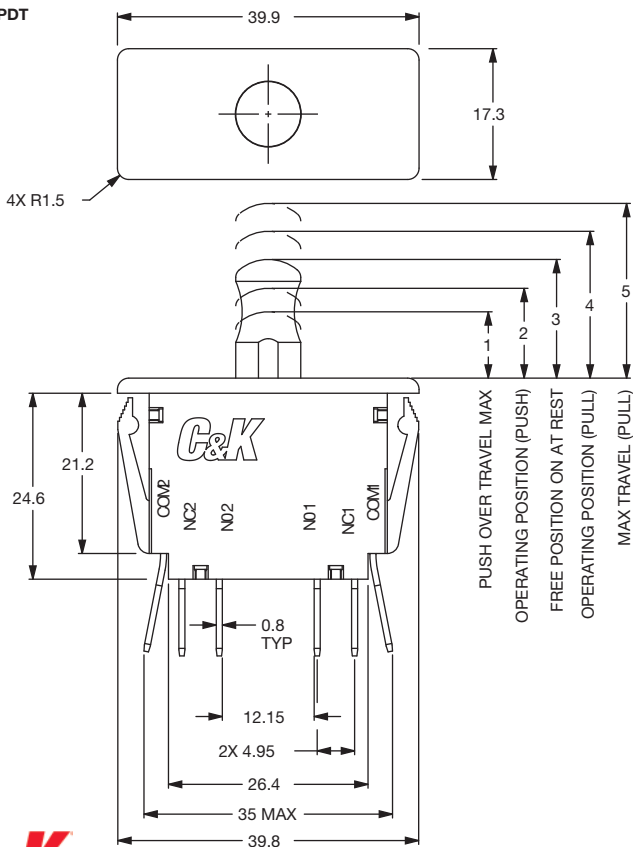

PANEL MOUNTING		
PANEL THICKNESS	DIM "A" mm	DIM "B" mm
1.14	36.70	13.97
2.54	36.96	13.97

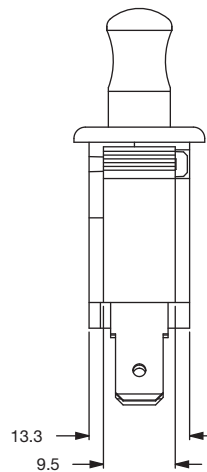

Dimensions are shown: mm
Specifications and dimensions subject to change



DS Series Interlock Pushbutton Switches

NEW!

ACTUATOR STYLE / SPECIFICATIONS

Pushbutton

A

A SHORT BUTTON

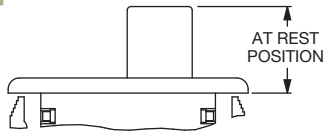

SHORT BUTTON

B LONG BUTTON

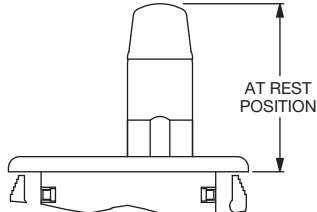

LONG BUTTON

C MOMENTARY/PULLED OUT

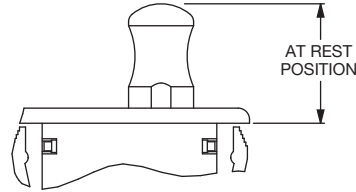

FREE POSITION

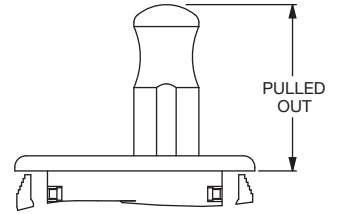

PULLED OUT POSITION

BUTTON STYLE	1 PUSH OVER TRAVEL MAX.	2 OPERATING POSITION	3 FREE POSITION AT REST	4 OPERATING POSITION PULL	5 OVER TRAVEL POSITION PULL MAX	OPERATING FORCE	
A	3.20	8.90 ± 1.25	11.45 ± 0.75	NA	NA	425 gf	
B	10.15	19.55 ± 1.25	22.25 ± 0.75	NA	NA	425 gf	
C	13.20	16.75 ± 1.25	19.30 ± 0.75	21.60 ± 1.25	24.90	PUSH 385gf	PULL 475gf

TERMINALS

Q1 4.8 x 0.5
Q2 4.8 x 0.8

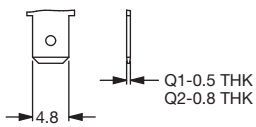

Q3 6.3 x 0.8

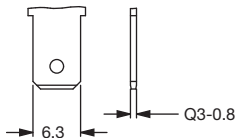

Dimensions are shown: mm
Specifications and dimensions subject to change