

# Flush-type connector - SACC-E-M12FSS-4CON-M16/0,5 PE - 1424137

Please be informed that the data shown in this PDF Document is generated from our Online Catalog. Please find the complete data in the user's documentation. Our General Terms of Use for Downloads are valid (<http://phoenixcontact.com/download>)



Flush-type connector, Power, 4-position, SocketLink:M12, S power, Front mounting, M16 x 1.5, Individual wires, Cable length: 0.5 m



## Key commercial data

Packing unit	1 pc
GTIN	 4 046356 693394
Weight per Piece (excluding packing)	49.0 g
Custom tariff number	85366990
Country of origin	Germany
Product key	ABQEAB

## Technical data

### Dimensions

Length of cable	0.5 m
-----------------	-------

### Ambient conditions

Ambient temperature (operation)	-25 °C ... 85 °C (Plug / socket)
	-40 °C ... 85 °C (without mechanical actuation)
Degree of protection	IP67

### General

Note	The electrical and mechanical data specified assume that the connector pair is correctly locked and mounted. If the connector is unlocked and if there is a danger of contamination, the connector must be sealed using a protective cap > IP54. Influences arising from litz wires, cables or PCB assembly must also be taken into consideration.
Rated current at 40°C	12 A
Rated voltage	630 V
Number of positions	4
Contact resistance	≤ 3 mΩ
Insulation resistance	≥ 100 MΩ

# Flush-type connector - SACC-E-M12FSS-4CON-M16/0,5 PE - 1424137

## Technical data

### General

Coding	S power
Standards/regulations	M12 connector
Signal type/category	Power
Status display	No
Surge voltage category	III
Pollution degree	3
Connection method	Individual wires
Insertion/withdrawal cycles	> 100
Torque	3 Nm ... 4 Nm (M12 connector)
Mounting type	Front mounting M16 x 1.5

### Material

Inflammability class according to UL 94	V0
Contact material	CuZn
Contact surface material	Au
Contact carrier material	PA
Material, knurls	CuZn alloy, nickel-plated
Sealing material	FKM

### Cable

Cable type	PP litz wire
Conductor cross section	1.5 mm <sup>2</sup>
AWG signal line	16
Wire colors	Black 1, black 2, black 3, green/yellow
Material conductor insulation	PP
Conductor material	Bare Cu litz wires
Ambient temperature (operation)	-40 °C ... 90 °C (cable, fixed installation)
	-30 °C ... 90 °C (cable, flexible installation)

## Classifications

### eCl@ss

eCl@ss 4.0	27140815
eCl@ss 4.1	27140815
eCl@ss 5.0	27143423
eCl@ss 5.1	27143423
eCl@ss 6.0	27143423
eCl@ss 7.0	27449001
eCl@ss 8.0	27440103

### ETIM

ETIM 3.0	EC002061
----------	----------

# Flush-type connector - SACC-E-M12FSS-4CON-M16/0,5 PE - 1424137

## Classifications

### ETIM

ETIM 4.0	EC002062
ETIM 5.0	EC002061

### UNSPSC

UNSPSC 6.01	31251501
UNSPSC 7.0901	31251501
UNSPSC 11	31251501
UNSPSC 12.01	31251501
UNSPSC 13.2	31251501

## Drawings

Schematic diagram



Connector pin assignment of M12 socket, 4-pos., S-coded, view of socket side

Dimensioned drawing

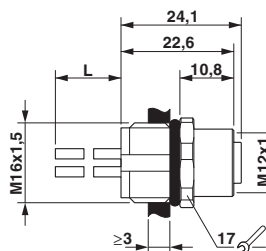

M12 flush-type socket

Circuit diagram

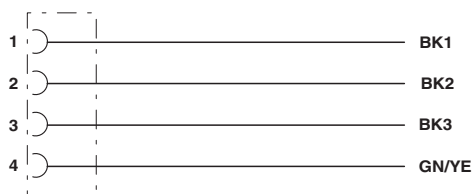

Contact assignment of the M12 socket