

Housing screw connection - SACC-M12 NUT PRESS - 1437889

Please be informed that the data shown in this PDF Document is generated from our Online Catalog. Please find the complete data in the user's documentation. Our General Terms of Use for Downloads are valid (<http://phoenixcontact.com/download>)



Housing screw connection for two-piece M12 connectors for the reflow soldering process.



Key commercial data

Packing unit	10 pc
GTIN	 4 046356 457552
Weight per Piece (excluding packing)	9.98 g
Custom tariff number	85389099
Country of origin	Germany
Product key	ABQCCB

Technical data

Ambient conditions

Ambient temperature (operation)	-25 °C ... 85 °C (Plug / socket)
	-40 °C ... 85 °C (without mechanical actuation)

General

Standards/regulations	M12 connector IEC 61076-2-101
Mounting type	M12 x 1

Material

Material	CuZn (nickel-plated)
Sealing material	EPDM (O-ring)

Cable

Ambient temperature (operation)	-40 °C ... 85 °C (cable, fixed installation)
	-25 °C ... 85 °C (cable, flexible installation)

Housing screw connection - SACC-M12 NUT PRESS - 1437889

Classifications

eCl@ss

eCl@ss 4.0	27250313
eCl@ss 4.1	27250313
eCl@ss 5.0	27143423
eCl@ss 5.1	27143423
eCl@ss 6.0	27143423
eCl@ss 7.0	27449001
eCl@ss 8.0	27449001

ETIM

ETIM 3.0	EC002061
ETIM 4.0	EC002061
ETIM 5.0	EC002061

UNSPSC

UNSPSC 6.01	31251501
UNSPSC 7.0901	31251501
UNSPSC 11	31251501
UNSPSC 12.01	31251501
UNSPSC 13.2	31251501

Approvals

Approvals

Approvals

GOST / GOST

Ex Approvals

Approvals submitted

Approval details

GOST 
--

Housing screw connection - SACC-M12 NUT PRESS - 1437889

Approvals



Drawings

Dimensioned drawing

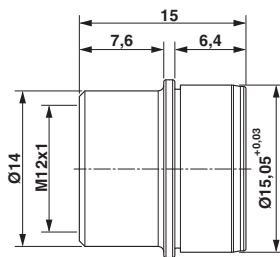

Dimensioned drawing

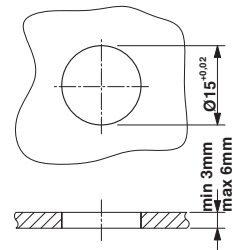

Housing bore holes

Dimensioned drawing

