

Data Sheet

PR044xxHBBN

Page 1/5

P/N

311901xx

xx=number of poles

2013/12/05

Illustration

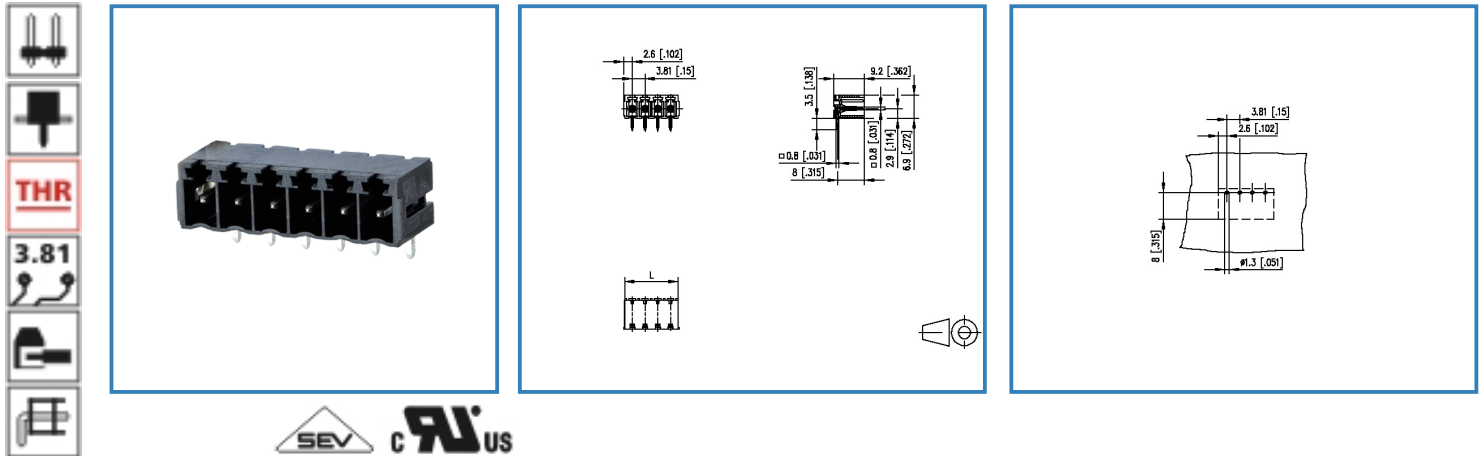

see enlarged drawing at the end of the document

Product specification

- pin header, THR solderable
- centerline 3.81 mm, direction of connection 90°
- closed ends
- color black
- Tape & Reel packaging
- codeable
- Connection data

cRUUS V / A 300 / 8

SEV 10 A / 130 V / 2.5 kV / 3 / IEC 61984

Data Sheet

PR044xxHBBN

Page 2/5

P/N

311901xx

xx=number of poles



2013/12/05

Technical Data

General Data

Solder pin length	3.5 mm		
min. number of poles	2		
max. number of poles	12		
Insulating material class	CTI 600		
clearance/creepage dist.	3.01 mm		
protection category	IP 00		
Overvoltage category	III	III	II
Pollution degree	3	2	2
Rated voltage	200 V	500 V	500 V
Rated test voltage	4.0 kV	4 kV	4.0 kV

Connection data

 V / A	300 / 8
	10 A / 130 V / 2.5 kV / 3 / IEC 61984

Material

insulating material	PA66/6T
flammability class	V0
contact pin material	CuMg
contact pin surface	Ni + Sn

Climatic properties

upper limit temperature	105 °C
lower limit temperature	-40 °C

General

solderability	For THR products acc. to IPC/JEDEC J-STD-020D-MSL 1 For THT products max. 260 °C / 10 s
Tolerance	ISO 2768 -mH



Data Sheet

PR044xxHBBN

Page 3/5

P/N

311901xx

xx=number of poles

2013/12/05

Matching Part to

P/N	Product name
311131	RP034xxHBLO Typ 113
311141	RP034xxHBLN Typ 114
313691	RP034xxVBLN Typ 369
ASP044	SP044xxVBNN ASP044
ASP064	SP064xxVGNN ASP064

Accessories

P/N	Product name
700333-01-1216	LED-light transmitter for headers, pluggable
700333-02-1216	LED-light transmitter for headers, pluggable
700333-03-1216	LED-light transmitter for headers, pluggable
720293-01-2	720293



Data Sheet

PR044xxHBBN

Page 4/5

P/N

311901xx

xx=number of poles

2013/12/05

Illustration

Drawing

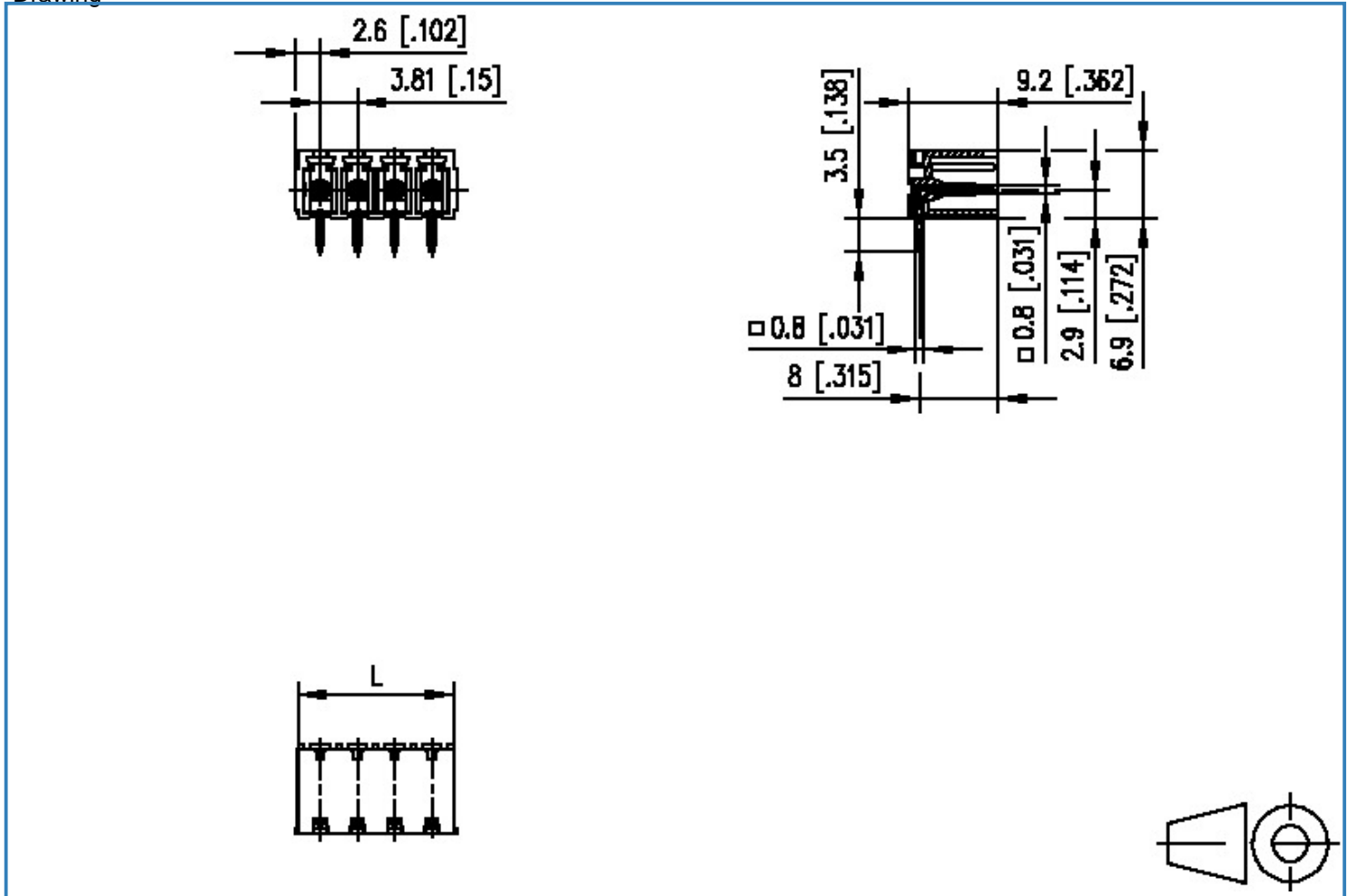

$L = (\text{pole size} - 1) \times \text{centerline} + 5.2 [0.205]$



Data Sheet

PR044xxHBBN

Page 5/5

P/N

311901xx

xx=number of poles

2013/12/05

PCB Layout

