

MECHANICAL DETAILS

Shell Style Model EG* : Fixed receptacle nut fixing

Keying 1 key (alpha=0, plug: male contacts, receptacle: female contacts)

Housing Material Brass (chrome plated) shell and collet nut, nickel plated brass latch sleeve and mid pieces

Cable Fixing 0 - 0 mm

Variant 2 :

		A	B	E	L	M	N
Mm.		22	25	11.5	30.7	2	28.1
In.		0.87	0.98	0.45	1.21	0.08	1.11

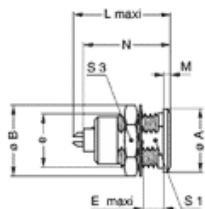

PERFORMANCE DETAIL

Insert 3B.304 : 4 Low Voltage

Insulator Y: PEEK for crimp contacts

Specifications

Contact Type: Crimp

Max. Matings: 5000

Contact 65 N

Contact Dia.: 2 mm (0.079in)

Bucket Dia.: 2.4 mm (0.094in)

Min. Conductor: 1.5 mm² (AWG 16)

Max. Conductor: 2.5 mm² (AWG 12)

R (max): 3.3 mOhm

Extractor: DCF.91.203.5LT

Positioner: DCE.91.203.BVCM



OTHER CHARACTERISTICS

Shell Style/Model Libellé

Temp (min) -55°C

Temp (max) +250°C

Humidity (max): <=95% [at 60 deg C /140 F]

Vibration: 15 g [10 Hz - 2000 Hz]

Shock Resistance: 100 g [6 ms]

Salt Spray >144 hr

Climatical 50/175/21

Shielding (min): 75 dB (10 MHz)

Shielding (min): 40 dB (1 GHz)

IP Rating 50

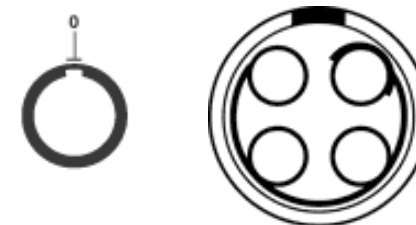









EGG.3B.304.CYM

Available Download

 unipole_multipole.pdf

Related links

-  [Contact](#)
-  [Quote Request](#)
-  [Catalogs Downloads](#)
-  [Catalogs Requests](#)
-  [Sample Request](#)
-  [3D drawings](#)