



# ERA.0S.403.CTL

## MECHANICAL DETAILS

**Shell Style Model** ERA\* : Fixed receptacle nut fixing

**Keying** Circular (can rotate), plug has male contact(s)

**Housing Material** Brass (chrome plated) shell and collet nut, nickel plated brass latch sleeve and mid pieces

**Cable Fixing** 0 - 0 mm

**Variant 2** :

	A	B	E	L	M	S1	e
Mm.	10	12.4	7	31.5	1.2	8.2	M9x0.6
In.	0.39	0.49	0.28	1.24	0.05	0.32	

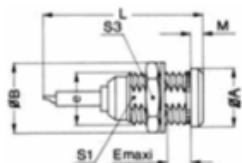

## PERFORMANCE DETAIL

**Insert** 0S.403 : 1 High Voltage

**Insulator** T: PTFE

**Specifications**

**Contact Type:** Solder



## OTHER CHARACTERISTICS

**Endurance (Shell)** Endurance (Shell):

**Temp (min)** -55°C

**Temp (max)** +250°C

**Humidity (max):** <=95% [at 60 deg C /140 F]

**Vibration:** 15 g [10 Hz - 2000 Hz]

**Shock Resistance:** 100 g [ 6 ms]

**Salt Spray** >144 hr

**Climatical** 50/175/21

**Shielding (min):** 75 dB (10 MHz)

**Shielding (min):** 40 dB (1 GHz)

**IP Rating** 50



## Available Download

[high\\_voltage.pdf](#)

## Related links

- [Contact](#)
- [Quote Request](#)
- [Catalogs Downloads](#)
- [Catalogs Requests](#)
- [Sample Request](#)
- [3D drawings](#)