



# FTA.0S.302.CLF

## MECHANICAL DETAILS

- Shell Style Model** FTA\* : T-plug with two in line receptacles
- Keying** Hermaphroditic keying (&quot;half moon&quot; insert), plug has male pin 1
- Housing Material** Brass (chrome plated) shell and collet nut, nickel plated brass latch sleeve and mid pieces
- Cable Fixing** 0 - 0 mm
- Variant 2** :

	A	H	I	L
Mm.	13	23	13	38
In.	0.51	0.91	0.51	1.50

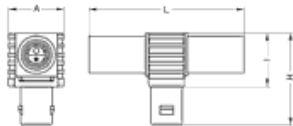

## PERFORMANCE DETAIL

- Insert** 0S.302 : 2 Low Voltage
- Insulator** L: PEEK
- Specifications**
- Contact Type:** Thermocouple

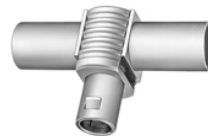

## OTHER CHARACTERISTICS

- Endurance (Shell)** Endurance (Shell):
- Temp (min)** -55°C
- Temp (max)** +250°C
- Humidity (max):** <=95% [at 60 deg C /140 F]
- Vibration:** 15 g [10 Hz - 2000 Hz]
- Shock Resistance:** 100 g [ 6 ms]
- Salt Spray** >144 hr
- Climatical** 50/175/21
- Shielding (min):** 75 dB (10 MHz)
- Shielding (min):** 40 dB (1 GHz)
- IP Rating** 50



## Available Download

unipole\_multipole.pdf

## Related links

- [Contact](#)
- [Quote Request](#)
- [Catalogs Downloads](#)
- [Catalogs Requests](#)
- [Sample Request](#)
- [3D drawings](#)