

**PLEASE CHECK WWW.MOLEX.COM FOR LATEST PART INFORMATION**

**Part Number:** [74726-0001](#)  
**Status:** **Active**  
**Overview:** SFP+ and SFP Interconnect Solutions  
**Description:** SFP Cage Lightpipe Cover Assembly, 1-by-1, Rear Mount

**Documents:**

[Drawing \(PDF\)](#) [RoHS Certificate of Compliance \(PDF\)](#)

**General**

Product Family	I/O Connectors
Series	<a href="#">74726</a>
Application	Module-to-Board
Comments	Rear mount lightpipe location
Component Type	Lightpipes
Overview	<a href="#">SFP+ and SFP Interconnect Solutions</a>
Product Name	SFP
Type	N/A
UPC	822348616657

**Physical**

Boot Color	N/A
Circuits (Loaded)	N/A
Gender	N/A
Keying to Mating Part	None
Lock to Mating Part	None
Material - Metal	Copper-Nickel-Zinc
Material - Plating Mating	N/A
Net Weight	1.834/g
Orientation	N/A
PCB Retention	None
Packaging Type	Tray
Panel Mount	No
Pitch - Mating Interface	N/A
Polarized to Mating Part	Yes
Polarized to PCB	N/A
Surface Mount Compatible (SMC)	N/A
Termination Interface: Style	N/A
Waterproof / Dustproof	No
Wire Size AWG	N/A

**Electrical**

Current - Maximum per Contact	N/A
Grounding to Panel	N/A
Shielded	No
Voltage - Maximum	N/A

**Solder Process Data**

Process Temperature max. C	70
----------------------------	----

**Material Info**

**Reference - Drawing Numbers**

Sales Drawing	SD-74726-001
---------------	--------------

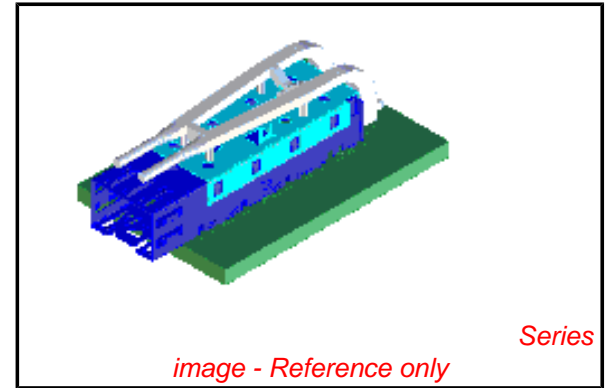

**EU RoHS**

**ELV and RoHS Compliant**  
**REACH SVHC Contains SVHC: No**  
**Low-Halogen Status Low-Halogen**

**China RoHS**



**Need more information on product environmental compliance?**

Email [productcompliance@molex.com](mailto:productcompliance@molex.com)  
 For a multiple part number RoHS Certificate of Compliance, [click here](#)

Please visit the [Contact Us](#) section for any non-product compliance questions.

**Search Parts in this Series**

[74726Series](#)

**Use With**

[74737](#)

**PLEASE CHECK [WWW.MOLEX.COM](http://WWW.MOLEX.COM) FOR LATEST PART INFORMATION**