

Part Number: 379

Type	Size	Rating	Description
Incandescent	T6	6.3V 200mA	T-1 ³ / ₄ Midget Groove Lamp

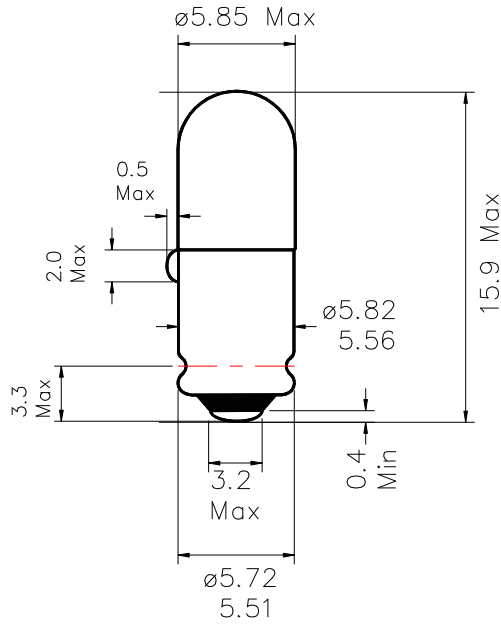

Dimensions in millimetres

TEST VOLTS	CURRENT (mA)			LIGHT OUTPUT (Lm)			LIFE Hours
	Min.	Nom.	Max.	Min.	Nom.	Max.	
6.3	180	200	220	3.8	5.0	6.2	20,000

Notes:

- 1 **Base Type** Nickel plated S5.7s
- 2 **Filament Shape** C-2F
- 3 **Lamp Marking** CML 379 6.3V 200mA
- 4 **Environmental** RoHS & REACH SVHC compliant