

# PANEL MOUNT INDICATOR, NON-RELAMPABLE

## NEON TECHNOLOGY

MOUNTING HOLE, Ø 0.500"

PART NO.	LENS COLOR	VOLTAGE	CURRENT [mA]	RATED LIFE HOURS
<b>NEON 115VAC SERIES</b>				
WL-1060QC1	RED	105-125VAC	1.5mA	25,000
WL-1060QC3	AMBER	105-125VAC	1.5mA	25,000
WL-1060QC4	WHITE	105-125VAC	1.5mA	25,000
WL-1060QC5	GREEN	105-125VAC	1.5mA	25,000
<b>NEON 230VAC SERIES</b>				
WL-1061QC1	RED	208-250VAC	1.5mA	25,000
WL-1061QC3	AMBER	208-250VAC	1.5mA	25,000
WL-1061QC4	WHITE	208-250VAC	1.5mA	25,000
WL-1061QC5	GREEN	208-250VAC	1.5mA	25,000

### NOTES

1. Recommended panel thickness  
0.030" to 0.090"
2. .187 terminals are standard
3. Storage temperature  
 $T_{STG}$ : -25°C - +80°C
4. Ambient temperature  
 $T_A$ : -20°C - +60°C
5. Voltage tolerance  
 $V_{OP}$ : ±10%
6. Body material  
Polycarbonate, white
7. Lens material  
Polycarbonate
8. Bezel material  
Stainless steel
9. .250 terminals available upon request

### CERTIFICATIONS

UL (E340667), RoHS



### DIMENSIONAL CHARACTERISTICS

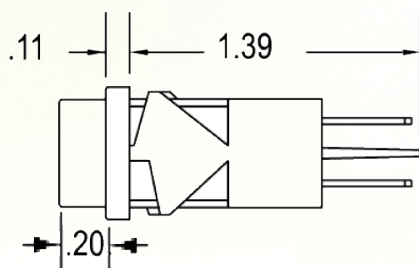

unless otherwise specified, all dimensions are in inches



### OPTIONS

Additional options and lens styles available. Please contact Wamco for more information.

