

Steel/Zinc & Clear (CR3)

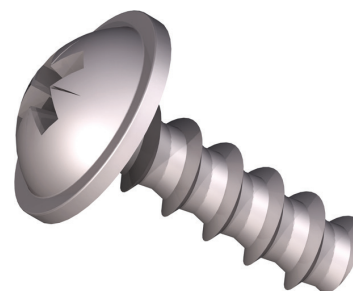
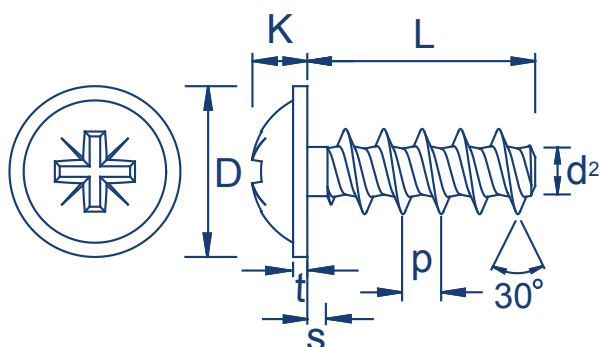

Dimensions (Metric)

Thread Dimensions	Screw Size	2.2	2.5	3.0	3.5	4.0	5.0	6.0
	d2 nom.	1.25	1.40	1.66	1.91	2.17	2.68	3.19
	p	0.98	1.12	1.34	1.57	1.79	2.24	2.69
	s (L > 3 x d1)	2.2	2.5	3.0	3.5	4.0	5.0	6.0
	s (L < 3 x d1)	1.1	1.3	1.5	1.8	2.0	2.5	3.0
Recommended Hole Size mm		1.54 - 1.87	1.75 - 2.12	2.10 - 2.55	2.45 - 2.97	2.80 - 3.40	3.50 - 4.25	4.20 - 5.10
Head Dimensions	D	4.4	5.0	6.0	7.0	8.0	10.0	12.0
	K	1.6	1.8	2.1	2.4	2.5	3.2	4.0
	t	0.5	0.6	0.7	0.8	0.9	1.1	1.3
	Recess No.	1	1	1	2	2	2	3

Preferred Lengths and Part Numbers (Metric)

Screw Size	Length (L)	5	6	8	10	12	14	16	18	20	25	30
		2.2										
2.5												
3.0			3.06 FLST30 TC1D	3.08 FLST30 TC1D	3.010 FLST30 TC1D	3.012 FLST30 TC1D	3.014 FLST30 TC1D	3.016 FLST30 TC1D				
3.5				3.58 FLST30 TC1D	3.510 FLST30 TC1D	3.512 FLST30 TC1D	3.514 FLST30 TC1D	3.516 FLST30 TC1D		3.520 FLST30 TC1D	3.525 FLST30 TC1D	
4.0				4.08 FLST30 TC1D	4.010 FLST30 TC1D	4.012 FLST30 TC1D	4.014 FLST30 TC1D	4.016 FLST30 TC1D	4.018 FLST30 TC1D	4.020 FLST30 TC1D	4.025 FLST30 TC1D	4.030 FLST30 TC1D
5.0						5.012 FLST30 TC1D		5.016 FLST30 TC1D		5.020 FLST30 TC1D	5.025 FLST30 TC1D	5.030 FLST30 TC1D
6.0												

Driver bits are available from stock for all screw sizes