

H:9 B: CFA 5HC B 7 C BH 5 B 98 B H K 6 8F5K B: 6 H 9 GC @ DFC D9FHMC:  
 @7 C A Z B 7 5 B MF 9DFC 8I 7 HC BG B D5FHC F K < C @ K H: C I H: 9 K F H 9 B  
 D9FA 6GC B C: @7 C A Z B 7 5 DFC < 6 H 9 8

# F c < G 7 ca d`Jubh'U

F9J 6C BG			
F9J	89G7 F 4HC B	85H9	7 < 5B: 98 6M
9	97B 7) * && FC15H98 @7 CA @C: C % \$S	+ #8 9 9%	B 7 5 GFC
:	97 B * & + 1 D85H98 @C: CG5B8: CFA 5H	S: # % # %	B: D
!		!	!
!		!	!

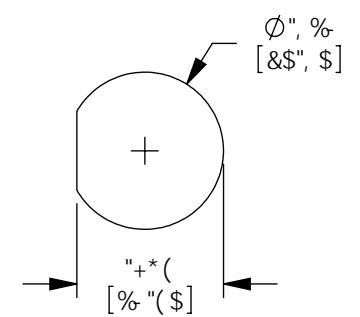

F97 C A A 9B 8 98  
 D5B 9 @ C D9B B:

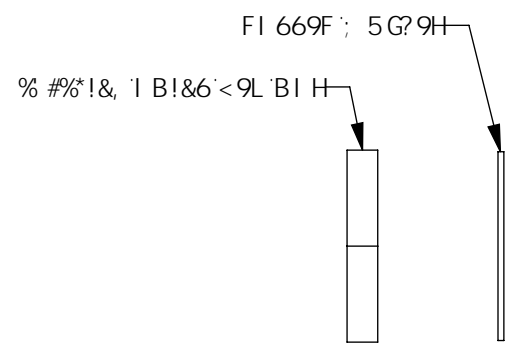

BI H5B8; 5G? 9HG < C K B B  
 H: 6 J 9 K C B @ M: C F 7 @ F H M

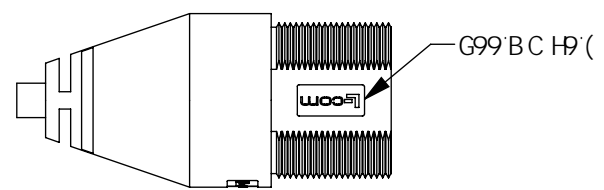
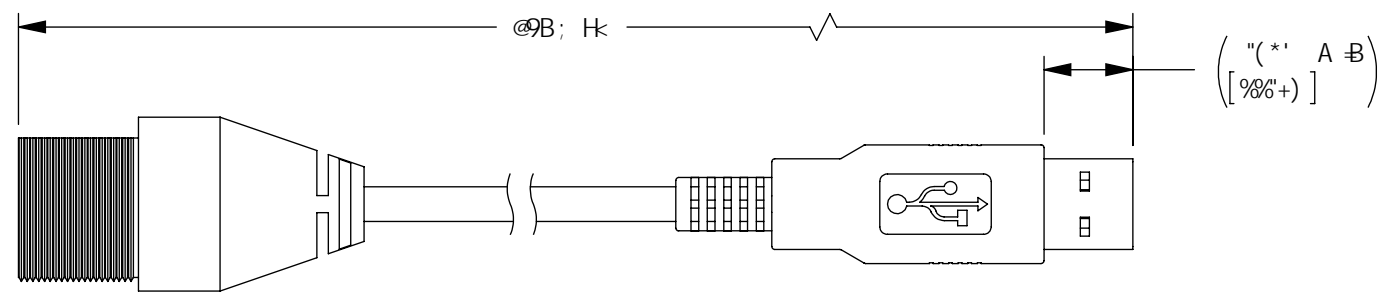

G99 BC H9 (

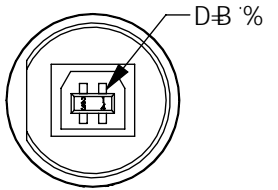

" > %"  
 I G6 G9F 9G 6  
 F97 9DH5 7 @

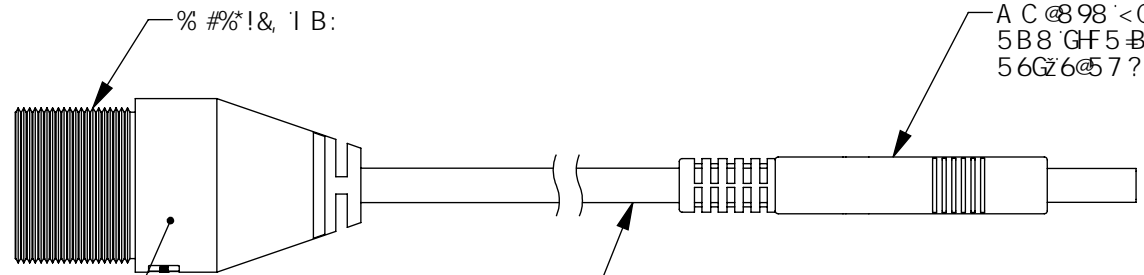

K 5 H F D F C C: < C I G B:  
 6 @ 7 ? 5 6 G I @ ( J I \$  
 f H D \* + F 5 H 9 8 L

C B 9 &, 5 K; GF5 B 8 98 H B B 98 7 C DD9F H K 6 H 9 8 D5 F  
 H K C & ( 5 K; GF5 B 8 98 H B B 98 7 C DD9F 7 C B 8 I 7 H C F G  
 C J 9 F 5 @ @ 5 @ A B A 9 8 D C @ M G H F G < 9 @ K H: 8 F 5 B:  
 K F 9 D @ G H B B 9 8 7 C DD9F 6 F 5 8 9 8 G < 9 @ B  
 D J 7 C I H 9 F > 5 7 ? 9 H z 6 @ 7 ?

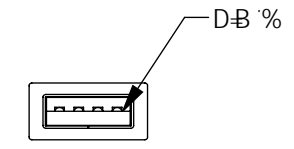

" D %"  
 I G6 G9F 9G 5  
 D @ ;

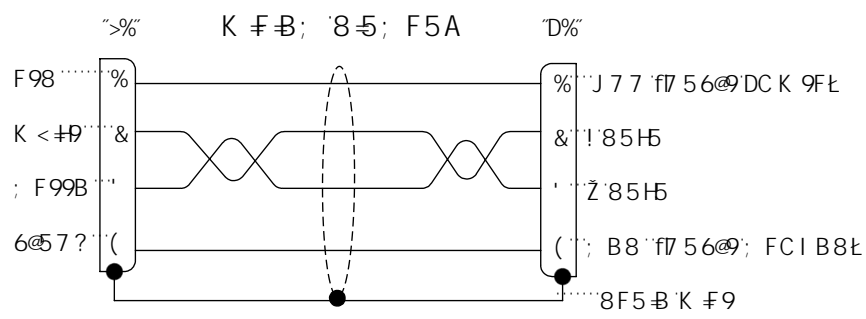

## BC H9G

% " H: 9 G 9 7 5 6 @ 5 G 9 A 6 @ 9 G 5 F 9 7 C B G F I 7 H 9 8 H C A 9 9 H I K 9  
 " " " F 9 E I F 9 A 9 B H G C: H: 9 I B J 9 F G 5 @ 9 F 5 @ 6 I G G D 9 7 = 7 5 H C B  
 " " " I G 6 & \$"  
 & " 7 C B B 9 7 H C F 7 C B H 5 7 H G < 5 J 9 " \$ + B 7 < 9 G: C @  
 " " " D 5 H B; C J 9 F B 7 ? 9 @ D 5 H B; "  
 " " " H: 9 7 5 6 @ 9 G < 9 @ 8 8 F 5 B K F 9 6 7 C B B 9 7 H 9 8 H C H: 9  
 " " " A 9 H 5 @ G < 9 @ C: 9 5 7 < D @ ; "  
 ( " " " H: 9 @ 7 C A " @ C: C 6 9 A 6 C G G 9 8 B 5 F 9 7 9 G G 9 8 D C 7 ? 9 H " H: 9  
 " " " F 5 6 9 8 @ C: C G < C I @ B C H D F C > 9 7 H 6 9 M C B 8 H: 9 C J 9 F A C @  
 " " " G I F: 5 7 9"  
 ) " " 7 5 6 @ 5 G 9 A 6 @ M G < 5 @ 6 9 H 9 G H 9 8: C F 7 C B H B I H M  
 \* " " 7 5 6 @ 5 G 9 A 6 @ M G < 5 @ 6 9 B 8 J 8 I 5 @ M D 5 7 ? 5; 9 8 B  
 " " " 5 7 7 C F 8 5 B 7 9 K H: @ 7 C A G D 9 7 = 7 5 H C B D G I \$ \$ ' %"

MODEL NUMBER	LENGTH	
	METER	FEET
WPUSBBA-05M	0.5	1.64
WPUSBBA-1M	1.0	3.28
WPUSBBA-2M	2.0	6.56
WPUSBBA-3M	3.0	9.84
WPUSBBA-5M	5.0	16.41

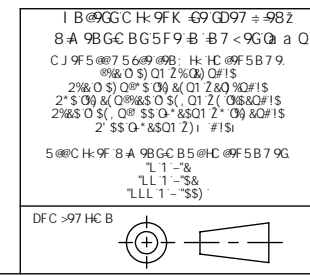

I B @ G G C H: 9 F K 6 9 @ D 9 7 = 9 8 z  
 8 A 9 B G C B G 5 F 9 B B 7 < 9 G @ a O  
 C J 9 F 5 @ 7 5 6 @ 9 8: H: H C @ F 5 B 7 9  
 @ % O S ) O I 2 % O ) O # I S  
 2 % O S ) O # S O 9 8 ( O I 2 & O % O # I S  
 2 \* S O 9 8 ( O % % S O S ( O I 2 ( O 8 8 O # I S  
 2 % S O S ( O # S S O 8 S O I 2 \* O 9 8 O # I S  
 2 \* S O \* & S O I 2 ) I # I S

5 D D F C J 5 @ G 8 5 H 9  
 8 F 5 K B 6 M  
 > 7 9 N @ 5 G  
 7 < 9 7 9 8 6 M  
 A " 8 5 < 9 M  
 5 D D F C J 9 8 6 M  
 F " 7 5 F F 7 ? ?  
 7 C B: = I F 5 H C B 8 9 H 5 @ C C:  
 I B 8 A 9 B G C B 9 8: 9 5 H F 9 G  
 A 5 M J 5 F M  
 7 C @ F J 5 F 5 H C B G  
 A 5 M C 7 7 I F

**L-com** Global Connectivity ( ) 6997 < K C C 8 8 F = 9  
 B C F H: 5 B 8 C J 9 F Z A 5  
 \$ % ( )

75H9: CFM I G6

DFC 8 I 7 H 8 9 7 F 4 H C B

7 6 @ K H F D F: I G 6 I: # 5 ! A

G99	G7 A B C *	8K: " B C *	F9J *
<b>6</b>	( ' & %	K D I G 6 6 5	:

G7 5 @ 9: % % 7 5 B: @ 9: K D I G 6 6 5 G 8 8 F K G: 9 9 H % C: %