

RECOMMENDED PCB LAYOUT

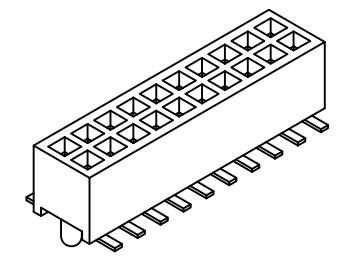
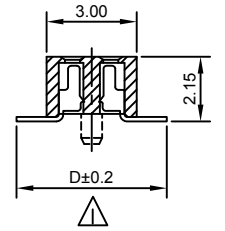
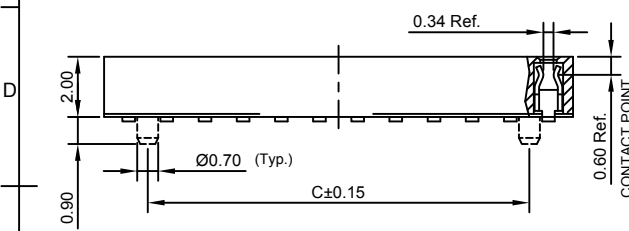

CONTACTS	DIMENSIONS		
	A	B	C
06	2.54	4.05	1.27
08	3.81	5.32	2.54
10	5.08	6.59	3.81
12	6.35	7.86	5.08
14	7.62	9.13	6.35
16	8.89	10.40	7.62
18	10.16	11.67	8.89
20	11.43	12.94	10.16
22	12.70	14.21	11.43
24	13.97	15.48	12.70
26	15.24	16.75	13.97
28	16.51	18.02	15.24
30	17.78	19.29	16.51
32	19.05	20.56	17.78
34	20.32	21.83	19.05
36	21.59	23.10	20.32
38	22.86	24.37	21.59
40	24.13	25.64	22.86
42	25.40	26.91	24.13
44	26.67	28.18	25.40
46	27.94	29.45	26.67
48	29.21	30.72	27.94
50	30.48	31.99	29.21
52	31.75	33.26	30.48
54	33.02	34.53	31.75
56	34.29	35.80	33.02
58	35.56	37.07	34.29
60	36.83	38.34	35.56
62	38.10	39.61	36.83
64	39.37	40.88	38.10
66	40.64	42.15	39.37
68	41.91	43.42	40.64
70	43.18	44.69	41.91
72	44.45	45.96	43.18
74	45.72	47.23	44.45
76	46.99	48.50	45.72
78	48.26	49.77	46.99
80	49.53	51.04	48.26

Ordering Grid
BD050 - **XX** - **X** - **X** - **XXXX** - **L** - **X**

REQUEST SAMPLES AND QUOTATION

No. of Contacts: 06 to 80

Contact Plating:
A = Gold Flash All Over (Standard)
C = Tin All Over

Insulator Material:
L = LCP

Dimension D (1/100mm) (Footprint Width)
0500 = 5.00mm (Standard)
 0450 = 4.50mm

Packing Options:
B = Tape & Reel with Cap (Standard)
 D = Tube
 E = Tube with Cap
 F = Tube with Film

Locating Peg:
 0 = No Peg
 1 = With Peg

SPECIFICATIONS 规格:

CURRENT RATING 电流额定值: 1 AMP
 INSULATOR RESISTANCE 绝缘电阻值: 1000 MΩ MIN.
 CONTACT RESISTANCE 接触电阻值: 20 mΩ MAX
 DIELECTRIC WITHSTANDING 耐电压: AC 500 V
 OPERATING TEMPERATURE 工作温度: -40° TO +105°C
 CONTACT MATERIAL 端子物料: PHOSPHOR BRONZE
 INSULATOR MATERIAL 绝缘体物料: POLYESTER 聚酯, LCP, UL 94 V-0
 SOLDERING PROCESS 可焊性: LCP -
 IR REFLOW 回流焊: 260°C for 10 sec.
 WAVE 波峰焊: 250°C for 5-10 sec
 MANUAL SOLDER 人工焊接: 350°C for 3-5 sec

MATES WITH 配套之母座 (SUBJECT TO PIN LENGTH 在端子长度适合的条件下):
 BD025 BD030 BD035 BD038 BD040
 BD095

For bottom entry applications, stringent soldering control & pin alignment are required as lead to pad misalignment could cause incorrect mating.

By LYH PN CB AE SA SA AJO AJO										Tolerances (Except as noted)		Part Number:- BD050		Date:- 28 DEC 07		GCT www.globalconnectortechology.com									
DETAIL DRAWING RELEASE										Dimensions in mm		Description:-		Scale NTS						Revision J		Material See Note		Drawn by LYH	
REV DATE										X. ± 0.30		1.27mm SOCKET N6T REMOVAL		© THIS DRAWING IS CONFIDENTIAL AND MUST NOT BE COPIED OR DISCLOSED WITHOUT WRITTEN CONSENT											



Third Angle Projection