

Part Number: M85049/10
EMI/RFI Environmental Backshell

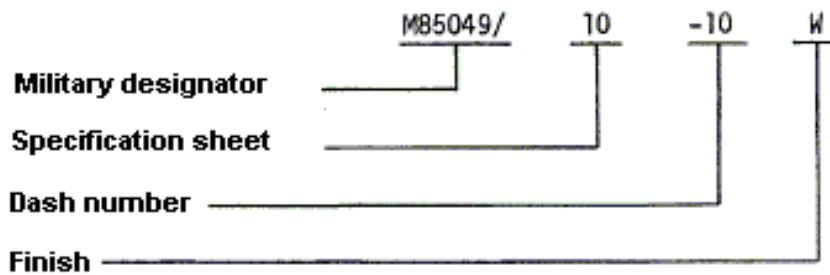
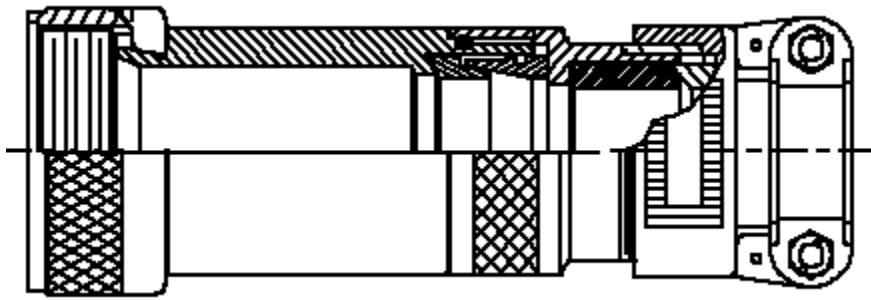

Dash Number

Dash Number	Shell Size	Cable Diameter Min (in)	Cable Diameter Min (mm)	Cable Diameter Max (in)	Cable Diameter Max (mm)
01	3	.125	3.2	.250	6.4
05	8	.125	3.2	.250	6.4
09	10	.125	3.2	.312	7.9
13	12	.250	6.4	.437	11.1
17	14	.350	8.9	.575	14.6
21	16	.500	12.7	.700	17.8
25	18	.350	8.9	.625	15.9
31	20	.350	8.9	.625	15.9
39	22	.350	8.9	.625	15.9
47	24	.500	12.7	.750	19.1
55	28	.500	12.7	.750	19.1
63	32	.625	15.9	.937	23.8
71	36	.875	22.2	1.250	31.8
79	40	.875	22.2	1.250	31.8
87	44	.875	22.2	1.250	31.8
95	48	.875	22.2	1.250	31.8
103	61	.500	12.7	.750	19.1

Finish / Material

A = Cadmium Olive Drab over Nickel/ Aluminum

C = Cadmium Olive Drab/ Aluminum

B = Black Cadmium / Stainless Steel

N = Electroless Nickel / Aluminum

S = Passivated / Stainless Steel

W = 1,000 Hr. Cadmium Olive Drab over Electroless Nickel / Aluminum

X = Aluminum, Nickel Fluorocarbon Polymer

Z = Aluminum, Zinc-Nickel, Black

Joslyn Sunbank Company LLC.
1740 Commerce Way - Paso Robles, California 93446
805238-2840 fax805238-0241
www.sunbankcorp.com