

Shock-Safe Fuseholder, 5 x 20 / 6.3 x 32 mm, Slotted Cap



Socket with Slotted Cap
Caps must be ordered separately (see accessories)

Socket with Slotted Cap

Socket with Fingergrip Cap

250 VAC · 4 W / 10 A (VDE) 20 A (UL)



Description

- Quick-connect or solder terminals

Standards

- IEC 60127-6
- UL 4248-1 / UL 512
- CSA C22.2 no. 39

Approvals

- VDE Certificate Number: 134125
- UL File Number: E39328
- CSA File Number: 38456

Weblinks

[pdf-datasheet](#), [html-datasheet](#), [General Product Information](#), [Approvals](#), [CE declaration of conformity](#), [RoHS](#), [CHINA-RoHS](#), [REACH](#), [e-Shop](#), [SCHURTER-Stock-Check](#), [Distributor-Stock-Check](#), [Accessories](#), [Detailed request for product](#)

Technical Data

| | |
|------------------------------|--|
| Shock-Safe Category | PC2 |
| Fuse-Link | 5 x 20 or 6.3 x 32 mm |
| Mounting | Panel Mount, Front Side |
| Mounting | Fixing Nut |
| Terminal | Solder or Quick-Connect 4.8 x 0.5 mm |
| Rated Voltage | 250 VAC |
| Rated current | 10 A (VDE), 20 A (UL) |
| Rated Power Acceptance IEC | 4 W / 10 A @ Ta 23 °C Admissible power acceptance at higher ambient temperature see derating curves |
| Degree of Protection | IP 40 |
| Protection Class | Suitable for appliances with protection class I or II acc. to IEC 61140 |
| Admissible Ambient Air Temp. | -40 °C to 85 °C |
| Climatic Category | 40/085/21 acc. to IEC 60068-1 |
| Material: Socket | Thermoplastic, black, UL 94V-0 |
| Material: Terminals | Tin-Plated Copper Alloy |
| Unit Weight | 5.5 g / 3.22 g |
| Storage Conditions | 0 °C to 60 °C, max. 70% r.h. |
| Product Marking | Type, Rated voltage, Rated current, Approvals |

| | |
|---------------------------------|---|
| Soldering Methods | Iron |
| Solderability | 350 °C / 2 sec acc. to IEC 60068-2-20, Test Ta, method 2 |
| Resistance to Soldering Heat | 350 °C / 10 sec acc. to IEC 60068-2-20, Test Tb, method 2 |
| Contact Resistance | < 5 mΩ at 20 mV |
| Dielectric Strength | > 3 kV > 4 kV between L/N-PE (50 Hz; 1 min) |
| Impulse Withstand Voltage | > 4 kV between L-N > 6 kV between L/N-PE |
| Insulation Resistance | > 10 MΩ between L-N > 100 MΩ between L/N-PE (500 VDC; 1 min) |
| Overvoltage Category | I - III acc. to IEC 60664-1 |
| Pollution Degree | 1 - 3 acc. to IEC 60664-1 |
| Admissible Torque on Fixing Nut | max 1.2 Nm |
| Panel Thickness s | max 7 mm |

Dimension

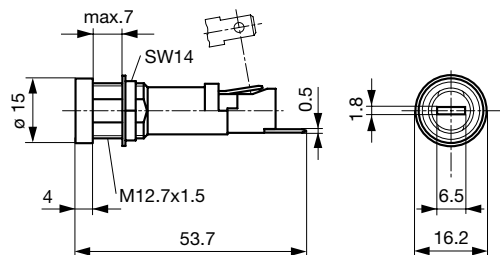
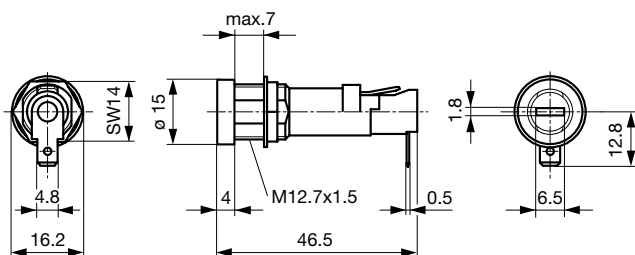

Variants: 0031.1693

Variant 0031.1694

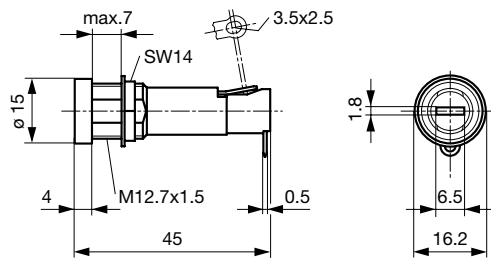
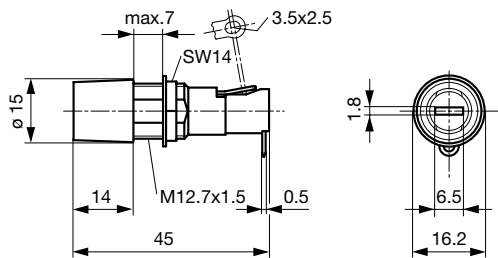

Variants 0031.1653

Variant 0031.1673

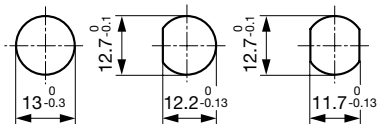

Mounting holes

Derating Curves

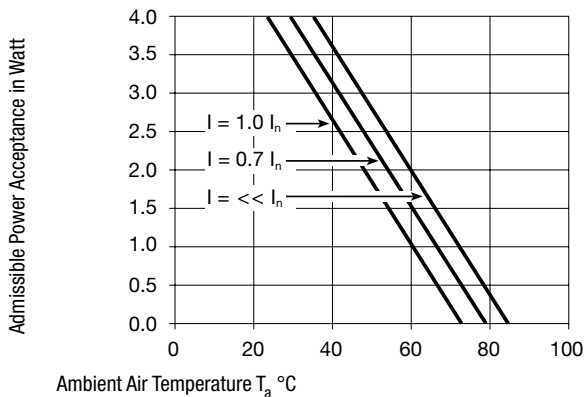

All Variants

| Holder | Cap | Fuse-Link | Terminal | Position End-Terminal | Degree of Protection | Colour Cap | Remark | Order Number |
|--------|-----|----------------------|-------------------------|-----------------------|----------------------|------------|--------|--------------|
| ● | - | 5 x 20 or 6.3 x 32mm | Quick-Connect 4.8 x 0.5 | 90° to Fuse Axis | IP 40 | - | - | 0031.1693 |
| ● | - | 5 x 20 or 6.3 x 32mm | Quick-Connect 4.8 x 0.5 | Straight to Fuse Axis | IP 40 | - | - | 0031.1694 |
| ● | - | 5 x 20 or 6.3 x 32mm | Solder | 90° to Fuse Axis | IP 40 | - | - | 0031.1653 |
| ● | - | 5 x 20 or 6.3 x 32mm | Solder | 90° to Fuse Axis | IP 40 | - | - | 0031.1673 |

Most Popular.

Availability for all products can be searched real-time: <http://www.schurter.com/en/Stock-Check/Stock-Check-SCHURTER>

Packaging Unit Bulk (100 pcs.)

Required Accessory

Description



Fingergrasp FEU, FAU, FAC
Caps Fingergrasp for Holder FEU, FAU, FAC



Caps to FEU, FAU, FAC
Caps to Holder FEU, FEU (Med), FAU, FAC



Accessories



Cover FEU, FEU (Med)
Insulation Cover for FEU, FEU (Med)