

1

2

3

4

5

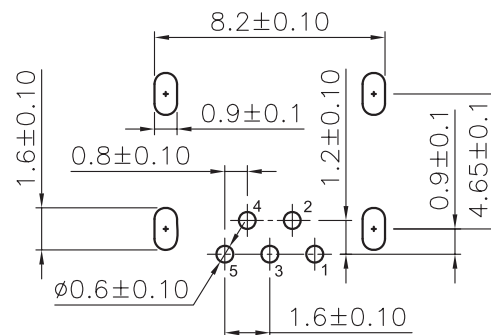
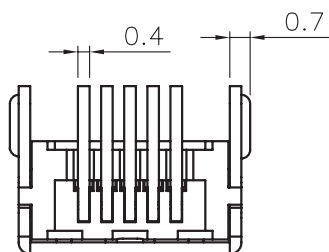

RECOMMENDED PCB LAYOUT  
RECOMMENDED PCB THICKNESS : 1.6 mm

#### TECHNICAL CHARACTERISTICS

**MATERIAL**  
INSULATOR: PBT  
FLAMABILITY RATING: UL94-V0  
COLOR: BLACK  
CONTACT MATERIAL: COPPER ALLOYS  
CONTACT TYPE: STAMPED  
CONTACT PLATING: SELECTIVE GOLD  
SHIELDING: BRASS WITH Ni PLATING  
QUALITY CLASS: 1500 MATING CYCLES

**ENVIRONMENTAL**  
OPERATING TEMPERATURE: -40 UP TO 105°C  
COMPLIANCE: LEAD FREE AND ROHS

**ELECTRICAL**  
CURRENT RATING: 1.0 A max  
WORKING VOLTAGE: 30V AC  
INSULATOR RESISTANCE: >1000 MOHM  
DIELECTRIC WITHSTANDING VOLTAGE: 750V AC/MN  
CONTACT RESISTANCE: 20 mOHM MAX

**STANDARD**  
CERTIFIED: E323964 / MODEL NUMBER 651-1365

**SOLDERING**  
WAVE PROCESS ONLY

**PACKAGING**  
TRAY

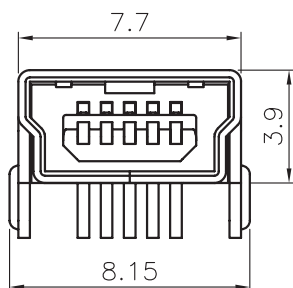
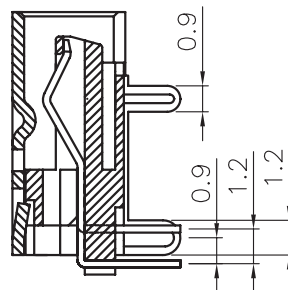
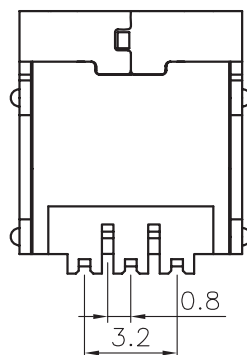
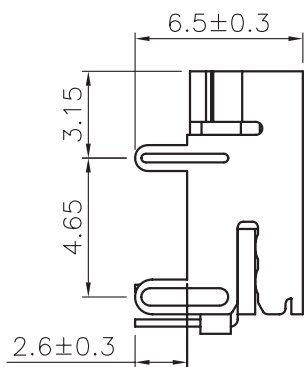

RoHS Compliant

PROJECTION:

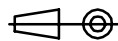

GENERAL TOLERANCE

.X =  $\pm 0.2$

.XX =  $\pm 0.15$



APPROVAL: NPr

UNIT: MM

SCALE:

SHEET: 1/1

DRAW: DXS

DESCRIPTION: MINI USB 2.0 TYPE B 5 CONTACTS

WERI PART NO: 651 005 136 521

SIZE

**A4**

REV	DATE	FILE	BY
K	09-AVR-15	PCB THICKNESS	QP
J	18-FEB-13	DESIGNATION	AR
I	08-NOV-11	CURRENT RATING	GG
H	22-JUN-11	CURRENT RATING	GG

RoHS Compliant			

PROJECTION:	GENERAL TOLERANCE
	.X = $\pm 0.2$
	.XX = $\pm 0.15$

APPROVAL: NPr	UNIT: MM	DESCRIPTION: MINI USB 2.0 TYPE B 5 CONTACTS
	SCALE:	
	SHEET: 1/1	WERI PART NO: 651 005 136 521
	DRAW: DXS	

WE	WÜRTH ELEKTRONIK

SIZE
<b>A4</b>

1

2

3

4

5

## Cautions and Warnings:

This electronic component is designed and developed with the intention for use in general electronics equipments.

Before incorporating the components into any equipments in the field such as aerospace, aviation, nuclear control, submarine, transportation, (automotive control, train control, ship control), transportation signal, disaster prevention, medical, public information network etc. where higher safety and reliability are especially required or if there is possibility of direct damage or injury to human body, Würth Elektronik must be asked for a written approval.

In addition, even electronic component in general electronic equipments, when used in electrical circuits that require high safety, reliability functions or performance, the sufficient reliability evaluation-check for the safety must be performed before by the user before usage.

A

B

C

RoHS Compliant

G				PROJECTION: 	GENERAL TOLERANCE .X = +/- 0.2 .XX = +/- 0.15		
F							
E							
D							
C				APPROVAL: JC	UNIT: MM	DESCRIPTION: DISCLAIMER	SIZE <b>A4</b>
B					SCALE:		
A	10-SEP-14	PDF	QL		SHEET: 2/2	WERI PART NO: DISCLAIMER	
REV	DATE	FILE	BY		DRAW: QL		

D