

# BACKGROUND CLEVER

## MUSIC SPEAKERS

a c o u s t i c s

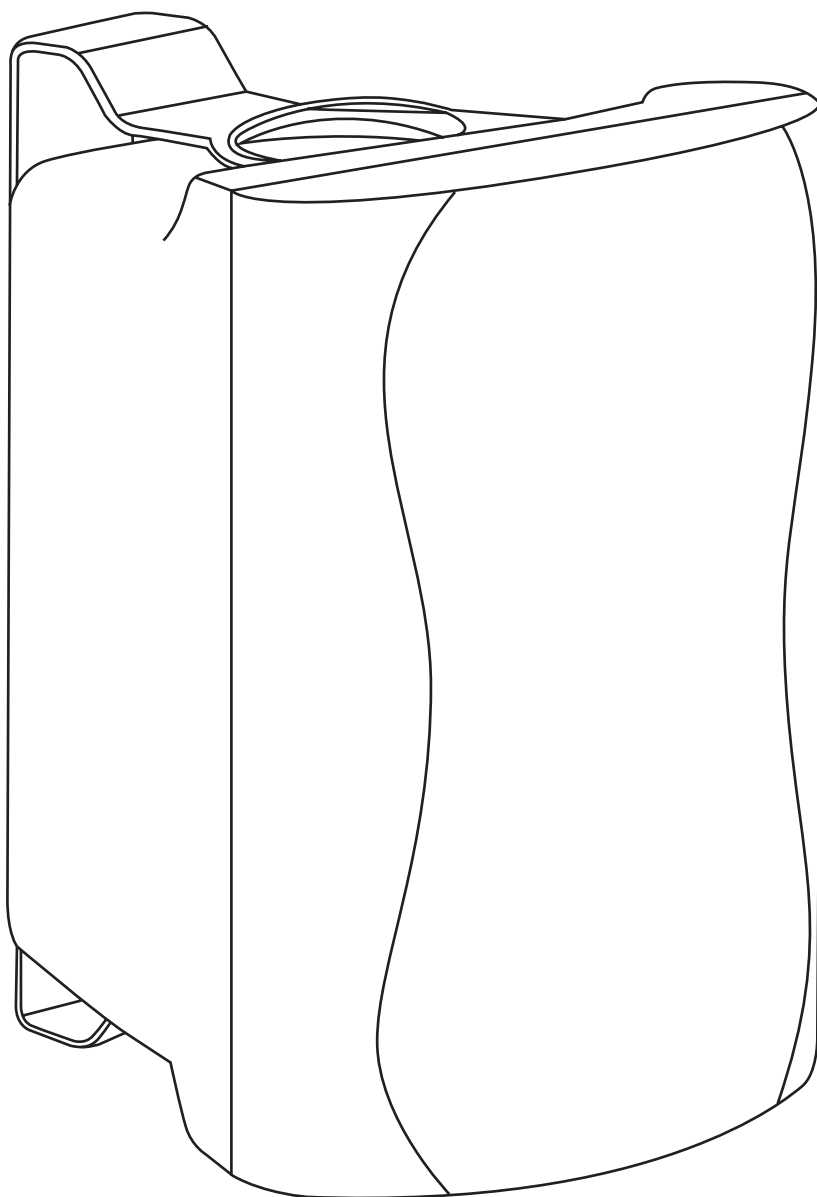

- CRSP23 - BGS 25 White**
- CRSP24 - BGS 25 Black**
- CRSP35 - WPS 25 Weatherproof White**
- CRSP36 - WPS 25 Weatherproof Black**
- CRSP25 - BGS 35 White**
- CRSP26 - BGS 35 Black**
- CRSP37 - WPS 35 Weatherproof White**
- CRSP38 - WPS 35 Weatherproof Black**
- CRSP27 - BGS 50 White**
- CRSP28 - BGS 50 Black**
- CRSP39 - WPS 50 Weatherproof White**
- CRSP40 - WPS 50 Weatherproof Black**

[www.cleveracoustics.co.uk](http://www.cleveracoustics.co.uk)

USER MANUAL

ENGLISH

## WARNING

**FOR YOUR OWN SAFETY, PLEASE READ THIS USER MANUAL CAREFULLY  
BEFORE YOUR INITIAL START-UP!**

### Unpacking Instructions

Immediately upon receiving this product, carefully unpack the carton and check the contents to ensure that all the parts are present, and have been received in good condition. Notify the dealer immediately and retain the packaging material for inspection if any parts appear damaged from shipping or the carton itself shows signs of mishandling. Save the carton and all packaging materials. In the event that a fixture must be returned to the supplier, it is important that the fixture is returned in the original carton and packaging.



#### **CAUTION! (BGS Series Only)**

**Do not use the speakers close to water or in  
damp/humid environment.**



### SAFETY INSTRUCTIONS

Every person involved with the installation, operation & maintenance of this equipment should:

- Be competent
- Follow the instructions of this manual

Before your initial start-up, please make sure that there is no damage caused during transportation. Should there be any, consult your dealer and do not use the equipment.

To maintain the equipment in good working condition and to ensure safe operation, it is necessary for the user to follow the safety instructions and warning notes written in this manual.

Please note that damages caused by user modifications to this equipment are not subject to warranty.



#### **DANGER TO LIFE!**

**Before putting the speaker into operation for the first time, the  
installation has to be approved by an expert!**



## **IMPORTANT:**

**The manufacturer will not accept liability for any resulting damages caused by the non-observance of this manual or any unauthorised modification to the equipment.**

- Never leave any cables lying around.
- Do not use the unit near stoves, heaters, radiators, or other heat producing devices.
- Do not insert any objects into the air vents.
- Never remove warning or informative labels from the equipment.
- Do not open the equipment and do not modify the equipment.
- Only use the equipment indoors. (BGS Series Only)
- WPS Series for sheltered outdoor use.
- Do not expose to flammable sources, liquids or gases.
- Make sure you don't use the wrong kind of cables or defective cables.
- Do not drive the inputs with a signal level bigger, than required to drive the equipment to its full output
- Prevent distortion! Make sure that all components connected to the speaker have sufficient power ratings. Distortion will be generated if the components are operated at their limits.
- The user is responsible for correct positioning and operating of this fixture. The manufacturer will not accept liability for damages caused by the misuse or incorrect installation of this equipment.
- Repairs and servicing must only be carried out by a qualified technician.  
THIS UNIT CONTAINS NO USER SERVICEABLE PARTS.
- WARRANTY; One year from date of purchase.

## **OPERATING DETERMINATIONS**

Incase of mal-function this device should be returned for service or inspection.

If this equipment is operated in any other way, than those described in this manual, the product may suffer damage and the warranty becomes void.

Incorrect operation may lead to danger e.g.: short-circuit, burns, electric shocks, lamp failure etc.

Do not endanger your own safety and the safety of others!

Incorrect installation or use can cause serious damage to people and property.

## Features

- 2-way speakers
- Complete with mounting brackets
- Supplied in pairs
- Available in Black and White
- Optional mounting by M6 screw sockets
- Robust housing
- WPS Series suitable for installation outside in sheltered conditions

<b>Specifications:</b>	<b>BGS 25 WPS 25</b>	<b>BGS 35 WPS 35</b>	<b>BGS 50 WPS 50</b>
<b>Freq. Range:</b>	70Hz~18kHz	60Hz~18kHz	55Hz~20kHz
<b>Sensitivity (SPL @ 1W/1m):</b>	88dB	89dB	89dB
<b>Max Calculated SPL:</b>	95dB	98dB	95dB
<b>Power (RMS):</b>	25W	35W	50W
<b>Power (Max):</b>	50W	70W	100W
<b>LF Transducer:</b>	4" Polypropylene	5" Polypropylene	6.5" Polypropylene
<b>HF Transducer:</b>	1" Mylar	1" Mylar	1" Mylar
<b>Impedance:</b>	8 Ohms	8 Ohms	8 Ohms
<b>Connections:</b>	2 x Binding terminals	2 x Binding terminals	2 x Binding terminals
<b>Dimensions (H×W×D):</b>	210 x 160 x 130mm	240 x 178 x 145mm	285 x 205 x 180mm
<b>Net Weight:</b>	1.5kgs (each)	2.2kgs (each)	3.2kgs (each)
<b>Shipping Weight:</b>	3.1kgs (pair)	4.4kgs (pair)	6.4kgs (pair)

## Overview:

BGS 25/WPS 25:

BGS 35/WPS 35:

BGS 50/WPS 50:

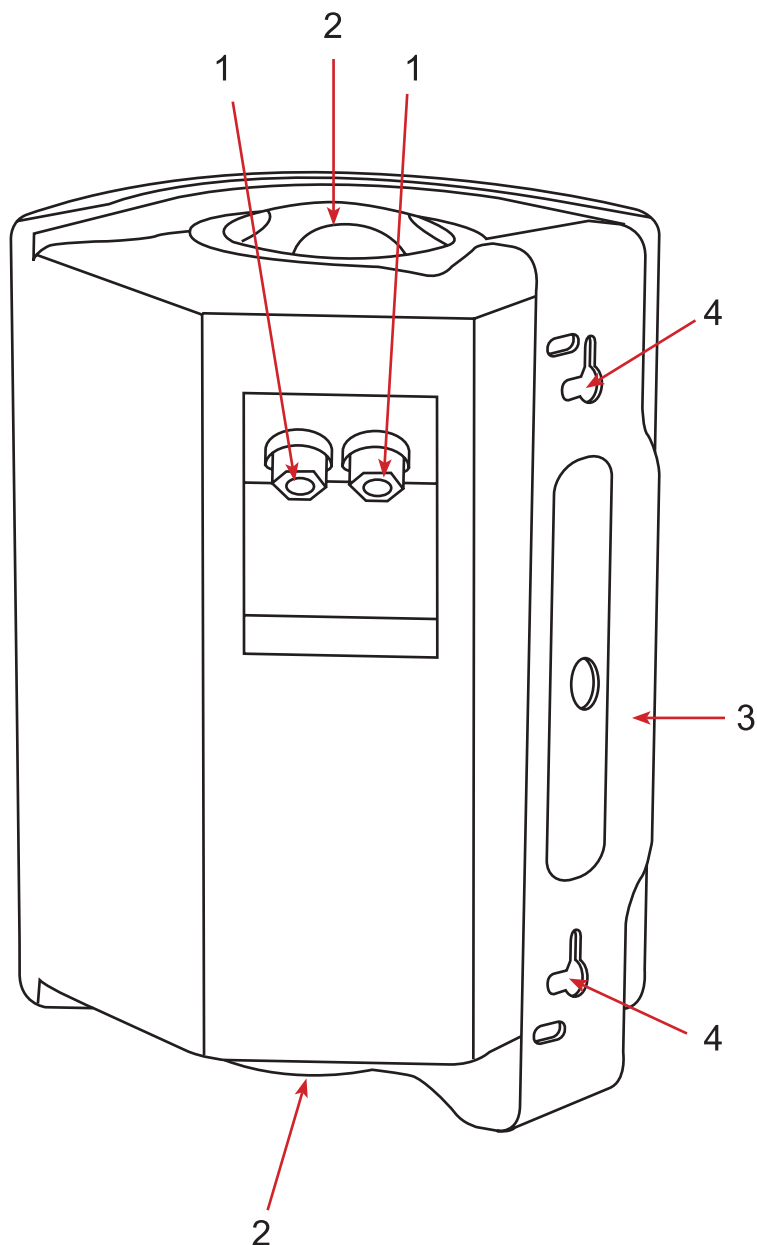

## Identification:

- 1, Binding post connectors
- 2, Angle adjustment knob
- 3, Bracket
- 4, Wall mounting holes - Max 6mm fixing

## Wall Installation:

Before attaching the speaker, make sure that the installation area can hold a minimum point load of 10 times the installations weight. (e.g. 13kgs - 130kgs point load).

The durability of the installation depends very much on the material used at the installation area (building material), such as wood, concrete and brick etc. This is why the fixing material must be chosen to suit the wall material. Always ask a specialist for the correct plug/screw combination indicating the maximum load and building material.

## Installation:

- DO NOT run microphone cables near mains, data, telephone or 100V line cables.
- ENSURE that all loudspeakers are in-phase.
- ENSURE that there are no short circuits on the loudspeaker line before connection of the amplifier.
- Where it is intended to use multiple low impedance speakers to cover an area, the speakers must be wired in a series/parallel arrangement in such a way as to present the correct load to the amplifier.
- Note: The total load impedance presented to the amplifier must never be below the rated amplifier impedance, otherwise damage can result.

### Standard 2 speaker set up:

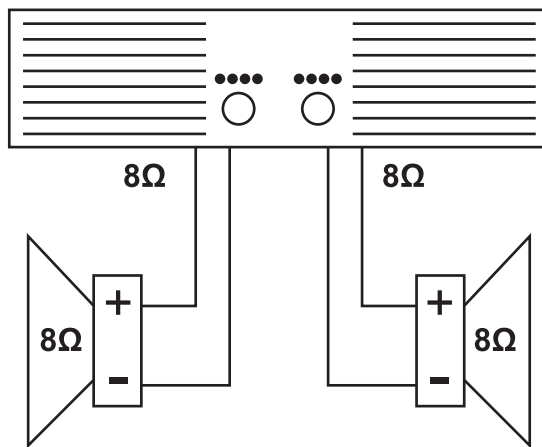

### Parallel 4 speaker set up:

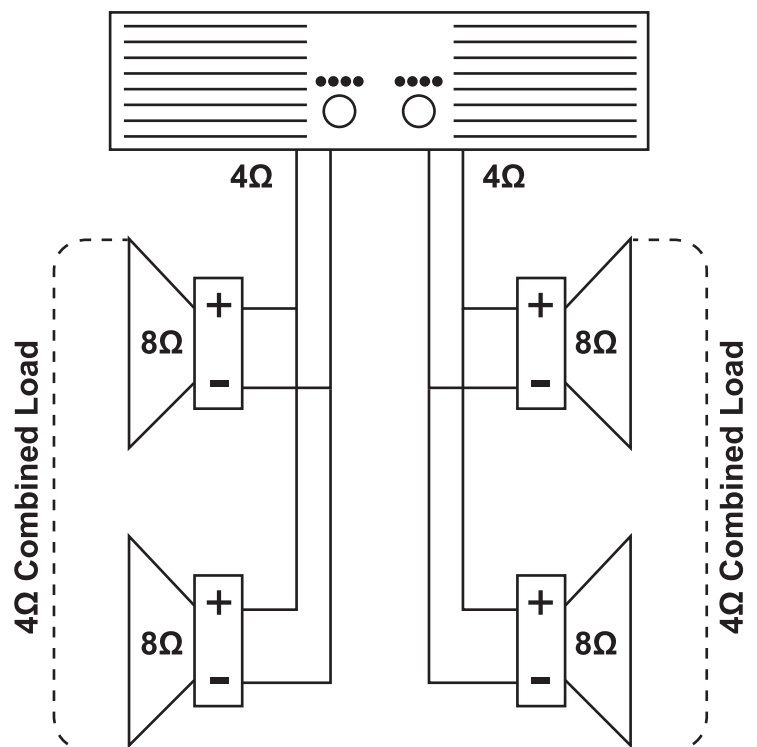

## Series Parallel 4 speaker mono set up:

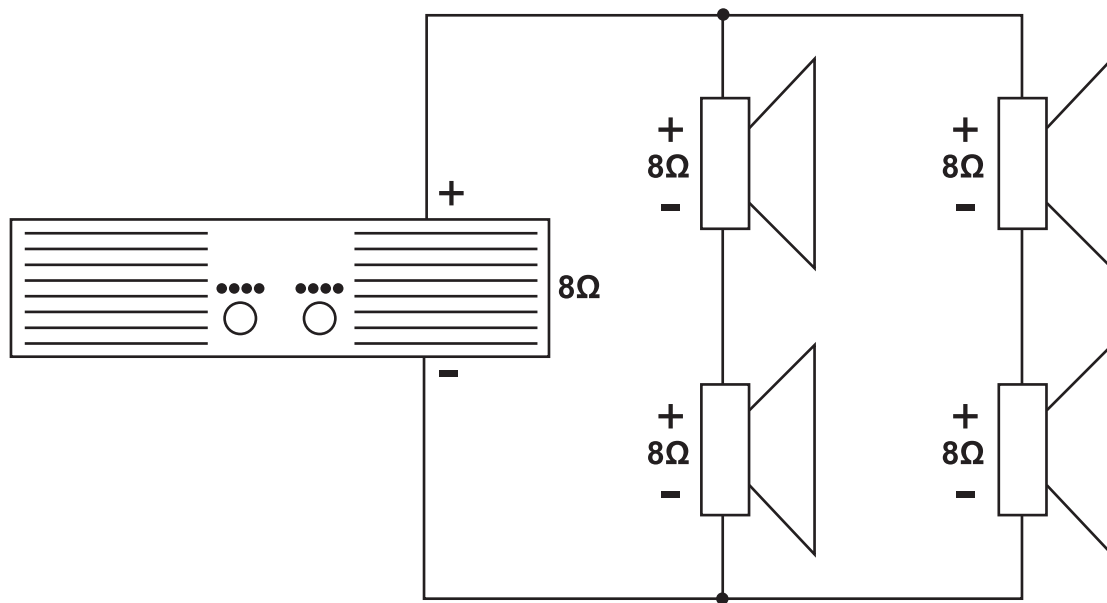

**CLEVER**  
**a c o u s t i c s**  
**[www.cleveracoustics.co.uk](http://www.cleveracoustics.co.uk)**