

Flush-type connector - SACC-DSI-M5MS-3CON-L180 - 1530621

Please be informed that the data shown in this PDF Document is generated from our Online Catalog. Please find the complete data in the user's documentation. Our General Terms of Use for Downloads are valid (<http://phoenixcontact.com/download>)



Sensor/actuator flush-type plug, 3-pos., M5, prewall/screw mounting, with straight solder connection

Product description

Rear mounting, one-piece, for wave soldering processes, 180°



Key commercial data

Packing unit	20 pc
Minimum order quantity	20 pc
GTIN	 4 046356 024426
Weight per Piece (excluding packing)	2.54 g
Custom tariff number	85366990
Country of origin	Germany
Product key	ABQAAA
Note	Made to Order (non-returnable)

Technical data

Ambient conditions

Ambient temperature (operation)	-25 °C ... 80 °C
Degree of protection	IP67

General

Rated current at 40°C	1 A
Rated voltage	60 V
Number of positions	3
Contact resistance	≤ 3 mΩ
Insulation resistance	≥ 100 MΩ
Coding	A - standard
Standards/regulations	M5 connector IEC 61076-2-105
Status display	No

Flush-type connector - SACC-DSI-M5MS-3CON-L180 - 1530621

Technical data

General

Surge voltage category	II
Pollution degree	3
Test voltage	800 V
Connection method	Solder pins
Mounting type	Rear mounting M5 x 0.5 With locking nut

Material

Inflammability class according to UL 94	HB
Contact material	Cu alloy
Contact surface material	Au
Contact carrier material	PA 66
Material, knurls	Nickel-plated brass
Sealing material	Viton

Classifications

eCl@ss

eCl@ss 4.0	27140815
eCl@ss 4.1	27140815
eCl@ss 5.0	27143423
eCl@ss 5.1	27143423
eCl@ss 6.0	27143423
eCl@ss 7.0	27449001
eCl@ss 8.0	27440103

ETIM

ETIM 2.0	EC001297
ETIM 3.0	EC002061
ETIM 4.0	EC002062
ETIM 5.0	EC002061

UNSPSC

UNSPSC 6.01	31251501
UNSPSC 7.0901	31251501
UNSPSC 11	31251501
UNSPSC 12.01	31251501
UNSPSC 13.2	31251501

Approvals

Approvals

Flush-type connector - SACC-DSI-M5MS-3CON-L180 - 1530621

Approvals

Approvals

EAC

Ex Approvals

Approvals submitted

Approval details

EAC

Drawings

Schematic diagram

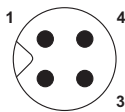

Pin assignment M5 plug, 3-pos., view male side

Dimensioned drawing

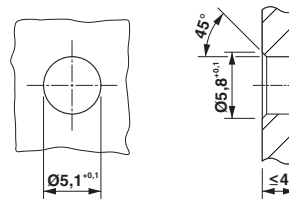

Drilling diagram

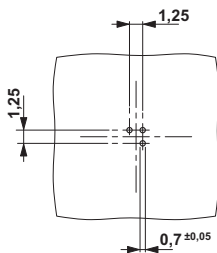

M5 flush-type plug

Dimensioned drawing

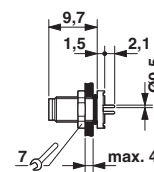

M5 flush-type plug