

PLEASE CHECK WWW.MOLEX.COM FOR LATEST PART INFORMATION

Part Number: [0739290001](#)
Status: **Active**
Overview: SFP Cable Assemblies (2 gbps)
Description: Small Form-factor Pluggable (SFP) Cable Assembly, 1.0m Length

Documents:

[Drawing \(PDF\)](#) [RoHS Certificate of Compliance \(PDF\)](#)

General

Product Family	Cable Assemblies
Series	73929
Assembly Configuration	Dual Ended Connectors
Connector to Connector	SFP-to-SFP
Overview	SFP Cable Assemblies (2 gbps)
Product Name	SFP
UPC	800756458755

Physical

Cable Length	1.0m
Circuits (Loaded)	20
Color - Resin	Black
Gender	Male-Male
Lock to Mating Part	Yes
Material - Resin	Polycarbonate
Net Weight	96.500/g
Packaging Type	Bag
Single Ended	No
Wire Insulation Diameter	N/A
Wire Size AWG	N/A
Wire/Cable Type	Twin-ax

Electrical

Current - Maximum per Contact	0.5A
Shielded	Yes
Voltage - Maximum	30V

Material Info

Reference - Drawing Numbers

Sales Drawing	SD-73929-001
---------------	--------------

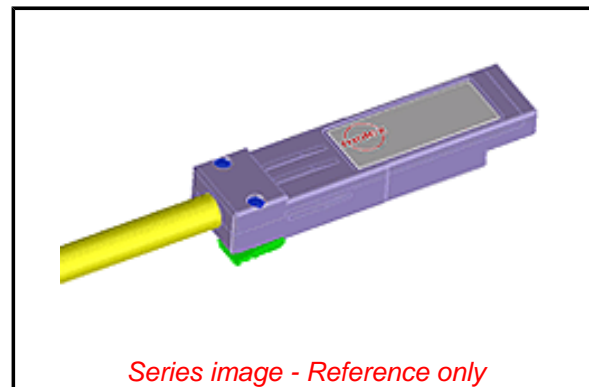

EU ELV

Not Relevant

EU RoHS

Compliant/Exempted

REACH SVHC

Contains SVHC(2014 December 17): No

Halogen-Free

Status

Not Low-Halogen

Need more information on product environmental compliance?

Email productcompliance@molex.com
Please visit the [Contact Us](#) section for any non-product compliance questions.

China ROHS

ELV

China RoHS

Green Image

Not Relevant

Search Parts in this Series

[73929](#) Series

Mates With

[74441](#) SFP Plus (SFP+) Host Connector