

# **PRO-ELEC**

## **INSTRUCTION MANUAL**

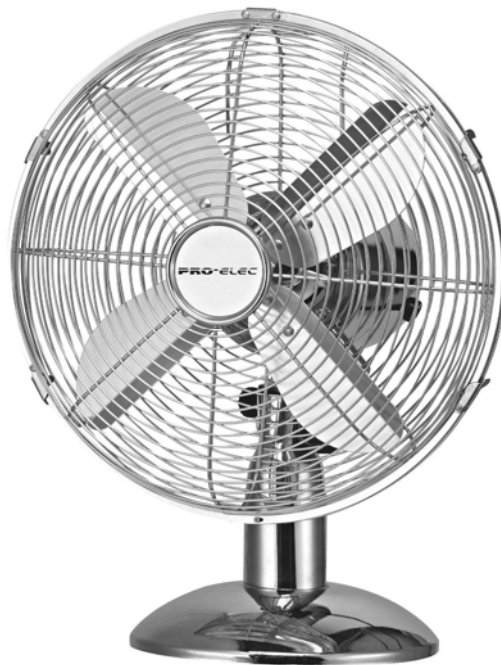

**Model HG00875**

**12" METAL DESK FAN**

## CAUTION

- When using electrical appliances basic safety precautions should always be followed.
- Check that the voltage indicated on the rating plate corresponds with that of the local network before connecting the appliance to the mains power supply.
- This appliance is intended for domestic use only. It should not be used for commercial purposes.
- Do not connect the fan to the supply until it is fully assembled with all guards fitted as described in these instructions.
- Children shall not play with the appliance.
- Cleaning and maintenance shall not be made by children without supervision.
- There are no user-serviceable parts in this product. Refer servicing to qualified personnel.
- Do not operate this appliance with a damaged plug or cord, after a malfunction or after being dropped or damaged in any way.
- This appliance can be used by children aged from 8 years and above and persons with reduced physical, sensory, or mental capabilities or lack of experience and knowledge if they have been given supervision or instruction concerning use of the appliance in a safe way and understand the hazards involved.
- If the supply cord is damaged, it must be replaced by the manufacturer, its service agent or similarly qualified persons in order to avoid a hazard.
- Ensure that the fan is switched off before removing the guard.
- Do not insert anything through the guard when the fan is connected to the supply.
- Make sure the fan is on a stable surface when operating.

## INTRODUCTION

1. Fan Motor
2. Oscillation button
3. Front Cage



## ASSEMBLY

Tools required: Cross head screw driver

1. Make sure the main fan body is secured tightly to the base with the thumb screw under the base.
2. Remove the four screws in the main body and use to attach the rear fan guard, ensuring the handle is at the top.
3. Slide the fan onto the axle screw first and tighten the screw ensuring it is in contact with the flattened edge of the axle.

4. Remove the bolt and nut from the bottom of the front guard and rotate all clips to an open position.
5. Attach the front fan guard, lining up the top notch with the rear guard and ensuring the bolt hole is aligned for the two halves.
6. Close the clips and replace the nut and bolt locking the two halves together.

## OPERATING INSTRUCTIONS

1. Connect the power plug to a suitable outlet.
2. Select the desired speed using the Speed control using the dial on the main body:
  - 0 – Device Off
  - 1 – Low Speed
  - 2 – Medium Speed
  - 3 – High Speed
3. The incline of the ventilator head can be adjusted by tilting it forward or backward. The ventilator head can then be locked into position with the larger thumb screw.
4. The fan can be set to oscillate using the knob on the main body, pushing in to engage the oscillation.

## MAINTENANCE

1. Before cleaning turn the fan off and unplug from the power supply.
2. To clean the fan, use a soft cloth to wipe off any dust. If the fan is very dirty use a damp cloth and wipe dry. Do not use any cleaning detergents, sprays or other chemicals, as they will damage the fan.
3. Store the fan in the original packing in a ventilated dry area.
4. The motor bearings are permanently sealed and do not require additional lubrication.

## TECHNICAL DETAILS

Model No:	HG00875
Power consumption:	35W
Main Voltage:	220-240V ~50Hz
Dimensions:	340x240x420mm
Weight:	3.0kg



### INFORMATION ON WASTE DISPOSAL FOR CONSUMERS OF ELECTRICAL & ELECTRONIC EQUIPMENT.

When this product has reached the end of its life it must be treated as Waste Electrical & Electronics Equipment (WEEE). Any WEEE marked products must not be mixed with general household waste, but kept separate for the treatment, recovery and recycling of the materials used. Contact your local authority for details of recycling schemes in your area.



Premier Farnell Ltd

For any enquiries regarding the product, please call 08447 88 00 88

# **PRO-ELEC**

## **INSTRUCTION MANUAL**

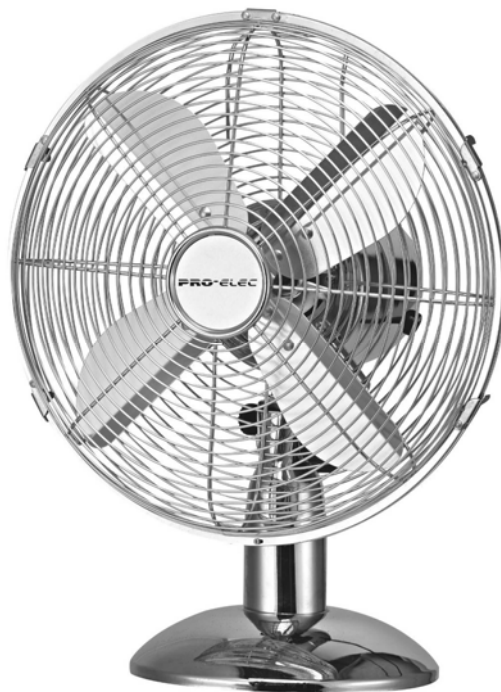

**Model HG00876**

**16" METAL DESK FAN**

## CAUTION

- When using electrical appliances basic safety precautions should always be followed.
- Check that the voltage indicated on the rating plate corresponds with that of the local network before connecting the appliance to the mains power supply.
- This appliance is intended for domestic use only. It should not be used for commercial purposes.
- Do not connect the fan to the supply until it is fully assembled with all guards fitted as described in these instructions.
- Children shall not play with the appliance.
- Cleaning and maintenance shall not be made by children without supervision.
- There are no user-serviceable parts in this product. Refer servicing to qualified personnel.
- Do not operate this appliance with a damaged plug or cord, after a malfunction or after being dropped or damaged in any way.
- This appliance can be used by children aged from 8 years and above and persons with reduced physical, sensory, or mental capabilities or lack of experience and knowledge if they have been given supervision or instruction concerning use of the appliance in a safe way and understand the hazards involved.
- If the supply cord is damaged, it must be replaced by the manufacturer, its service agent or similarly qualified persons in order to avoid a hazard.
- Ensure that the fan is switched off before removing the guard.
- Do not insert anything through the guard when the fan is connected to the supply.
- Make sure the fan is on a stable surface when operating.

## INTRODUCTION

1. Fan Motor
2. Oscillation button
3. Front Cage



## ASSEMBLY

Tools required: Cross head screw driver

1. Make sure the main fan body is secured tightly to the base with the thumb screw under the base.
2. Remove the four screws in the main body and use to attach the rear fan guard, ensuring the handle is at the top.
3. Slide the fan onto the axle screw first and tighten the screw ensuring it is in contact with the flattened edge of the axle.

4. Remove the bolt and nut from the bottom of the front guard and rotate all clips to an open position.
5. Attach the front fan guard, lining up the top notch with the rear guard and ensuring the bolt hole is aligned for the two halves.
6. Close the clips and replace the nut and bolt locking the two halves together.

## OPERATING INSTRUCTIONS

1. Connect the power plug to a suitable outlet.
2. Select the desired speed using the Speed control using the dial on the main body:
  - 0 – Device Off
  - 1 – Low Speed
  - 2 – Medium Speed
  - 3 – High Speed
3. The incline of the ventilator head can be adjusted by tilting it forward or backward. The ventilator head can then be locked into position with the larger thumb screw.
4. The fan can be set to oscillate using the knob on the main body, pushing in to engage the oscillation.

## MAINTENANCE

1. Before cleaning turn the fan off and unplug from the power supply.
2. To clean the fan use a soft cloth to wipe off any dust. If the fan is very dirty use a damp cloth and wipe dry. Do not use any cleaning detergents, sprays or other chemicals, as they will damage the fan.
3. Store the fan in the original packing in a ventilated dry area.
4. The motor bearings are permanently sealed and do not require additional lubrication.

## TECHNICAL DETAILS

Model No:	HG00876
Power consumption:	50W
Main Voltage:	220-240V ~50Hz
Dimensions:	450x280x520mm
Weight:	3.7kg



### INFORMATION ON WASTE DISPOSAL FOR CONSUMERS OF ELECTRICAL & ELECTRONIC EQUIPMENT.

When this product has reached the end of its life it must be treated as Waste Electrical & Electronics Equipment (WEEE). Any WEEE marked products must not be mixed with general household waste, but kept separate for the treatment, recovery and recycling of the materials used. Contact your local authority for details of recycling schemes in your area.



Premier Farnell Ltd

For any enquiries regarding the product, please call 08447 88 00 88

# **PRO-ELEC**

## **INSTRUCTION MANUAL**



**Model HG00877**

**16" METAL PEDESTAL FAN**

## CAUTION

- When using electrical appliances basic safety precautions should always be followed.
- Check that the voltage indicated on the rating plate corresponds with that of the local network before connecting the appliance to the mains power supply.
- This appliance is intended for domestic use only. It should not be used for commercial purposes.
- Do not connect the fan to the supply until it is fully assembled with all guards fitted as described in these instructions.
- Children shall not play with the appliance.
- Cleaning and maintenance shall not be made by children without supervision.
- There are no user-serviceable parts in this product. Refer servicing to qualified personnel.
- Do not operate this appliance with a damaged plug or cord, after a malfunction or after being dropped or damaged in any way.
- This appliance can be used by children aged from 8 years and above and persons with reduced physical, sensory, or mental capabilities or lack of experience and knowledge if they have been given supervision or instruction concerning use of the appliance in a safe way and understand the hazards involved.
- If the supply cord is damaged, it must be replaced by the manufacturer, its service agent or similarly qualified persons in order to avoid a hazard.
- Ensure that the fan is switched off before removing the guard.
- Do not insert anything through the guard when the fan is connected to the supply.
- Make sure the fan is on a stable surface when operating.

## INTRODUCTION

1. Front Guard
2. Fan Blade
3. Locking Nut
4. Fan Blade Screw
5. Cover Fixing Screws
6. Rear Guard
7. Motor Shaft
8. Speed Control
9. Fan Motor
10. Mains Lead
11. Knob
12. Inner Tube
13. Height Adjustment Screw
14. Outer Tube
15. Base
16. Weight
17. Fastener
18. Locking Screw

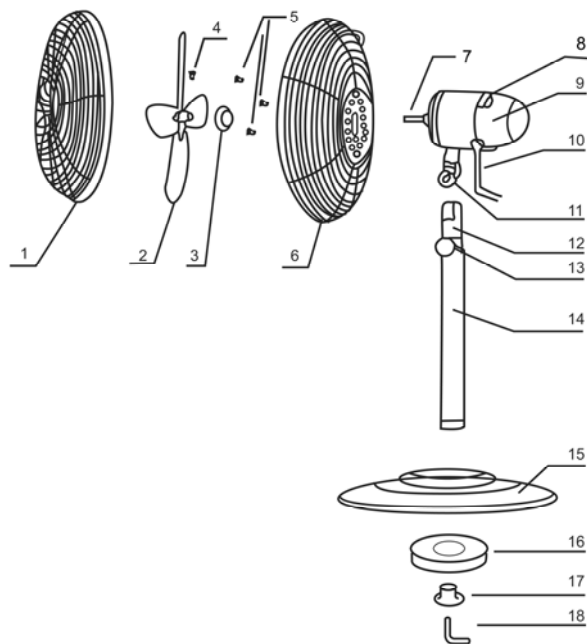



## ASSEMBLY

1. Assemble the base.
2. Insert the outer tube into the base, slide on the weight and secure using the locking screw. Place the assembly upright.
3. Secure the fan motor to the inner tube using the screws provided.
4. Attach the rear guard to the fan motor, securing it in place with the cover fixing screws.
5. Place the locking nut and fan blade on the motor shaft, securing in place using the fan blade screw.
6. Hold the front guard against the rear guard and secure it in place with the cover fixing screws

## OPERATING INSTRUCTIONS

1. Connect the power plug to a suitable outlet.
2. Select the desired speed using the Speed control:
  - 0 – Off
  - 1 – Low Speed
  - 2 – Medium Speed
  - 3 – High Speed
3. The incline of the ventilator head can be adjusted by tilting it forward or backward. The ventilator head can then be locked into position, which is indicated by an audible click.
4. To adjust the height, slacken the height adjustment screw, slide the upper section to the required height and re-tighten the adjustment screw.

## MAINTENANCE

1. Before cleaning turn the fan off and unplug from the power supply.
2. To clean the fan, use a soft cloth to wipe off any dust. If the fan is very dirty use a damp cloth and wipe dry. Do not use any cleaning detergents, sprays or other chemicals, as they will damage the fan.
3. Store the fan in the original packing in a ventilated dry area.
4. The motor bearings are permanently sealed and do not require additional lubrication.

## TECHNICAL DETAILS

Model No:	HG00877
Power consumption:	50W
Main Voltage:	220-240V ~50Hz
Dimensions:	400x400x1250mm
Weight:	6.3kg



### INFORMATION ON WASTE DISPOSAL FOR CONSUMERS OF ELECTRICAL & ELECTRONIC EQUIPMENT.

When this product has reached the end of its life it must be treated as Waste Electrical & Electronics Equipment (WEEE). Any WEEE marked products must not be mixed with general household waste, but kept separate for the treatment, recovery and recycling of the materials used. Contact your local authority for details of recycling schemes in your area.



Premier Farnell Ltd

For any enquiries regarding the product, please call 08447 88 00 88