

# 529702B02500G

TO-220, TO-220-single gauge (0.020")



Extruded heat sink with large radial fins and solderable pins

This non-electronic component is functionally unaffected by the normal soldering or reflow processes used for semiconductor circuits. The heat resistance time or heat resistance temperature is not applicable for the component.

- Height:** 25.40
- Mount Orientation:** Vertical
- Finish:** Black Anodize
- RoHS:** compliant
- Thermal Resistance:** 5.50

**Additional Drawing Dimensions:**

A Dim: 25.4 | B Dim: 18.29 | C Dim: 3.17

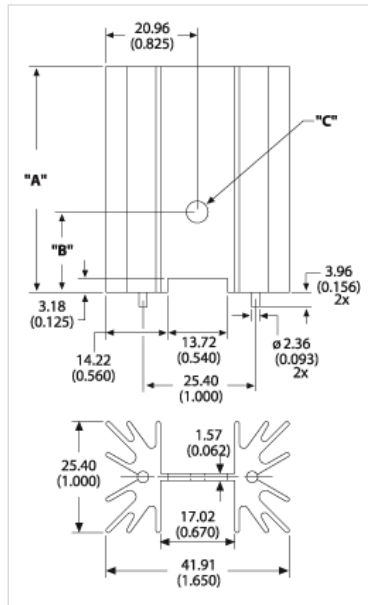

X Dim: 12.70 (0.500) | Y Dim: 0.79 (0.031) | Z Dim: 2.67 (0.105)

